

B.M. 98.77 N.W. cor. conc. porch to 2002 S. Poplar
 B.M. 99.49 "M" in Mueller F. Hyd. N.W. cor. Grove & Levy

NOTE: Chaining N. on W.R.

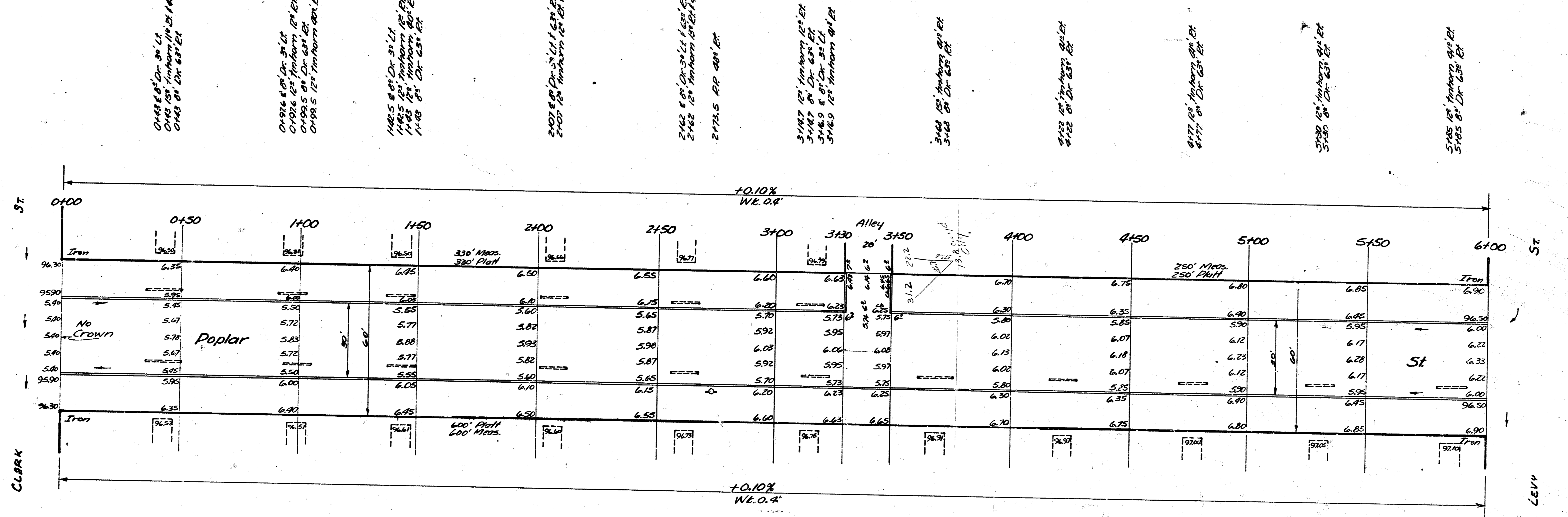

0148 6" Dr. 30" Lt.
 0148 12" Manhole 10' Dr. 18" Lt.
 0148 8" Dr. 25' Lt.

0192 4" Dr. 30" Lt.
 0192 12" Manhole 10' Dr. 18" Lt.
 0192 5" Dr. 25' Lt.

1165 8" Dr. 30" Lt.
 1165 12" Manhole 10' Dr. 18" Lt.
 1165 8" Dr. 25' Lt.

2102 8" Dr. 30" Lt.
 2102 12" Manhole 10' Dr. 18" Lt.

2162 8" Dr. 30" Lt.
 2162 12" Manhole 10' Dr. 18" Lt.
 2174.5 AP 48" Lt.

3187 8" Dr. 30" Lt.
 3187 12" Manhole 10' Dr. 18" Lt.
 3187 5" Dr. 25' Lt.
 3187 8" Dr. 25' Lt.

3148 8" Dr. 30" Lt.
 3148 12" Manhole 10' Dr. 18" Lt.

4142 8" Dr. 30" Lt.
 4142 12" Manhole 10' Dr. 18" Lt.

4172 12" Manhole 10' Dr. 18" Lt.
 4172 8" Dr. 25' Lt.

5180 12" Manhole 10' Dr. 18" Lt.
 5180 8" Dr. 25' Lt.

5148 8" Dr. 30" Lt.
 5148 12" Manhole 10' Dr. 18" Lt.

Checked by: [Signature]
 Drawn by: [Signature]
 City Engineer

NOTE TO CONTRACTOR & FIELD ENGINEER
 All entrance pipe to be placed on owners property. If
 owner wants pipe daulted away, Street Dept. will remove it

Grand Total Excav.
 Prop. X- Sect. 974.7
 +10% 97.5
 Total 1072.2 Cu. Yd.
 City X- Sect. 16.9
 Plan. 13.8
 -30.7
 +10% 3.1
 Total 33.8 Cu. Yd.

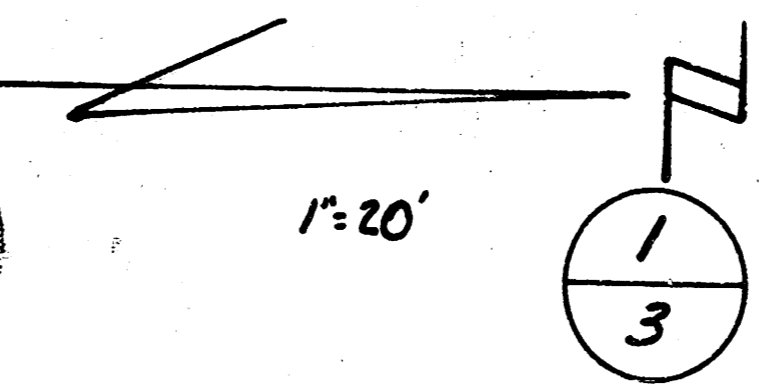
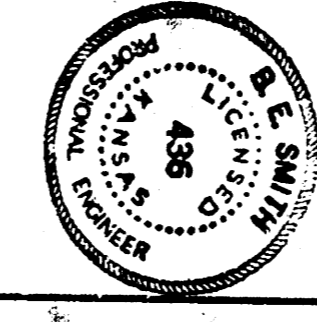

POPLAR ST.
 N.L. CLARK TO S.L. LEVY
 30' CONC. CB.
 CITY OF WICHITA, KANSAS
 B.E. SMITH CITY ENGINEER
 JAN. 19, 1953 Proj. No. C12-193