

BM 1 Cut on N.E. Corner of Highway of Doublet 140 R.C.P. 253' E of  
 Grove on PAWLEE. ELEV. 93.51  
 BM 2 on N.W. Corner of Highway of Doublet 140 R.C.P. 253' E of  
 Grove on PAWLEE. ELEV. 93.51  
 GROVE Sta. 99+00  
NOTE: Stationing on L.R. POPLAR East.

**NOTE:**  
 Use Pre-cast Expansion Joint at Stations  
 1+34.98, 1+64.98, 2+25, 3+05.88 and  
 3+35.88.

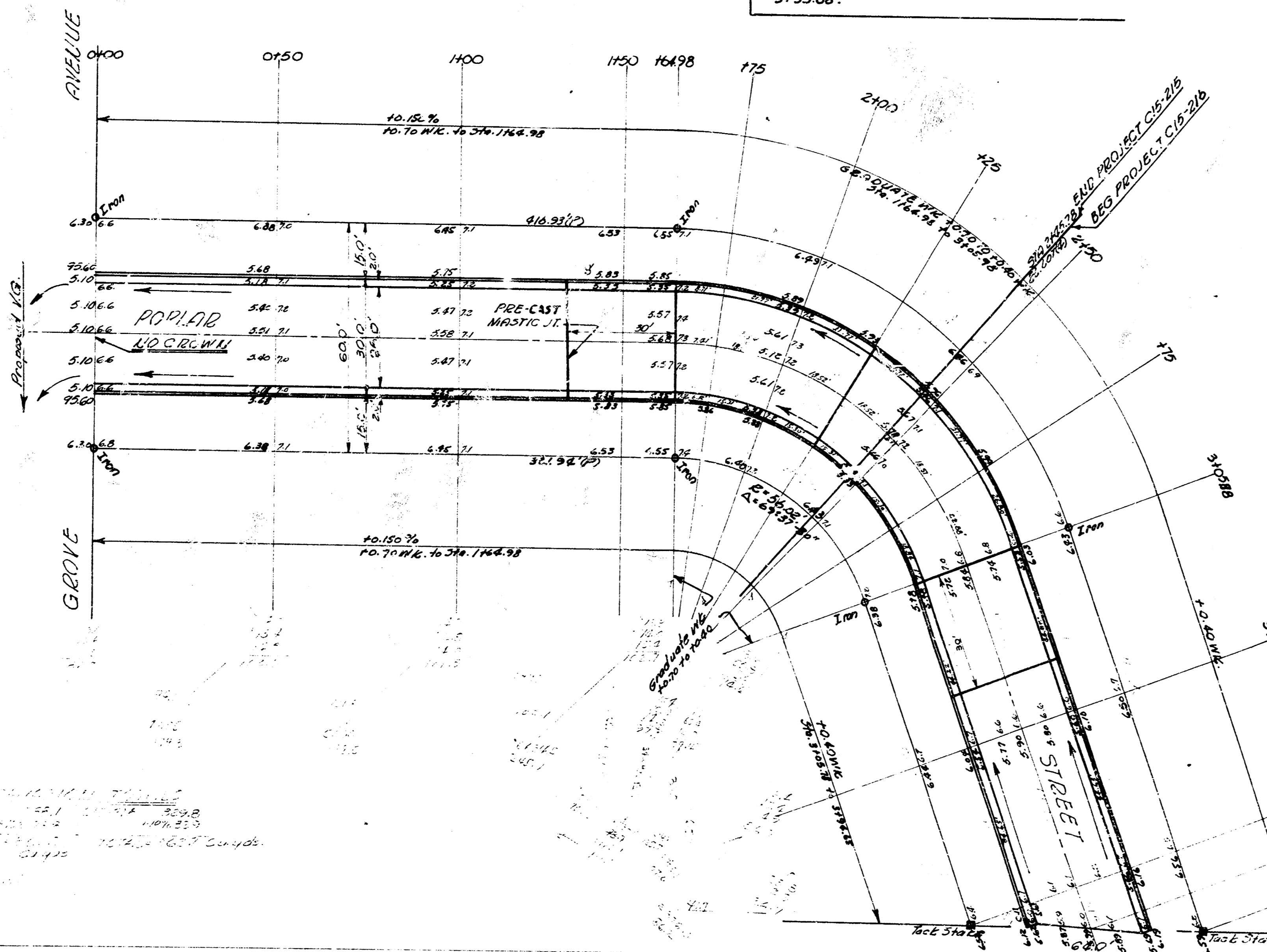

CURVE DATA BASED ON E.P. 216.02 24.5

STATION	CHORD	CHORD BEARING	ARC	ARC BEARING
1+64.98	121.00	120° 00' 00"	121.00	120° 00' 00"
1+75	5.60	2° 28' 02"	2' 28' 02"	2° 28' 02"
2+00	18.01	6° 10' 23"	6° 10' 23"	6° 10' 23"
2+25	18.01	6° 10' 23"	6° 10' 23"	6° 10' 23"
2+50	18.01	6° 10' 23"	6° 10' 23"	6° 10' 23"
2+75	18.01	6° 10' 23"	6° 10' 23"	6° 10' 23"
3+00.78	17.56	2° 28' 58"	2' 28' 58"	2° 28' 58"



**POPLAR STREET**  
 EL GROVE - EL Lot 4, Blk 2, L7th  
 El. Lot 4, Blk 2, L7th Addn. - El. Lot 4, Blk 2, L7th Addn.  
 26-2-30 A.C.  
 CITY OF WICHITA, KANSAS  
 B.E. SMITH CITY ENGINEER  
 APRIL 1956 PROJ. NO. 815-216

Survey Status 5, 1927  
 100' Station  
 100' Station