

BM #1 132.60 *60 Spike N.S. P.P. So. Side 37th + 75' W. Of Woodrow N.
 BM #2 132.71 "X" N. End Return N.W. Friar Ln. + Woodrow Ave.
 BM #3 130.79 P.P. Spike N. Side Transformer P. So. Side 37th E. Side Porter Ave. N.
 BM #4 133.01 "□" Cut E. End Pav. NE. Friar + Woodrow

N
 Scale: 1" = 40'

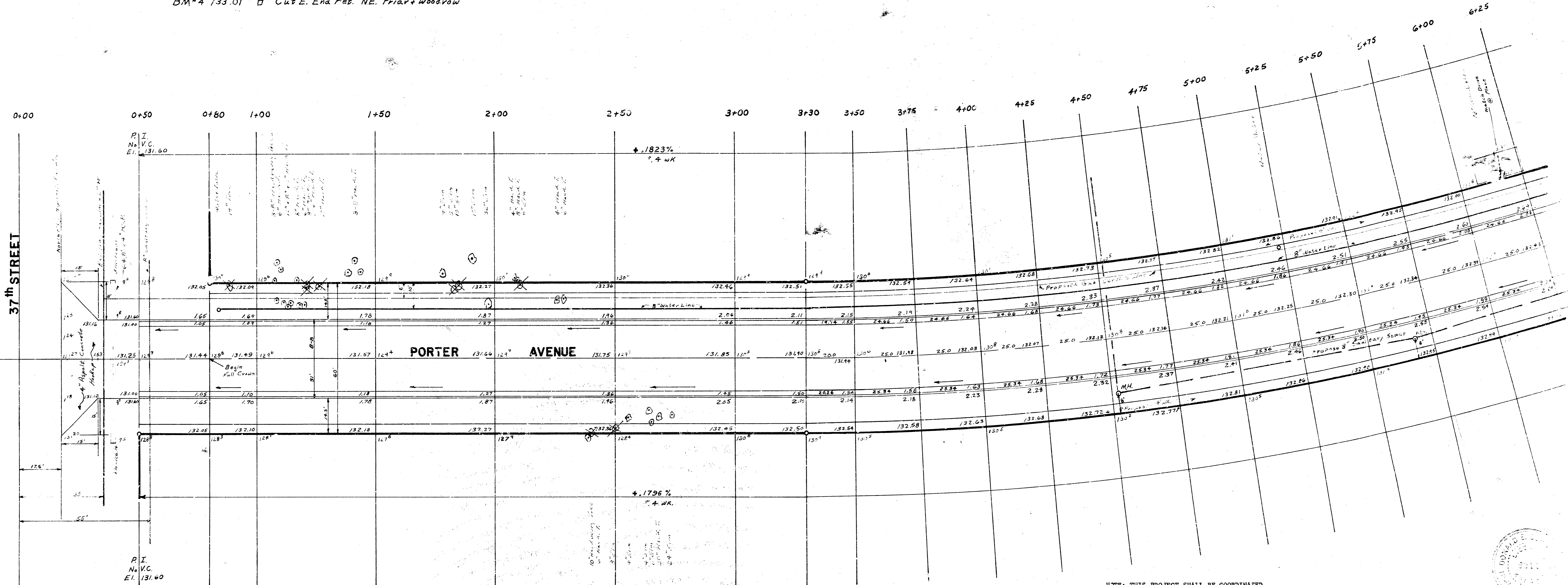

37th STREET

PORTER AVENUE

NOTE: THIS PROJECT SHALL BE COORDINATED WITH THE SANITARY SEWER PROJECT TO BE CONSTRUCTED IN STREET RIGHT-OF-WAY.

Excavation	Compacted Fill	Borrow	Total
336 yd ³	1856.7 yd ³	2700 yd ³	3983.7 yd ³
+10% : 369.6 yd ³	+10% : 2042.4 yd ³	+10% : 2970 yd ³	4682.0 yd ³
Total:	369.6 yd ³	2970 yd ³	4682.0 yd ³

Note: The Centerline Of Porter Is The Base Line For This Project.
 Note: All Curve Data Is On Page 2.
 Note: ~~Tree~~ Tree To Be Removed.

NOTE: THE TYPE OF SUB-GRADE TREATMENT SHALL BE DETERMINED BY THE FIELD ENGINEER. SUB-GRADE TREATMENT MAY CONSIST OF LIME TREATMENT, CEMENT TREATMENT, SUB-GRADE MODIFICATION, OR ANY COMBINATION OF THESE.
 NOTE: CONTRACTOR TO GRADE PARKINGS, CLEAR THE RIGHT-OF-WAY, AND CONSTRUCT COMPACTED FILL FOR FUTURE SIDEWALK. SIDEWALK SHALL BE CONSTRUCTED BY OTHERS.

PORTER AVENUE
 FROM N.L. OF 37th STREET
 TO S.L. FRIAR LANE
 26-2-30 A.C. PAVMT.
 CITY OF WICHITA, KANSAS
 R.W. LINN CITY ENGINEER
 DATE: July 1973
 SHEET 1 OF 4
 PROJECT NO. DAKS 565009

