

B.M. 16233 R.R. Sp. N.S. R.R. NW. Gr. Post oak & Douglas

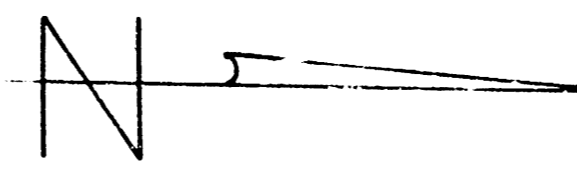

NOTE: Elevations Shown Are For ROLL CURB

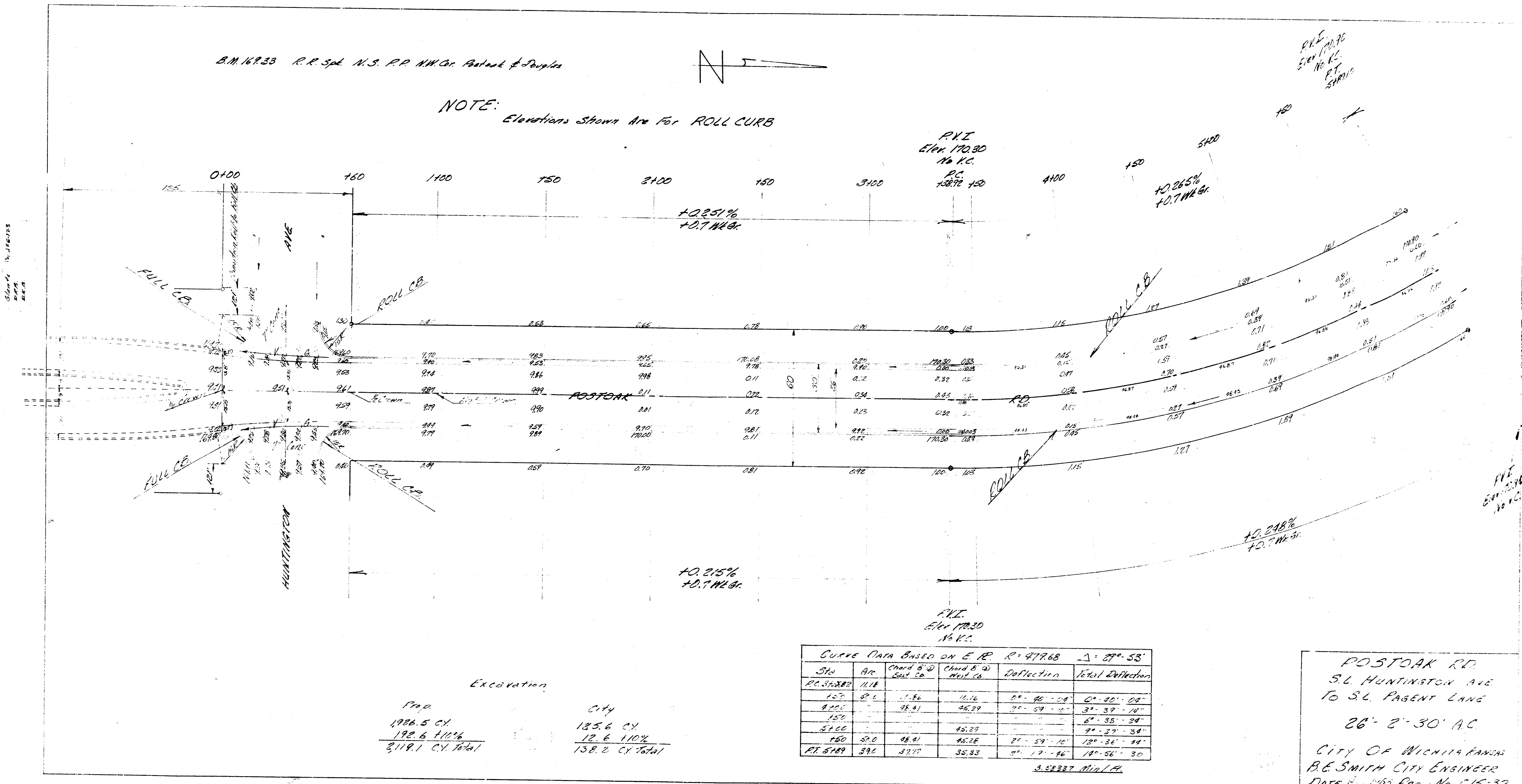

Excavation

From	City
1986.5 CY	135.6 CY
198.6 110%	12.6 110%
2119.1 CY Total	158.2 CY Total

Curve Data Based on E.R. R. 47768 Δ = 27° 53'

Sta	AR	Chord B' @ Sol. Co.	Chord B' @ Neul. Co.	Deflection	Total Deflection
PC 3+38.82	11.8				
150	22.6	42.76	42.76	0° 40' 00"	0° 40' 00"
200	45.2	85.52	85.52	0° 59' 40"	0° 59' 40"
250	67.8	128.28	128.28	1° 18' 20"	1° 18' 20"
300	90.4	171.04	171.04	1° 37' 00"	1° 37' 00"
350	113.0	213.80	213.80	1° 55' 40"	1° 55' 40"
400	135.6	256.56	256.56	2° 14' 20"	2° 14' 20"
PT 4+18.7	11.8				

3.52327 Min/Lt.

POSTOAK RD.  
 S.L. HUNTINGTON AVE  
 TO S.L. PAGENT LANE  
 26'-8"-30" AC  
 CITY OF WICHITA KANSAS  
 B.E. SMITH CITY ENGINEER  
 DATE 11-1-65 PROJ. No. C15-32

