

Survey  
Plan  
Checked J.T.

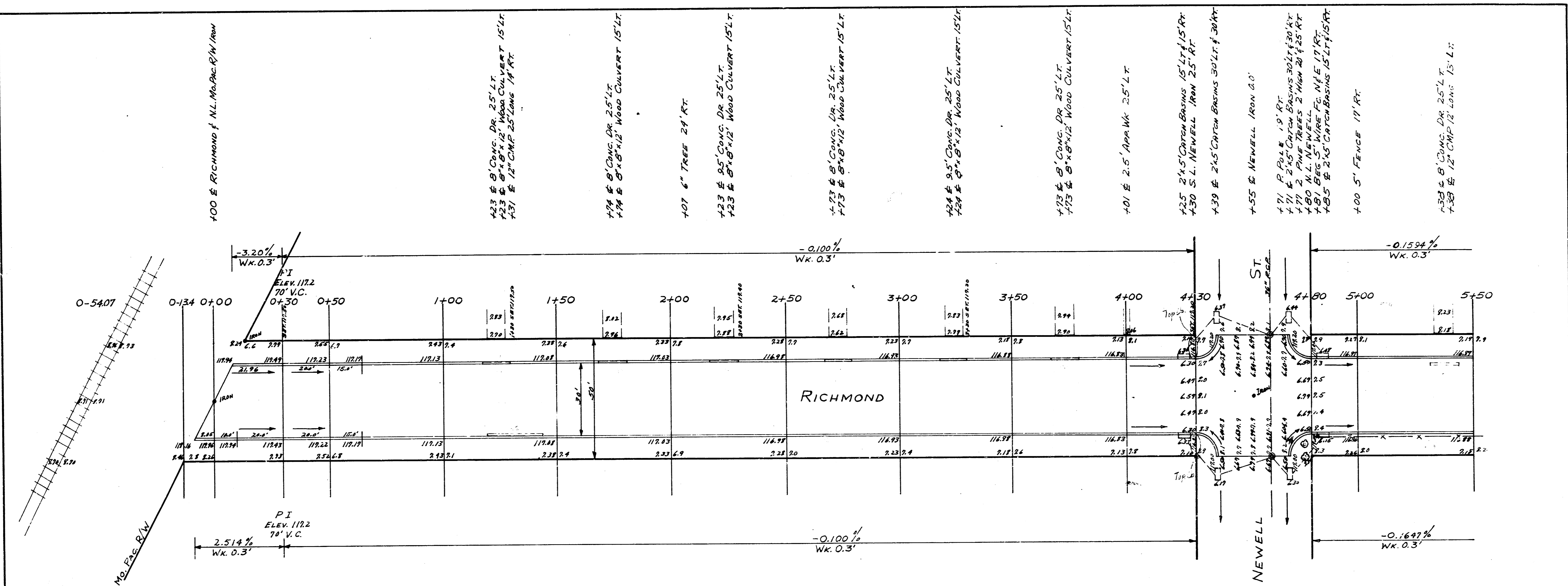

400 E RICHMOND f. N.L. MO PAC RR/RW

423 & B CONC. DR. 25" LT.  
423 & B 8" x 8" x 12" WOOD CULVERT 15' LT.  
431 & 12" CMP 25' LONG 14' RT.

474 & B CONC. DR. 25" LT.  
474 & B 8" x 8" x 12" WOOD CULVERT 15' LT.

407 6" TREE 24' RT.

423 & B 8" x 8" x 12" WOOD CULVERT 15' LT.  
423 & B 8" x 8" x 12" WOOD CULVERT 15' LT.

473 & B 8" x 8" x 12" WOOD CULVERT 15' LT.  
473 & B 8" x 8" x 12" WOOD CULVERT 15' LT.

424 & B 8" x 8" x 12" WOOD CULVERT 15' LT.  
424 & B 8" x 8" x 12" WOOD CULVERT 15' LT.

473 & B 8" x 8" x 12" WOOD CULVERT 15' LT.  
473 & B 8" x 8" x 12" WOOD CULVERT 15' LT.

401 & 2.5' APPR Wk 25' LT.

425 & B 2' x 5' CATCH BASIN 15' LT. f. 15' RT.  
430 S.L. NEWELL IRON 25' RT.

439 & B 2' x 5' CATCH BASIN 30' LT. f. 30' RT.

455 & NEWELL IRON 40'

471 P POLE 19' RT.  
471 & B 2' x 5' CATCH BASIN 30' LT. f. 30' RT.  
470 2' x 5' CATCH BASIN 2' HIGH 20' x 25' RT.  
481 8" x 8" x 12" WOOD CULVERT 15' LT. f. 15' RT.  
485 & B 2' x 5' CATCH BASIN 15' LT. f. 15' RT.

400 5' FENCE 19' RT.

432 & B 8" x 8" x 12" WOOD CULVERT 15' LT.  
432 & B 12" CMP 18' LONG 13' LT.

NOTE: TO FIELD ENG. DRIVE GRADES ON WEST SIDE WERE NOT SET BY CITY ENGINEERS DO NOT MATCH

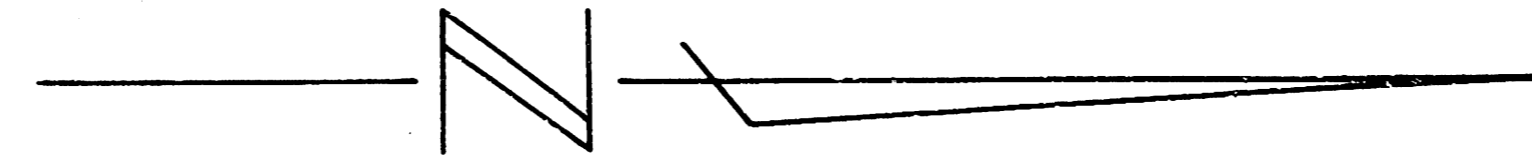

1/4

B.M. 116.08 S END SE RADIUS CENTRAL f. RICHMOND  
B.M. 117.60 6" IN GLOBE E END OF S.E. RADIUS NEWELL f. EDWARDS  
STATIONING f. BASE LINE f. OF RICHMOND.

TIES TO IRON & NEWELL  
23.3 NORTH EAST FACE F. POLE  
56.5 NORTH WEST TO COR. STEEL FENCE  
63.3 SOUTH WEST TO CAR HOUSE

NOTE: TO CONTRACTOR f. FIELD ENGINEER  
ENTRANCE PIPES WILL BE DISPOSED OF IN ACCORDANCE WITH INSTRUCTION OF DIRT CHECKER.



RICHMOND  
SL. CENTRAL TO N.L. MO PAC. RR/RW  
30 CONC f. CB  
CITY OF WICHITA KAN  
B.E. SMITH CITY ENGINEER  
MAY 1954 Proj. No C14-98

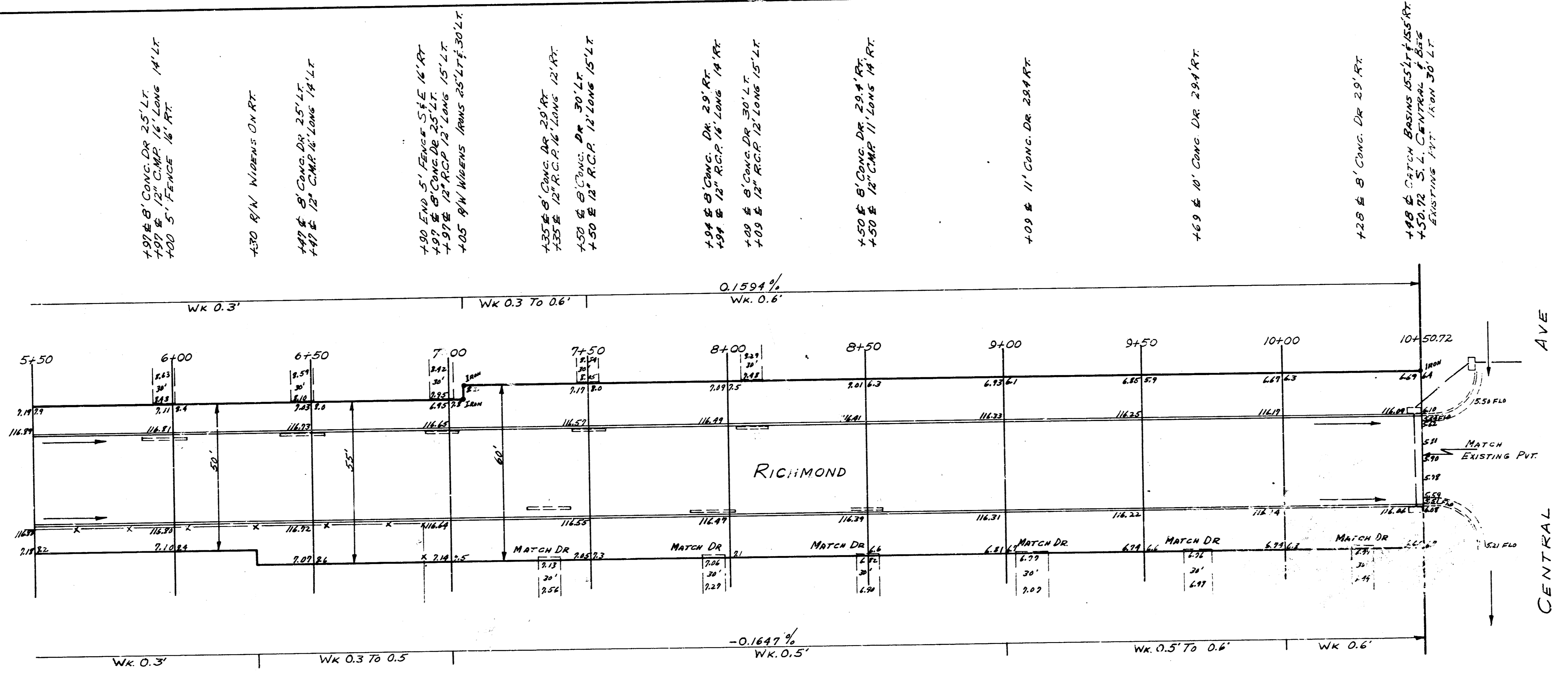

497 & 8' CONC. DR. 25' LT.  
 497 & 2" C.M.P. 12' LONG 14' RT.  
 490 5' FENCE 16' RT.  
 490 8" N. WIRE ON RT.  
 497 & 8' CONC. DR. 25' LT.  
 497 & 2" C.M.P. 12' LONG 14' RT.  
 499 F.W. 5' FENCE S/E 16' RT.  
 497 & 8' CONC. DR. 25' LT.  
 497 & 2" R.C.P. 12' LONG 15' LT.  
 495 8" N. WIRE S/W 25' LT. 30' LT.  
 495 & 8' CONC. DR. 25' RT.  
 495 & 2" R.C.P. 12' LONG 12' RT.  
 498 & 8' CONC. DR. 25' LT.  
 498 & 2" C.M.P. 12' LONG 14' RT.  
 499 & 8' CONC. DR. 25' LT.  
 499 & 2" R.C.P. 12' LONG 15' LT.  
 499 & 8' CONC. DR. 25' LT.  
 499 & 2" R.C.P. 12' LONG 15' LT.  
 499 & 8' CONC. DR. 25' RT.  
 499 & 2" C.M.P. 12' LONG 14' RT.  
 499 & 11' CONC. DR. 28' RT.  
 499 & 10' CONC. DR. 28' RT.  
 499 & 8' CONC. DR. 25' RT.  
 499 & CATCH BASIN 45' LT. 155' RT.  
 499 & 2" S. L. CENTRAL F. 25' RT.  
 EXISTING 117' 18" ON 30' LT.

2/4

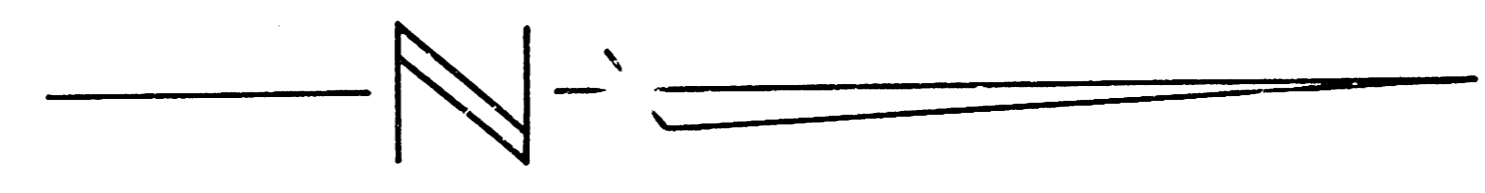

RICHMOND  
 Proj. No. C14-98