

**RICHMOND AVENUE**  
**N.L. 10TH STREET TO S.L. 11TH STREET**  
**PROJ NO. 472-76-245-80919000 - 000-001**

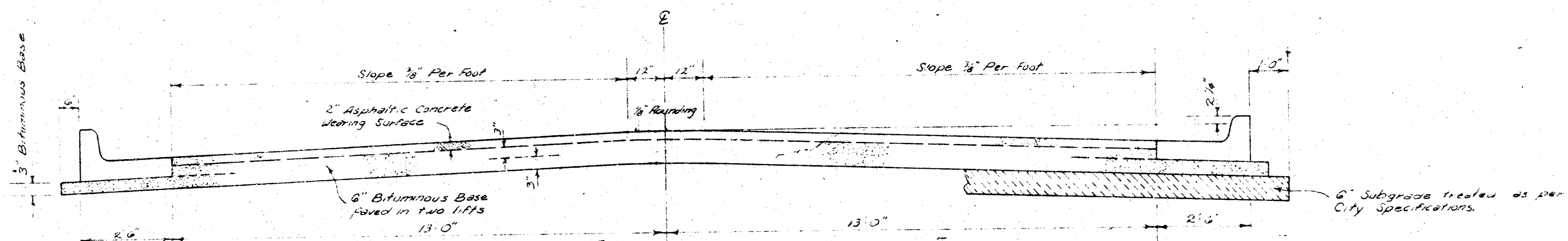

**TYPICAL SECTION**

**3" ASPHALTIC CONCRETE PAVEMENT WITH BITUMINOUS BASE**

A TACK COAT OF EMULSIFIED ASPHALT (SS-1H) SHALL BE APPLIED AT AN APPROXIMATE RATE OF 0.05 GALLONS PER SQ YD BETWEEN LIFTS OF ASPHALTIC MATERIALS WHEN ORDERED BY THE ENGINEER. TACK COAT WILL NOT BE PAID FOR DIRECTLY AND SHALL BE CONSIDERED AS SUBSIDIARY TO PRICE BID FOR ASPHALTIC PAVEMENT.

BITUMINOUS BASE AND ASPHALTIC CONCRETE WEARING SURFACE SHALL BE PLACED WITH A LAYDOWN MACHINE HAVING AUTOMATIC CONTROLS FOR CROWN AND GRADE. CONSTRUCTION JOINTS IN EACH LIFT SHALL BE STAGGERED A MINIMUM DISTANCE OF 1' WITH JOINTS IN PRECEDING LIFTS, AND SUCH THAT A JOINT WILL BE CONSTRUCTED ON THE PAVEMENT CENTERLINE IN THE TOP LIFT.

*The A.C. pavement between the Comp. Curb & gutter shall be paid as 2 1/2" A.C. Pavement (6" Bituminous Base). The Bituminous Base under the Comp. Curb & gutter shall be paid as 3" Bituminous Base.*

**DETAIL OF TRANSVERSE CONSTRUCTION JOINTS**

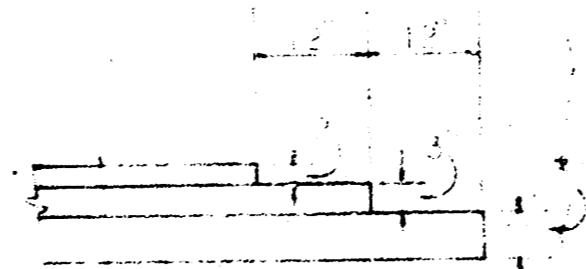

TRANSVERSE CONSTRUCTION JOINTS SHALL BE CONSTRUCTED IN FLEXIBLE BASE PAVEMENTS AT LOCATIONS WHERE PAVEMENT TEMPORARILY ENDS TO FACILITATE FUTURE PAVEMENT CONSTRUCTION AS SHOWN BY DETAIL. THE COST OF CONSTRUCTING THE TRANSVERSE CONSTRUCTION JOINTS SHALL NOT BE MEASURED OR PAID FOR DIRECTLY BUT SHALL BE INCLUDED IN THE BID PRICE FOR SQUARE YARDS OF ASPHALTIC CONCRETE PAVEMENT.

COMBINED CURB & GUTTER

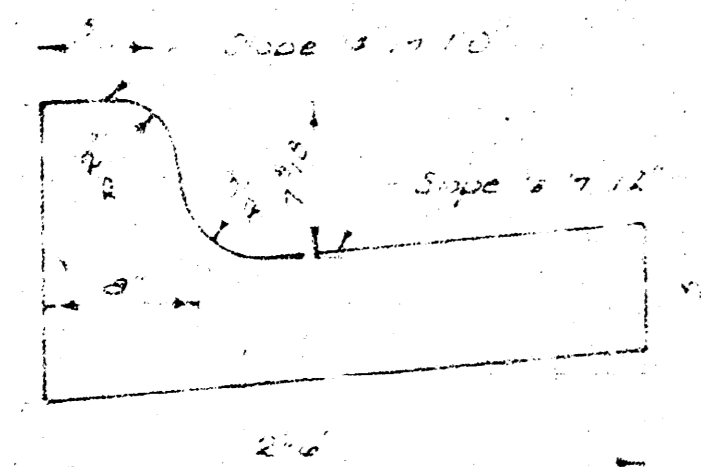

~~ROLL TYPE CURB & GUTTER~~

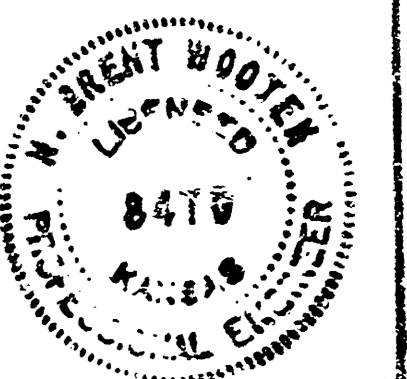
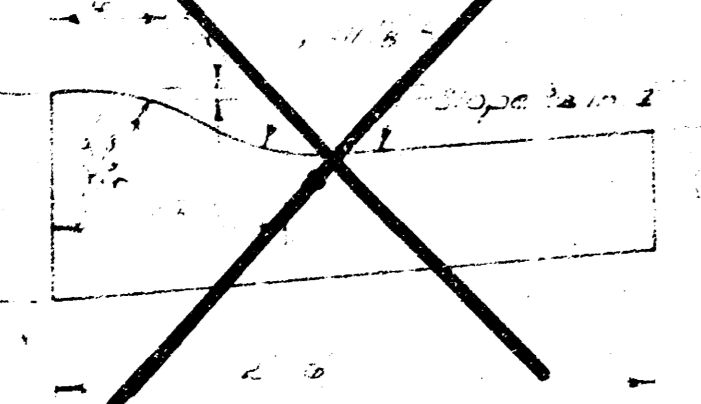

CITY OF WICHITA, KANSAS

DEPARTMENT OF PUBLIC WORKS — ENGINEERING

D.S. SELLERS ACTING CITY ENGINEER

DATE \_\_\_\_\_

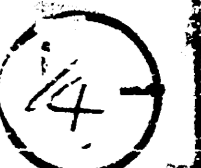

B.M. 11975 S.W. COR CONCRETE PORCH 2512 WEST 11TH STREET.  
 SURVEY BASELINE - RICHMOND AVE

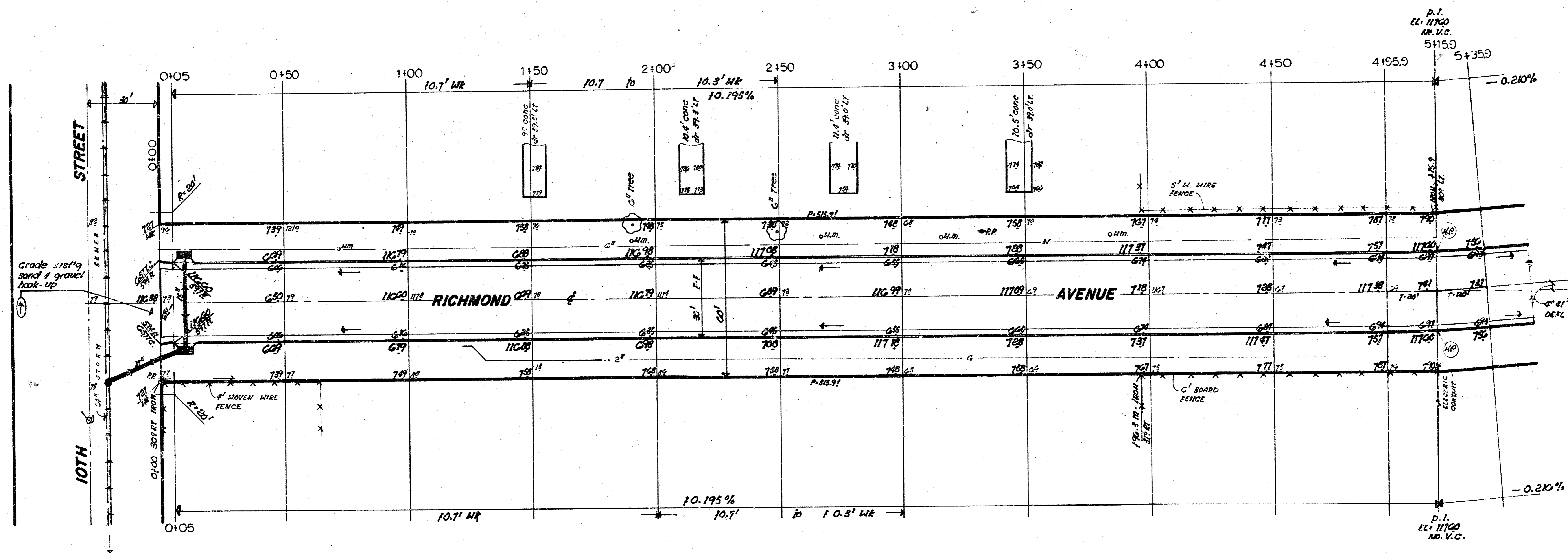

SURVEY: DAZLEA DR. D.C.D. & P.C.  
 PLAN: M.E.E.  
 CHECKED: [Signature]

⊕ COST FOR GRADING EXISTING SAND AND GRAVEL HOOR-UP TO BE CONSIDERED INCIDENTAL TO OTHER BID ITEMS.

⊕ **EARTHWORK**  
 EXCAVATION  
 1175.2 CU YDS  
 110% 117.5  
 1292.7 CU YDS

2550 SQ YDS MANIPULATION

**SUB-GRADE**  
 TYPE OF SUB-GRADE TREATMENT SHALL BE DETERMINED BY THE FIELD ENGINEER. SUB-GRADE TREATMENT MAY CONSIST OF LIME TREATMENT, CEMENT TREATMENT, SUB-GRADE MODIFICATION, OR ANY COMBINATION OF THESE.

⊕ IRON PIN. FIELD ENGINEER TO TAKE TIES TO IRONS DESTROYED BY CONSTRUCTION. IRONS ARE TO BE RE-PLACED.

⊕ **"DRIVES"**  
 NO MORE THAN 17'-20" DRIVES TO BE CONSTRUCTED ON THIS PROJECT.

**RICHMOND AVENUE**  
 N.L. 10TH STREET TO S.L. 11TH STREET  
**CITY OF WICHITA, KANSAS**  
 (30" F-F) 2" ASPH CONC WEARING SURFACE  
 6" BITUMINOUS BASE W/ COMB CURB & GTR.  
 D.S. SELLERS Acting City Engineer  
 DATE: \_\_\_\_\_  
 Proj No. 472-76-245-80919-000-000-001

2  
5

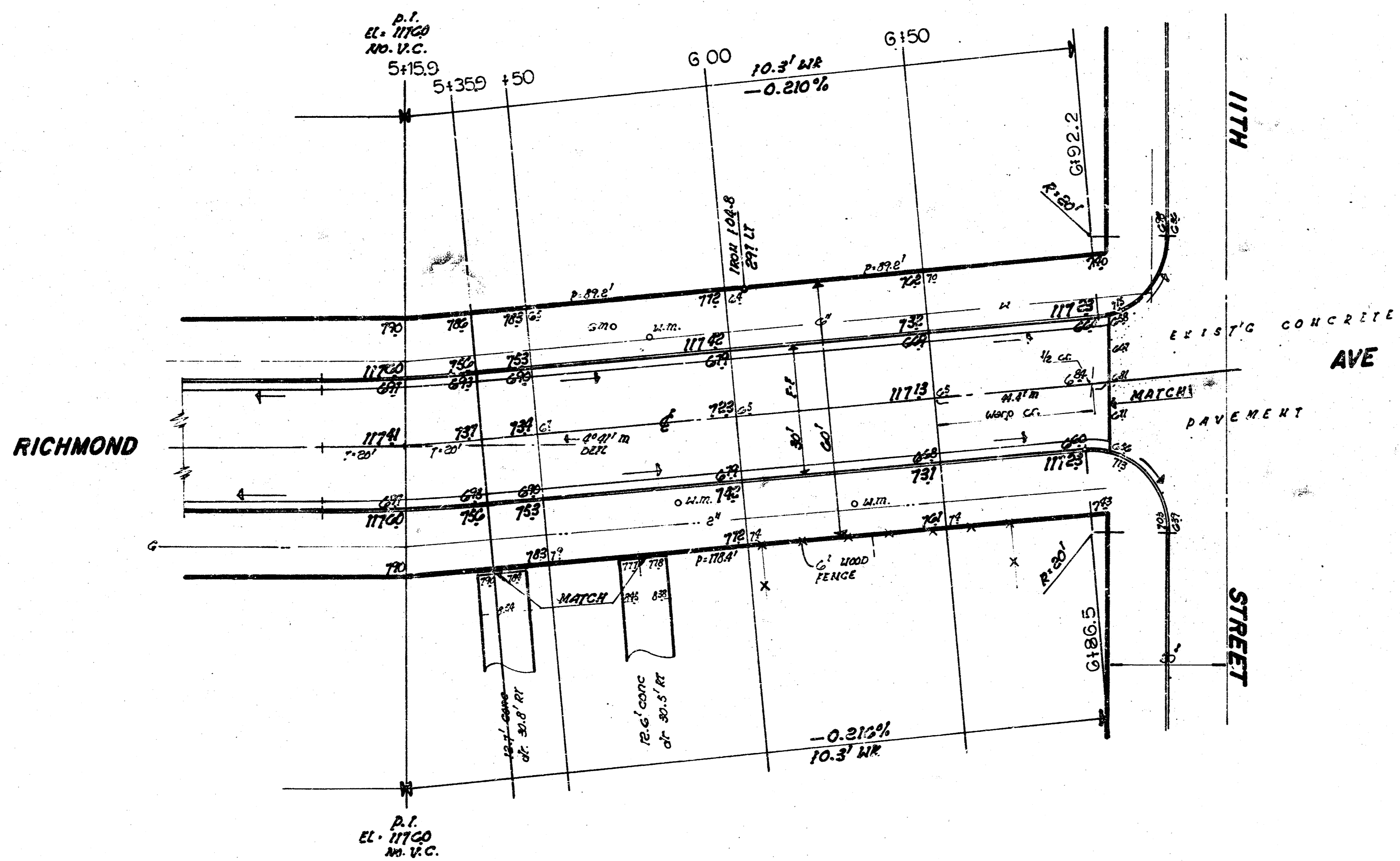

CURVE DATA BASED ON P.I. STA 5+15.9  
 RADIUS = 489.09'  
 TAN = 20.00'  
 Δ = 4° 41' MEAS.

