

D.M. 1133 City St. 6' 11" E. of SE cor. 11th Meridian
 D.M. 1134 SE cor. 10th 1305 N. Richmond
 D.M. 1135 SW cor. 10th 1512 N. 11th St.

Scale 1" = 20'

Surveyed by
 E.C. Linn
 Checked by
 E.C. Linn

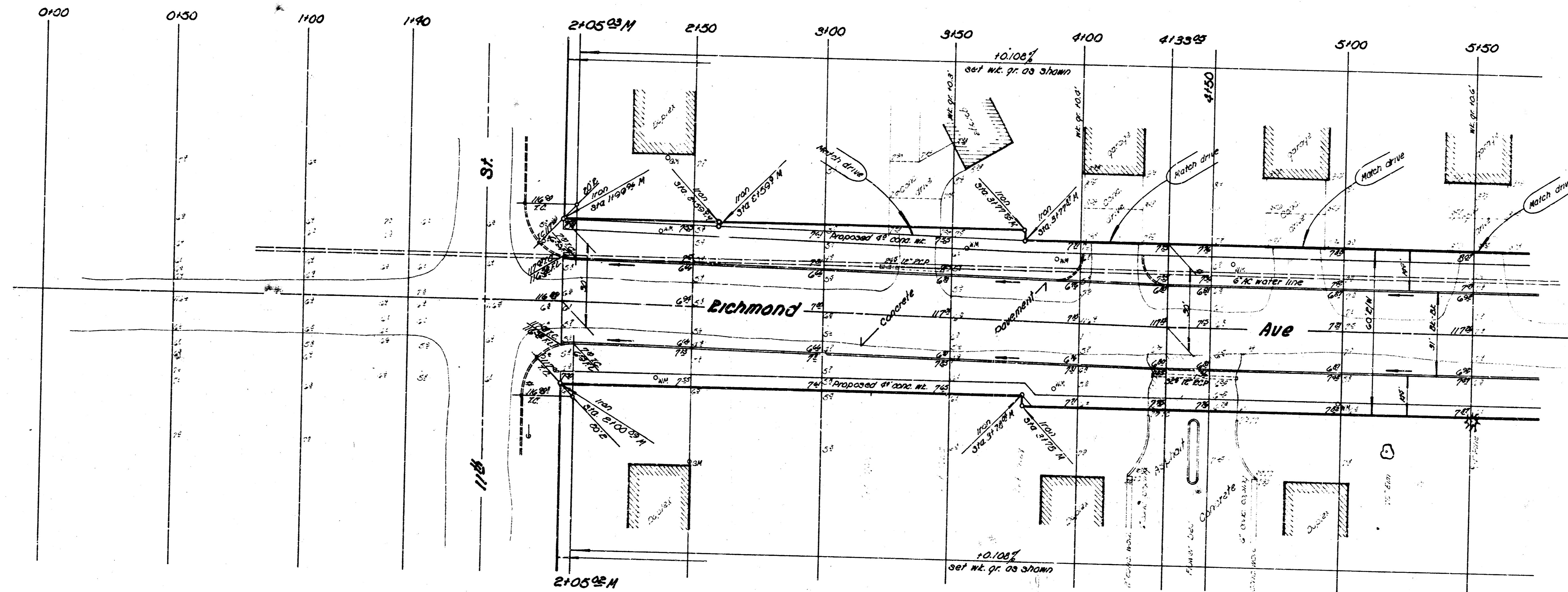

- General Notes**
- Contractor to clear Right of Way, grade parking and construct compacted fill in sidewalk areas. Sidewalk to be constructed by others.
 - Contractor to grade 11th St. and Richmond Ave. in intersection to match new pavement such that water will drain west to Sheridan Ave. This work shall be considered incidental to project.

Earthwork

Excavation	463.4 cu yds	Comp. Fill	238.4 cu yds
110%	46.3 cu yds	110%	23.9 cu yds
Total	509.7 cu yds	Total	262.3 cu yds

Borrow Excavator
620 cu yds



Richmond Ave.
 N.E. 11th St. to N.E. 1st & Coler Avenues
 Concrete 30" & curb
 City of Wichita, Kansas
 E.W. Linn City Engineer
 Project No. DAK5573070
 Date: MAY 1974

