

B. M. 99.035 S. W. cor. conc. Parch. No. 2902 S. Fern.

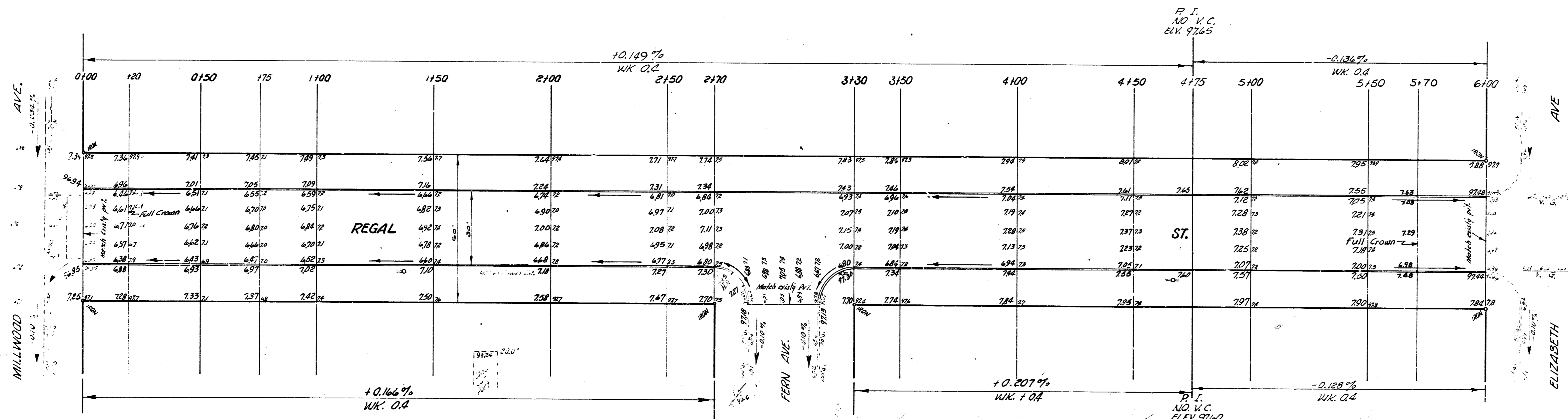

Survey J.F.G. BK # 22  
 Plan  
 Checked  
 7/1



**REGAL ST.**  
 EL MILLWOOD - WL ELIZABETH  
 30' CONC. F' CB.  
 CITY OF WICHITA, KANSAS  
 B. E. SMITH CITY ENGINEER  
 APRIL 1957 PROJ. NO. C16-185

