

BASELINE = EAST LINE RICHMOND AVE.

S.M. 98.80 RR SPIKE N.W. SIDE WOOD STREET LIGHT POLE ON S.E. COR. RICHMOND & SOUTHGATE  
S.M. 98.40 X ON E. END OF S.E. CURB. RETURN, S.E. COR. 30th & GORDON

NOTE: CONTRACTOR TO CLEAR RIGHT-OF-WAY, GRADE PARKINGS, AND CONSTRUCT COMPACTED FILL WHERE NECESSARY FOR PROPOSED SIDEWALK. SIDEWALK TO BE CONSTRUCTED BY OTHERS. FIELD ENGINEER IS TO DETERMINE THE TYPE OF SUBGRADE TREATMENT WHICH IS TO BE USED. SUBGRADE TREATMENT MAY CONSIST OF LIME TREATED SUBGRADE, CEMENT TREATED SUBGRADE, RE-COMPACTION OF EXISTING SUBGRADE MATERIAL AS SPECIFIED IN STANDARD SPECIFICATIONS, OR ANY COMBINATION OF THESE. CONTRACTOR TO GRADE SUNNYBROOK ON THE WEST SIDE OF RICHMOND TO MATCH NEW PAVEMENT AS DETERMINED BY ENGINEER. CONTRACTOR TO GRADE SOUTHGATE AND SUNNYBROOK ON THE EAST SIDE OF RICHMOND TO MATCH NEW PAVEMENT AND SO THAT WATER WILL DRAIN FROM PAVEMENT TO DITCH ALONG THE WEST SIDE OF MERIDIAN AS DETERMINED BY THE ENGINEER. FIELD ENGINEER TO TAKE CROSS-SECTIONS AS NECESSARY ON THESE SIDEROADS SO THAT THE EARTHWORK QUANTITIES MAY BE DETERMINED.

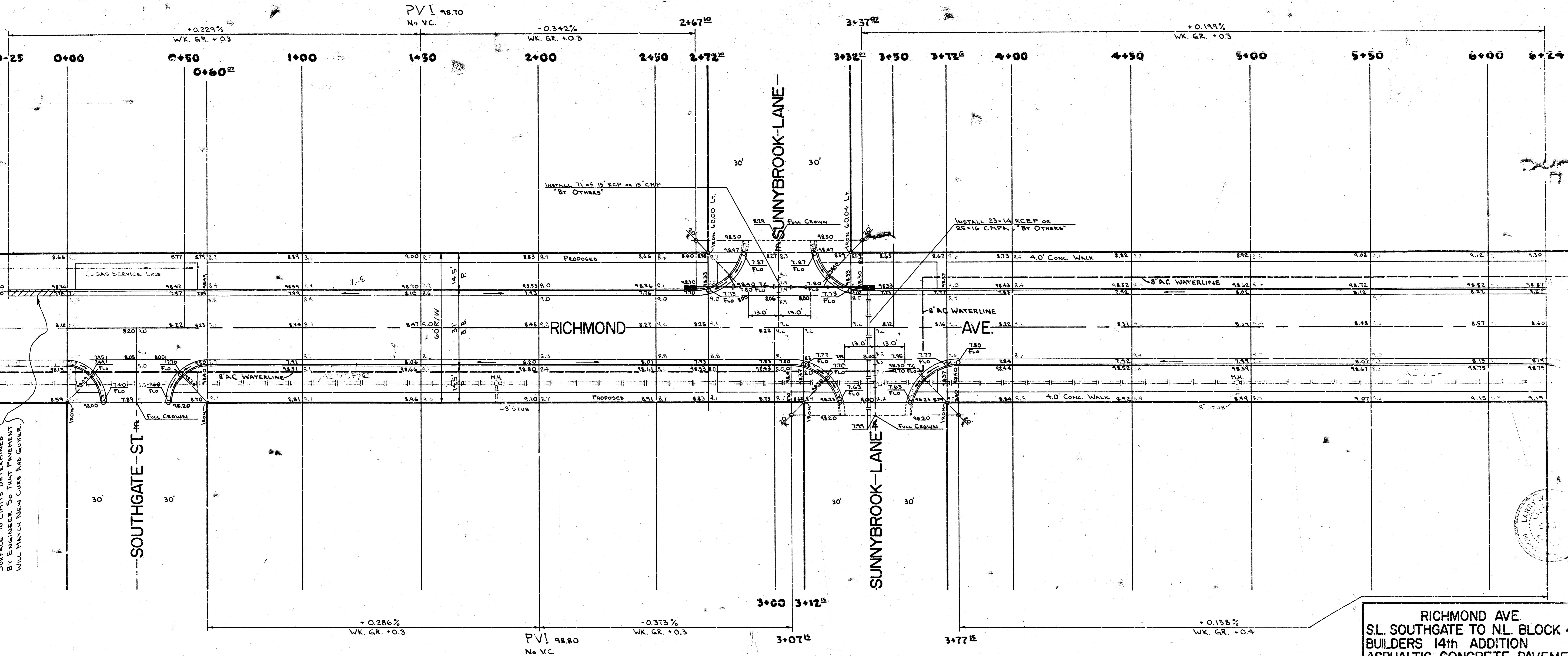
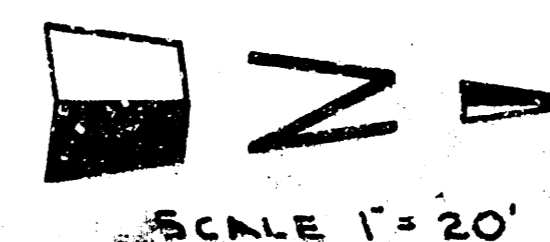

SURFACE TO LIMITS DETERMINED BY ENGINEER. SO THAT PAVEMENT WILL MATCH NEW CURB AND GUTTER.

■ DENOTES 2'x5' STB. INLET "BY OTHERS"

~EARTHWORK~

EXCAVATION PROP	824.3	Cu. Yds.	EXCAVATION CITY	225.2	Cu. Yds.
+10%	82.4	Cu. Yds.	+10%	22.5	Cu. Yds.
TOTAL	906.7	Cu. Yds.	TOTAL	247.7	Cu. Yds.

NOTE: ESTIMATED 350 CU. YDS. EXCAVATION FOR EARTHWORK ON SIDEROADS

RICHMOND AVE.  
S.L. SOUTHGATE TO N.L. BLOCK 4  
BUILDERS 14th ADDITION  
ASPHALTIC CONCRETE PAVEMENT  
3' B-B WITH COMB. CB. & GTR.

CITY OF WICHITA, KANSAS  
R. W. LINN CITY ENGINEER  
PROJ. NO. DAKS 569056  
DATE: Dec. 1973