

CITY OF WICHITA, KANSAS

MICHAEL E. LINDEBAK, P.E., CITY ENGINEER

RIDGE ROAD PAVING IMPROVEMENTS

IN

CROWN CHASE APARTMENTS

PRIVATE PROJECT NO. 110PPP

INDEX CODE 607879

ROSS ENGINEERING, INC.
 445 M Street
 Suite 201
 Lincoln, NE 68508
 Phone 402-271-2020
 Fax 402-271-2020

Scale	None
Drawn	LEF
Checked	TEH
Approved	TAB

Job # 988-1D
 Title 8880.CS4
 Date 12/3/97
 Issue 4/10/98

GENERAL NOTES

- The Contractor is specifically cautioned that the location and/or elevation of existing utilities as shown on these Construction Drawings are based upon records of the various utility companies. This information is not to be relied upon as being exact or complete. It shall be the responsibility of the respective Contractor to notify ONE-CALL at (316) 687-2470, a minimum of 48 hours in advance of any excavation to request the exact field locations of the existing underground utilities. It shall be the responsibility of the respective Contractor to relocate all existing utilities which conflict with the proposed improvements as shown on the Construction Drawings.
- The Contractor must notify the following in case of an emergency:

Cablevision	(316) 262-4270 or (316) 263-2061
KGE - Gas	(316) 263-7511
KGE - Electric	(316) 264-1141
Peoples Natural Gas	(316) 942-8350 or (316) 263-8161
Southwestern Bell Telephone Co.	1-(316) 571-2611
City of Wichita Water Department	(316) 268-4908
City of Wichita Sewer Maintenance	(316) 268-4071
- City of Wichita Benchmark:
 Brass Cap in Northeast corner of Concrete Headwall
 Approximately 675' North of Intersection of Silver
 Spring Blvd. and Ridge Road.
 Elevation: 1317.54 (U.S.G.S. Datum)
 130.14 (City of Wichita Datum)
- Preliminary Surveys: ROSS ENGINEERING, INC.
- Trench excavation and backfill shall be mechanically tamped and tested. Compaction requirements shall be in accordance with the Sitework Specifications.
- Cost of barricades, flashers and all items necessary for safe and efficient movement of traffic shall be considered subsidiary to the construction of the pavement and utilities.
- The Contractor shall use extreme caution in the area of existing trees which are to remain, existing manholes, power poles, fences, pavement and utilities, and shall be responsible for any damages.
- It will be the Contractor's responsibility to inform the Engineer of any control points including street centerline and lot corners that may be destroyed during construction so that these points may be offset. The cost of resetting points that have not been offset will be paid for by the Contractor. Requests for offsets must be made 48 hours in advance.
- Horizontal Control for the improvements in Ridge Road are based on CL stationing with 0+00 being at the intersection of Ridge Road and Silver Springs Boulevard

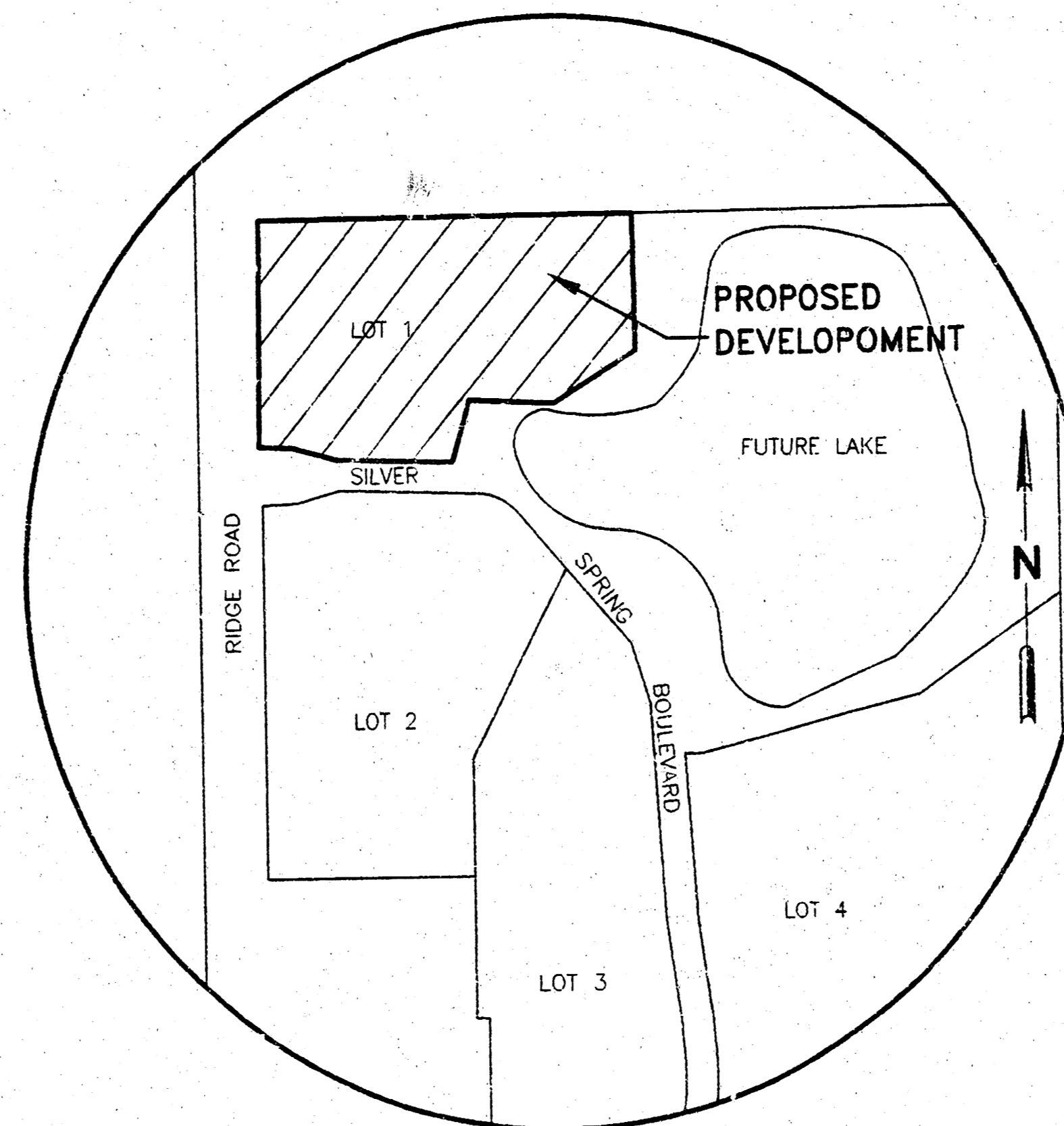

SHEET INDEX

	NO.
Public Construction	
COVER SHEET	1 of 3
PAVING REMOVAL PLAN	2 of 3
PAVING IMPROVEMENT PLAN	3 of 3

APPROVED AS NOTED
BY CITY ENGINEER OF WICHITA

Sanitary Sewers _____

Storm Sewers _____

Driveways/Approaches _____

Water Mains _____

Paving VRH 4/13/98

NOTE TO CONTRACTORS

PUBLIC PROPERTY: Inspection and testing for the Waterline is to be provided by a Licensed Consulting Engineering Firm under contract with the records of the Owner/Developer. Said inspection to be in accordance with the City of Wichita standard construction engineering practices and certified by a Licensed Professional Engineer. No work shall be performed in dedicated easements or public right-of-way by the Contractor without such inspection nor shall any work be commenced without written authorization by the City Engineer. All construction and materials shall comply with the City of Wichita Specifications and Standards (on file and available in the City Engineer's Office.

ENGINEER'S CERTIFICATE

I hereby certify that these Construction Drawings were prepared by me or under my direct supervision and that I am a Registered Professional Engineer under the laws of the State of Kansas. These Construction Drawings meet the requirements of subdivision approval and the City Engineer's Office design requirements as they apply to construction at the time of this certificate.

Tom A. Brown 4/9/98
Date

PROJECT INSPECTED BY
BAUGHMAN COMPANY P.A.
APRIL 7 1998
BAUGHMAN COMPANY P.A.

COVER SHEET
 CROWN CHASE
 RIDGE ROAD & SILVER SPRING BOULEVARD
 WICHITA, KANSAS

Sheet No.
1 OF 3

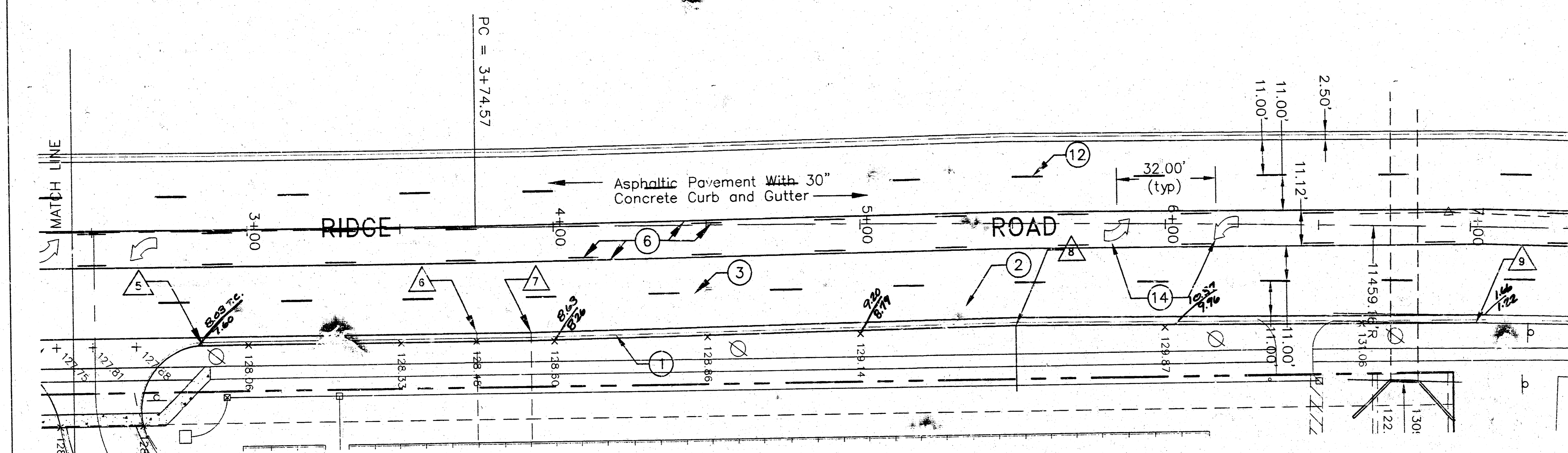
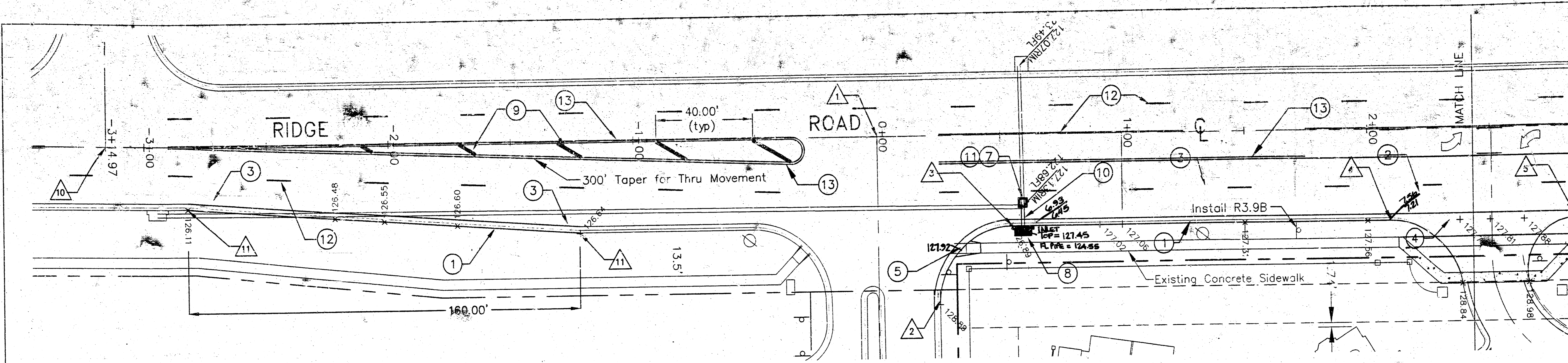

SCHEDULE OF APPROX. QUANTITIES

DESCRIPTION	UNITS	QUANT.
30" Concrete Curb and Gutter	LF	781
6" Asphalt Base Course w/2" Asphalt Overlay	SY	629
Replace 2" Asphalt Overlay	SY	79
6" Concrete w/ Integral Curb	SF	1103
Convert Existing Curb Inlet to Manhole	Ea	1
Construct Curb Inlet w/ Salvaged Top	Ea	1
15" RCP Storm Sewer Pipe	LF	8
Tap Storm Sewer Manhole	Ea	1

KEY STATIONS AND DESCRIPTIONS

NO.	STATION/OFFSET	DESCRIPTION
1	0+00.00 / 0.00' RL	Intersection of Ridge Road & Silver Springs Blvd.
2	0+24.86 / 64.23' RL	Match Existing Curb / End Of Return
3	0+54.86 / 35.54' RL	End Of Return
4	2+05.06 / 35.54' RL	South End Of Return (Driveway)
5	2+84.95 / 35.54' RL	North End Of Return (Driveway)
6	3+74.57 / 35.54' RL	PCHC
7	3+92.28 / 35.54' RL	PTHC
8	5+51.15 / 31.91' RL	Curb Deflection 178'37"12" RL
9	7+02.13 / 30.00' RL	Match Curb Line
10	-3+14.97 / 0.00' RL	Intersection
11	-2+81.99 / 24.50' RL	Pavement Deflection 178'03'00" RL
12	-1+21.99 / 35.54' RL	Pavement Deflection 178'03'00" LL

West Curb Curve Data
 Included Angle: 00°25'15"19"
 Radius: 11,831.66'
 Tangent: 8.83'
 Length: 17.57'
 Chord: 17.57'

NOTES

- All pavement markings to be cold plastic per K.D.O.T. specification.
- City of Wichita Benchmark:
 Brass Cap in Northeast corner of Concrete Headwall
 Approximately 675' North of Intersection of Silver Spring Blvd. and Ridge Road.
 Elevation: 1317.54 (U.S.G.S. Datum)
 130.14 (City of Wichita Datum)

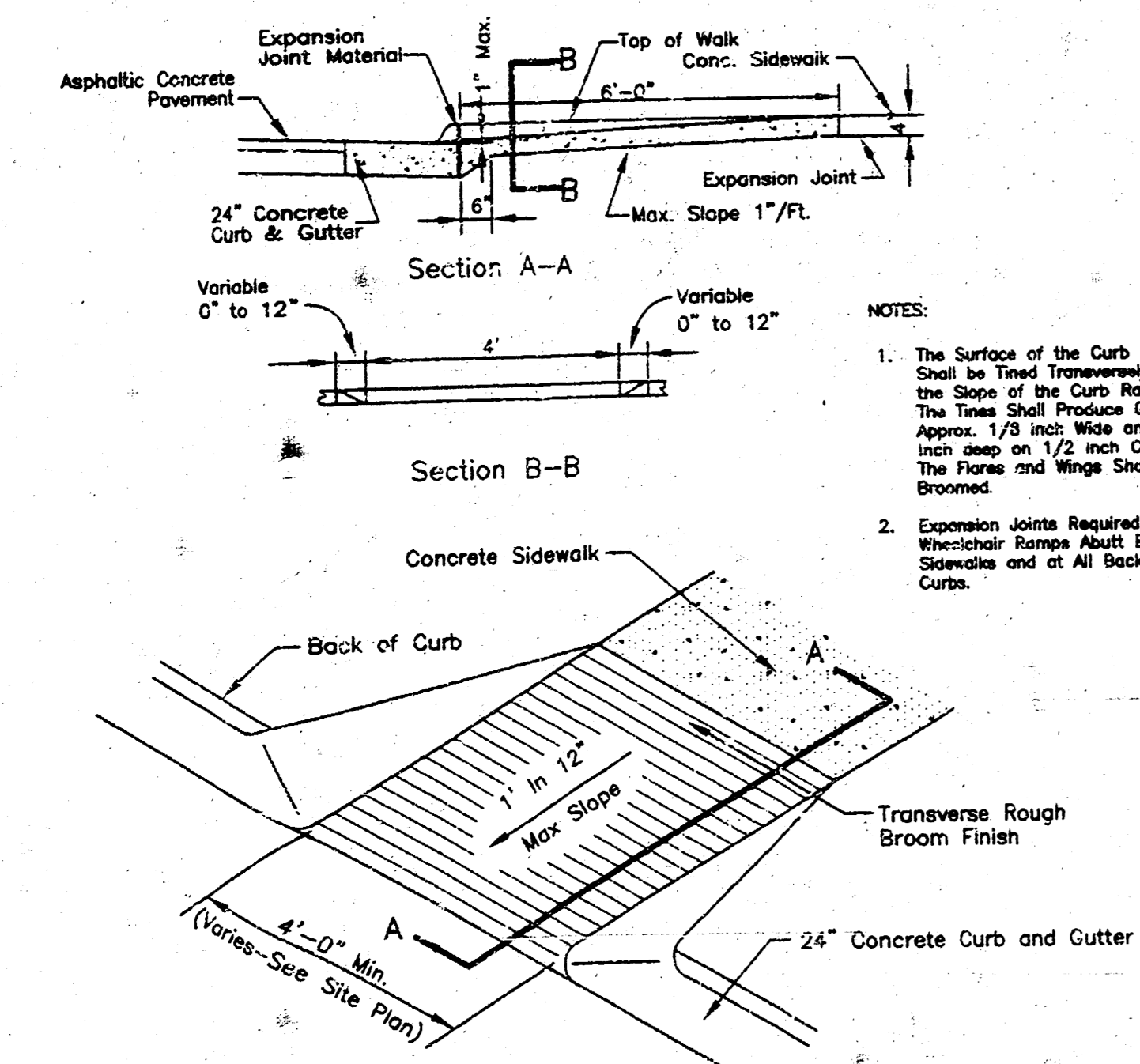

HANDICAP SIDEWALK RAMP
NO SCALE

- NOTES**
- See Miscellaneous Details for details of Dumpster Pads. Cost will include work for all concrete, including 6" Pad, 4" Sidewalk, Wood Post with Concrete Footings, and 6" bollards.
 - Dumpster Pads will be constructed at same time as Concrete Curb and Gutter and pavement base course.

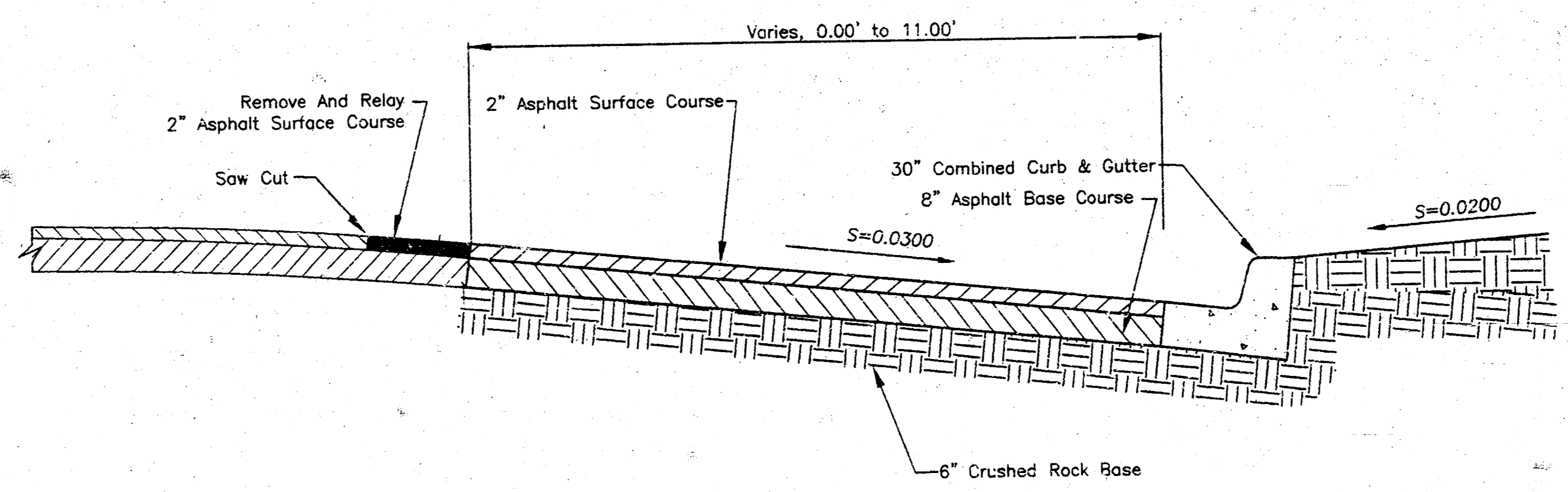
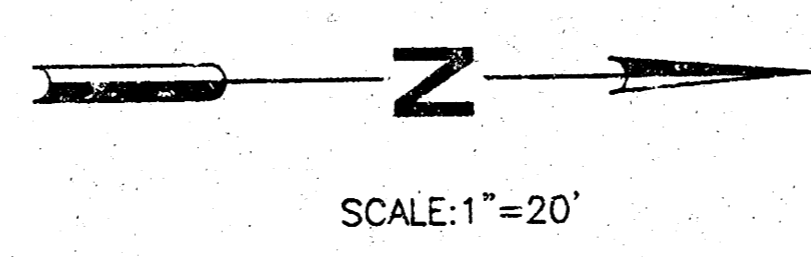

TYPICAL PAVEMENT CROSS SECTION
NO SCALE

LEGEND

- ① 30" Concrete Curb and Gutter (Typ.)
- ② 6" Asphalt Base Course w/2" Asphalt Surface Course (Typ.)
- ③ Replace 2" Asphalt Asphalt Surface Course (Typ.)
- ④ 6" Concrete w/Integral Curb (Typ.)
- ⑤ Handicap Ramp (Typ.)
- ⑥ 4" Yellow Cold Plastic Striping (Typ.)
- ⑦ Convert Existing Curb Inlet To Manhole, Complete
- ⑧ Storm Sewer Curb Inlet w/ Salvaged Top (TC Elev.=126.89 FL(15")=123.64)
- ⑨ 12" Yellow cold Plastic Stripe
- ⑩ Construct 8LF- 15" RCP Storm Sewer @ S=0.07100
- ⑪ Tap Storm Sewer Manhole FL(15"): 122.93
- ⑫ 6" White Cold Plastic Stripe
- ⑬ 4" Double Yellow Cold Plastic Stripe
- ⑭ White Left-Turn Arrow Symbol Marking

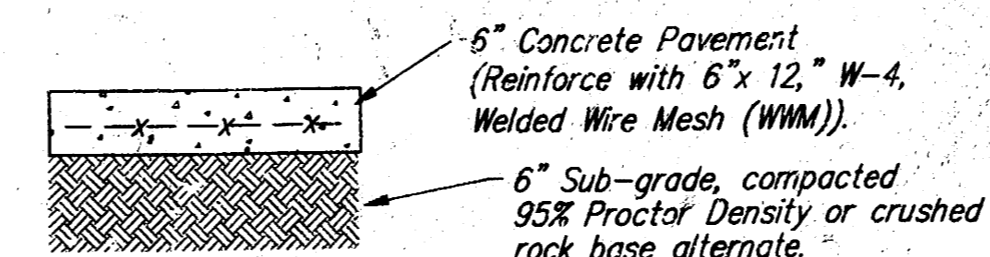
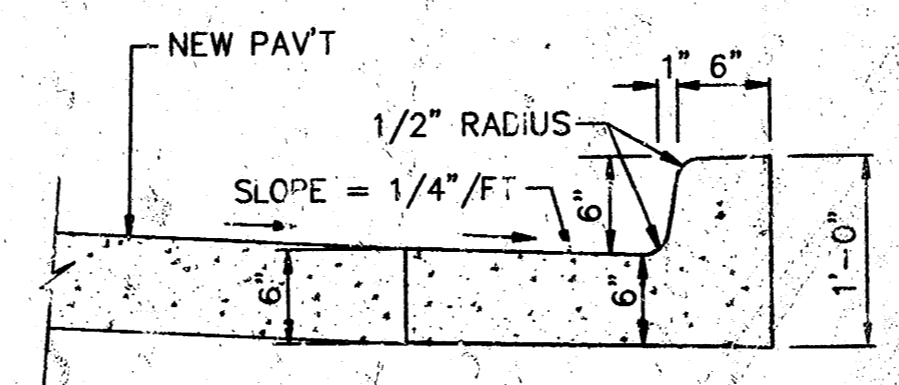
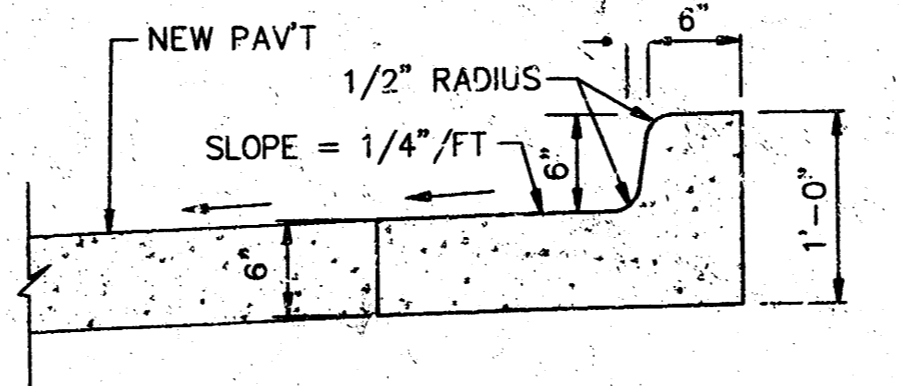
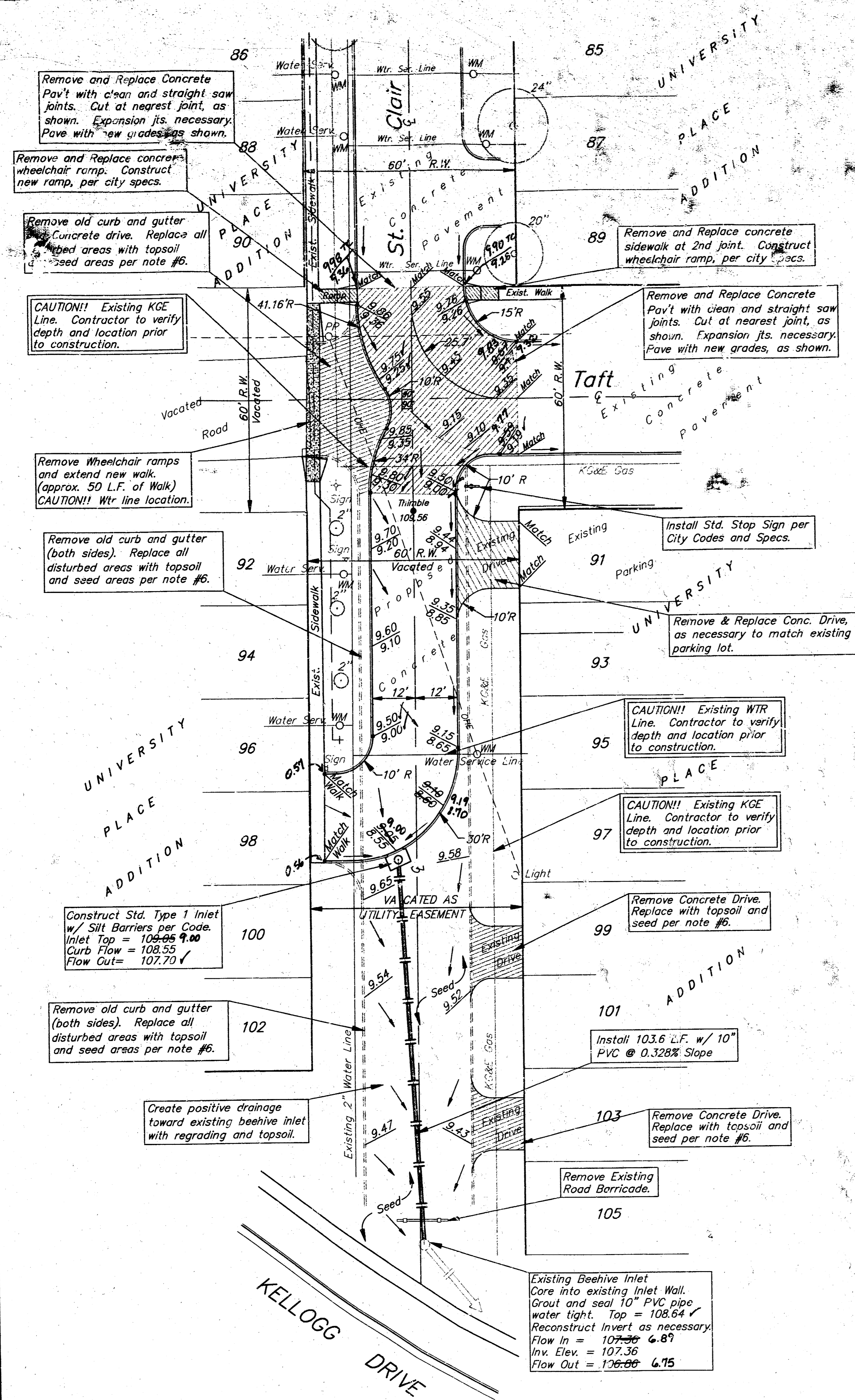

SITE NOTES:

- Contractor will be required to provide notice to utility companies a minimum of twenty-four (24) hours prior to any excavation, as follows:
 Kansas One-Call 687-2470
 The Contractor must notify the following in case of an emergency:
 Cablevision 262-4270
 K.P.L. Gas Service Company 263-2061
 Kansas Gas & Electric Company 383-8650
 Southwestern Bell Telephone Company 1-571-2611
- Exist. utilities and their locations, as shown on the plans, represent the best information obtainable for design. Location information has been obtained from the various utility companies and is either from company record drawings or company-provided field locations. The Contractor will be required to work around existing utilities which do not conflict with proposed construction.
- Traffic affected by the construction on this project shall be handled in accordance with the latest edition of the Manual on Uniform Traffic Control Devices.
- All dimensions shown on plans are from face-of-curb to face-of-curb, unless noted otherwise.
- The Contractor to verify utility locations prior to construction of this project.
- All disturbed areas and areas called out on the plan as "Seed" shall be seeded and fertilized as follows:
 SEED—
 Kansas Premium Fescue Blend 6-8#/1000 sq. ft. (equal parts of Olympic II, Bonanza, Apache, and Monarch)
 FERTILIZER—
 16-20-6 ratio 4#/1000 sq. ft.
- Signaling and striping shall be installed in accordance with City of Wichita Specifications and Codes. Striping shall be painted markings in conformance with the latest edition of the Standard Specifications for State Road and Bridge Construction by the Kansas Department of Transportation.
- Excess excavation material and other debris shall be wasted on sites to be provided by the Contractor as approved by the Engineer at no additional cost to the Owner.
- Trees and shrubs in public right-of-way which are in direct conflict with proposed new construction shall be removed by the Contractor with the Engineer's approval. Trees and shrubs which are not in direct conflict with proposed new construction shall be saved and protected from damage.
- It shall be the responsibility of the Contractor to satisfy himself as to the existence of unusual subsurface conditions, and to allow for such conditions in his bid.
- G.C. shall coordinate with Friends University for possible future sleeves under concrete drive. Contractor to verify locations with Friends University Plans for exact location of sleeves. Contact Paul Winchester at 295-5836.
- Separate permit may be required for new drive approach on St. Clair and Taft Streets. Construct per City Specs.
- Proposed 10" Storm Water Sewer Line will need to be reviewed and permitted through the Office of Central Inspection (O.C.I.) on the 7th Floor of the City Building prior to construction. Contact Taylor Levin (Plan Review) at 268-4461.

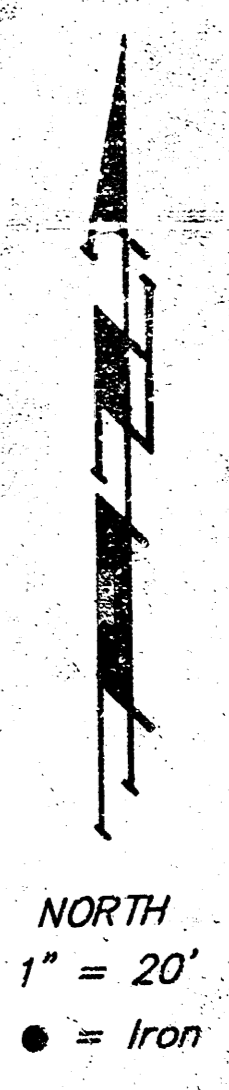

APPROVED AS NOTED
 BY CITY ENGINEER OF WICHITA

Paving URH 7/27/98

NOTE TO CONTRACTORS

Inspection and testing for this project is to be provided by a Licensed Consulting Engineering Firm under contract with the Owner/Developer. Said inspection to be in accordance with the City of Wichita standard construction engineering practices and certified by a Licensed Professional Engineer. No work shall be performed in dedicated easements or public right-of-way by the Contractor without such inspection nor shall any work be commenced without written authorization by the City Engineer. All Construction and Materials shall comply with the City of Wichita Specifications and Standards (on file and available in the City Engineer's Office).

Booked
 9-22-01
 MCG
 D-354

SITE BENCHMARKS:

- Cut in Top of Curb 2' East of East End of Return Located 20.7' South of Centerline of Maple and 28.0' East of Centerline of St. Clair.
 Elevation = 111.47 City Datum
- Cut in Top of Curb at South End of Return Located 26.3' South of Centerline of Mentor and 15.6' West of Centerline of St. Clair.
 Elevation = 112.02 City Datum
- Cut in Top of Curb at East End of Return Located 15.5' South of Centerline of Taft and 31.7' East of Centerline of St. Clair.
 Elevation = 109.78 City Datum

PROTECT INSPECTED BY BAUGHMAN
 ASBUILT 9/29 BAUGHMAN COMPANY, P.A.

ST. CLAIR STREET IMPROVEMENTS
SITE PLAN
 FRIENDS UNIVERSITY

BAUGHMAN COMPANY P.A.
 ENGINEERING, SURVEYING, & PLANNING
 316-202-7221 • 315 ELLIS • WICHITA, KANSAS 67211

PROJECT NUMBER
 Private Project: 113 PPP (607879)

DESIGN	DRAWN	APPROVED	DATE	SCALE
NBW	JL	NWB	7-15-98	1"=20'

SHEET 1 OF 1

10 40 19