

B.M. 20641 6" in S. 6166 W. Ch. Ridgewood, S.L. 922  
 B.M. 20704 6" in 6166 S. End Rad. E. Ch. Parkwood, S.L. 922

Property  
 247.6  
 188.7  
 83.8  
 41.8  
 49.9  
 48.6  
 55.6  
 52.8  
 50.4  
 50.4  
 49.0  
 741.4  
 1122  
 1390.4 @ 26'

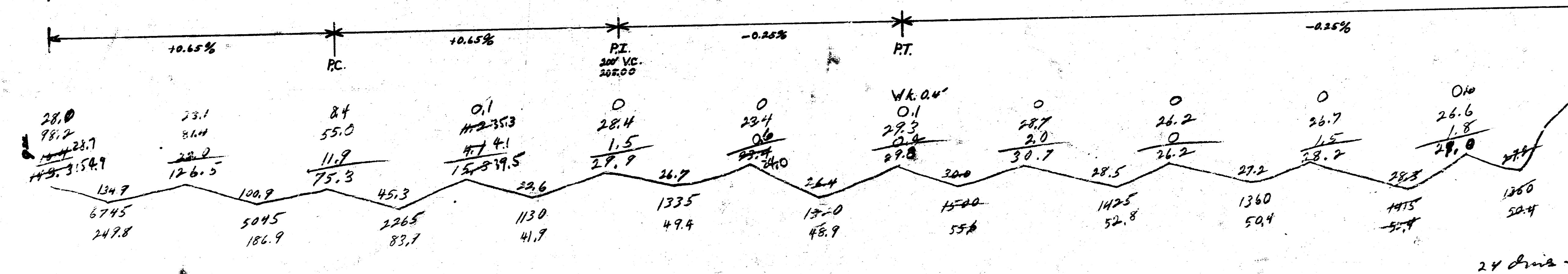
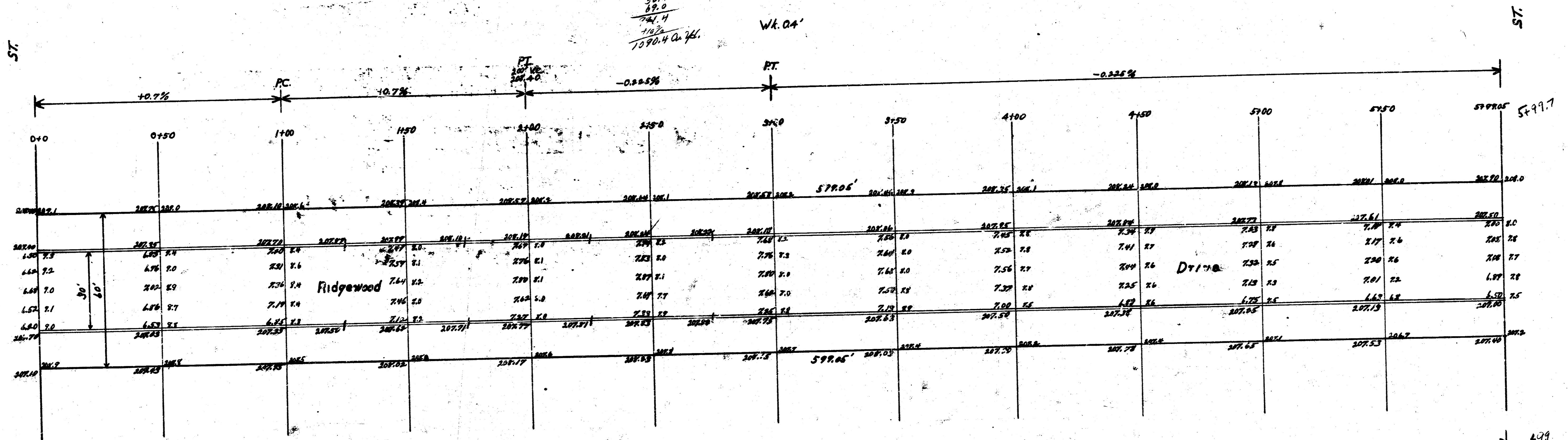
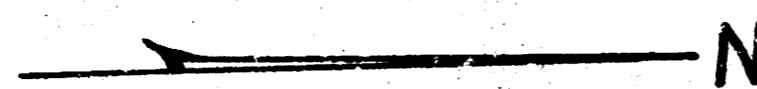

$\frac{0}{26.0}$   
 $\frac{422}{43.3}$   
 $\frac{380}{186.2}$   
 $\frac{422}{67.0}$   
 $\frac{422}{49.9}$   
 $\frac{422}{102}$   
**Ridgewood Drive**  
 N.L. 922 S.L. 1022  
 90' Conc. Cb.  
 City of Wichita, Kansas  
 L.K. White City Engineer  
 February 1948 Project C18-7  
 24' Curb