

BM=126.67 R.R. Spike S.Side P.Pole on N.Side 21st ST. @ River Park Drive
 BM=125.53 R.R. Spike N.Side P.Pole on S.Side River Park Dr. Approximately 152' W.W.L Hyacinth

NOTE: ROLL CURB ENTIRE PROJECT

Dirt will be furnished to this project from other construction projects for fill.
 The parkings will be graded to the elevations shown on the plans.

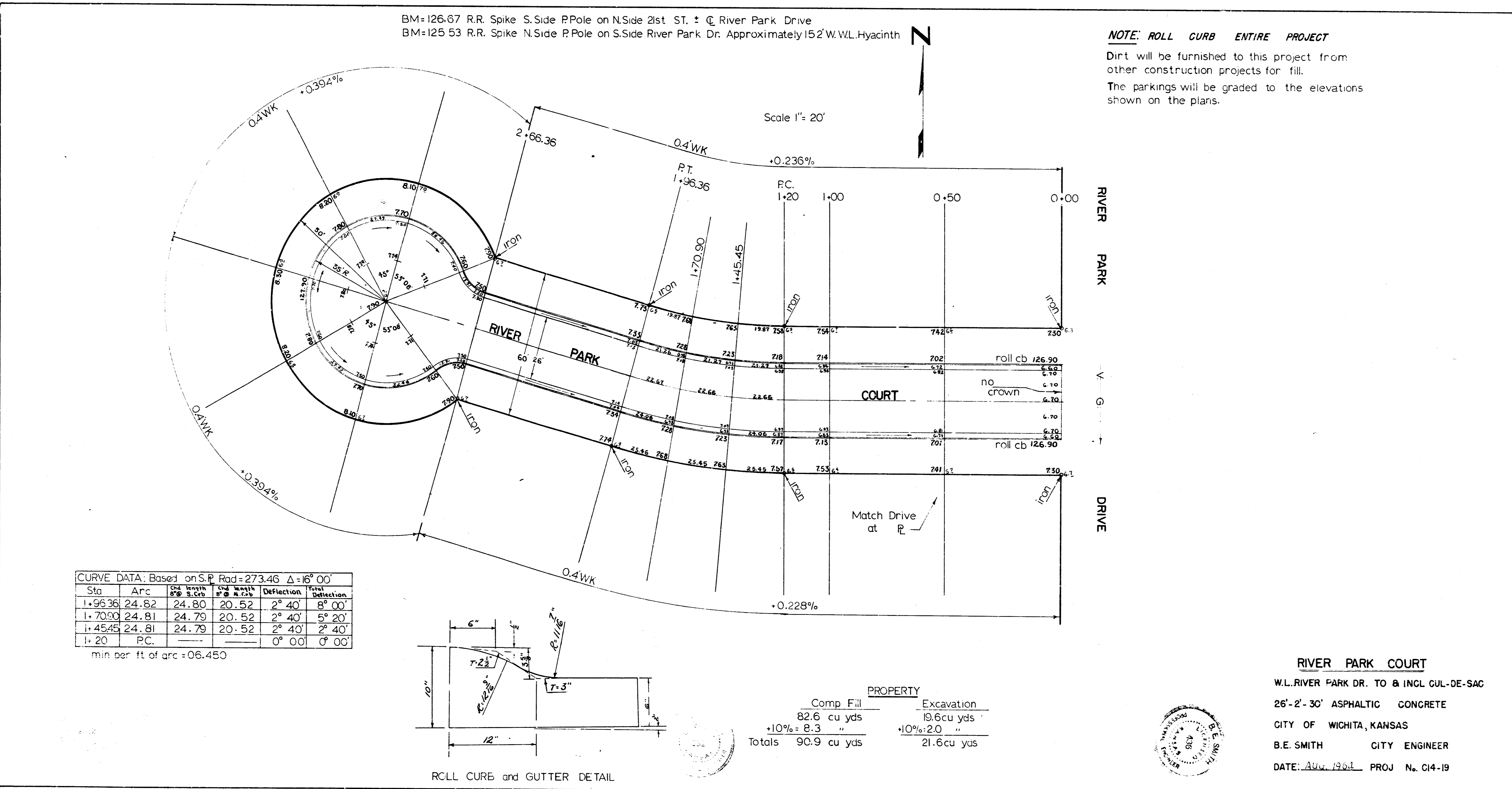

Client's Allocation

CURVE DATA: Based on S.P. Rad=273.46 Δ=16° 00'

Sta	Arc	Chord Length	Chord S. Chord	Chord N. Chord	Deflection	Total Deflection
1+96.36	24.62	24.80	20.52	2° 40'	8° 00'	
1+70.00	24.81	24.79	20.52	2° 40'	5° 20'	
1+45.45	24.81	24.79	20.52	2° 40'	2° 40'	
1+20	P.C.			0° 00'	0° 00'	

min per ft of arc = 06.450

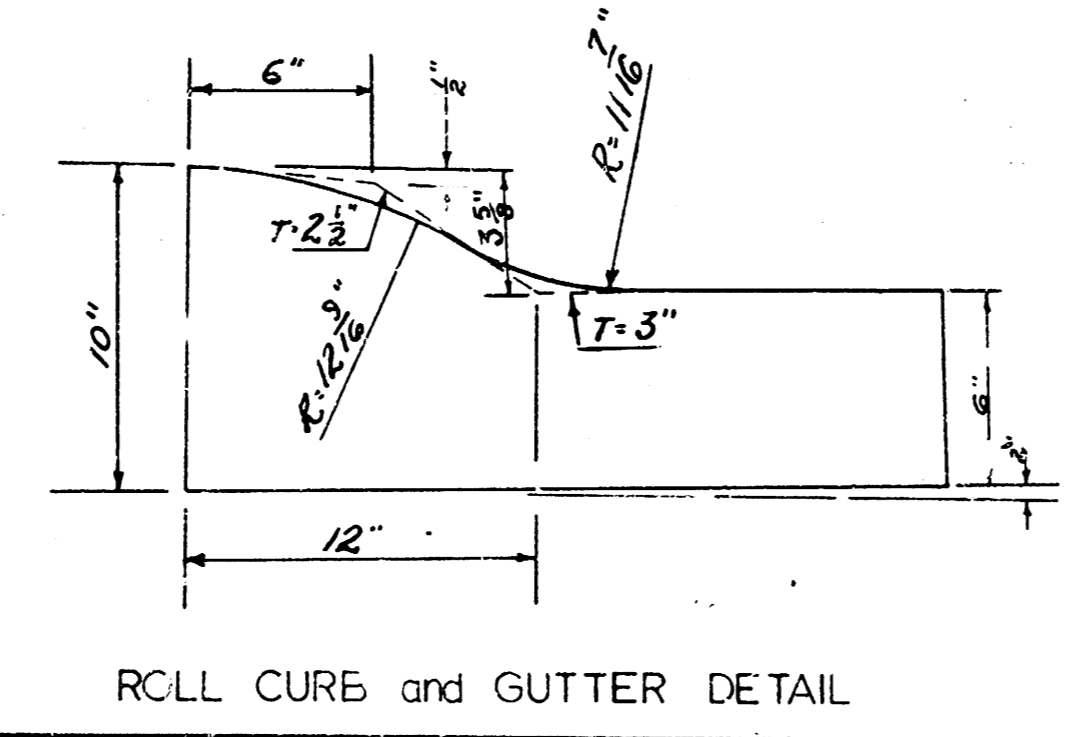

PROPERTY	
Comp Fill	Excavation
82.6 cu yds	19.6 cu yds
+10% = 8.3 "	+10% = 2.0 "
Totals 90.9 cu yds	21.6 cu yds



RIVER PARK COURT
 W.L. RIVER PARK DR. TO & INCL CUL-DE-SAC
 26'-2'-30' ASPHALTIC CONCRETE
 CITY OF WICHITA, KANSAS
 B.E. SMITH CITY ENGINEER
 DATE: Aug 1961 PROJ No. C14-19