

B.M. 154.49 R.R. Spk. in RR East Side Rock Road
and South Line Funston extended East.

Proposed Farmers Insurance
Building

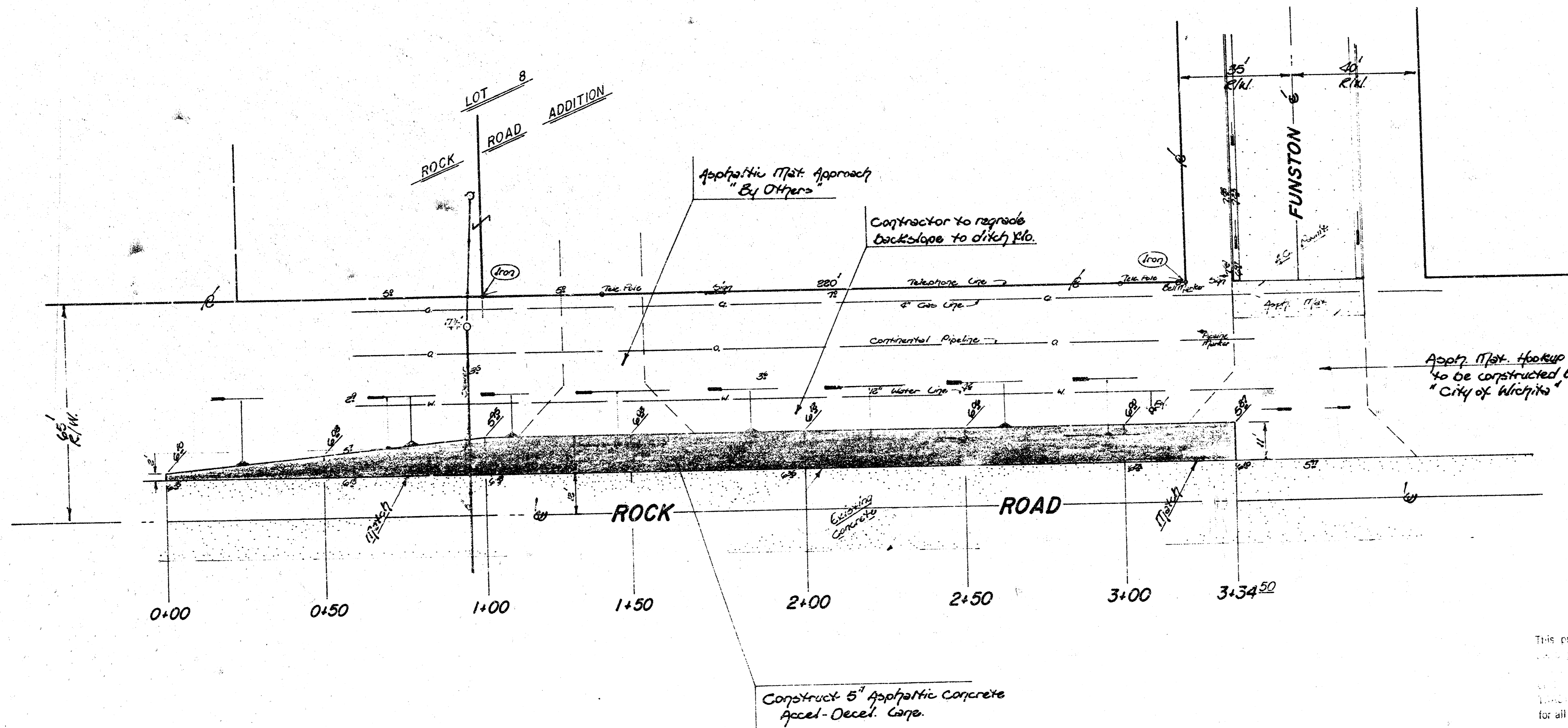

Scale: 1" = 20'



APPROVED AS SHOWN
BY THE CITY OF WICHITA
DATE: 4-8-82

CITY OF WICHITA
ENGINEER: [Signature]
DATE: 4-8-82

NOTE TO CONTRACTOR
This project is to be
constructed in accordance
with the City of Wichita
Specifications for
Roadway Construction
for all costs of inspection.



TEMPORARY ACCEL-DECAL LANE TO SERVE
LOT 8, ROCK ROAD ADDITION.
CITY OF WICHITA, KS.
PROJECT NO.
472-76-245-80000-000-000-008

BAUGHMAN COMPANY, P.A.
SURVEYING & ENGINEERING
316/262-7271 • 330 LAURA • WICHITA, KANSAS 67211

FILMED FROM THE BEST
AVAILABLE COPY

B.M. 154.99 RR Spk. in P.P. East Side Rock Road
and South Line Funston extended East.

Proposed Farmers Insurance
Building



Scale: 1" = 20'

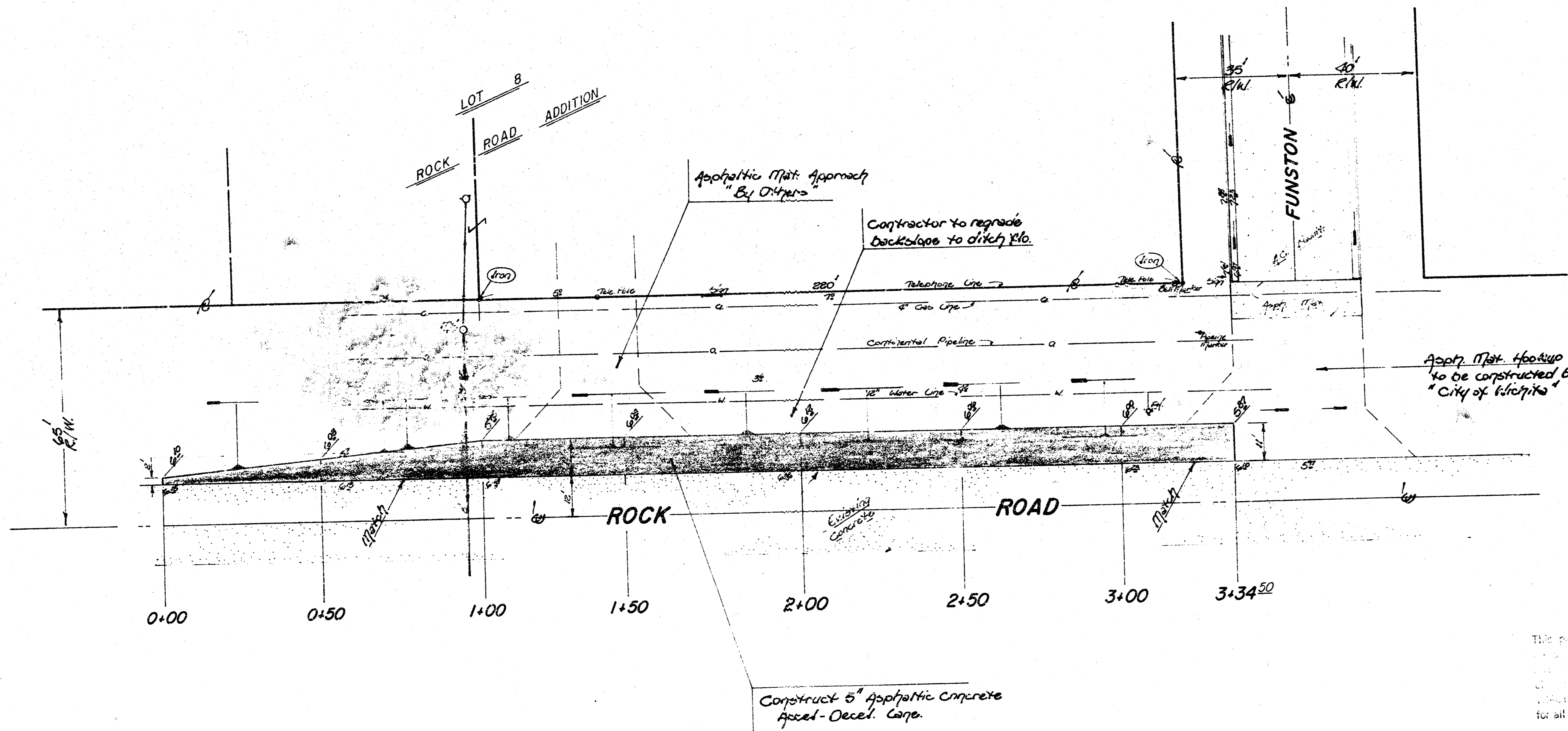

APPROVED FOR THE CITY OF WICHITA
 CITY ENGINEER
 DATE
 PROJECT NO.
 Highway Approach: 4-8-82

NOTE TO CONTRACTOR
 This project is to be completed by the contractor for all costs of completion.

CITY OF WICHITA
 APPROVED: [Signature]
 DATE: 4-8-82
 Engineering Div. [Signature]



TEMPORARY ACCEL-DECEL LANE TO SERVE
 LOT 8, ROCK ROAD ADDITION.
 CITY OF WICHITA, KS.
 PROJECT NO.
 472-76-245-80000-000-000-008

BAUGHMAN COMPANY, P.A.
 SURVEYING & ENGINEERING
 316/262-7271 • 330 LAURA • WICHITA, KANSAS 67211

2/4

FILMED FROM THE BEST AVAILABLE COPY....

B.M. 154.99 R.R. Spk. in RR East Side Rock Road
and South Line Funston extended East.

Proposed Farmers Insurance
Building

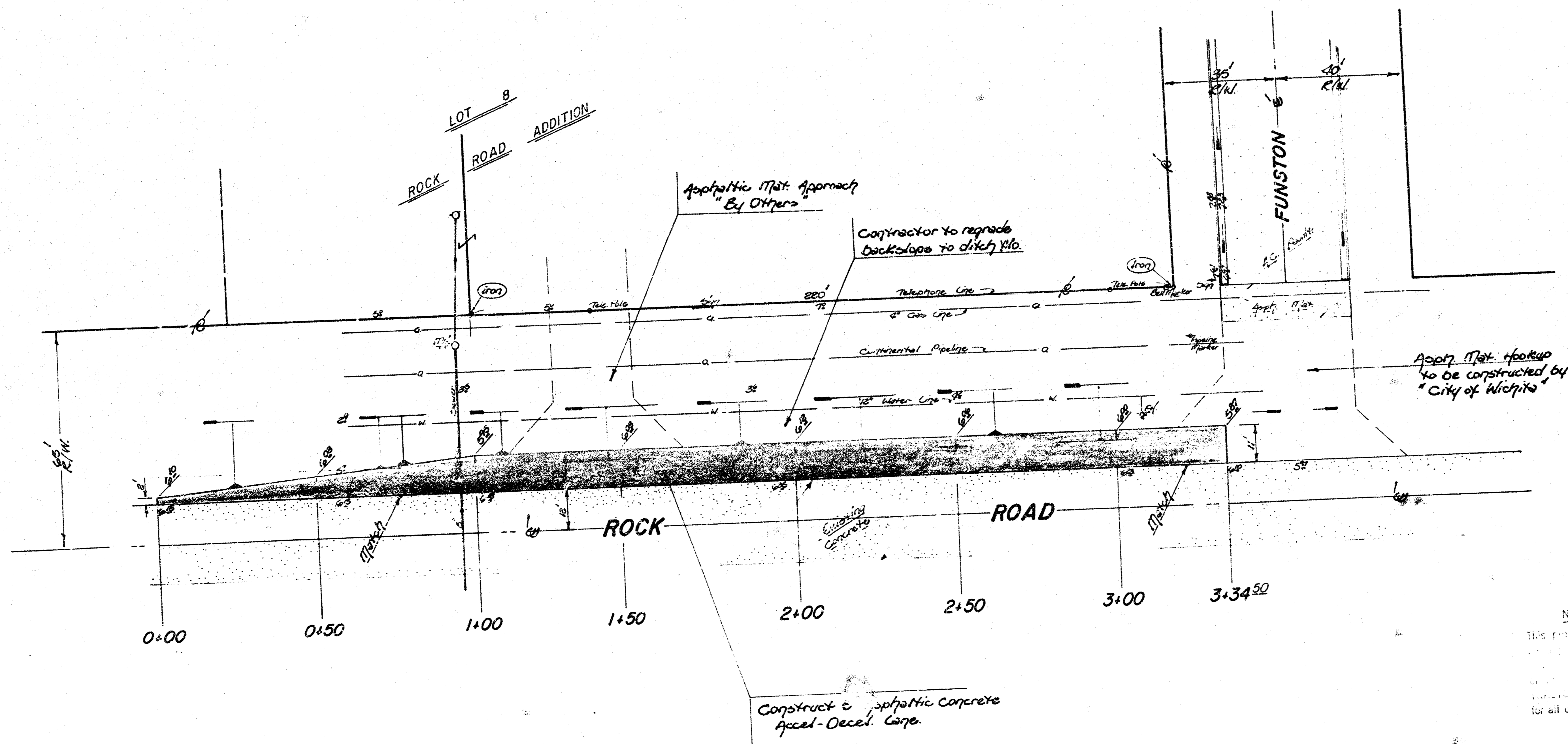
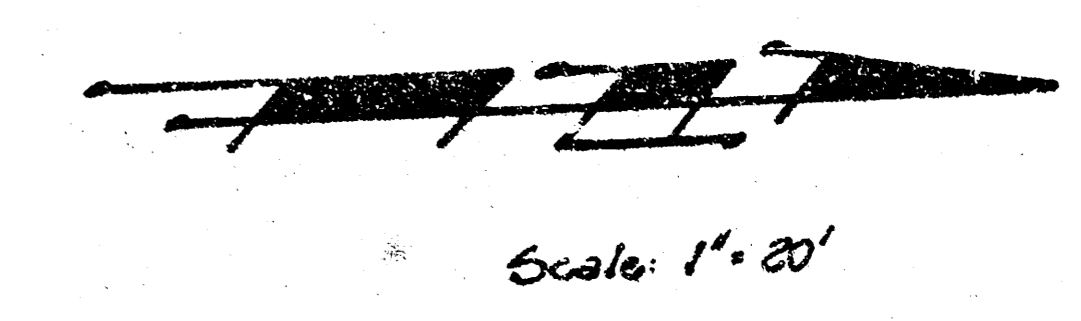

APPROVED AS NOTED
BY CITY ENGINEER J. W. LIGHTA
CITY OF WICHITA
Storm Sewer
Cityway Approaches 4-1-82

NOTE TO CONTRACTOR
This drawing is to be used for construction of the project shown. It is the responsibility of the contractor to verify all dimensions and conditions on the ground before construction. For all parts of inspection.

CITY OF WICHITA
APPROVED: APPROVED AS NOTED
DATE: 4-1-82
ENGINEERING BY: [Signature]



TEMPORARY ACCEL-DECEL LANE TO SERVE
LOT 8, ROCK ROAD ADDITION.
CITY OF WICHITA, K.S.
PROJECT NO.
472-76-245-80000-000-008

BAUGHMAN COMPANY, P.A.
SURVEYING & ENGINEERING
316/262-7271 • 330 LAURA • WICHITA, KANSAS 67211

FILMED FROM THE BEST
AVAILABLE COPY....

THIS DRAWING IS THE PROPERTY OF THE CITY OF WICHITA

TEMPORARY ACCEL-DECEL LANE TO SERVE
LOT 8, ROCK ROAD ADDITION,
CITY OF WICHITA, KS
PROJECT NO.
472-76-245-80000-000-000-008
BAUGHMAN COMPANY, P.A.
SURVEYING & ENGINEERING
1212 W. 10TH ST. WICHITA, KS 67202

APPROVED AS NOTED
BY CITY ENGINEER OF WICHITA
Sanitary Sewers
Storm Sewers
Driveway Approaches
11-22-21
CITY OF WICHITA
APPROVED: Approved does not release the contractor from any responsibility for the work shown on this drawing. The contractor shall be responsible for obtaining all necessary permits and approvals from the City of Wichita. The contractor shall be responsible for obtaining all necessary permits and approvals from the City of Wichita.

NOTE TO CONTRACTOR
This project will be constructed under the supervision of the City Engineer of Wichita. The contractor shall be responsible for obtaining all necessary permits and approvals from the City of Wichita. The contractor shall be responsible for obtaining all necessary permits and approvals from the City of Wichita.

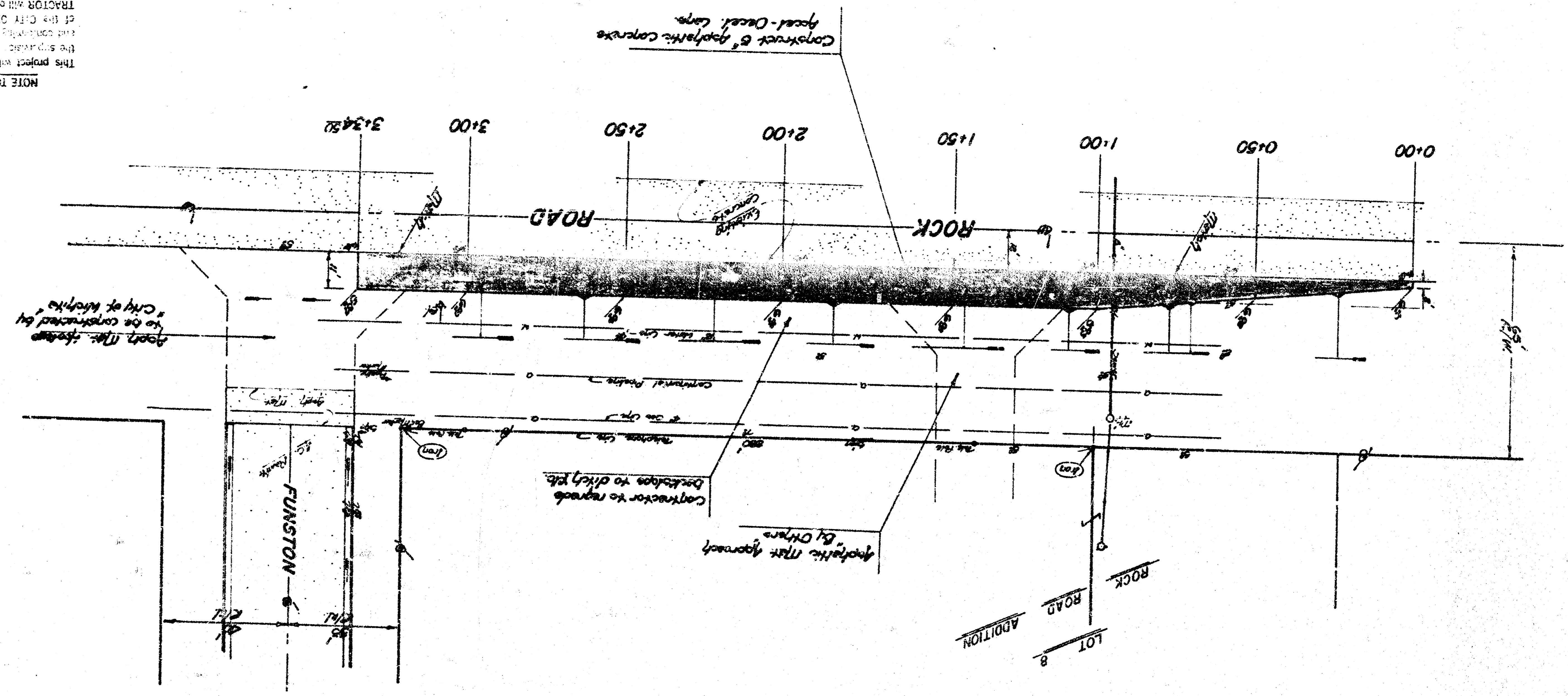

B.M. Station E.E. Gate on RR East Side Rock Road
and South Lane Funston extended east.

Scale: 1" = 20'