

STATE	PROJECT	DATE	BY
KANSAS	NO.		

**GRADING, CULVERTS &
SUBGRADE STABILIZATION,
SURFACING**

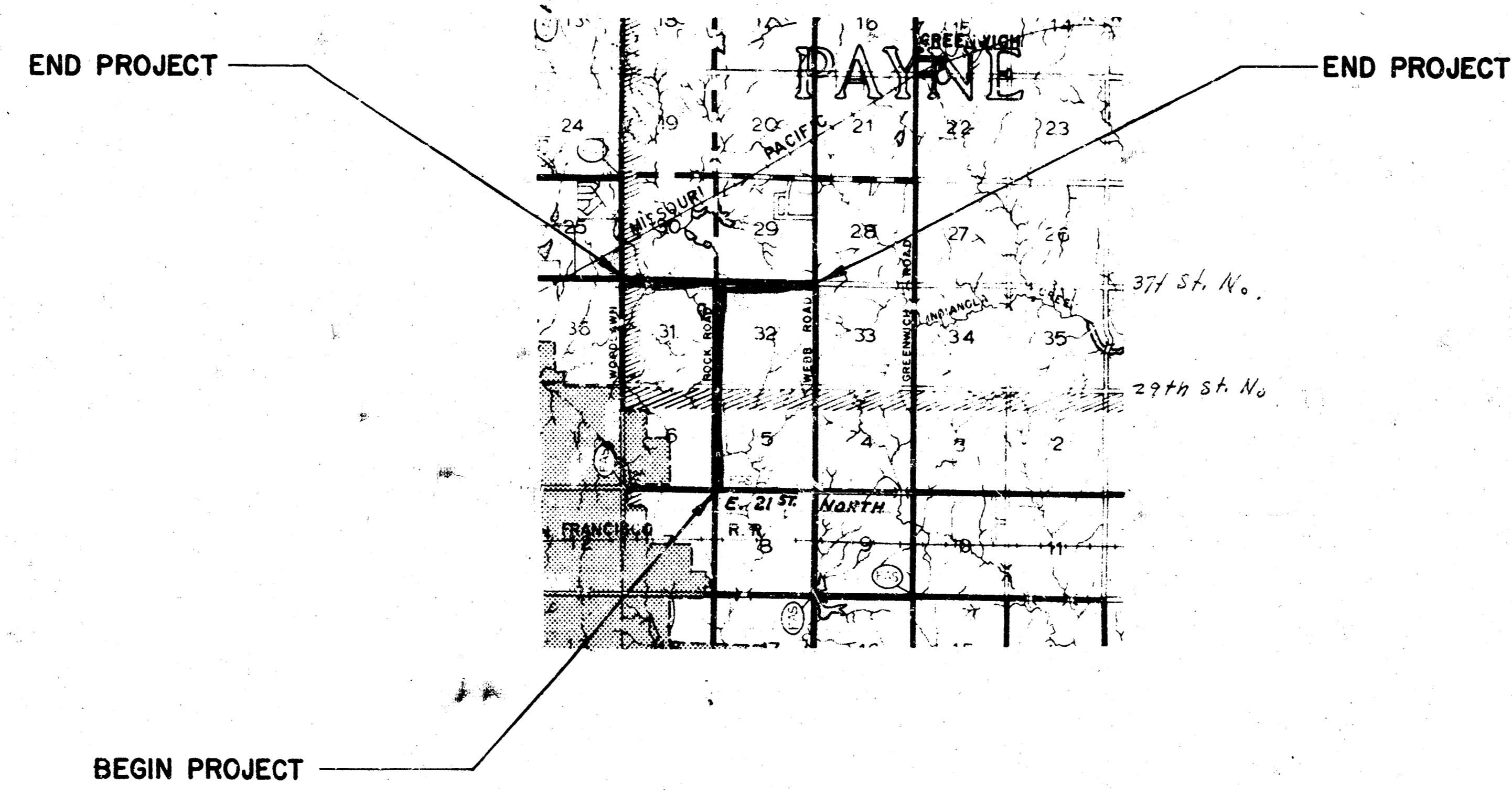

NET LENGTH OF PROJECT	FT.	MILES
NET LENGTH OF BRIDGES	FT.	MILES
NET LENGTH OF ROAD	FT.	MILES
PAVEMENT	FT.	MILES
ADJUSTMENTS	FT.	MILES
GROSS LENGTH OF PROJECT	FT.	MILES

PLANS PREPARED BY

SEDGWICK COUNTY ENGINEERS

WICHITA, KANSAS

DATE

APPROVED

CHAIRMAN

BOARD OF COUNTY COMMISSIONERS

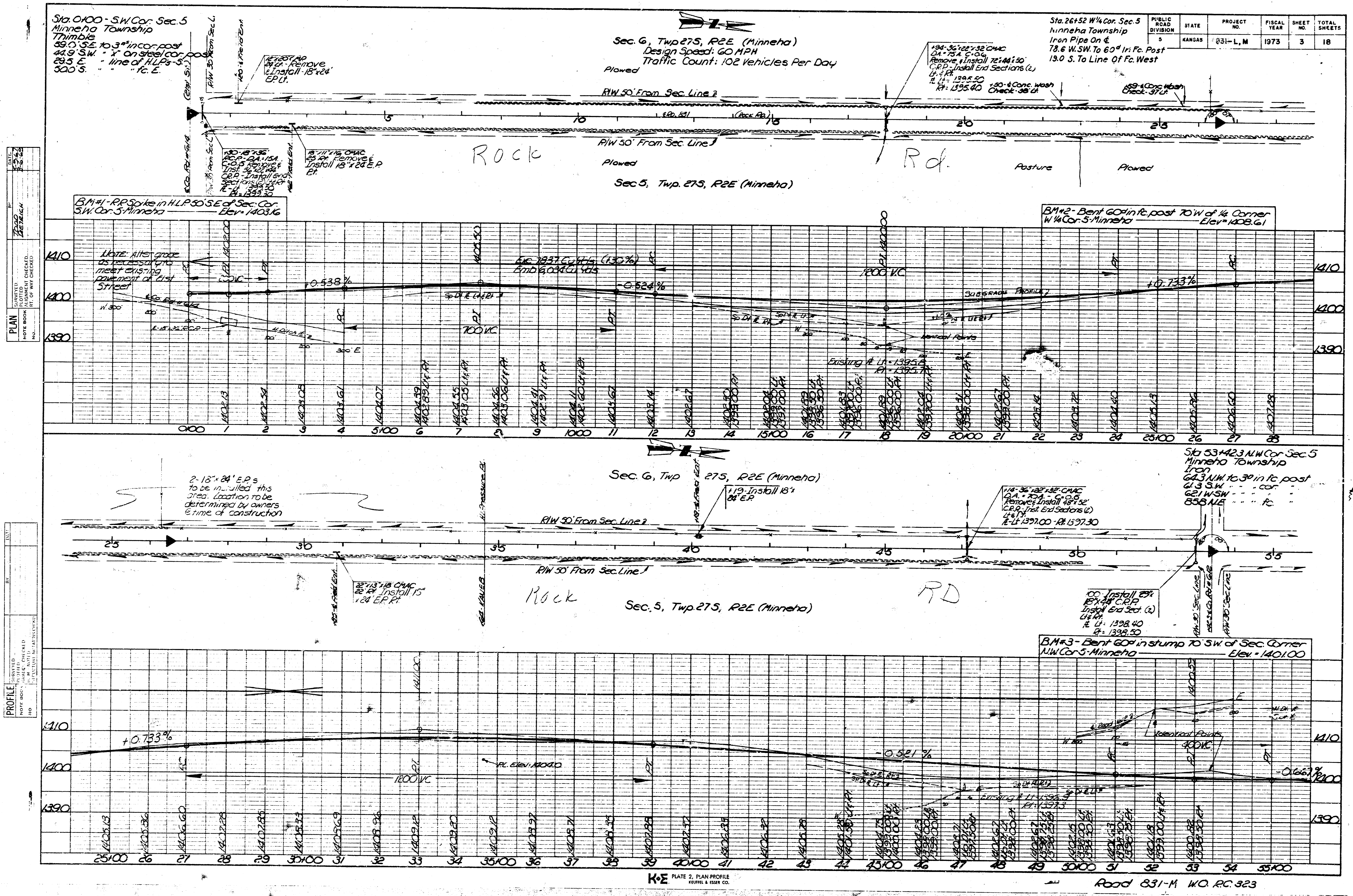

PLAN
 SURVEYED
 ALIGNMENT CHECKED
 NOTE BOOK
 P.T. OF WPT CHECKED

PROFILE
 SURVEYED
 GRADES CHECKED
 NOTE BOOK
 P.T. OF WPT CHECKED

PUBLIC ROAD DIVISION	STATE	PROJECT NO.	FISCAL YEAR	SHEET NO.	TOTAL SHEETS
5	KANSAS	831-L, M	1973	3	18

Sta. 0+00 - SW Cor. Sec. 5
 Minneha Township
 Township
 33.0 S. E. 10.3° in cor. post
 44.9 S.W. 1/4 On steel cor.
 29.5 E. - line of HLPs-S
 500 S. - - - - - E.

Sec. 6, Twp. 27S, R. 2E (Minneha)
 Design Speed: 60 MPH
 Traffic Count: 102 Vehicles Per Day
 Plowed

Sta. 26+52 W 1/4 Cor. Sec. 5
 Minneha Township
 Iron Pipe On E
 78.6 W. SW. To 60° In Fc. Post
 19.0 S. To Line Of Fc. West

BM #1 - R.P. spike in HLP 50 S.E. of Sec. Cor.
 SW Cor. 5 Minneha
 Elev. 1403.16

BM #2 - Bent 60° in fc. post 70 W of 1/4 Corner
 W 1/4 Cor. 5 Minneha
 Elev. 1408.61

