

Base Line for Curve Data is 6' Offset Face (A) Curb

Station	Point	Alignment	Deflection Angle	Chords	Arc
6+23.5	PT	A+36°40'	18°20'	12.18	12.18
6+50		R+102'	17°53'31"	49.33	49.33
6+00		T+326.32	16°36'26"	49.32	49.32
5+50		L+653.39	15°13'26"	49.33	49.33
5+00			13°50'23"	49.32	49.32
4+50			12°27'21"	49.33	49.33
4+00			11°04'18"	49.32	49.32
3+50			9°41'16"	49.32	49.32
3+00			8°18'14"	49.33	49.33
2+50			6°55'11"	49.32	49.32
2+00			5°32'09"	49.32	49.32
1+50			4°09'07"	49.33	49.33
1+00			2°46'04"	49.32	49.32
0+50			1°23'02"	49.32	49.32
0+00	RC				

	PROPERTY	CITY	IMPROVE & REIMPROVE
Cu.Yds. Excavation + 10%	2084	354	142
	208	35	12
Totals	2292	389	156
Cu.Yds. Comp. Fill + 10%	165		
Total	181		

ROOSEVELT STREET
S.L. SUNNYBROOK to S.L. PAWNEE
30'-6" CONC. & INT. CURB
& 40'-7" CONC. IMP. & REIMP.
B.E. SMITH CITY ENGINEER
CITY OF WICHITA, KANSAS
PROJECT NO. C19-242
APRIL 1962 C19-243



Survey C.A.M. 5-7-71
Plan V.L.A.
Checked

B.M. 123.71 "x" on Walk NW Corner
Roosevelt & Ross Parkway

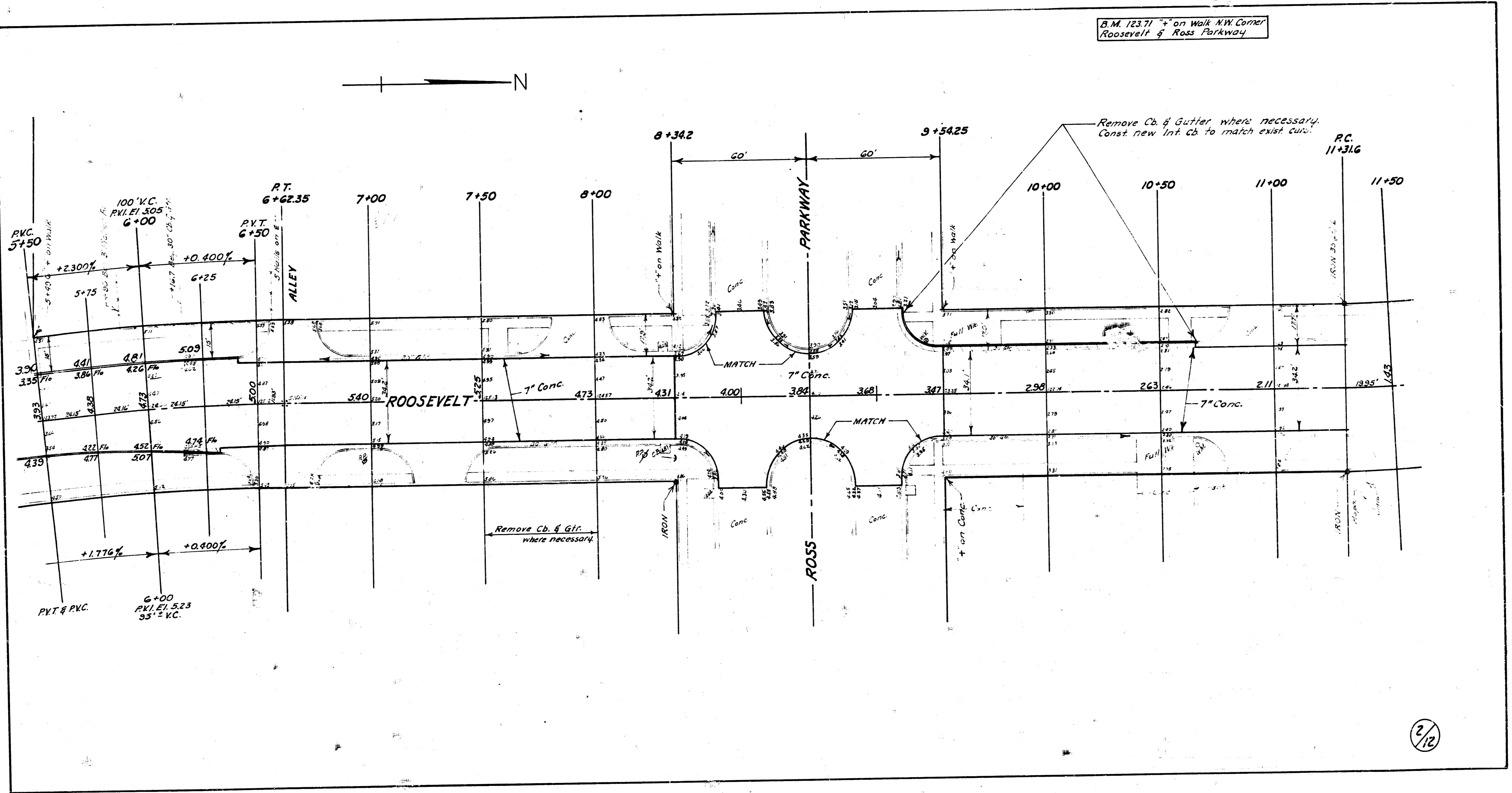
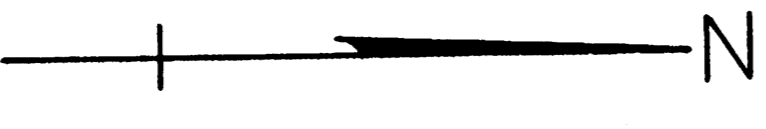

Station & Point	Alignment	Deflection Angle	Chord	Arc
14+81.1 P.T.		$\Delta = 48^{\circ} 10'$		
14+75	R*			
14+50	T*			
14+25	L*			
14+00				
13+75				
13+50				
13+25				
13+00				
12+75				
12+50				
12+25				
12+00				
11+75				
11+50				
11+31.6 P.C.				

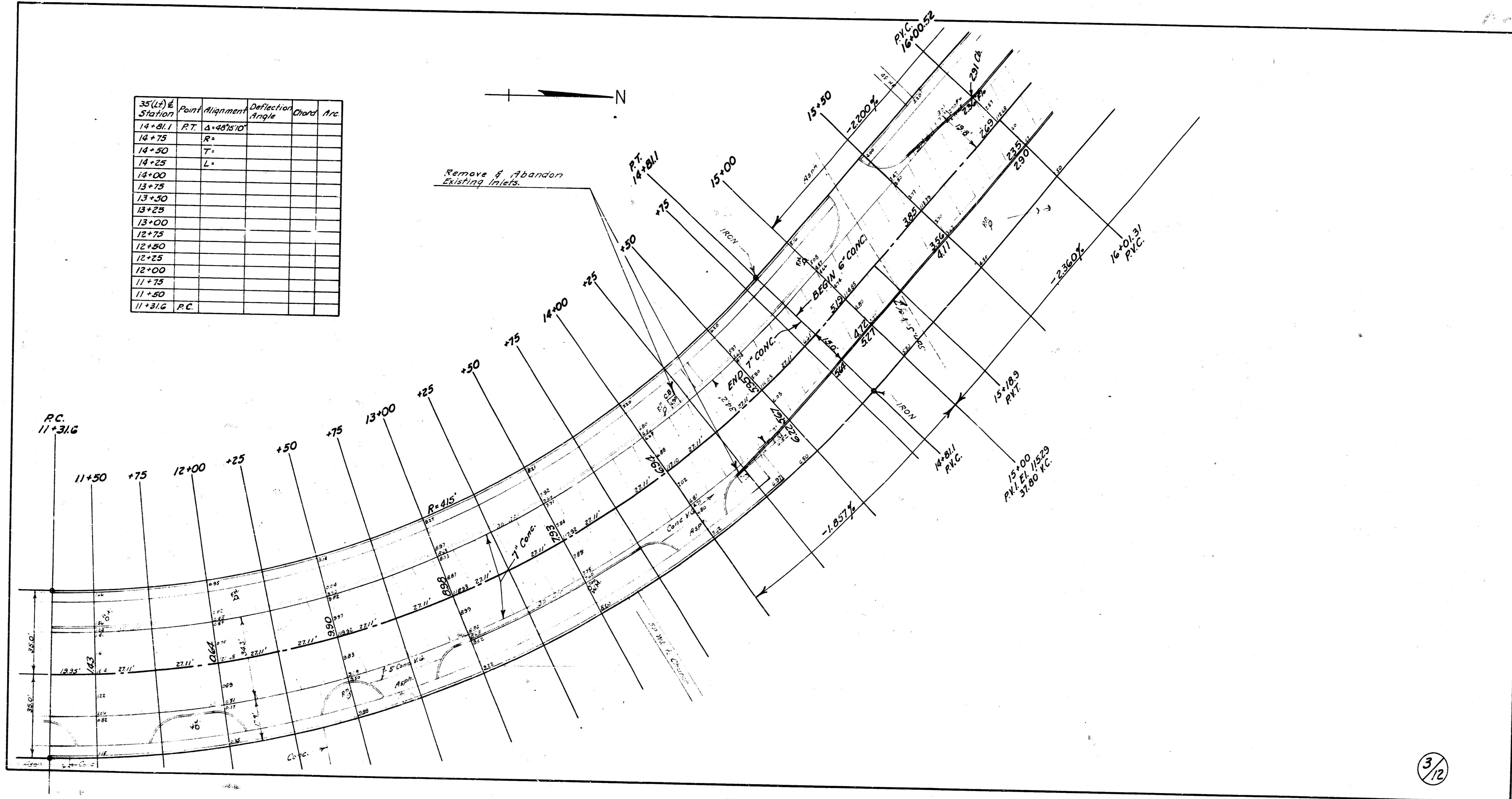

B.M. 114.23' on ctr. of Walk
S.S. Roseberry, W.L. Roosevelt

