

3.M 124.56 Bridge Spike S.S. P.R. West Side Roosevelt & Ross Parkway  
 3.M 131.35 S.E. Cor. Lower Conc. Slab, No. 4024 Ross Parkway  
 3.M 124.61 N.E. Cor. Conc. Pav. No. 4217 Ross Parkway  
 3.M 124.57 S.W. Cor. Conc. Pav. No. 4210 Ross Parkway  
 1.127 11.12.12 Page 17

NOTE: Intersections at Roosevelt & Ross to be  
 constd. either prior to or after remainder  
 of project is opened to traffic.

Summary of  
 Work  
 on  
 this  
 sheet

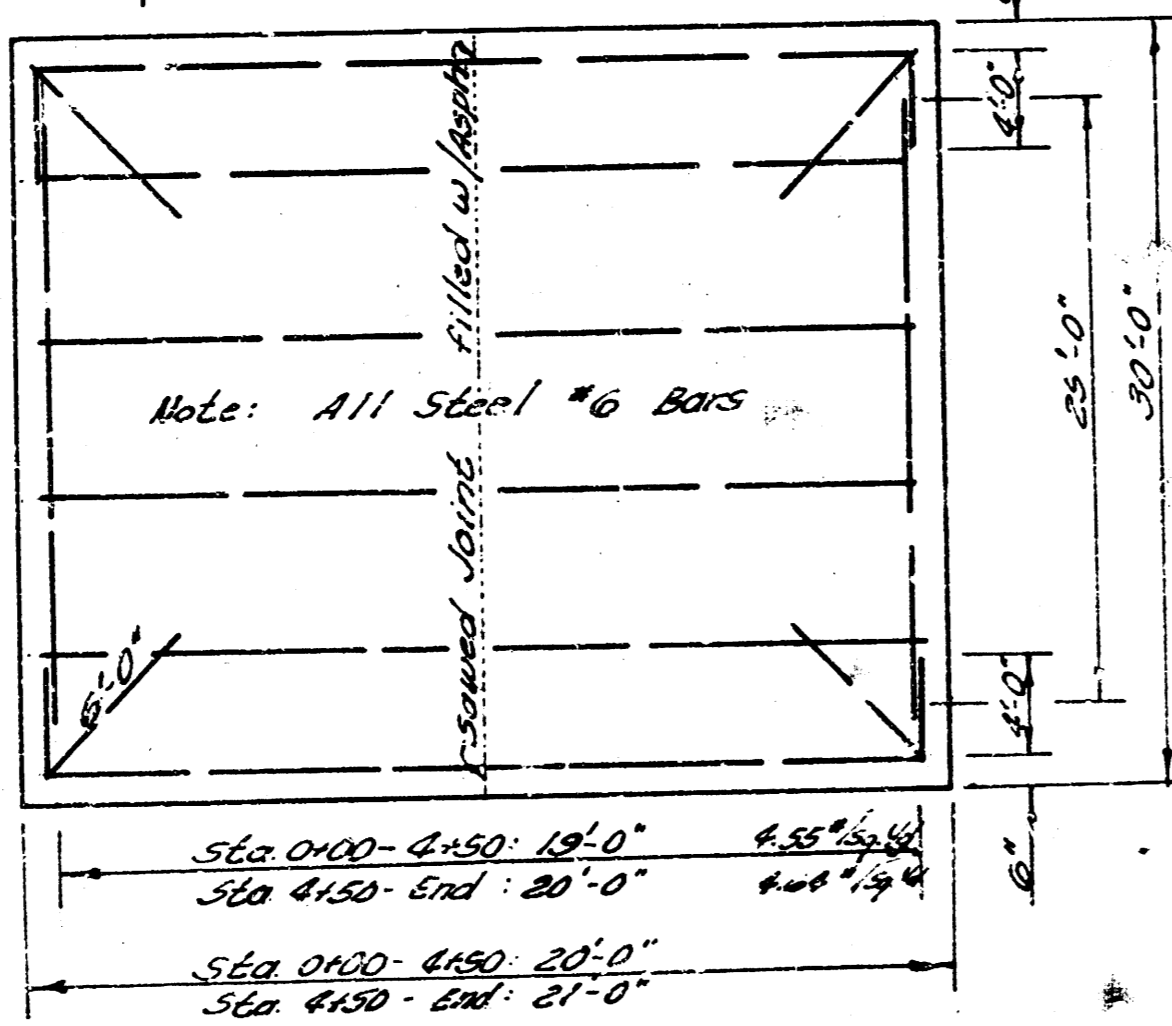
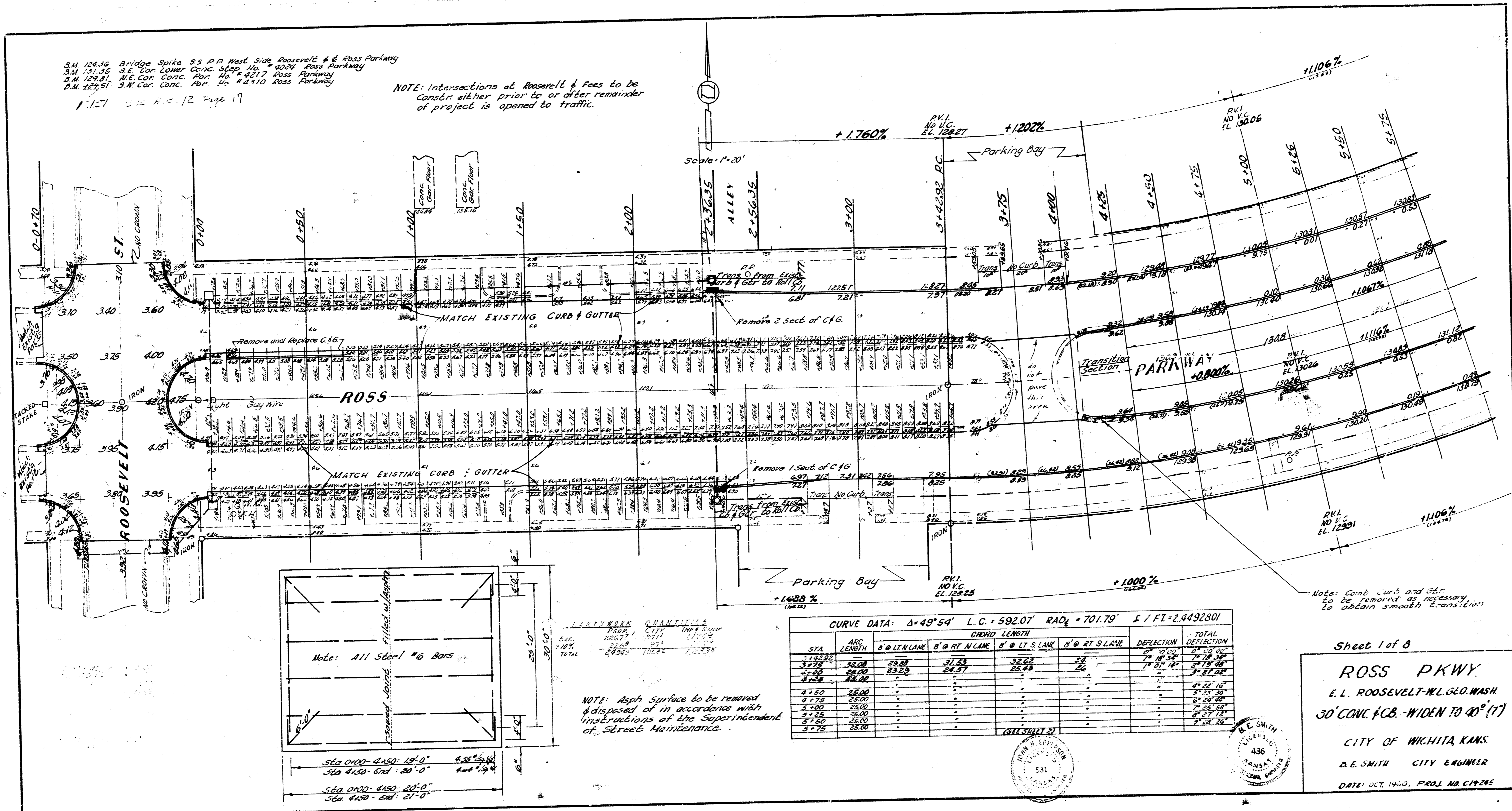

REINFORCEMENT QUANTITIES  
 PROP. CITY  
 200.75 271 117.50  
 22.8 231 117.50  
 20.8 202 117.50

NOTE: Asphalt surface to be removed  
 & disposed of in accordance with  
 instructions of the Superintendent  
 of Street Maintenance.

CURVE DATA:  $\Delta = 49^{\circ}54'$  L.C. = 592.07' RAD. = 701.79'  $S/FI = 2.4492801$

STA	ARC LENGTH	8' @ LT/LANE	8' @ RT/LANE	8' @ LT/LANE	8' @ RT/LANE	DEFLECTION	TOTAL DEFLECTION
3+22.22	25.00	31.25	32.00	34	34	7' 10.30"	7' 10.30"
3+75	25.00	23.25	24.27	25.43	26	7' 07.74"	14' 18.04"
4+25	25.00						14' 18.04"
4+75	25.00						14' 18.04"
5+25	25.00						14' 18.04"
5+75	25.00						14' 18.04"
6+25	25.00						14' 18.04"
6+75	25.00						14' 18.04"

Note: Comb Curb and G.T.  
 to be removed as necessary  
 to obtain smooth transition

Sheet 1 of 8  
**ROSS PKWY.**  
 E.L. ROOSEVELT-N.W. GLO. WASH.  
 30' CONC. FCB - WIDEN TO 40' (11')  
 CITY OF WICHITA, KANS.  
 D.E. SMITH CITY ENGINEER  
 DATE: OCT. 1940, PROJ. NO. C19225

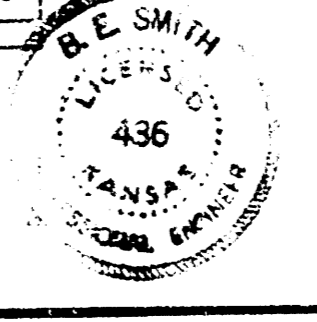
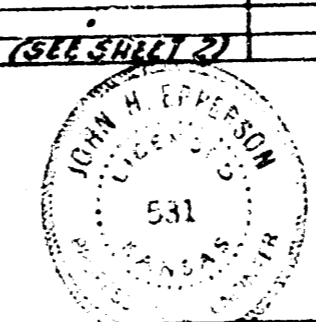

**CURVE DATA:  $\Delta=49^{\circ}54'$  L.C.=592.07 RAD $_R=701.79$   $L/FT=2.4492801$**

STA	ARC LENGTH	CHORD LENGTH				DEFLECTION	TOTAL DEFLECTION
		B @ LT. LANE	B @ RT. LANE	B @ LT. S. LANE	B @ RT. S. LANE		
5+75	26.00	23.29	24.57	25.85	26.71	1° 01' 18"	9° 24' 24"
6+00	26.00	23.29	24.57	25.85	26.71	1° 01' 18"	10° 35' 42"
6+25	26.00	23.29	24.57	25.85	26.71	1° 01' 18"	11° 47' 00"
6+50	26.00	23.29	24.57	25.85	26.71	1° 01' 18"	13° 00' 18"
6+75	26.00	23.29	24.57	25.85	26.71	1° 01' 18"	14° 13' 36"
7+00	26.00	23.29	24.57	25.85	26.71	1° 01' 18"	15° 27' 54"
7+25	26.00	23.29	24.57	25.85	26.71	1° 01' 18"	16° 43' 12"
7+50	26.00	23.29	24.57	25.85	26.71	1° 01' 18"	18° 00' 30"
7+75	26.00	23.29	24.57	25.85	26.71	1° 01' 18"	19° 18' 48"
8+00	26.00	23.29	24.57	25.85	26.71	1° 01' 18"	20° 38' 06"
8+25	26.00	23.29	24.57	25.85	26.71	1° 01' 18"	22° 00' 24"
8+50	26.00	23.29	24.57	25.85	26.71	1° 01' 18"	23° 24' 42"
8+75	26.00	23.29	24.57	25.85	26.71	1° 01' 18"	24° 51' 00"
9+00	26.00	23.29	24.57	25.85	26.71	1° 01' 18"	26° 20' 18"
9+25	26.00	23.29	24.57	25.85	26.71	1° 01' 18"	27° 51' 36"
9+50	26.00	23.29	24.57	25.85	26.71	1° 01' 18"	29° 25' 54"
9+75	26.00	23.29	24.57	25.85	26.71	1° 01' 18"	31° 03' 12"
10+00	26.00	23.29	24.57	25.85	26.71	1° 01' 18"	32° 44' 30"
10+25	26.00	23.29	24.57	25.85	26.71	1° 01' 18"	34° 30' 48"
10+50	26.00	23.29	24.57	25.85	26.71	1° 01' 18"	36° 22' 06"
10+75	26.00	23.29	24.57	25.85	26.71	1° 01' 18"	38° 19' 24"
11+00	26.00	23.29	24.57	25.85	26.71	1° 01' 18"	40° 32' 42"
11+25	26.00	23.29	24.57	25.85	26.71	1° 01' 18"	42° 52' 00"
11+50	26.00	23.29	24.57	25.85	26.71	1° 01' 18"	45° 18' 18"
11+75	26.00	23.29	24.57	25.85	26.71	1° 01' 18"	47° 51' 36"
12+00	26.00	23.29	24.57	25.85	26.71	1° 01' 18"	50° 32' 54"
12+25	26.00	23.29	24.57	25.85	26.71	1° 01' 18"	53° 22' 12"
12+50	26.00	23.29	24.57	25.85	26.71	1° 01' 18"	56° 20' 30"
12+75	26.00	23.29	24.57	25.85	26.71	1° 01' 18"	59° 27' 48"
13+00	26.00	23.29	24.57	25.85	26.71	1° 01' 18"	62° 44' 06"
13+25	26.00	23.29	24.57	25.85	26.71	1° 01' 18"	65° 69' 24"
13+50	26.00	23.29	24.57	25.85	26.71	1° 01' 18"	68° 09' 42"
13+75	26.00	23.29	24.57	25.85	26.71	1° 01' 18"	70° 54' 00"
14+00	26.00	23.29	24.57	25.85	26.71	1° 01' 18"	73° 53' 18"
14+25	26.00	23.29	24.57	25.85	26.71	1° 01' 18"	77° 07' 36"
14+50	26.00	23.29	24.57	25.85	26.71	1° 01' 18"	80° 37' 54"
14+75	26.00	23.29	24.57	25.85	26.71	1° 01' 18"	84° 24' 12"
15+00	26.00	23.29	24.57	25.85	26.71	1° 01' 18"	88° 27' 30"
15+25	26.00	23.29	24.57	25.85	26.71	1° 01' 18"	92° 47' 48"
15+50	26.00	23.29	24.57	25.85	26.71	1° 01' 18"	97° 35' 06"
15+75	26.00	23.29	24.57	25.85	26.71	1° 01' 18"	102° 39' 24"
16+00	26.00	23.29	24.57	25.85	26.71	1° 01' 18"	108° 10' 42"
16+25	26.00	23.29	24.57	25.85	26.71	1° 01' 18"	113° 59' 00"
16+50	26.00	23.29	24.57	25.85	26.71	1° 01' 18"	119° 54' 18"
16+75	26.00	23.29	24.57	25.85	26.71	1° 01' 18"	126° 05' 36"
17+00	26.00	23.29	24.57	25.85	26.71	1° 01' 18"	132° 33' 54"
17+25	26.00	23.29	24.57	25.85	26.71	1° 01' 18"	138° 79' 12"
17+50	26.00	23.29	24.57	25.85	26.71	1° 01' 18"	144° 52' 30"
17+75	26.00	23.29	24.57	25.85	26.71	1° 01' 18"	151° 43' 48"
18+00	26.00	23.29	24.57	25.85	26.71	1° 01' 18"	158° 52' 06"
18+25	26.00	23.29	24.57	25.85	26.71	1° 01' 18"	166° 18' 24"
18+50	26.00	23.29	24.57	25.85	26.71	1° 01' 18"	173° 72' 42"
18+75	26.00	23.29	24.57	25.85	26.71	1° 01' 18"	180° 44' 00"
19+00	26.00	23.29	24.57	25.85	26.71	1° 01' 18"	188° 33' 18"
19+25	26.00	23.29	24.57	25.85	26.71	1° 01' 18"	196° 50' 36"
19+50	26.00	23.29	24.57	25.85	26.71	1° 01' 18"	205° 25' 54"
19+75	26.00	23.29	24.57	25.85	26.71	1° 01' 18"	214° 29' 12"
20+00	26.00	23.29	24.57	25.85	26.71	1° 01' 18"	224° 10' 30"
20+25	26.00	23.29	24.57	25.85	26.71	1° 01' 18"	233° 59' 48"
20+50	26.00	23.29	24.57	25.85	26.71	1° 01' 18"	244° 17' 06"
20+75	26.00	23.29	24.57	25.85	26.71	1° 01' 18"	254° 52' 24"
21+00	26.00	23.29	24.57	25.85	26.71	1° 01' 18"	265° 45' 42"
21+25	26.00	23.29	24.57	25.85	26.71	1° 01' 18"	276° 56' 00"
21+50	26.00	23.29	24.57	25.85	26.71	1° 01' 18"	288° 34' 18"
21+75	26.00	23.29	24.57	25.85	26.71	1° 01' 18"	300° 39' 36"
22+00	26.00	23.29	24.57	25.85	26.71	1° 01' 18"	313° 22' 54"
22+25	26.00	23.29	24.57	25.85	26.71	1° 01' 18"	326° 34' 12"
22+50	26.00	23.29	24.57	25.85	26.71	1° 01' 18"	340° 13' 30"
22+75	26.00	23.29	24.57	25.85	26.71	1° 01' 18"	354° 30' 48"
23+00	26.00	23.29	24.57	25.85	26.71	1° 01' 18"	369° 26' 06"
23+25	26.00	23.29	24.57	25.85	26.71	1° 01' 18"	384° 50' 24"
23+50	26.00	23.29	24.57	25.85	26.71	1° 01' 18"	400° 42' 42"
23+75	26.00	23.29	24.57	25.85	26.71	1° 01' 18"	417° 03' 00"
24+00	26.00	23.29	24.57	25.85	26.71	1° 01' 18"	433° 51' 18"
24+25	26.00	23.29	24.57	25.85	26.71	1° 01' 18"	451° 07' 36"
24+50	26.00	23.29	24.57	25.85	26.71	1° 01' 18"	468° 51' 54"
24+75	26.00	23.29	24.57	25.85	26.71	1° 01' 18"	487° 04' 12"
25+00	26.00	23.29	24.57	25.85	26.71	1° 01' 18"	506° 34' 30"
25+25	26.00	23.29	24.57	25.85	26.71	1° 01' 18"	526° 32' 48"
25+50	26.00	23.29	24.57	25.85	26.71	1° 01' 18"	546° 48' 06"
25+75	26.00	23.29	24.57	25.85	26.71	1° 01' 18"	567° 30' 24"
26+00	26.00	23.29	24.57	25.85	26.71	1° 01' 18"	588° 28' 42"
26+25	26.00	23.29	24.57	25.85	26.71	1° 01' 18"	609° 53' 00"
26+50	26.00	23.29	24.57	25.85	26.71	1° 01' 18"	632° 34' 18"
26+75	26.00	23.29	24.57	25.85	26.71	1° 01' 18"	656° 31' 36"
27+00	26.00	23.29	24.57	25.85	26.71	1° 01' 18"	681° 45' 54"
27+25	26.00	23.29	24.57	25.85	26.71	1° 01' 18"	707° 17' 12"
27+50	26.00	23.29	24.57	25.85	26.71	1° 01' 18"	733° 15' 30"
27+75	26.00	23.29	24.57	25.85	26.71	1° 01' 18"	759° 40' 48"
28+00	26.00	23.29	24.57	25.85	26.71	1° 01' 18"	786° 32' 06"
28+25	26.00	23.29	24.57	25.85	26.71	1° 01' 18"	813° 50' 24"
28+50	26.00	23.29	24.57	25.85	26.71	1° 01' 18"	842° 35' 42"
28+75	26.00	23.29	24.57	25.85	26.71	1° 01' 18"	871° 37' 00"
29+00	26.00	23.29	24.57	25.85	26.71	1° 01' 18"	901° 54' 18"
29+25	26.00	23.29	24.57	25.85	26.71	1° 01' 18"	932° 37' 36"
29+50	26.00	23.29	24.57	25.85	26.71	1° 01' 18"	964° 37' 54"
29+75	26.00	23.29	24.57	25.85	26.71	1° 01' 18"	997° 55' 12"
30+00	26.00	23.29	24.57	25.85	26.71	1° 01' 18"	1032° 29' 30"
30+25	26.00	23.29	24.57	25.85	26.71	1° 01' 18"	1068° 30' 48"
30+50	26.00	23.29	24.57	25.85	26.71	1° 01' 18"	1105° 38' 06"
30+75	26.00	23.29	24.57	25.85	26.71	1° 01' 18"	1143° 51' 24"
31+00	26.00	23.29	24.57	25.85	26.71	1° 01' 18"	1183° 10' 42"
31+25	26.00	23.29	24.57	25.85	26.71	1° 01' 18"	1223° 46' 00"
31+50	26.00	23.29	24.57	25.85	26.71	1° 01' 18"	1265° 37' 18"
31+75	26.00	23.29	24.57	25.85	26.71	1° 01' 18"	1308° 54' 36"
32+00	26.00	23.29	24.57	25.85	26.71	1° 01' 18"	1353° 37' 54"
32+25	26.00	23.29	24.57	25.85	26.71	1° 01' 18"	1400° 07' 12"
32+50	26.00	23.29	24.57	25.85	26.71	1° 01' 18"	1448° 02' 30"
32+75	26.00	23.29	24.57	25.85	26.71	1° 01' 18"	1497° 23' 48"
33+00	26.00	23.29	24.57	25.85	26.71	1° 01' 18"	1547° 71' 06"
33+25	26.00	23.29	24.57	25.85	26.71	1° 01' 18"	1598° 35' 24"
33+50	26.00	23.29	24.57	25.85	26.71	1° 01' 18"	1650° 55' 42"
33+75	26.00	23.29	24.57	25.85	26.71	1° 01' 18"	1704° 42' 00"
34+00	26.00	23.29	24.57	25.85	26.71	1° 01' 18"	1759° 44' 18"
34+25	26.00	23.29	24.57	25.85	26.71	1° 01' 18"	1815° 52' 36"
34+50	26.00	23.29	24.57	25.85	26.71	1° 01' 18"	1873° 26' 54"



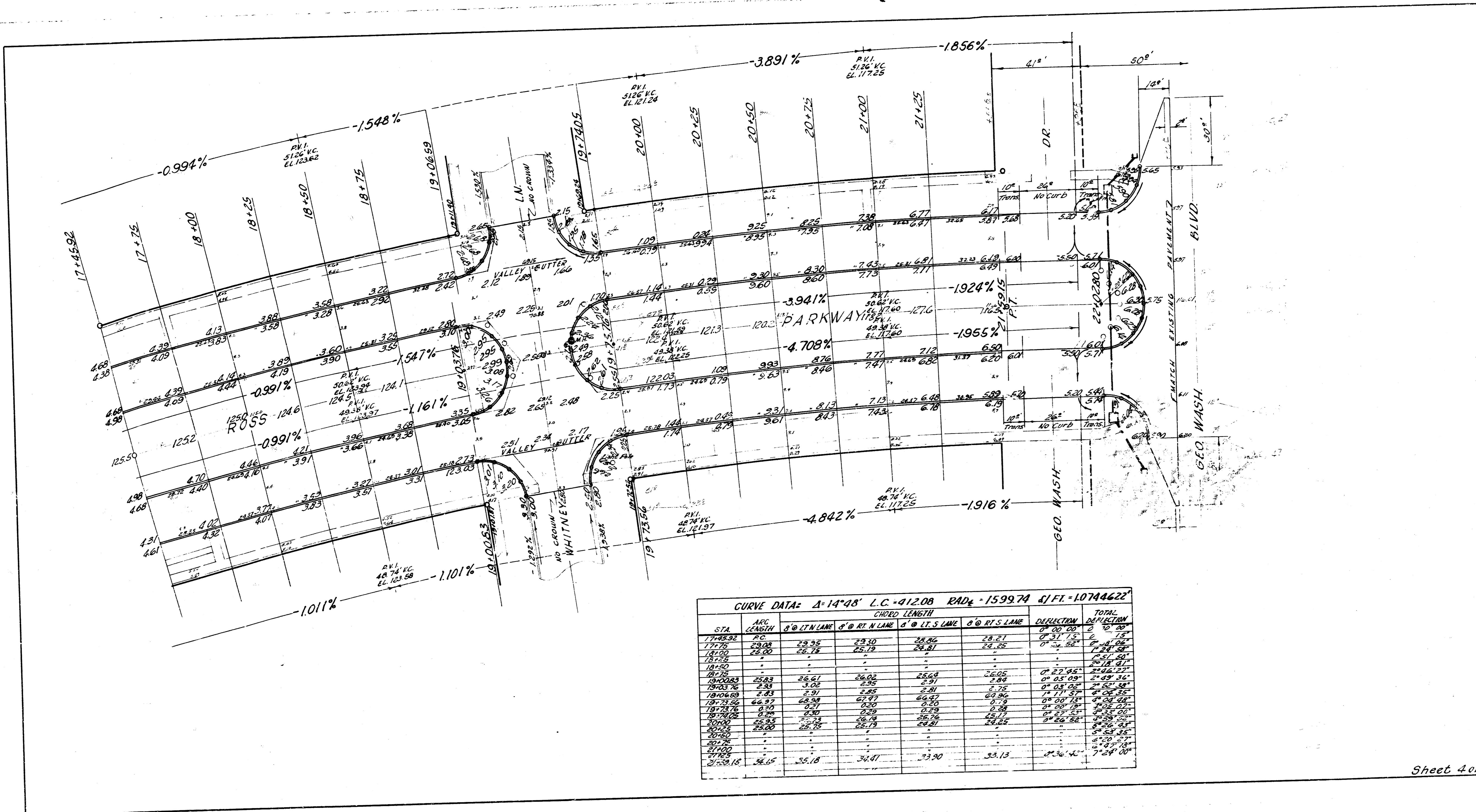

CURVE DATA:  $\Delta = 14^{\circ}48'$  L.C. = 412.08 RAD = 1599.74  $\Delta$  I.FI. = 10794622

STA	ARC LENGTH	CHORD LENGTH				DEFLECTION	TOTAL DEFLECTION
		S @ RT N LANE	S @ RT N LANE	S @ LT S LANE	S @ RT S LANE		
17+45.92	P.C.						
17+75	28.58	29.25	29.30	28.86	28.21	0° 31' 15"	0° 31' 15"
18+00	25.00	25.75	25.79	25.81	25.25	0° 32' 52"	0° 32' 52"
18+25							
18+50							
18+75							
19+00	25.00	25.61	25.62	25.69	25.05	0° 27' 45"	0° 27' 45"
19+00.85	25.83	26.05	26.05	26.05	26.05	0° 25' 09"	0° 25' 09"
19+03	2.91	2.91	2.91	2.91	2.91	0° 03' 02"	0° 03' 02"
19+06.69	2.83	2.91	2.91	2.91	2.91	1° 11' 39"	1° 11' 39"
19+09.56	66.97	68.98	69.97	69.96	69.96	0° 06' 35"	0° 06' 35"
19+12.16	0.90	0.91	0.90	0.90	0.90	0° 00' 15"	0° 00' 15"
19+14.08	0.90	0.90	0.90	0.90	0.90	0° 00' 15"	0° 00' 15"
19+16	25.83	26.74	26.74	26.74	26.74	0° 27' 45"	0° 27' 45"
19+25	25.00	25.75	25.79	25.81	25.25	0° 32' 52"	0° 32' 52"
19+50							
19+75							
19+75.00							
19+75.15	26.15	26.18	26.17	26.20	26.13	0° 36' 42"	0° 36' 42"