

PAVING PLANS FOR

# TEAL COVE SECOND

RUSHWOOD COURT: (LOTS 1 THROUGH 5 INCLUSIVE BLK. 1 TEAL COVE SECOND) FROM THE EAST LINE OF RUSHWOOD TO AND INCL. CUL-DE-SAC  
 RUSHWOOD COURT: (LOTS 6 THROUGH 9 INCLUSIVE BLK. 1 TEAL COVE SECOND) FROM THE EAST LINE OF RUSHWOOD TO AND INCL. CUL-DE-SAC  
 RUSHWOOD COURT: (LOTS 10 THROUGH 12 INCLUSIVE BLK. 1 TEAL COVE SECOND) FROM THE EAST LINE OF RUSHWOOD TO AND INCL. CUL-DE-SAC

## PROJECT NO.

# 472-76-245-81571-000-000-001

CITY OF WICHITA, KANSAS  
 MICHAEL E. LINDEBAK CITY ENGINEER

### GENERAL NOTES

- CURB AND GUTTER WITH WIDENED GUTTER TO BE PAID AS COMBINED CURB AND GUTTER.
- THE CONTRACTOR SHALL BE RESPONSIBLE FOR PRESERVING PROPERTY IRONS. (THE CONTRACTOR SHALL BE REQUIRED TO RE-ESTABLISH ANY PROPERTY IRONS WHICH ARE DAMAGED OR DESTROYED BY HIS CONSTRUCTION OPERATIONS. SUCH IRONS SHALL BE RE-ESTABLISHED BY A LICENSED LAND SURVEYOR OR A LICENSED PROFESSIONAL ENGINEER IN ACCORDANCE WITH STATE LAWS.)
- TRANSITION CURB FROM FULL HEIGHT COMBINATION CURB AND GUTTER TO ROLL TYPE COMBINATION CURB AND GUTTER IS TO BE PAID AS BID FOR LINEAL FEET COMBINED CURB AND GUTTER (3 5/8" ROLL).
- CURB SHALL BE DEPRESSED THROUGH DRIVES (1 1/2"), WHERE ROLL TYPE CURB AND GUTTER IS CONSTRUCTED.
- NO MORE THAN 5-20' DRIVEWAY APPROACHES OR THE EQUIVALENT TO BE CONSTRUCTED.
- EXISTING UTILITIES AND THEIR LOCATIONS, AS SHOWN ON THE PLANS, REPRESENT THE BEST INFORMATION OBTAINABLE FOR DESIGN. LOCATION INFORMATION HAS BEEN OBTAINED FROM THE VARIOUS UTILITY COMPANIES AND IS EITHER FROM COMPANY RECORD DRAWINGS OR COMPANY PROVIDED FIELD LOCATIONS. THE PLAN LOCATIONS SHOWN ARE NOT GUARANTEED. ADDITIONAL EXISTING UTILITIES MAY ALSO BE ENCOUNTERED.
- CONTRACTOR WILL BE REQUIRED TO PROVIDE A MINIMUM ADVANCE NOTICE OF TWENTY-FOUR (24) HOURS TO UTILITY COMPANIES PRIOR TO STARTING ANY EXCAVATION AS FOLLOWS:
 

SOUTHWESTERN BELL TELEPHONE COMPANY	1-316-571-2611
CABLEVISION	262-4270 or 263-2061
KPL GAS SERVICE	263-7511
KANSAS GAS & ELECTRIC	264-1141
CITY OF WICHITA WATER DEPARTMENT	268-4908
CITY OF WICHITA SEWER DEPARTMENT	268-4071
ARKLA GAS COMPANY	942-8350 or 263-8161
- CONTACT REX BROWN, FARMLAND INDUSTRIES, AT 918-333-9644 AT LEAST 48 HOURS PRIOR TO EXCAVATING THIS PROJECT.

SOUTHWESTERN BELL TELEPHONE COMPANY	1-316-571-2611
CABLEVISION	262-4270 or 263-2061
KPL GAS SERVICE	263-7511
KANSAS GAS & ELECTRIC	264-1141
CITY OF WICHITA WATER DEPARTMENT	268-4908
CITY OF WICHITA SEWER DEPARTMENT	268-4071
ARKLA GAS COMPANY	942-8350 or 263-8161

### BENCH MARKS

- BM #1 CITY STD. 30' NORTH & 34' WEST OF QUARTER SECTION CORNER AT 37TH & GOVERNOUR ELEV. = 185.54
- TBM #2 RAILROAD SPIKE IN WEST FACE OF WEST LEG OF "H" POLE AT THE NORTHEAST CORNER OF TEAL COVE ELEV. = 179.24

### INDEX TO DRAWINGS

SHEET NO.	DISCRPTION
1	TITLE SHEET
2	PAVING DETAILS
3	RUSHWOOD COURTS
4-6	PAVING CROSS SECTIONS
7	FINAL PLAT

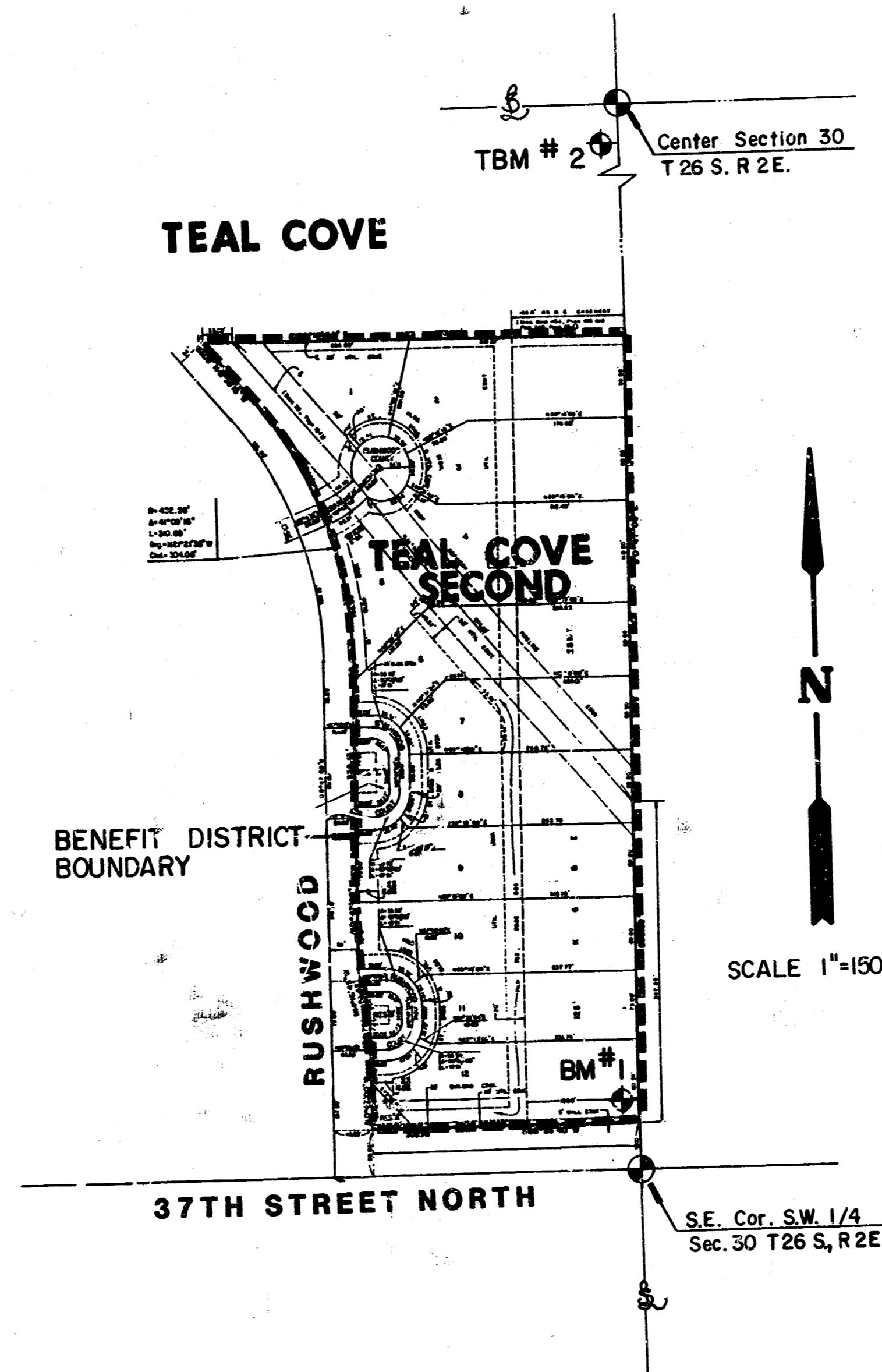

**CAUTION:**  
 HIGH PRESSURE COOP.  
 PIPE LINE. CONTACT BILL STULL  
 24 HRS. PRIOR TO EXCAVATION AT  
 1-316-221-2107

<b>MK EL</b>	<b>TEAL COVE SECOND</b>	Desig: F.F., K.K.L. Drawn by: F.F. Checked by: K.H.B. Date: April, 1967 Job no.
	<b>PAVING PLANS</b>	Sheet <b>1</b> of <b>7</b>
MID-KANSAS ENGINEERING CONSULTANTS PA 3500 NORTH ROCK ROAD BUILDING #800 WICHITA, KANSAS 67226		682-6561

NOTE:  
Top of Curb Elevations Shown For Full Curb, Construct Combined Curb & Gutter (Roll Type).

TEAL

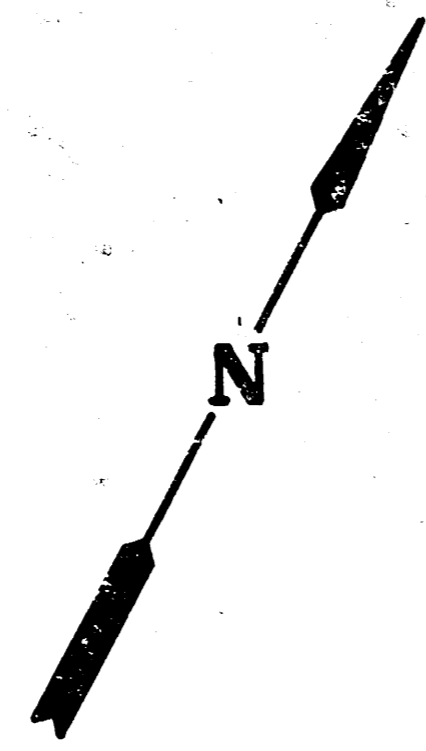

Scale: 1" = 20'

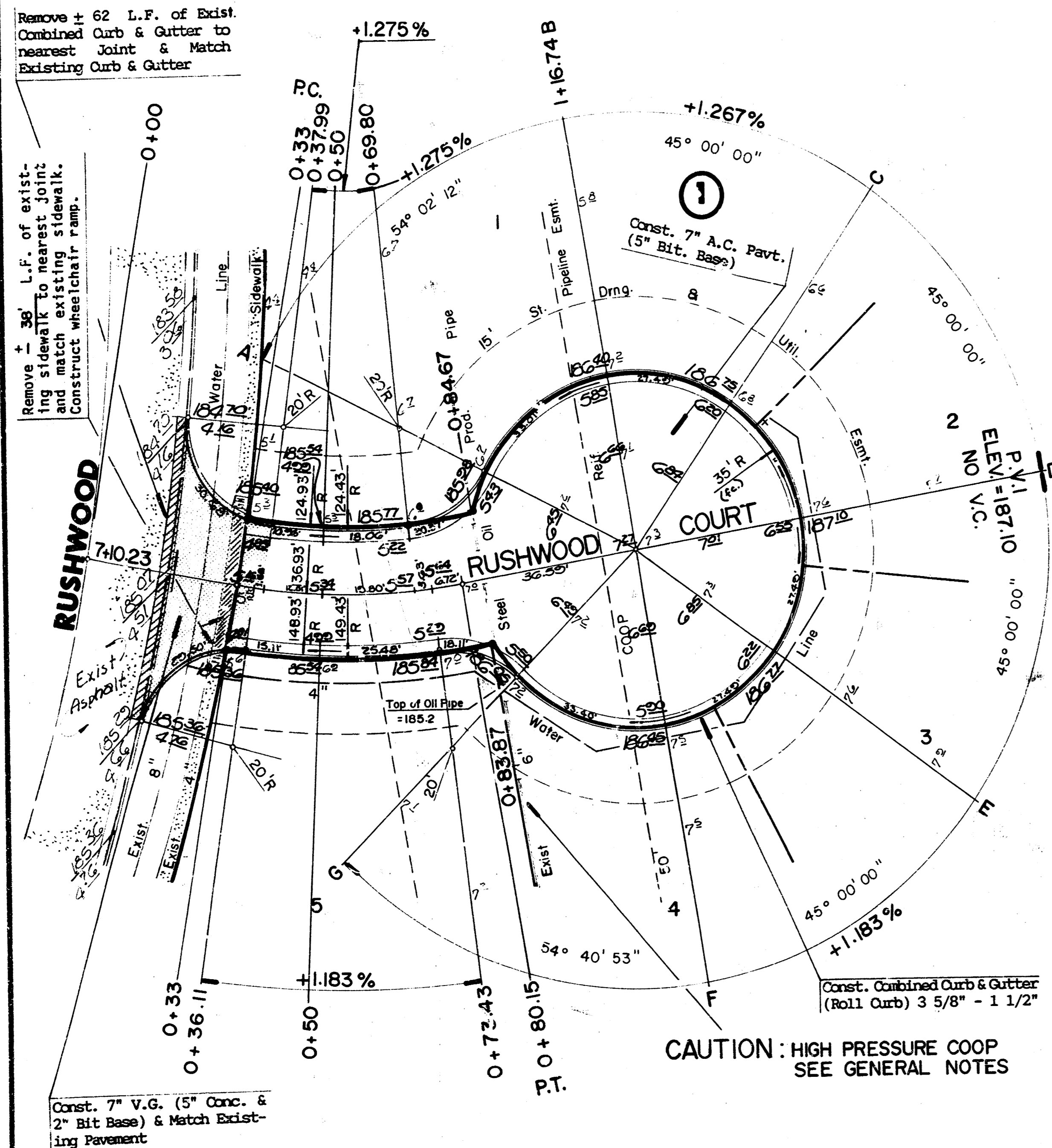

Const. 7" V.G. (5" Conc. & 2" Bit Base) & Match Existing Pavement

CAUTION: HIGH PRESSURE COOP  
SEE GENERAL NOTES

RUSHWOOD & RUSHWOOD CT.  
(LOT 1 THRU 5)  
INTERSECTION QUANTITIES

$\Delta = 19^{\circ}43'40''$  R = 136.93' T = 23.81' L = 47.15' LC = 46.91'  
CURVE DATA BASED ON Centerline RAD.  $\Delta / 2 = 9^{\circ}51'50''$

STATION	ARC	CHORD LENGTH	DEFLECTION	TOTAL DEFLECTION
0+30.00	-	-	-	00°00'00"
0+32.11	3.11'	3.56	00°39'02"	00°39'02"
0+32.99	1.88'	4.26'	00°23'36"	01°02'38"
0+50.00	12.01'	13.76'	02°30'46"	03°33'24"
0+59.80	19.80'	16.89'	04°08'33"	07°41'57"
0+73.43	3.53'	26.82'	00°45'30"	08°27'30"
0+80.15	6.72'	-	01°24'20"	09°51'50"

Def. / Ft. = 12.65293 Min.

RUSHWOOD & RUSHWOOD CT.  
(LOT 1 THRU 5)  
INTERSECTION QUANTITIES

S.T. Concrete Pavement  
S.T. Asphaltic Conc. Pavement (3" Bituminous Base)  
S.T. Bituminous Base  
L.F. Combined Curb & Gutter (6 5/8")  
L.F. Monolithic Edge Curb (6 5/8")  
S.F. 4" Wheelchair Ramp  
S.F. 4" Walk  
C.V. Excavation  
C.V. Compacted Fill  
Lbs. Reinforcing Steel  
S.T. Manipulation  
Tons Lime or Cement  
S.T. V.G. 5" Concrete & 2" Asphaltic Concrete Base

RUSHWOOD & RUSHWOOD CT.  
(LOT 1 THRU 9)  
INTERSECTION QUANTITIES

$\Delta = 90^{\circ}00'00''$  R = 30.50' T = 30.50' L = 47.91' LC = 43.13'  
CURVE DATA BASED ON Centerline RAD.  $\Delta / 2 = 45^{\circ}00'00''$

STATION	ARC	CHORD LENGTH	DEFLECTION	TOTAL DEFLECTION
1+40.91	-	-	-	00°00'00"
1+40.91	8.00'	3.12'	08°32'16"	08°32'16"
1+40.91	25.00'	8.37'	40.24'	23°28'54"
1+40.91	27.91'	9.20'	44.82'	28°12'36"

Def. / Ft. = 56.3560 Min.

RUSHWOOD & RUSHWOOD CT.  
(LOT 1 THRU 9)  
INTERSECTION QUANTITIES

$\Delta = 90^{\circ}00'00''$  R = 30.50' T = 30.50' L = 47.91' LC = 43.13'  
CURVE DATA BASED ON Centerline RAD.  $\Delta / 2 = 45^{\circ}00'00''$

STATION	ARC	CHORD LENGTH	DEFLECTION	TOTAL DEFLECTION
1+40.91	-	-	-	00°00'00"
1+40.91	8.00'	3.12'	08°32'16"	08°32'16"
1+40.91	25.00'	8.37'	40.24'	23°28'54"
1+40.91	27.91'	9.20'	44.82'	28°12'36"

Def. / Ft. = 56.3560 Min.

RUSHWOOD & RUSHWOOD CT.  
(LOT 10 THRU 12)  
INTERSECTION QUANTITIES

$\Delta = 90^{\circ}00'00''$  R = 30.50' T = 30.50' L = 47.91' LC = 43.13'  
CURVE DATA BASED ON Centerline RAD.  $\Delta / 2 = 45^{\circ}00'00''$

STATION	ARC	CHORD LENGTH	DEFLECTION	TOTAL DEFLECTION
0+45.00	-	-	-	00°00'00"
0+45.00	10.00'	3.43'	16.48'	09°23'33"
1+00.00	25.00'	8.37'	40.24'	23°28'54"
1+12.91	12.91'	4.41'	23.22'	12°07'33"

Def. / Ft. = 56.3560 Min.

RUSHWOOD & RUSHWOOD CT.  
(LOT 1 THRU 9)  
INTERSECTION QUANTITIES

S.T. Concrete Pavement  
S.T. Asphaltic Conc. Pavement (3" Bituminous Base)  
S.T. Bituminous Base  
L.F. Combined Curb & Gutter (6 5/8")  
L.F. Monolithic Edge Curb (6 5/8")  
S.F. 4" Wheelchair Ramp  
S.F. 4" Walk  
C.V. Excavation  
C.V. Compacted Fill  
Lbs. Reinforcing Steel  
S.T. Manipulation  
Tons Lime or Cement  
S.T. V.G. 5" Concrete & 2" Asphaltic Concrete Base

NOTE:  
Top of Curb Elevations Shown For Full Curb, Construct Combined Curb & Gutter (Roll Type).

COVE



Scale: 1" = 20'

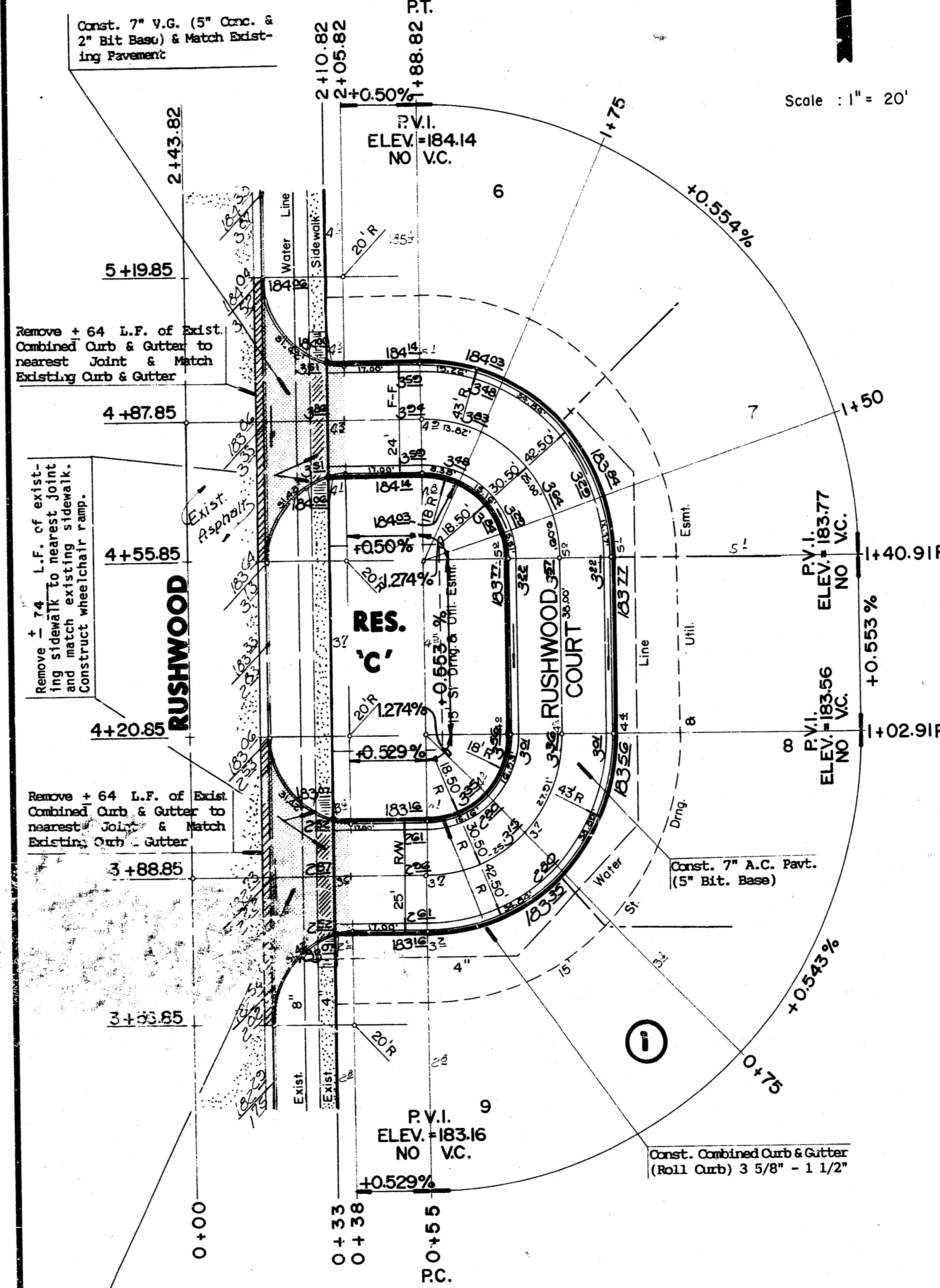

Const. 7" V.G. (5" Conc. & 2" Bit Base) & Match Existing Pavement

NOTE:  
Top of Curb Elevations Shown For Full Curb, Construct Combined Curb & Gutter (Roll Type).

SECOND



Scale: 1" = 20'

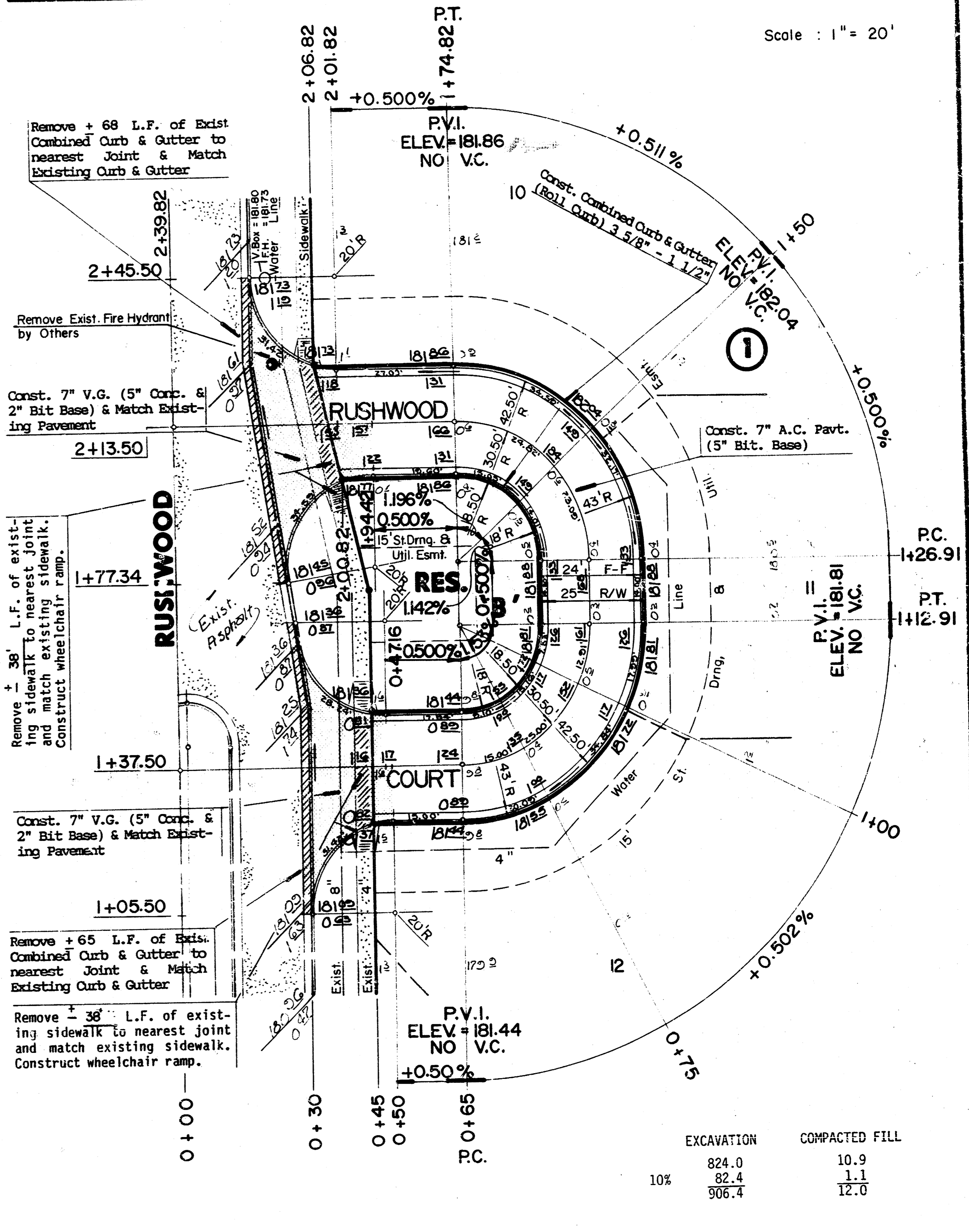

Remove 68 L.F. of exist. Combined Curb & Gutter to nearest Joint & Match Existing Curb & Gutter

Const. 7" V.G. (5" Conc. & 2" Bit Base) & Match Existing Pavement

Remove 36' L.F. of existing sidewalk to nearest joint and match existing wheelchair ramp. Construct wheelchair ramp.

	EXCAVATION	COMPACTED FILL
10%	824.0	10.9
	82.4	1.1
	906.4	12.0



CITY OF WICHITA  
**RUSHWOOD COURTS**  
LOT 1 THRU 5 BLK. 1  
LOT 6 THRU 9 BLK. 1  
LOT 10 THRU 12 BLK. 1  
PROJECT NO. 472-76-245-81571-000-000-001

MJD-KANSAS ENGINEERING CONSULTANTS PA  
3500 NORTH ROCK ROAD  
BUILDING #800  
WICHITA, KANSAS 67226

F.F.KKL  
Checked by FF  
Date April, 1987  
Sheet 3 of 7

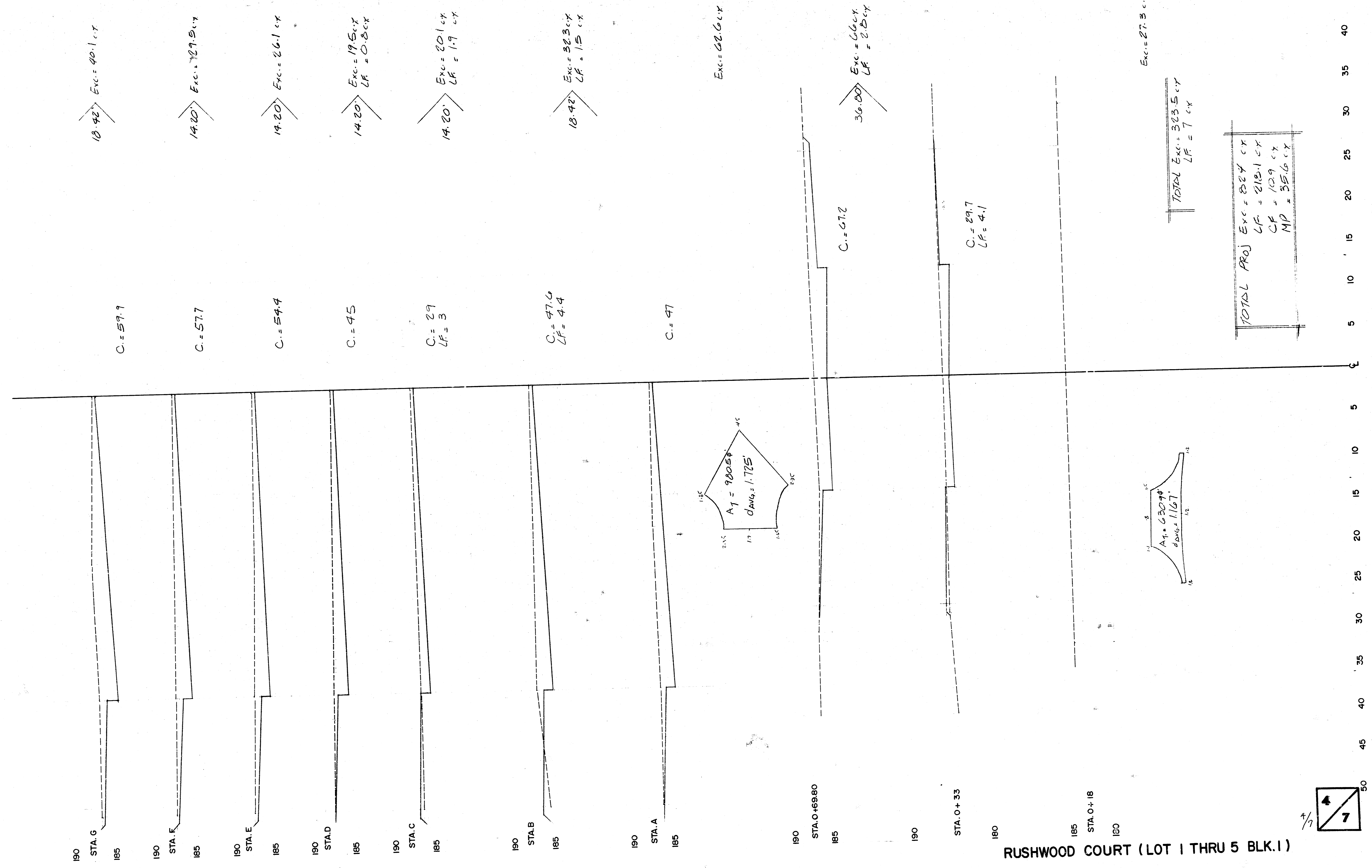

RUSHWOOD COURT (LOT 1 THRU 5 BLK. 1)

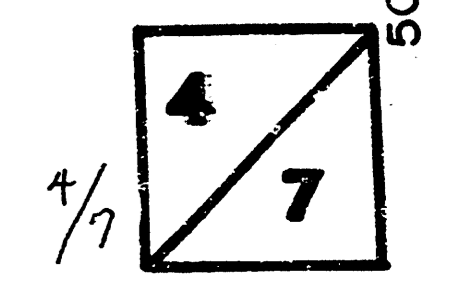

5 10 15 20 25 30 35 40 45 50

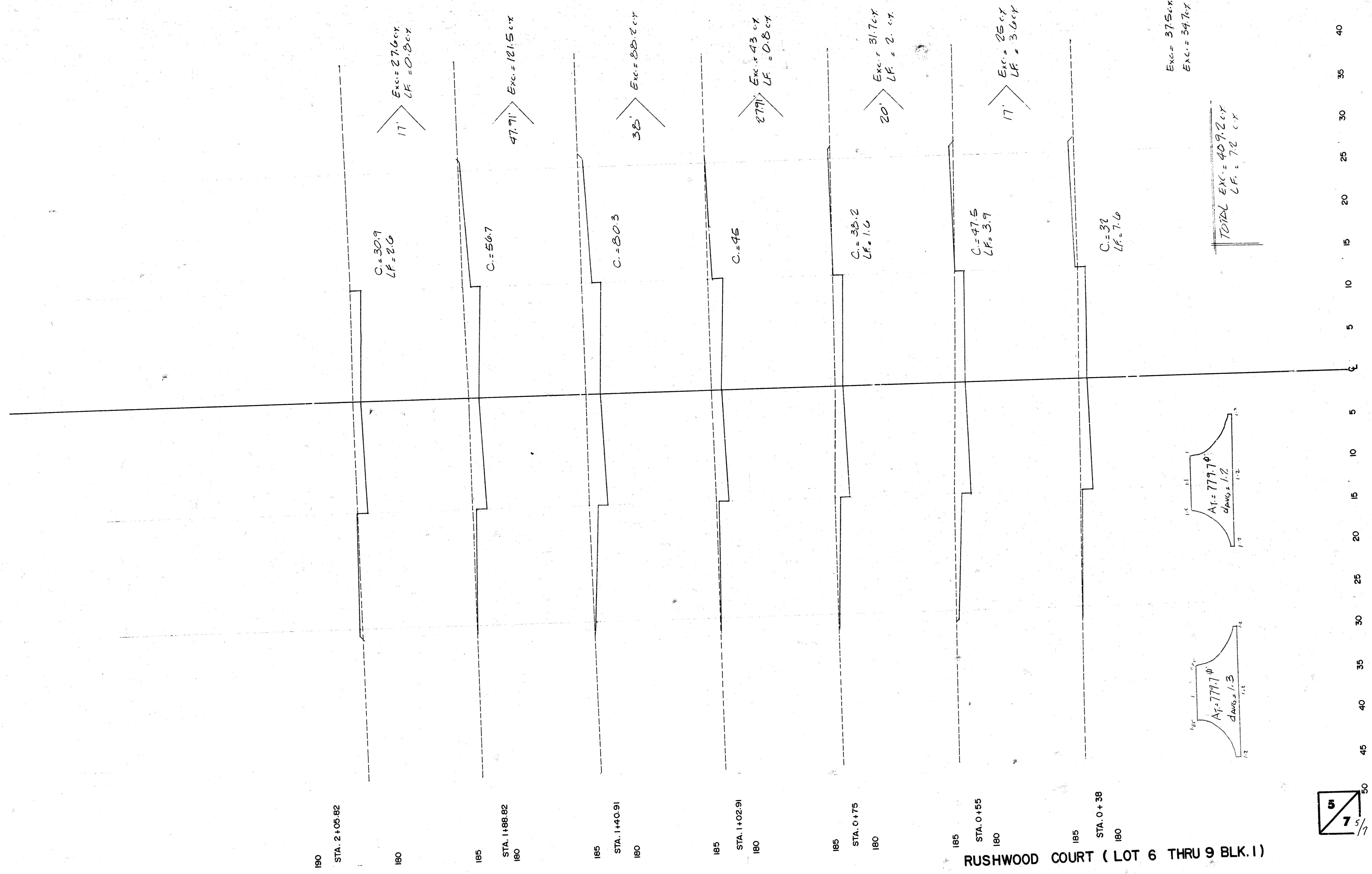

Exc. = 375.6 cy  
 Exc. = 547.6 cy

TOTAL EXC. = 409.2 cy  
 LF = 72 cy



RUSHWOOD COURT (LOT 6 THRU 9 BLK. 1)

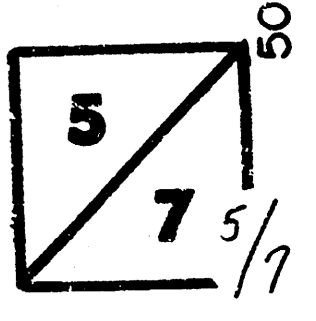

45  
40  
35  
30  
25  
20  
15  
10  
5  
0  
5  
10  
15  
20  
25  
30  
35  
40  
45  
50

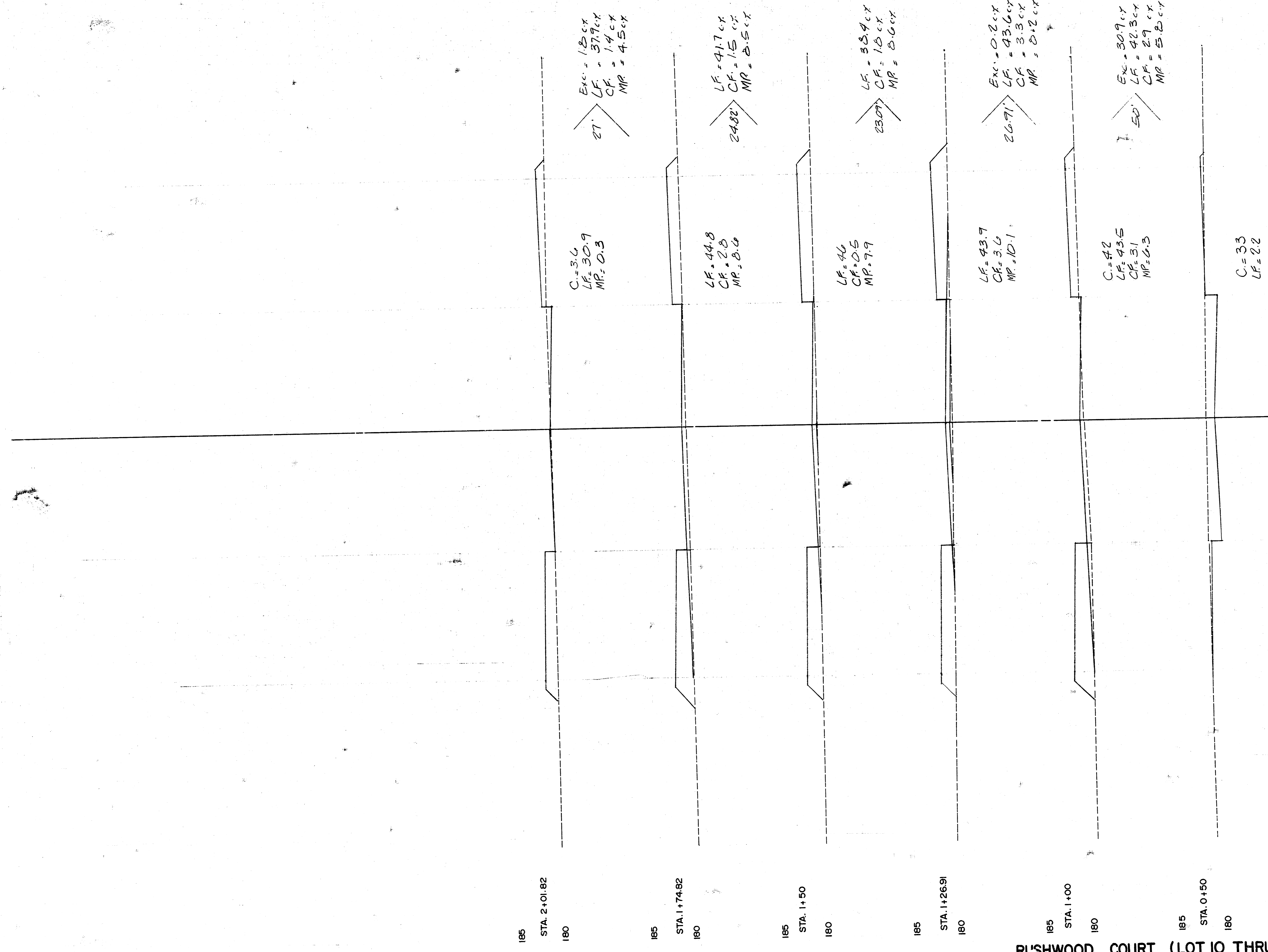

TOTAL Exc. = 713 cy  
 LF = 203.9 cy  
 CF = 10.9 cy  
 MR = 35.6 cy

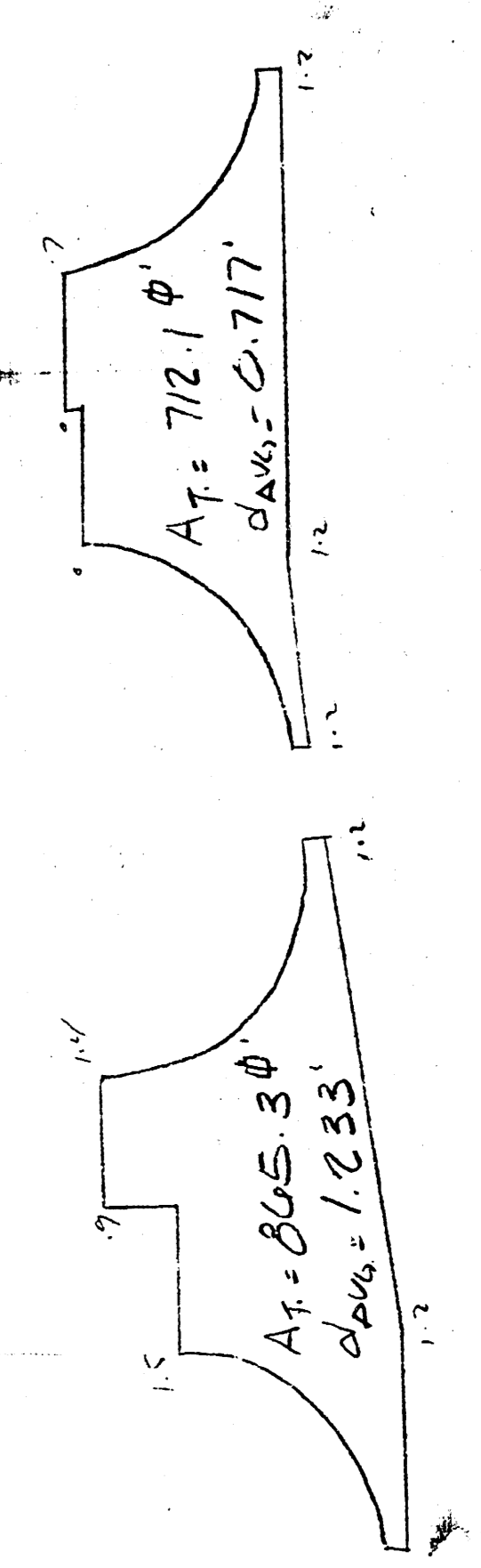

RUSHWOOD COURT (LOT 10 THRU 12 BLK. 1)

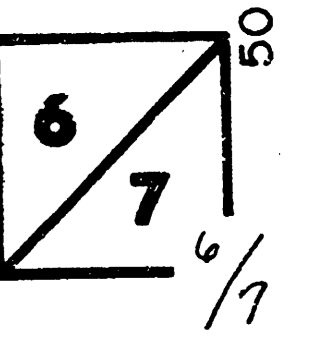

50  
45  
40  
35  
30  
25  
20  
15  
10  
5  
0  
5  
10  
15  
20  
25  
30  
35  
40  
45

