

103.50 B.M. #1 - G.R. Spike N.S. Bell Pole on E.S. Side Hillside Approx. 95' N. of 4 31<sup>st</sup> St. So.  
 129.00 B.M. #2 - G.R. Spike N.S. Power Pole W.S. Rutan S. Side 31<sup>st</sup> St. So.  
 130.07 B.M. #3 - E.S.E. E. on flange of fire plug N.W. cor. Sayles & Rutan

NOTE: Full curb to be built bet 31<sup>st</sup> & Dunham,  
 & bet Dunham & Ross Parkway.  
 Roll curb to be built bet Dunham &  
 Sunnybrook.

Scale: 1"=20'

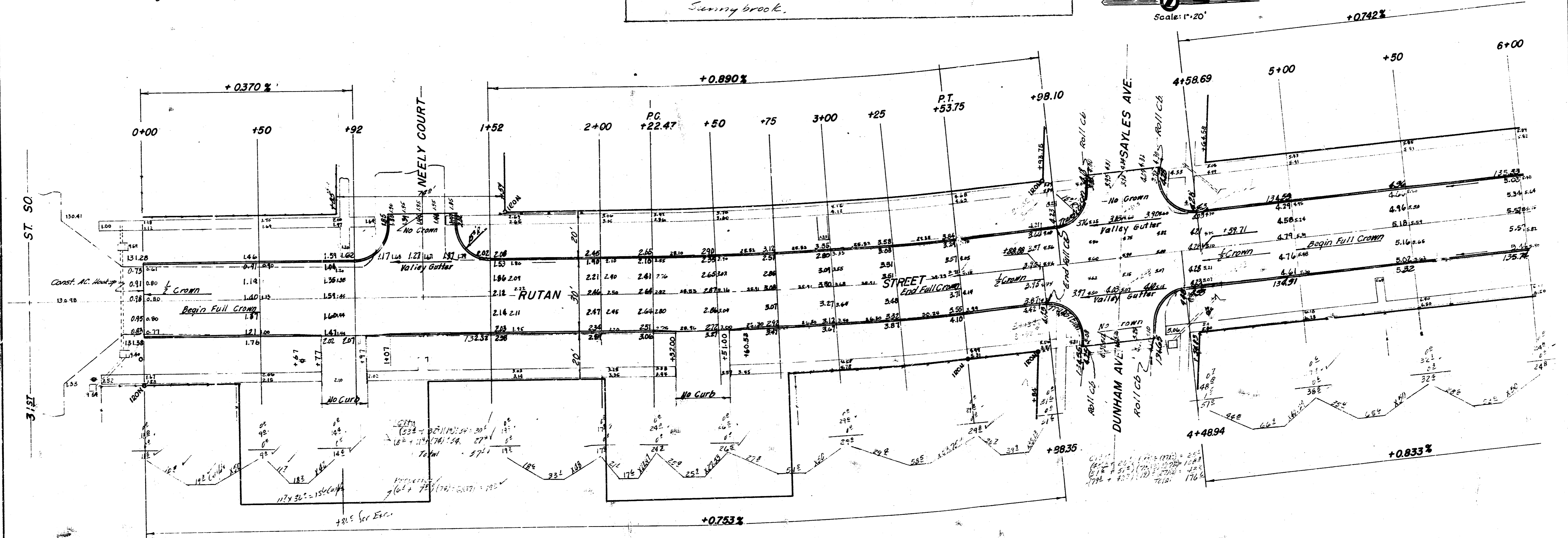

CURVE DATA BASED ON W.R. RAD. 96433 Δ = 7°48'

STATION	ARC LENGTH	CHORD LEN.	CHORD LEN.	CHORD LEN.	CHORD LEN.	TOTAL DEFLECTION
		①	②	③	④	
2+22.47	P.C.					0° 00' 00"
+50		27.53	27.67	24.18	24.31	0° 09' 04"
+75		25.00	25.31	24.31	24.51	0° 44' 34"
3+00		25.00	25.31	26.51	26.71	0° 44' 34"
+25		25.00	25.31	26.5	26.7	0° 08' 34"
+53.75		23.75	24.12	30.81	31.18	0° 51' 14"

DEFLECTION PER FOOT OF CURVE = 1.78245'

DATE: 1960  
 145.50  
 146.00  
 146.50

NOTE: Asphalt surface to be disposed of in  
 Plainview Area in accordance with instruc-  
 tions of the Street Maintenance Superintendent.

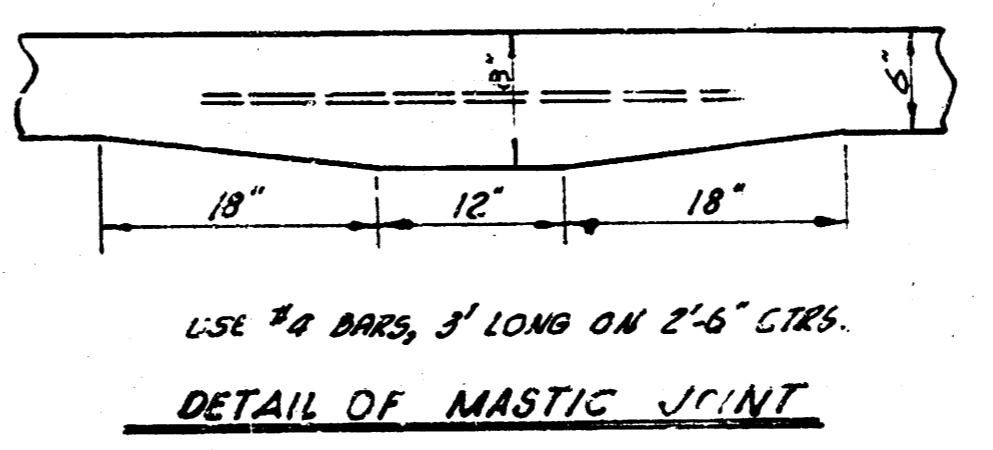

**RUTAN STREET**  
 N.L. 31<sup>st</sup> ST. SO. TO S.L. ROSS PARKWAY  
**30' CONC. & CB.**  
 CITY OF WICHITA, KANSAS  
 B. E. SMITH CITY ENGINEER  
 DATE: SEPT. 1960 PROJ. NO. C19-221

D.M. # 4 131.79 S.W. Corner Conc. Porch House 2936 Rutan

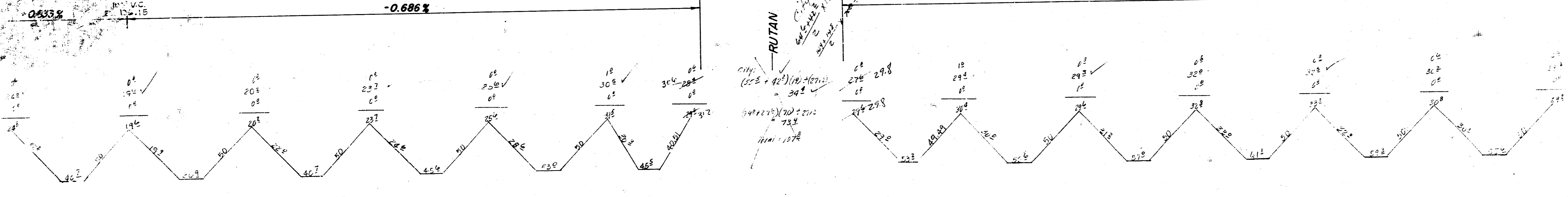
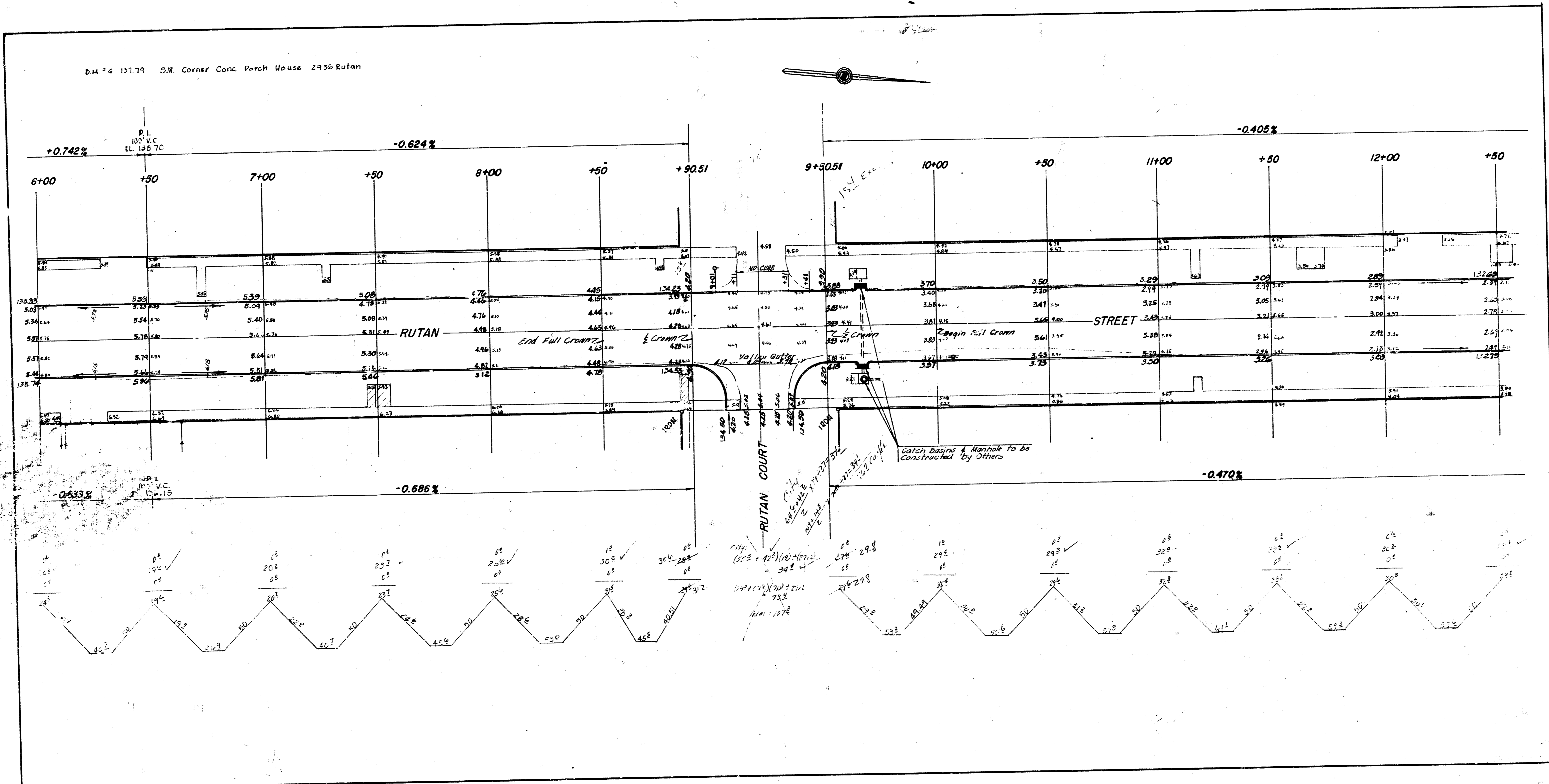
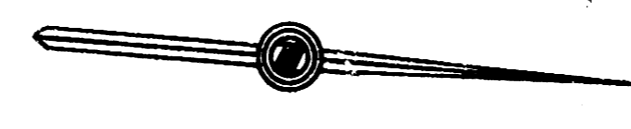

B.M. #5 134.06 SW Corner Bottom Step Church N.E. Corner Rutan & Sunnybrook  
 B.M. #6 111.08 RR Spike V. Face P. Pole 10' E., 6' N of Iron S.E. Rutan & Ross Parkway

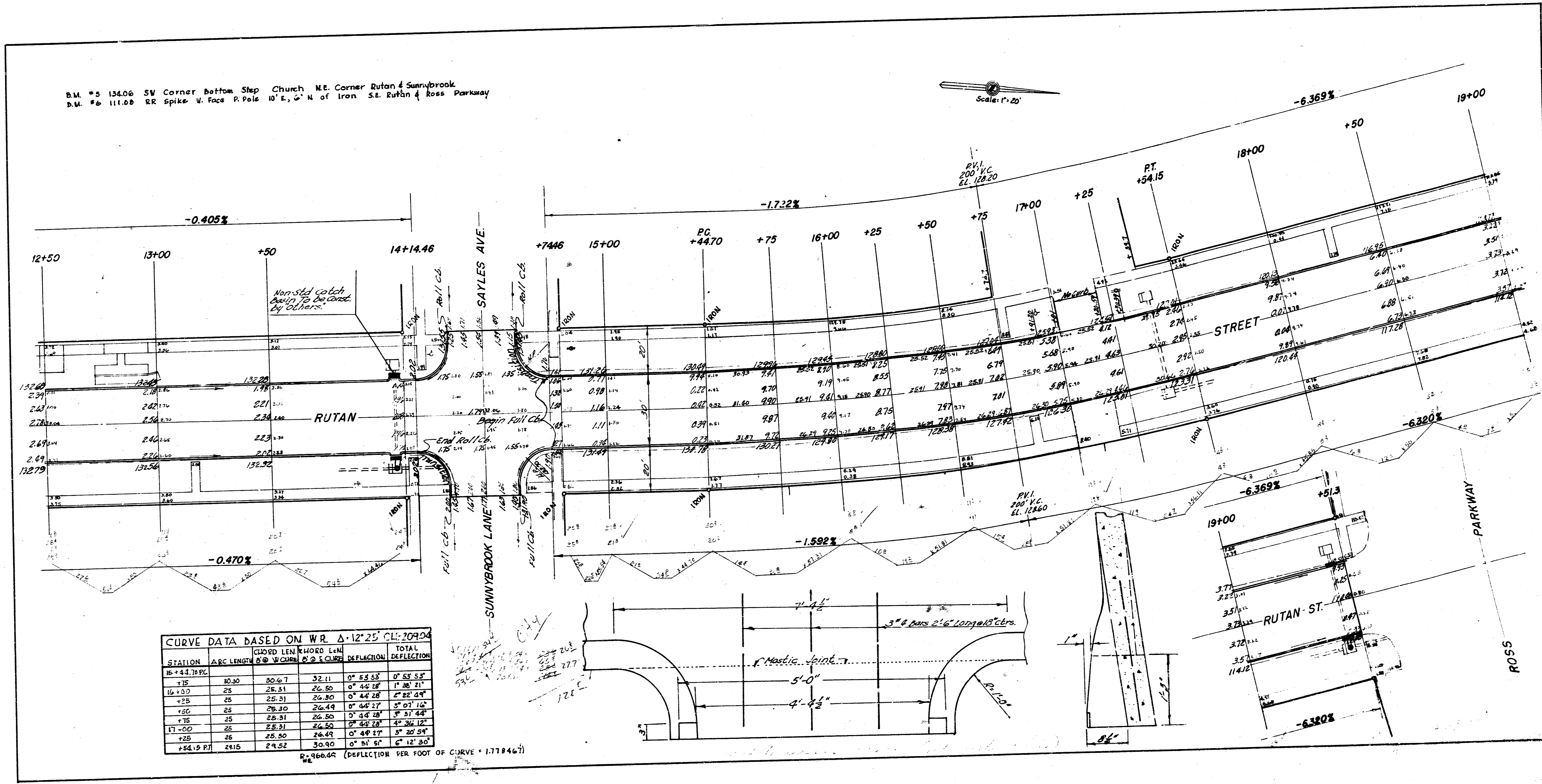
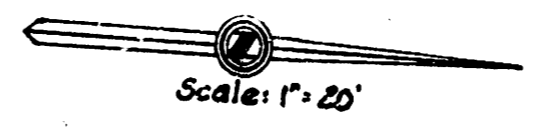

CURVE DATA BASED ON W R Δ=12°25' CL=209.04

STATION	ARC LENGTH	CHORD LEN	RHORD LEN	DEFLECTION	TOTAL DEFLECTION
14+44.70 PC	30.30	30.467	32.11	0° 53' 53"	0° 53' 53"
+15	25	25.31	26.50	0° 46' 18"	1° 00' 11"
+20	25	25.31	26.50	0° 46' 18"	1° 56' 29"
+25	25	25.31	26.50	0° 46' 18"	2° 42' 47"
+30	25	25.31	26.50	0° 46' 18"	3° 29' 05"
+35	25	25.31	26.50	0° 46' 18"	4° 15' 23"
+40	25	25.31	26.50	0° 46' 18"	5° 01' 41"
+45	25	25.31	26.50	0° 46' 18"	5° 47' 59"
+50	25	25.31	26.50	0° 46' 18"	6° 34' 17"
+54.15 PT	24.15	24.32	30.40	0° 51' 51"	7° 26' 08"

Δ=1966.64 (DEFLECTION PER FOOT OF CURVE = 1.77846%)

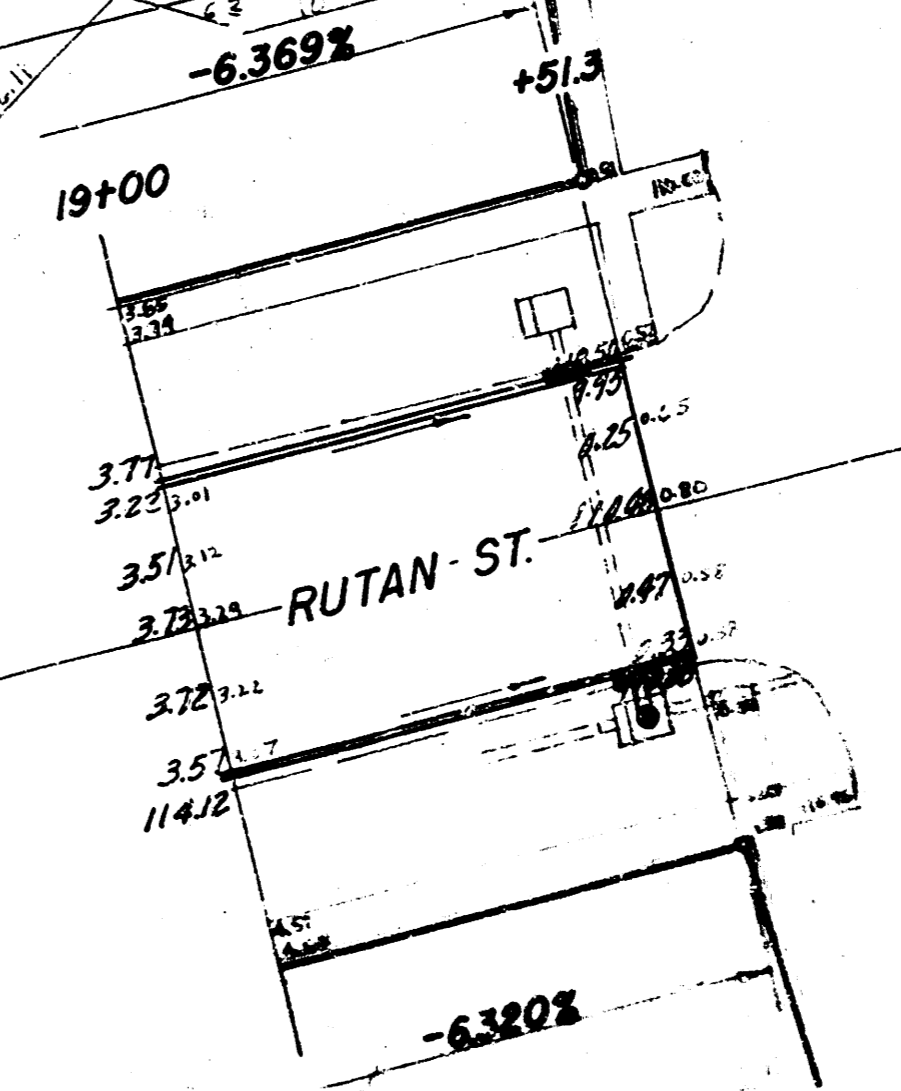
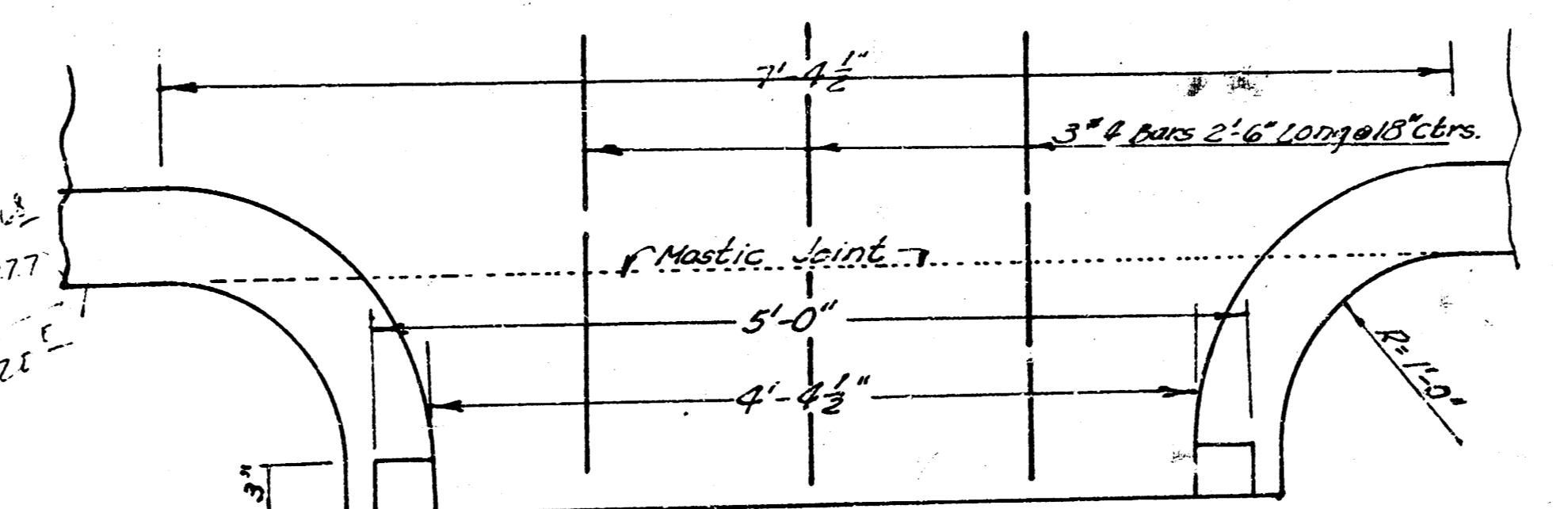

SUNNYBROOK LANE  
 PLAN  
 CHECKED BY:

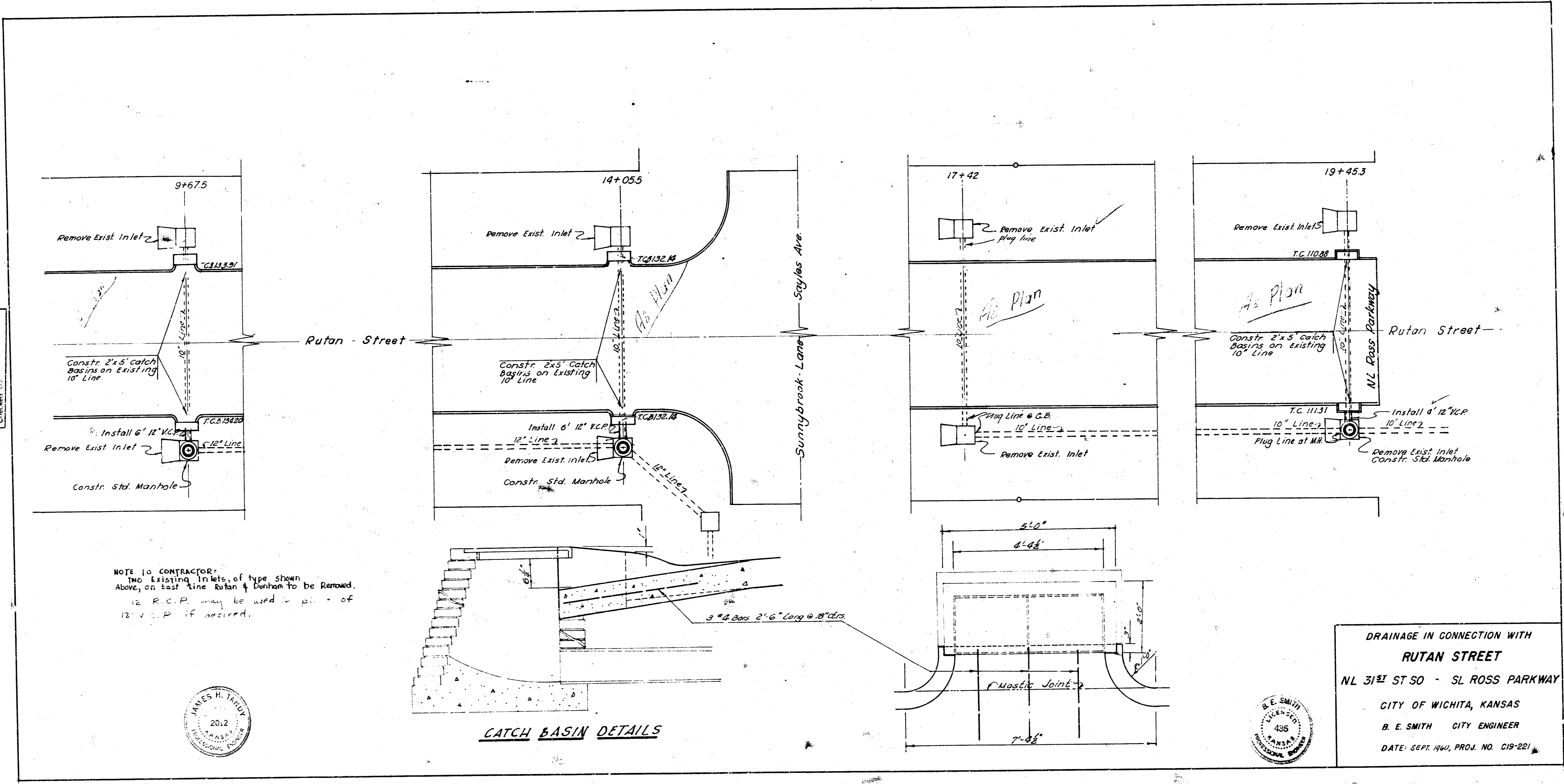

NOTE TO CONTRACTOR:  
 TWO EXISTING INLETS, OF TYPE SHOWN  
 ABOVE, ON EAST LINE RUTAN & DUNHAM TO BE REMOVED.  
 12 R.C.P. MAY BE USED IN PLACE OF  
 12 V.C.P. IF DESIRED.

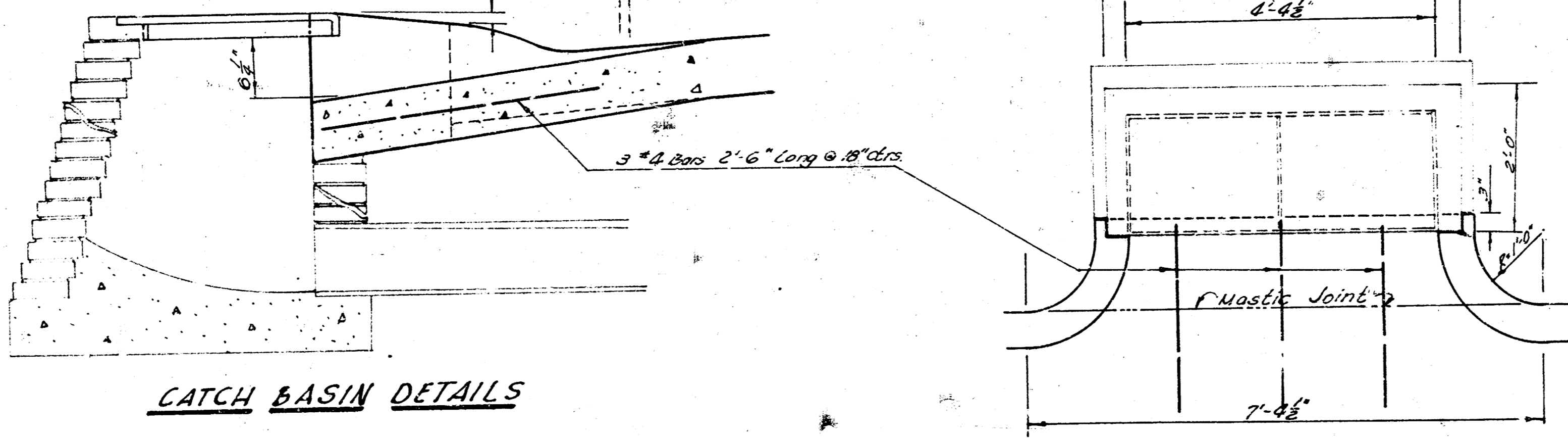
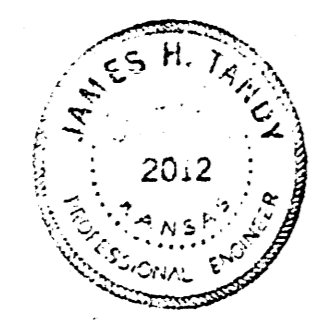

DRAINAGE IN CONNECTION WITH  
**RUTAN STREET**  
 NL 31<sup>ST</sup> ST SO - SL ROSS PARKWAY  
 CITY OF WICHITA, KANSAS  
 B. E. SMITH CITY ENGINEER  
 DATE: SEPT. 1940, PROJ. NO. C19-221