

CURVE DATA

STATIONING ON W. P.L. STA. 1+18.30 TO STA. 7+27.74
 $R = 742.95'$ Min. per running ft. = 2.3136, $\frac{A}{R} = 28^{\circ}-30'-00''$

STATIONS	Arc length West P.L. $R = 742.95'$	Chord length 8' offset from Face of W. cb. $R = 735.95'$	Chord length 8' offset from Face of E. cb. $R = 688.95'$	Deflection	TOTAL Deflection
1+18.30 RC.					
1+50	31.70	31.40'	29.13'	1° 13' 20"	1° 13' 20"
2+00	50.00	49.53'	46.43'	1° 55' 41"	3° 09' 01"
2+50	"	"	"	"	5° 04' 42"
3+00	"	"	"	"	7° 00' 23"
3+50	"	49.52'	46.42'	1° 55' 40"	8° 56' 03"
4+00	"	49.53'	46.43'	1° 55' 41"	10° 51' 44"
4+50	"	"	"	"	12° 47' 25"
5+00	"	"	"	"	14° 43' 06"
5+50	"	49.52'	46.42'	1° 55' 40"	16° 38' 46"
6+00	"	49.53'	46.43'	1° 55' 41"	18° 34' 27"
6+50	"	"	"	"	20° 30' 08"
7+00	"	"	"	"	22° 25' 49"
7+27.74 RT. 27.74		27.48'	25.76'	1° 04' 11"	23° 30' 00"

B.M. 176.83 R in Ritchie top N. end N.W. Rod. @ Elm & Rutland.
 B.M. 182.19 S.E. cor. conc. porch No. 607 Armour.
 Stationing & Baseline on west Property Line of Rutland.

EARTH WORK
EXCAVATION

CITY	PROP.
0.0	1555.4
+10%	163.5
0.0	1,820.9 Cu. Yds.



RUTLAND
 N.W. Elm St. To EL 2nd Addn.
 To Woodlawn Village
 26'-2"-30' A.C.
CITY OF WICHITA, KANSAS
 B. E. SMITH CITY ENGINEER
 OCT. 1959, PROJ. NO. C13-204

B.M. 176.83 "R" in Ritchie N. End NW Rod. @ Elm of Rutland

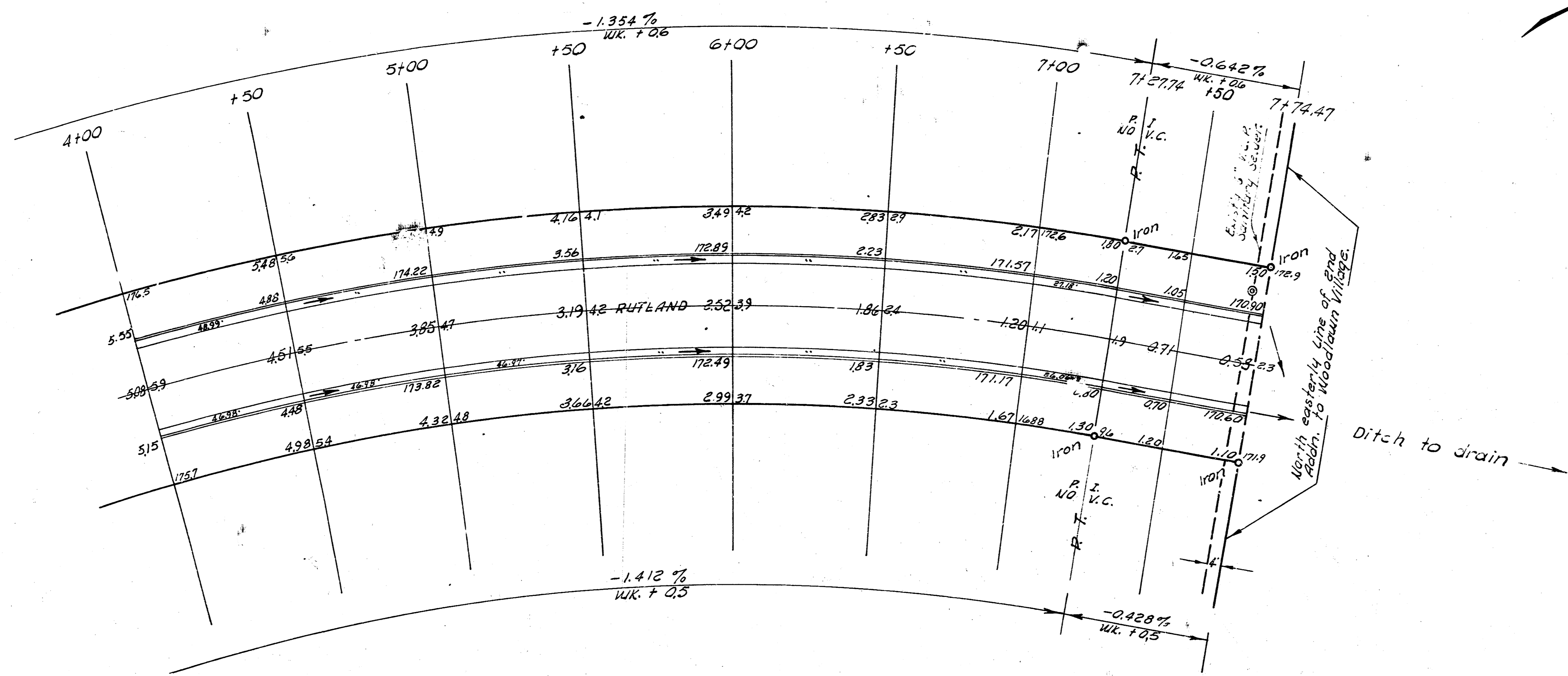
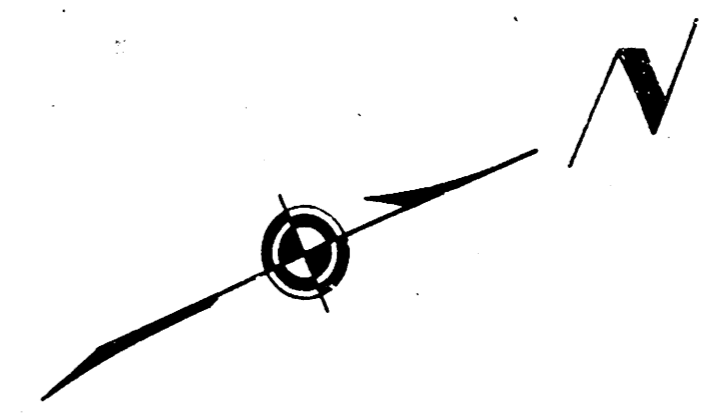

Ditch to drain

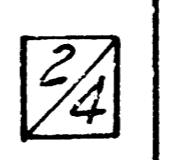

RUTLAND

PROJ. NO. C18-204