

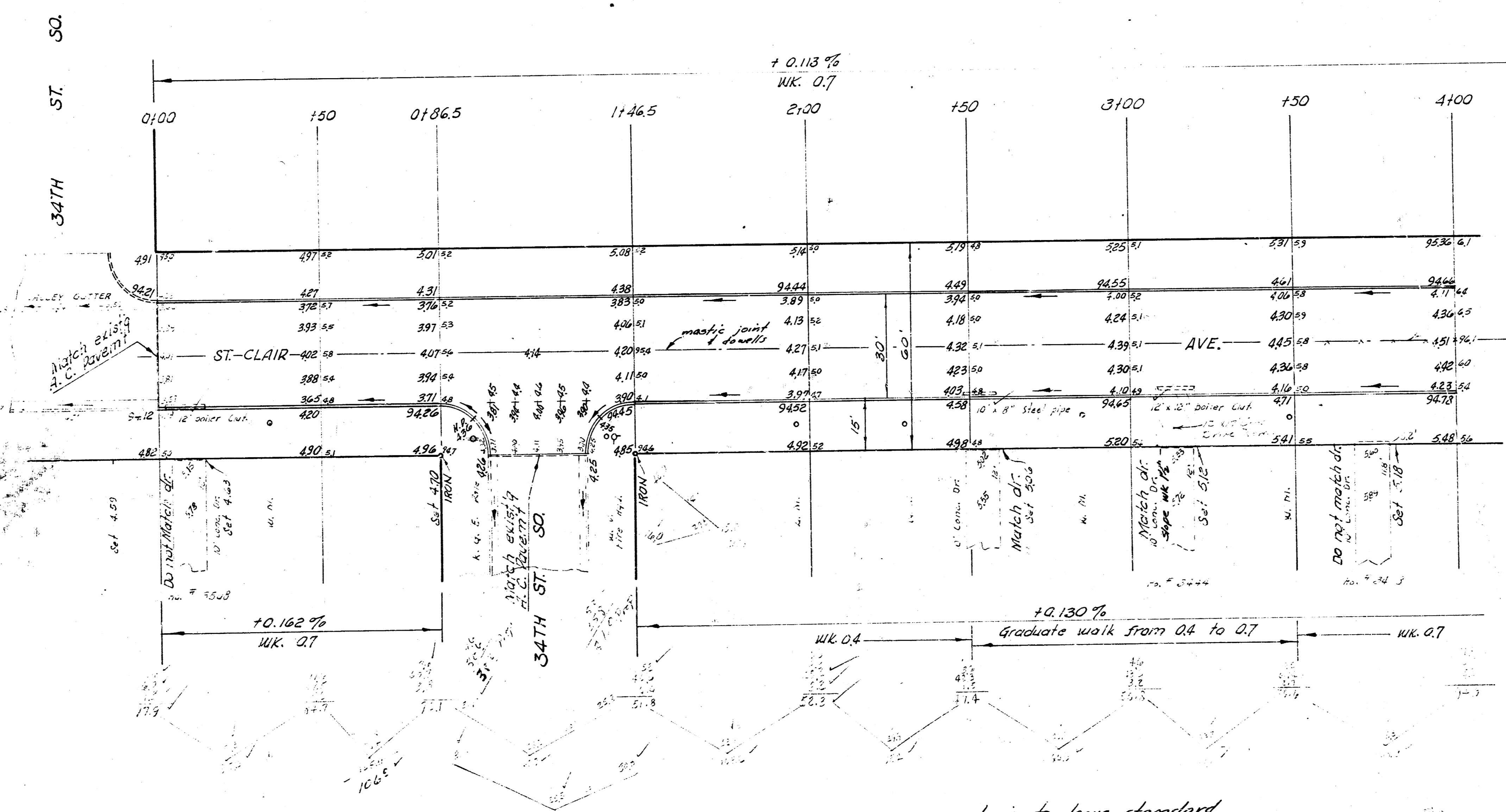

B. M. 94.31 "P" in P.K.S. S. of 34th St. So. E. of St. Clair Ave.  
 B. M. 95.35 "P" in P.K.S. N. end road E. of St. Clair N.L. 33rd St. So.  
 B. M. 97.64 S.E. cor. porch No. 441 cor. 33rd St. So. & Everett Ave.  
 Base = East 1/2 St. Clair Ave.

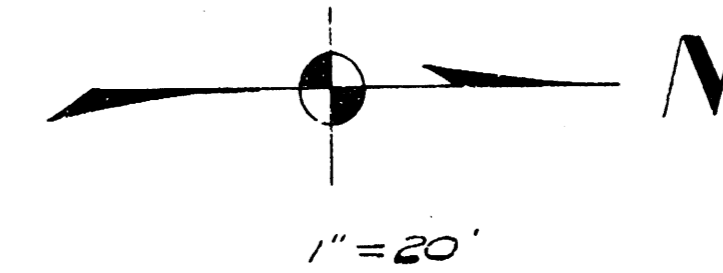

EARTHWORK EXCAVATION	
CITY	PROR.
71.7	1715.9
7.2	171.6
78.9 cu. yds.	1887.5 cu. yds.



NOTE: This project is to have standard mastic center line joint with dowell steel

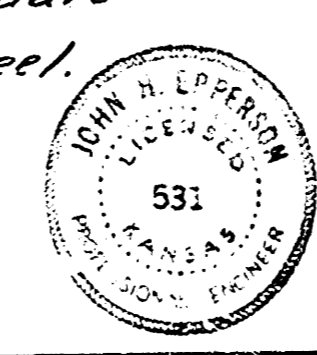

**ST. CLAIR AVE.**  
 N.L. 34TH ST. SO. TO S.L. 33RD ST. SO.  
**30' CONC. & C.B.**  
 CITY OF WICHITA, KANSAS  
 B. E. SMITH CITY ENGINEER  
 MAY, 1962 PROJ. NO. C10-63

