

B. M. 97.605 U. S. G. S. S.W. Meridian & 31ST. ST. S2

Stations on E. E.

B. M. 77.24 on E. Cor. Porch to NW cor 33rd & Everett

**NOTICE TO CONTRACTOR:**

All entrance pipes are to be disposed of in accordance with instructions from the city dirt checker.

NOTES:

SCALE 1"=20'

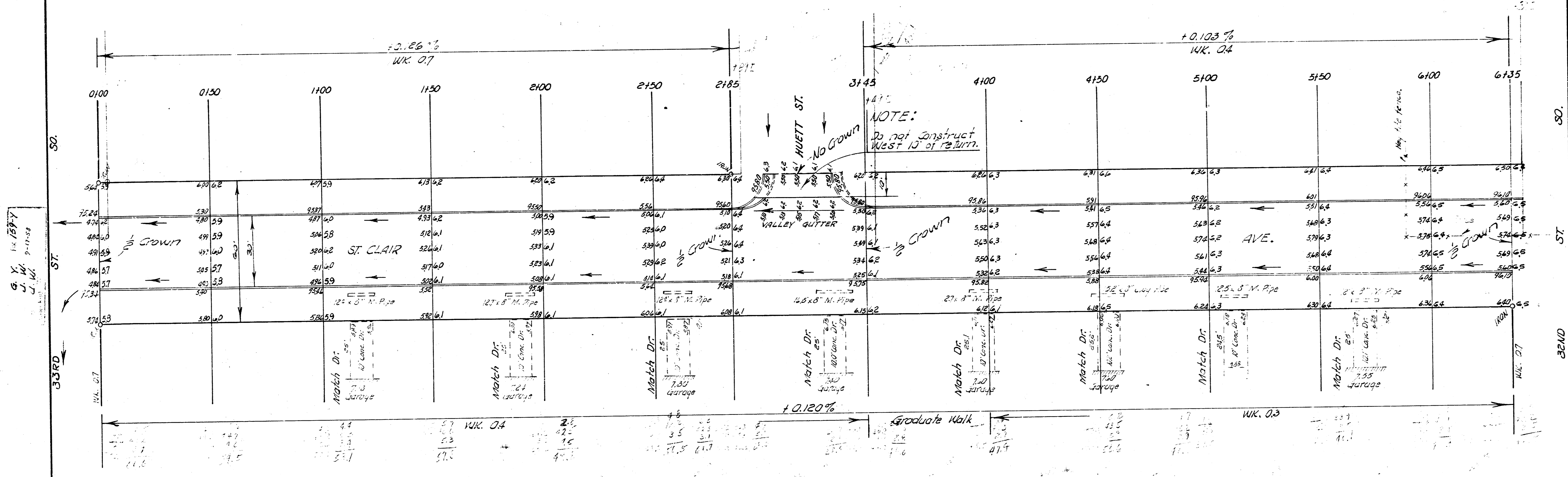

excavation

CITY	PROP
185.9	146.5
18.6	146.1
204.5 Cu Yds	1606.6 Cu Yds

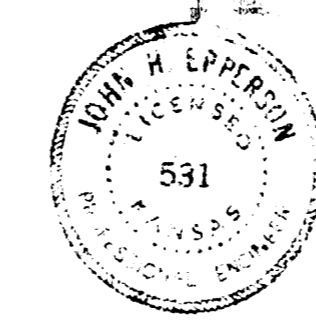

1/2

**ST. CLAIR AVE.**  
 NL 33RD. ST. SO. TO SL 31ST. ST. SO.  
 30' CONC. & CB.  
 CITY OF WICHITA, KANSAS  
 B. E. SMITH - CITY ENGINEER  
 SEPT. 1958, PROJ. NO. C16-173

