

CURVE DATA FROM STA. 1156.45 TO STA. 2177.98
STATIONING ON E. R. $\frac{1}{2} \Delta = 18^{\circ}-19'-28''$

Stationing on E. R. $R=190.02'$	Arc length on E. R. $R=190.02'$	Chord length for 3' offset from face of West curb. $R=137.02'$	Chord length for 3' offset from face of East curb. $R=183.02'$	Deflection	Total Deflection
1156.45	13.55'	13.36'	17.86'	2°-47'-49"	2°-47'-49"
2100	25.00'	18.00'	24.02'	3°-42'-10"	6°-33'-59"
2125	25.00'	18.00'	24.02'	3°-42'-11"	10°-20'-10"
2150	25.00'	18.00'	24.02'	3°-42'-10"	14°-06'-20"
2177.98	27.93'	20.16'	26.93'	4°-13'-08"	18°-19'-28"

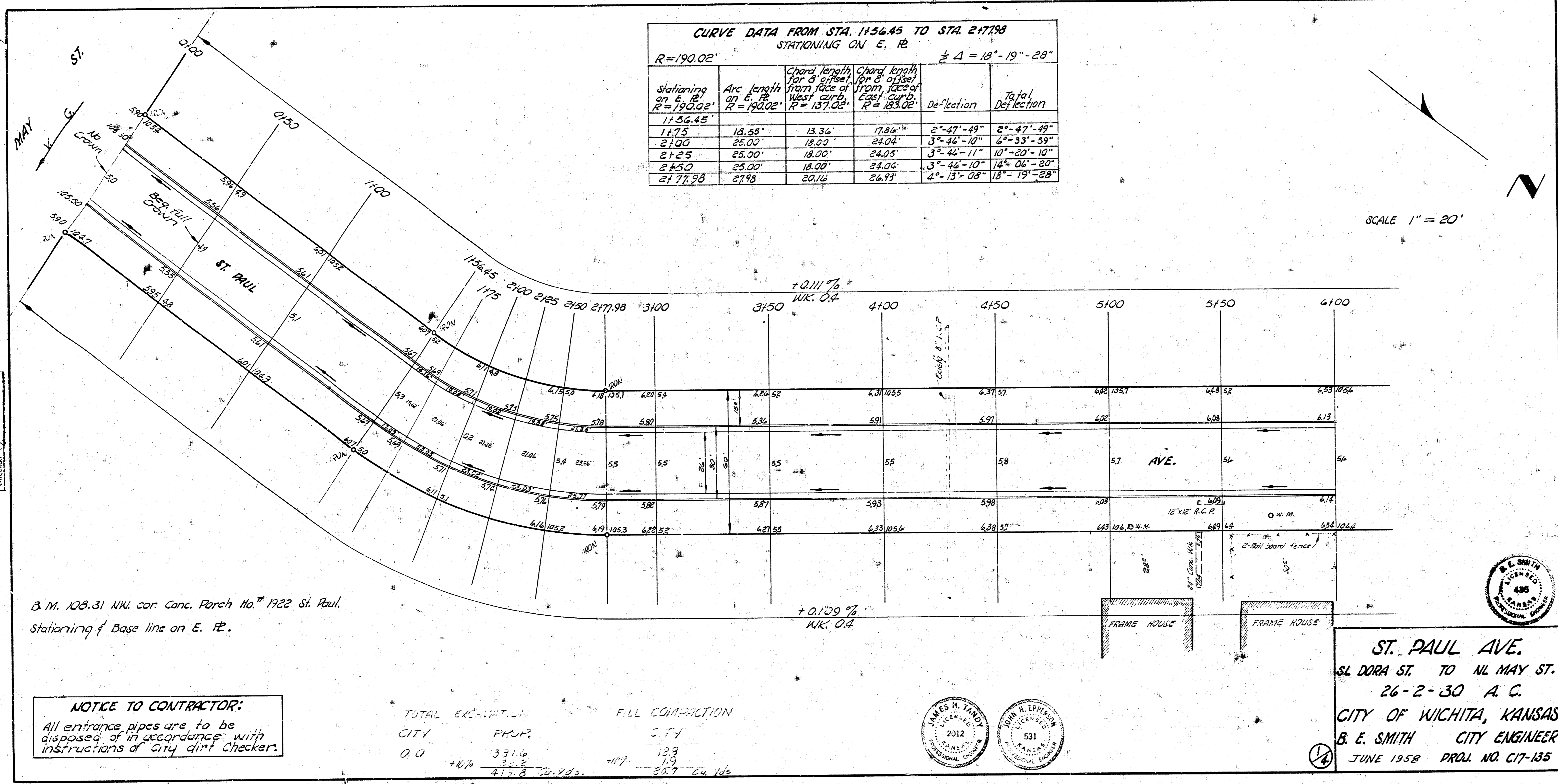

SCALE 1" = 20'

B.M. 108.31 NW. cor. Conc. Porch No. 1922 St. Paul.
Stationing of Base line on E. R.

NOTICE TO CONTRACTOR:
All entrance pipes are to be disposed of in accordance with instructions of City dirt checker.

TOTAL EXCAVATION		FILL COMPLETION	
CITY	PROP.	CITY	PROP.
0.0	331.6	12.3	1.9
+4.7%	377.8	+1.7%	20.7

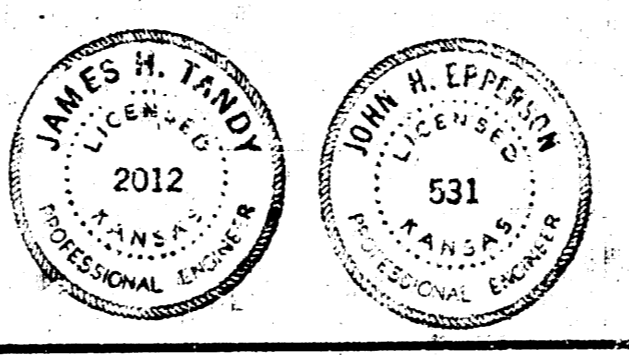

ST. PAUL AVE.
SL DORA ST. TO NW MAY ST.
26-2-30 A.C.
CITY OF WICHITA, KANSAS
B. E. SMITH CITY ENGINEER
JUNE 1958 PROJ. NO. C17-135

B. M. 109.04 SE cor. Conc. Porch No. *3026 Dorr.
 Stationing of Baseline on E. 12.

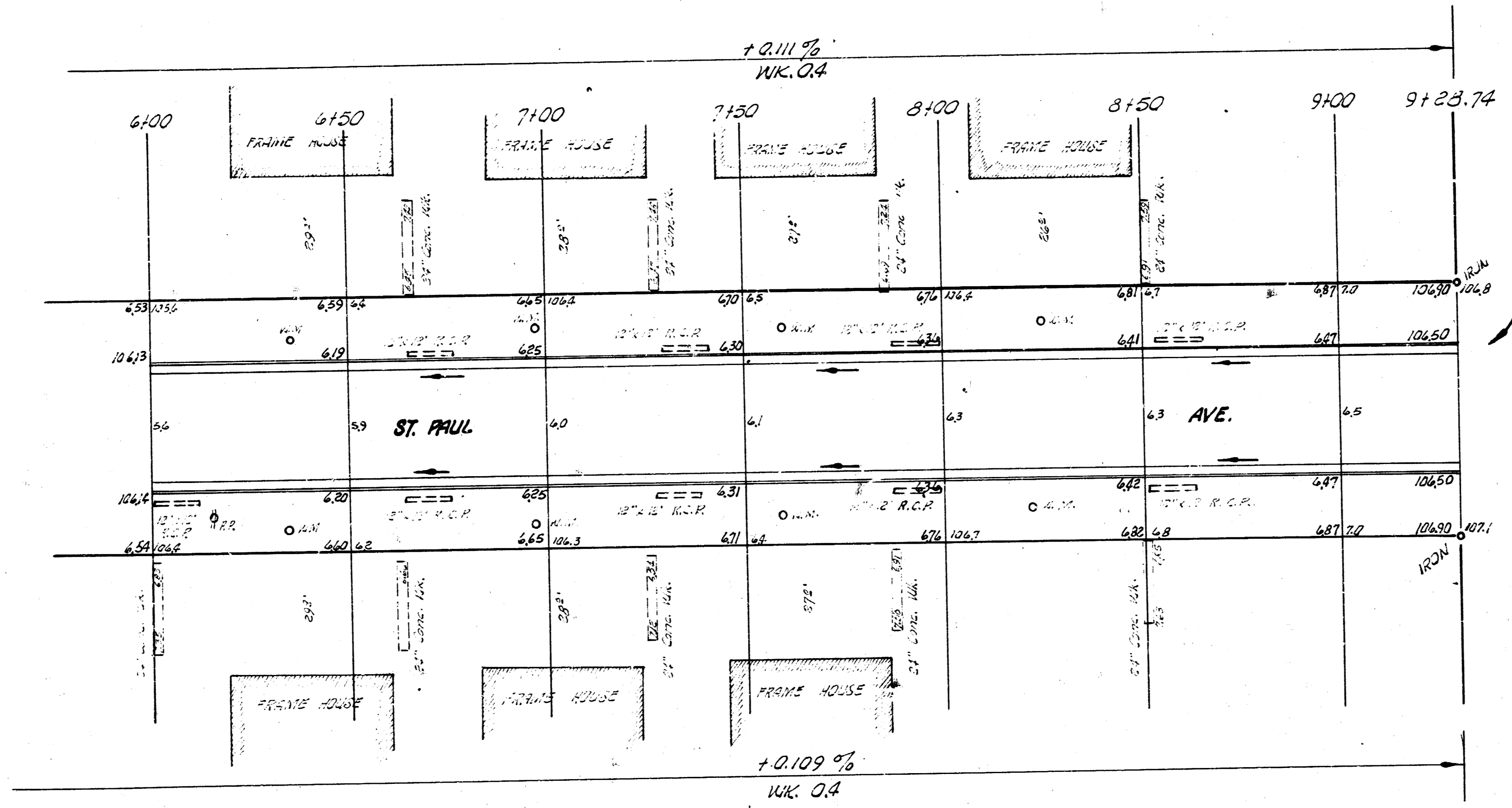

SCALE 1" = 20'

*ST. PAUL AVE.

PROJ. NO. C17-135

24