

B.M. 109.23 Standard G Sheridan & Harry 36' W of 35' S of Both &
 B.M. 110.05 NW Corner Conc. Porch House 1602 St Paul SE Cor. Harry & St Paul
 B.M. 109.27 NE Corner Conc. Porch House 1709 St Paul
 B.M. 109.60 NW Corner Porch N Side House S.W. Corner St Paul & Gordon
 Stationing On North East Prop Line

Surveyed by J. H. ...
 Plotted by ...
 Checked by ...

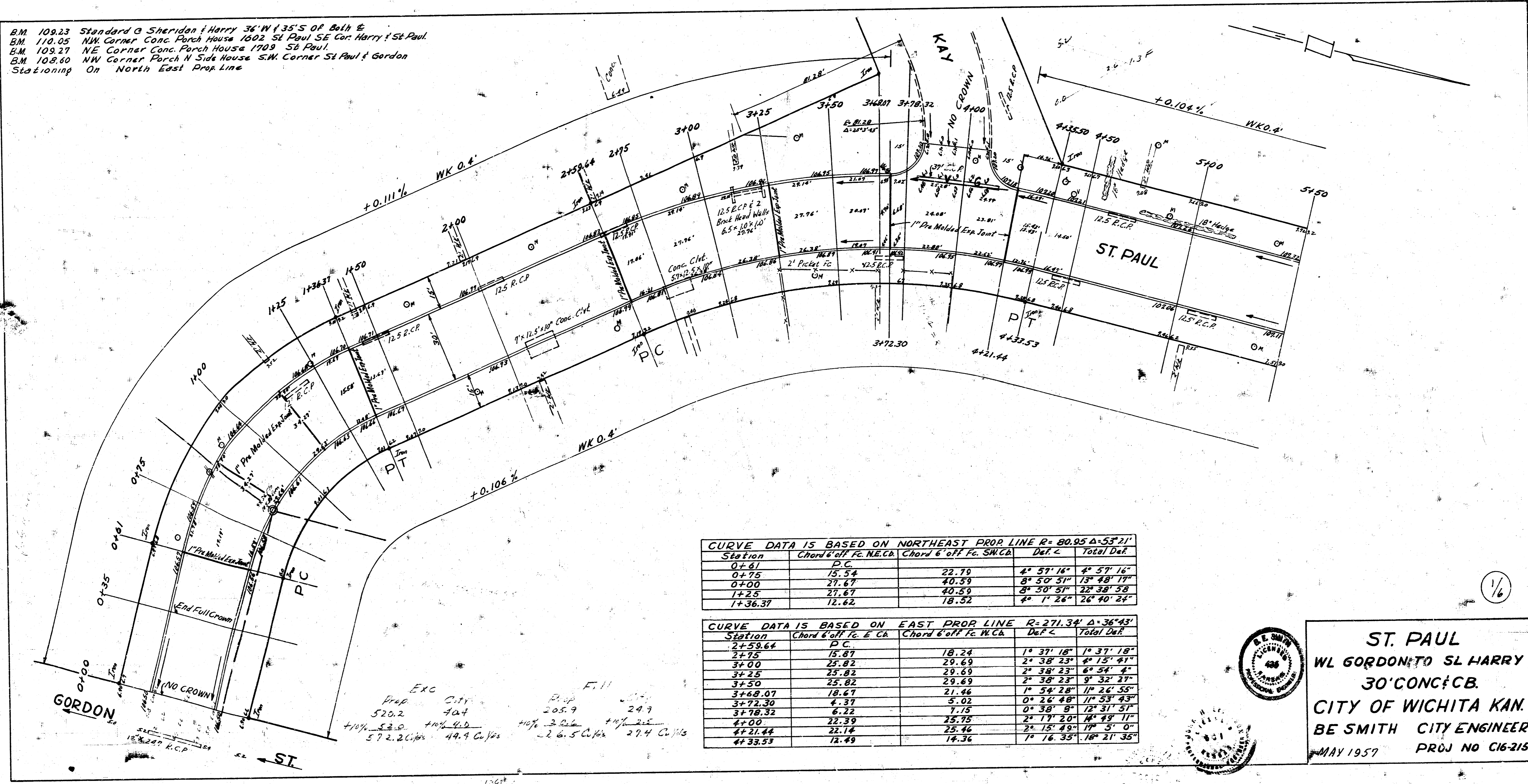

CURVE DATA IS BASED ON NORTHEAST PROP LINE R=80.95 Δ=53°21'

Station	Chord 6' off Fe. NE. Ch.	Chord 6' off Fe. SW. Ch.	Def. C.	Total Def.
0+61	P.C.	27.70	4° 57' 16"	4° 57' 16"
0+75	15.54	40.59	8° 50' 31"	13° 48' 17"
0+00	27.67	40.59	8° 50' 31"	17° 38' 38"
1+25	27.67	18.52	4° 1' 26"	21° 40' 24"
1+36.37	12.62			

CURVE DATA IS BASED ON EAST PROP LINE R=271.34 Δ=36°43'

Station	Chord 6' off Fe. E. Ch.	Chord 6' off Fe. W. Ch.	Def. C.	Total Def.
2+59.64	P.C.	18.24	1° 37' 18"	1° 37' 18"
3+00	25.82	29.69	2° 38' 23"	4° 15' 41"
3+25	25.82	29.69	2° 38' 23"	6° 54' 4"
3+50	25.82	29.69	2° 38' 23"	9° 32' 27"
3+69.07	18.67	5.02	0° 26' 48"	11° 53' 43"
3+72.30	4.37	1.15	0° 38' 8"	12° 31' 51"
3+78.33	6.22	25.75	2° 17' 20"	14° 49' 11"
4+00	22.39	25.46	2° 15' 49"	17° 5' 0"
4+21.44	22.14	14.36	1° 16' 35"	18° 21' 35"
4+33.53	12.49			

EXC. CITY
 520.2 404
 10% 53.0 44.4
 57.2 C. 49.9 C. 27.4 C. 110

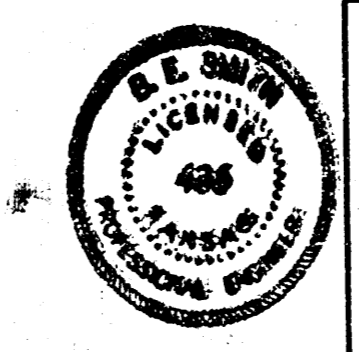

ST. PAUL
 WL GORDON TO SL HARRY
 30' CONC. C.B.
 CITY OF WICHITA KAN.
 BE SMITH CITY ENGINEER
 MAY 1957 PROJ NO C16-215

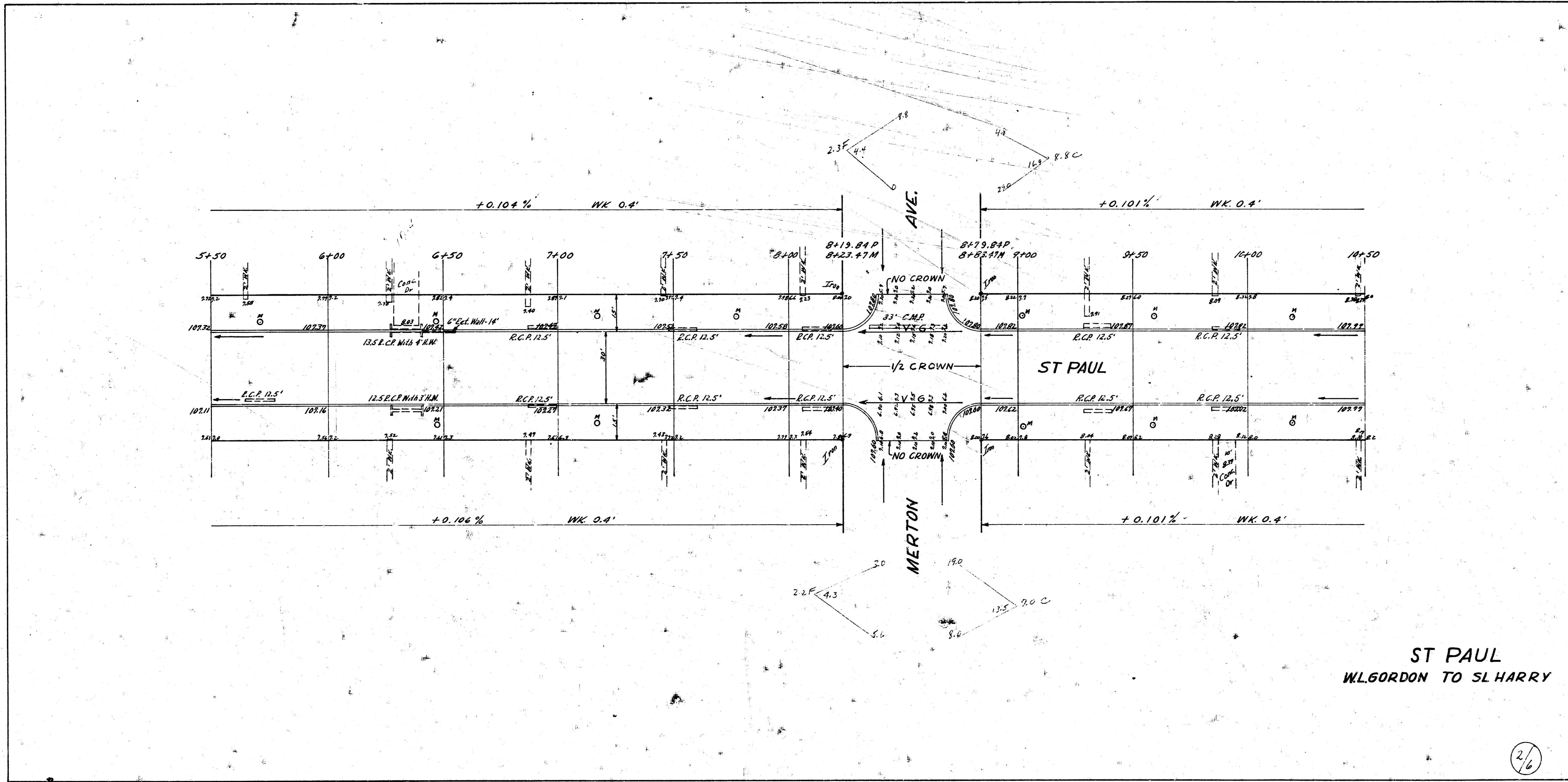

ST PAUL
 WLGORDON TO SL HARRY

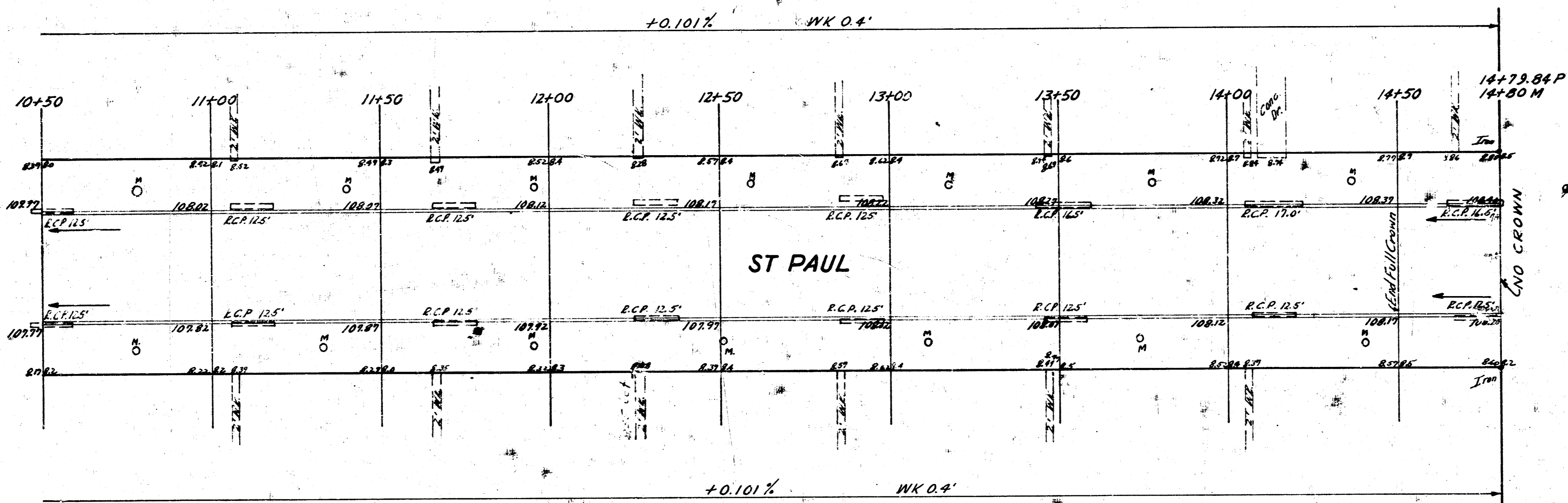

ST. PAUL
 W.L. GORDON TO S.L. HARRY