

B.M. 112.65 "X" on pavement @ Maple & St Paul
 B.M. 113.81 "L" in Le Fever ctr wk. N., N.W. corner St Paul & Burton



PLATTED DIST. IS 18' LONGER THAN MEAS. DIST.

<i>City</i>	<i>Prop</i>
28.7	85.0
18.1	153.7
10.7	74.0
57.5	113.7
110.70	40.0
633 cu yds.	39.4
	40.0
	41.0
	36.7
	756.6
	110.70
	825.7 cu yds.

TOTAL	
<i>City</i>	<i>Prop</i>
36.9	825.7
100.2 cu yds.	741.1
	1546.8 cu yds.

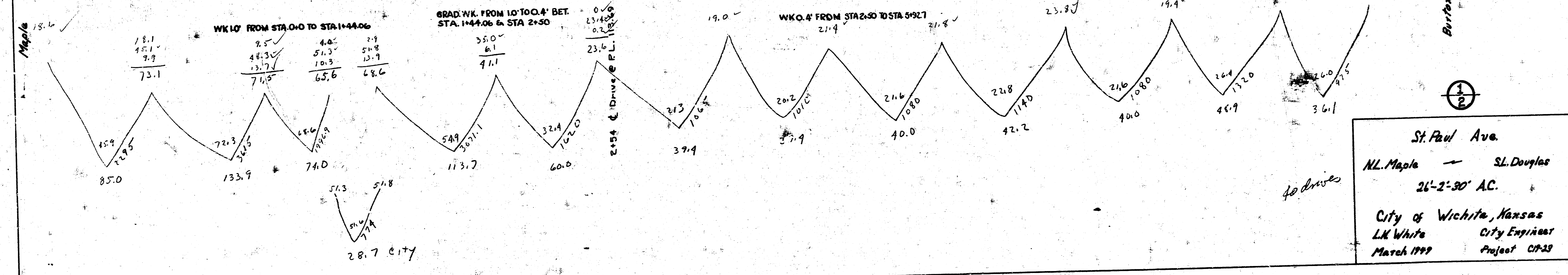
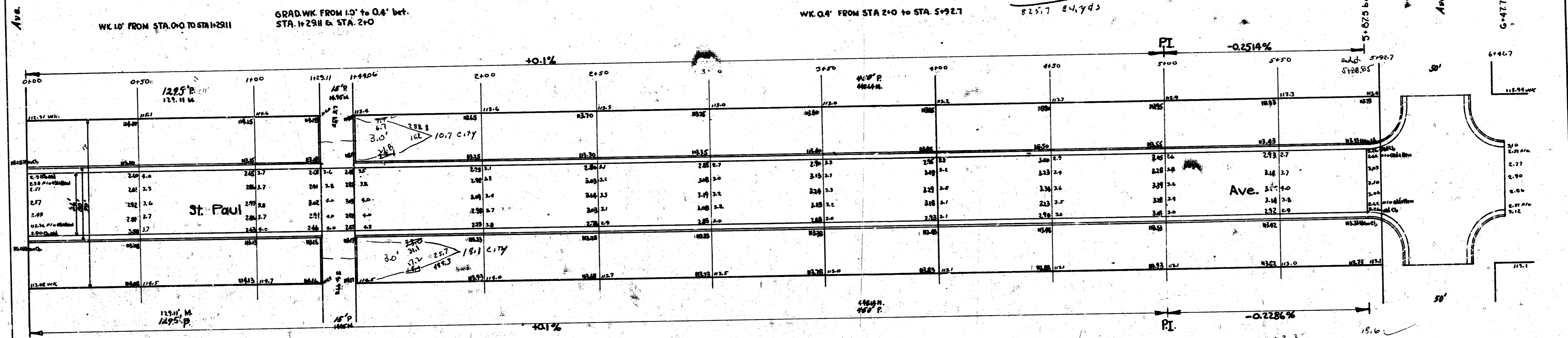

St. Paul Ave.
 N.L. Maple — S.L. Douglas
 26'-2'-30" AC.
 City of Wichita, Kansas
 L.N. White City Engineer
 March 1999 Project 07-23

