

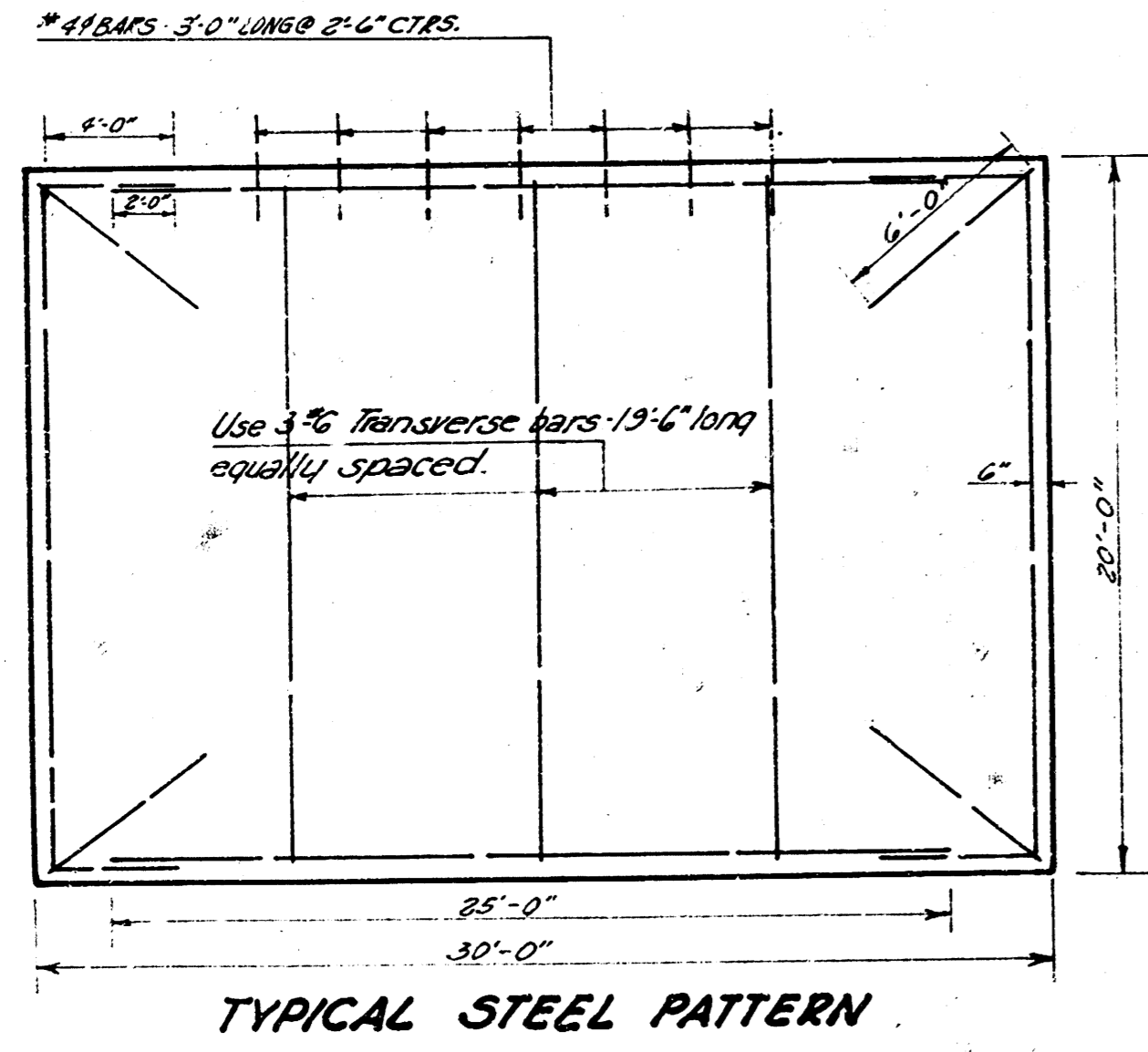

SANTA FE

PINE STREET

AVENUE

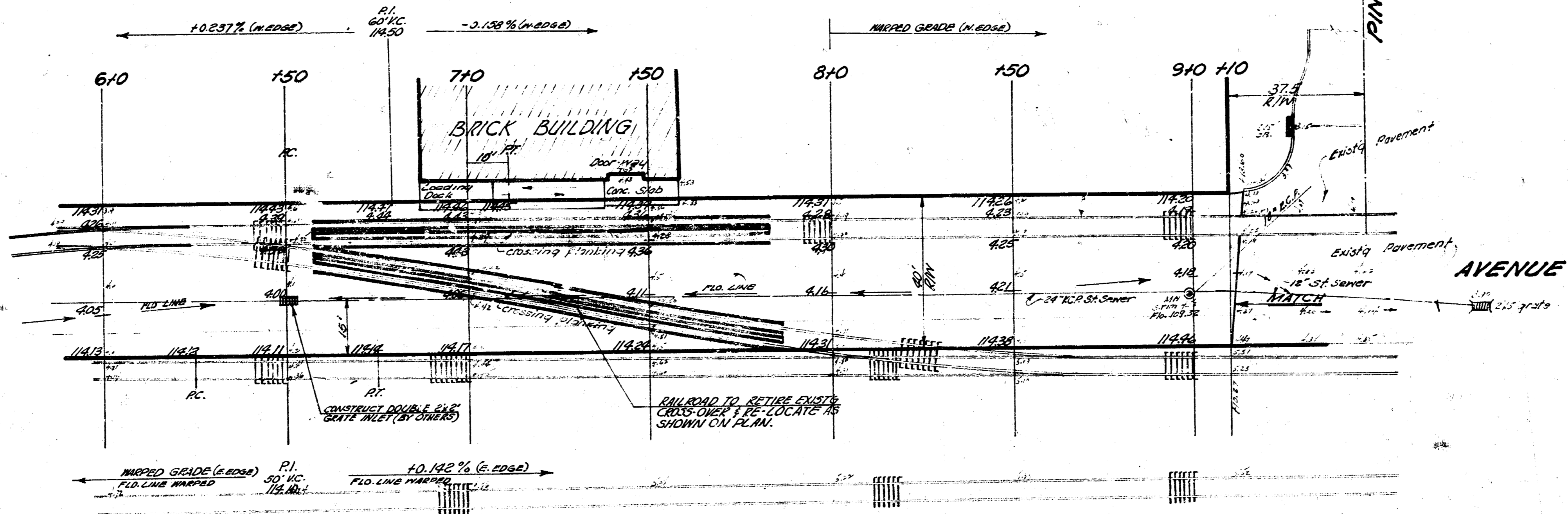

NOTE - DO NOT USE EXTRA TRANSVERSE STEEL IN PATTERNS LESS THAN 30' WIDE.

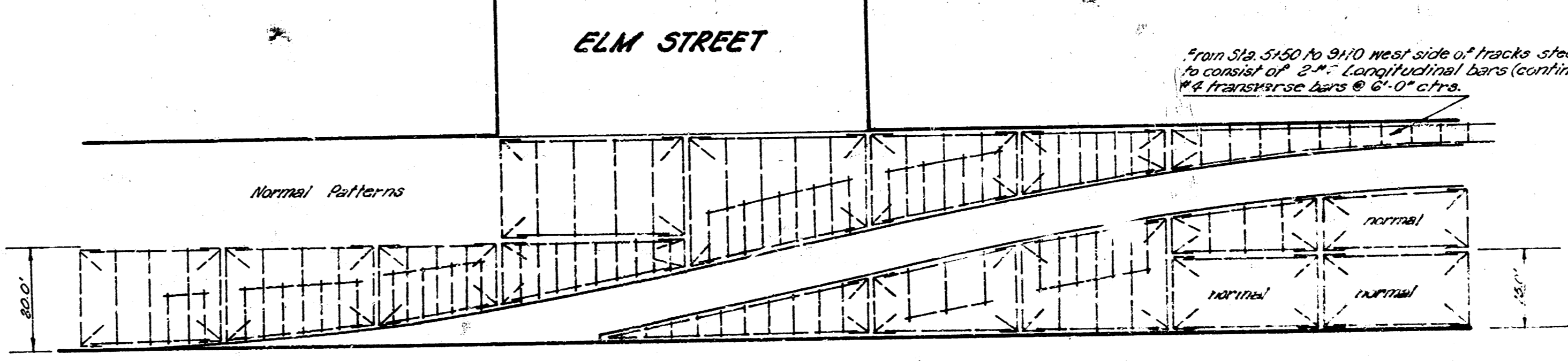

TYPICAL STEEL PATTERNS ACROSS R.R. TRACKS

SANTA FE - Central to Pine
PROJ. NO. C12-71

3/6