

Young  
Green  
Engineering  
1954

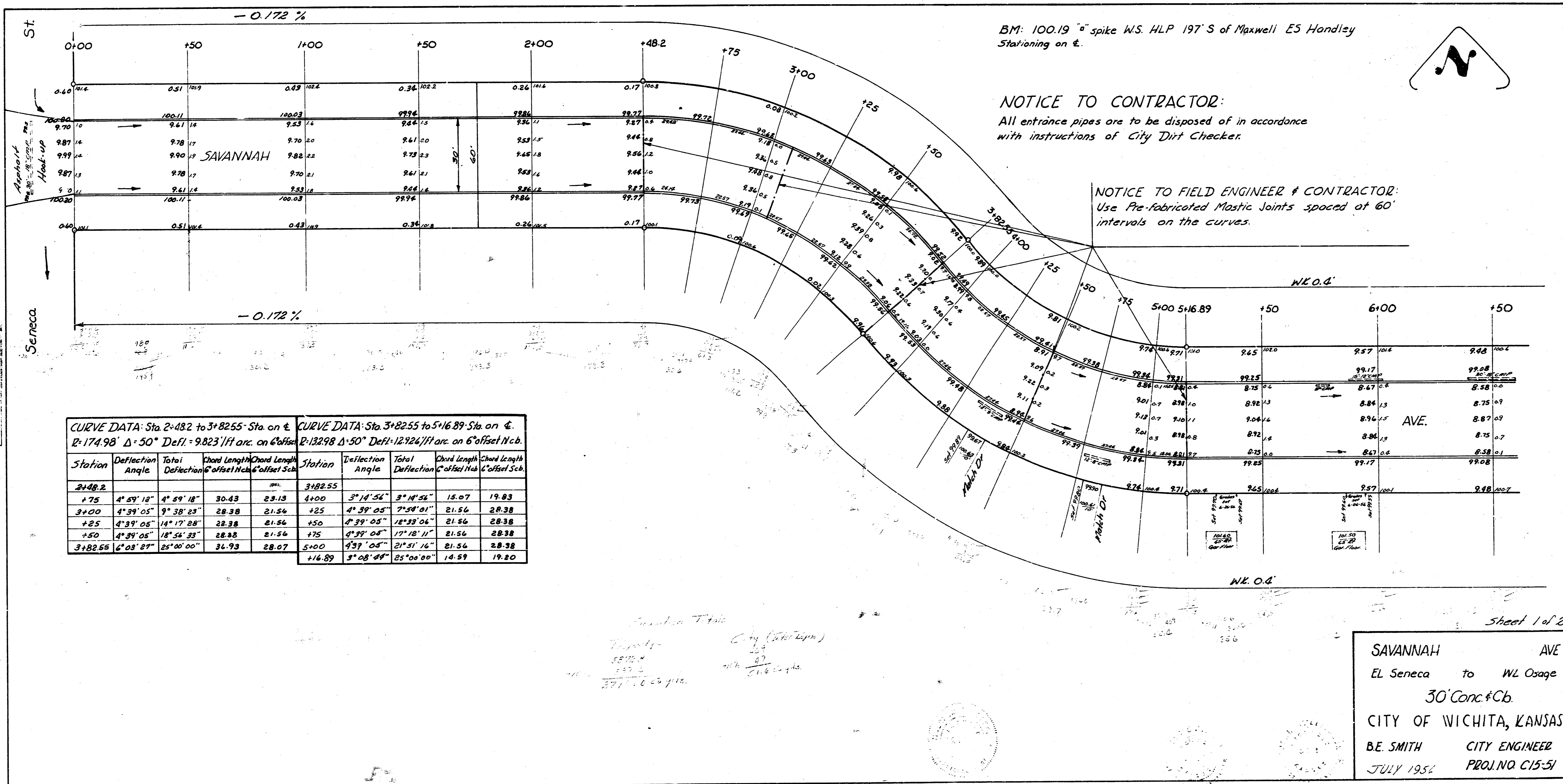

BM: 100.19 " spike W.S. HLP 197 S of Maxwell ES Handley Stationing on E.

**NOTICE TO CONTRACTOR:**  
All entrance pipes are to be disposed of in accordance with instructions of City Dirt Checker.

**NOTICE TO FIELD ENGINEER & CONTRACTOR:**  
Use Pre-fabricated Mastic Joints spaced at 60' intervals on the curves.

CURVE DATA: Sta. 2+482 to 3+8255 - Sta. on E.					CURVE DATA: Sta. 3+8255 to 5+16.89 - Sta. on E.				
R=174.98 Δ=50° Defl.=9.823/ft arc on 6' offset					R=132.98 Δ=50° Defl.=12.124/ft arc on 6' offset				
Station	Deflection Angle	Total Deflection	Chord Length	Chord Length	Station	Deflection Angle	Total Deflection	Chord Length	Chord Length
		6' offset	Hub	6' offset			6' offset	Hub	6' offset
2+482	4° 59' 18"	4° 59' 18"	30.43	28.13	3+825.5	3° 14' 54"	3° 14' 54"	15.07	19.83
+75	4° 39' 05"	9° 38' 23"	28.38	21.56	+25	4° 39' 05"	7° 54' 01"	21.56	28.38
+100	4° 39' 05"	14° 17' 28"	28.38	21.56	+50	4° 39' 05"	12° 19' 04"	21.56	28.38
+125	4° 39' 05"	18° 56' 33"	28.38	21.56	+75	4° 39' 05"	17° 18' 11"	21.56	28.38
+150	4° 39' 05"	23° 35' 38"	28.38	21.56	+100	4° 39' 05"	21° 51' 16"	21.56	28.38
3+825.5	6° 03' 27"	29° 39' 00"	34.93	28.07	5+00	3° 39' 05"	25° 00' 00"	14.59	19.80
					+16.89	3° 08' 44"	25° 00' 00"	14.59	19.80

Sheet 1 of 2

SAVANNAH AVE  
EL Seneca to WL Osage  
30' Conc. & Cb.  
CITY OF WICHITA, KANSAS  
B.E. SMITH CITY ENGINEER  
JULY 1954 PROJ. NO. C15-51

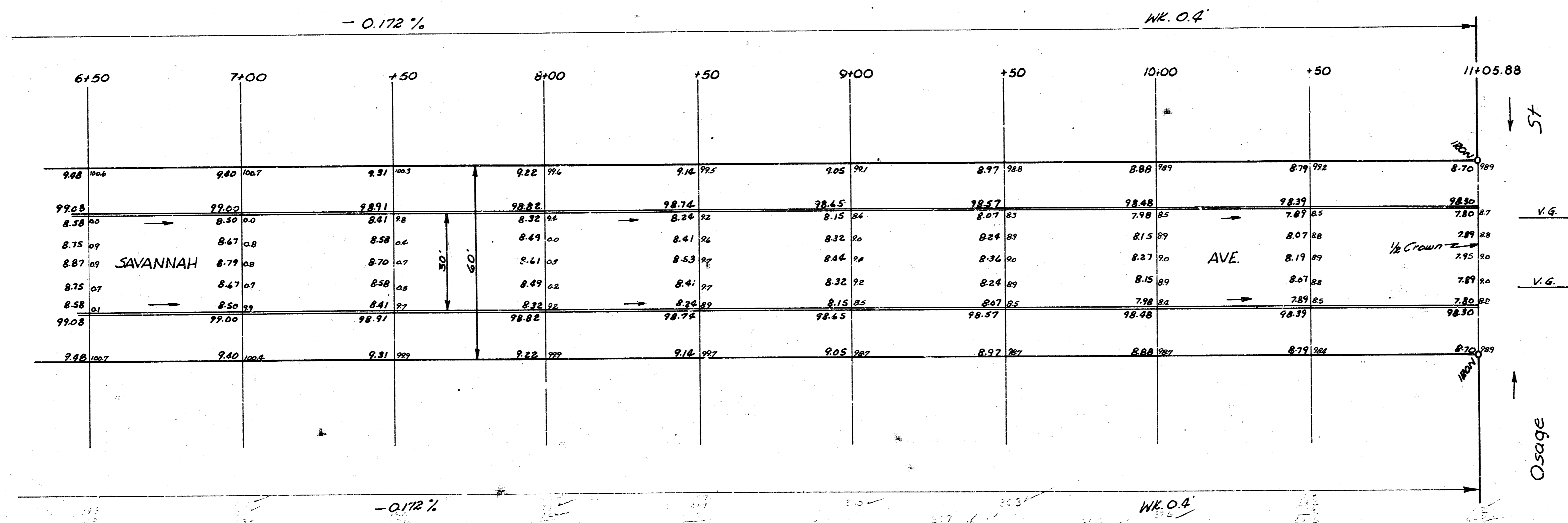

SAVANNAH AVE. C15-51  
Sheet 2 of 2.