

SENECA AVENUE
 S.L. RECTOR'S ACRES TO S.L. 31ST ST. SO.
 C11-9

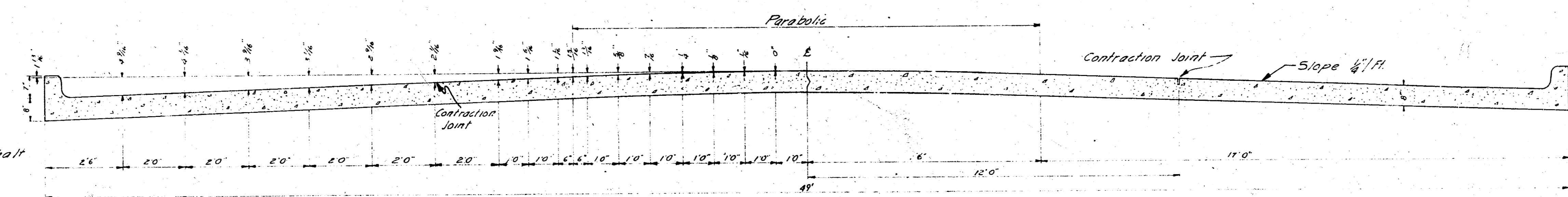

TYPICAL SECTION
 No Scale

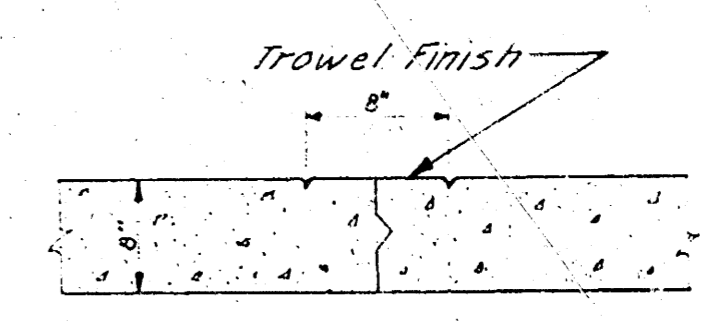

MARKER DETAIL
 No Scale
 Place Full Length of Job

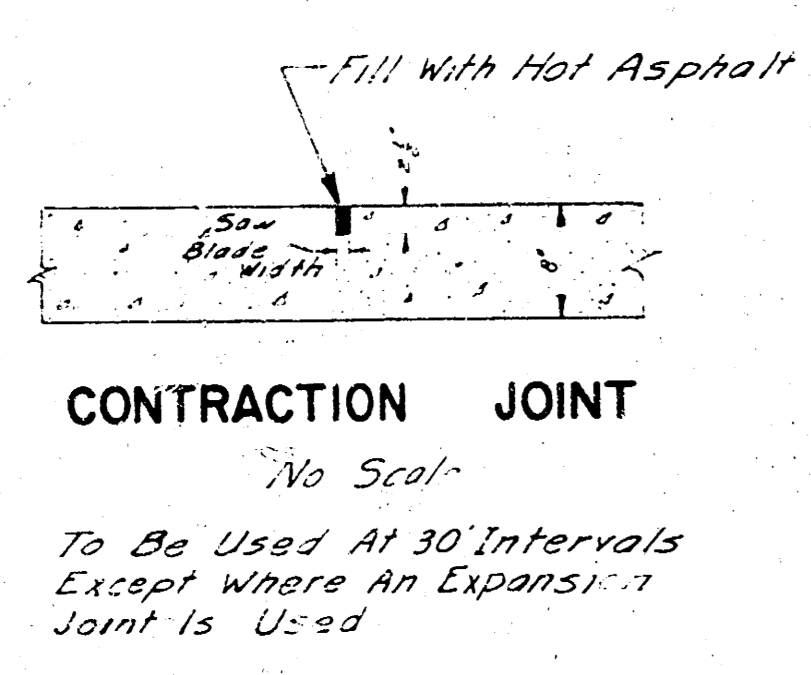

CONTRACTION JOINT
 No Seal
 To Be Used At 30' Intervals
 Except Where An Expansion Joint Is Used

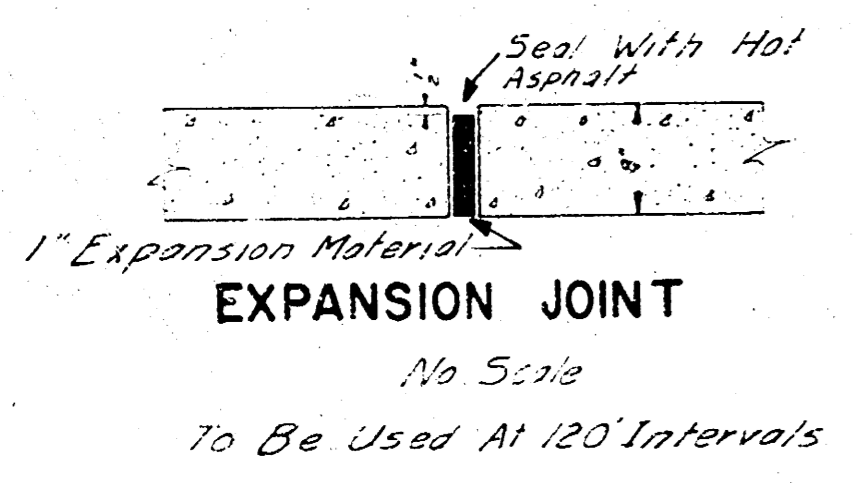

EXPANSION JOINT
 No Seal
 To Be Used At 120' Intervals

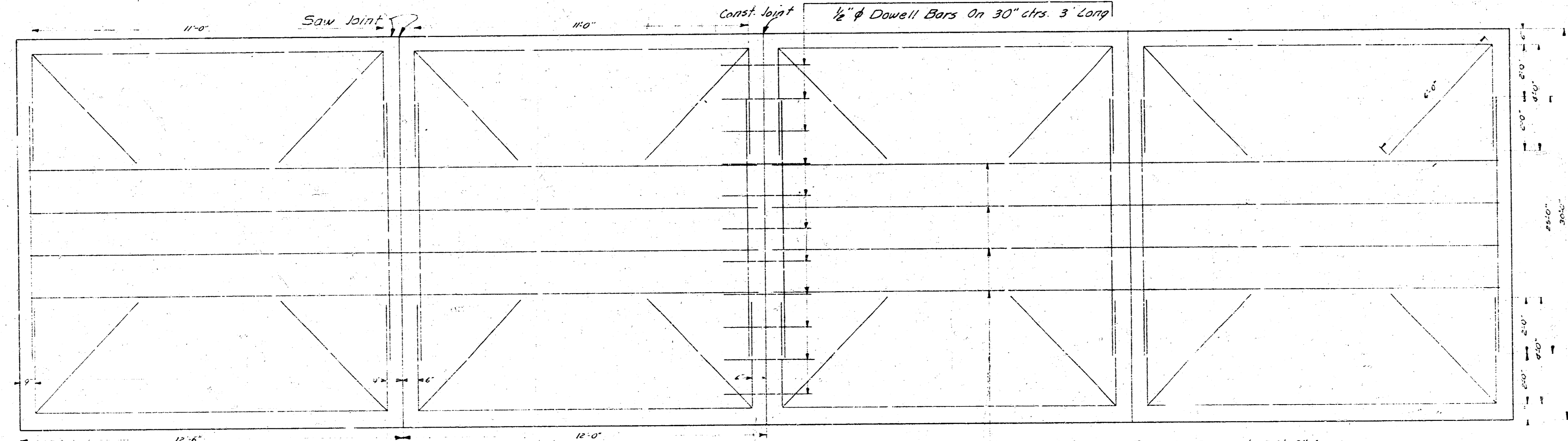

STEEL PATTERN
 No Scale
 Use 3/8" ϕ Bars Unless Otherwise Specified

4 - 3/4" ϕ Bars, Equally Spaced, 24'-0" Long



1/11

B.M. 22691 City Standard, 6' N. of 2' W. of S.W. cor. Seneca & 35th

Drainage by City
 Remove existing catch basins & install three new basins as shown. Install 15" R.C.P. between basins as indicated.

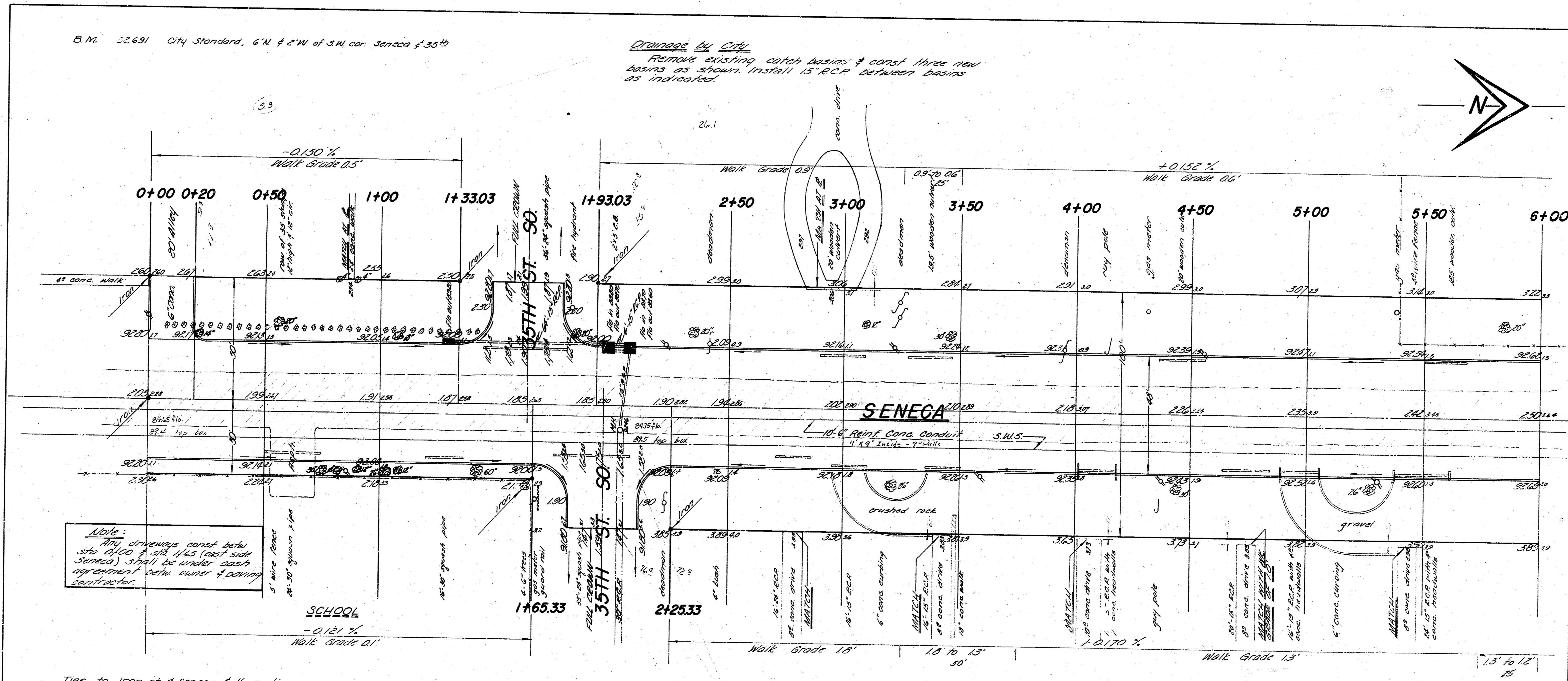
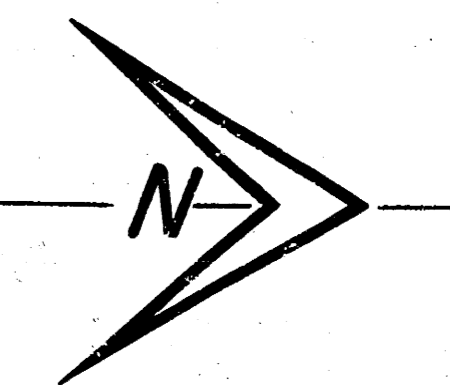

SURVEY BY: WOLLS
 DRAWN BY: J.J.
 CHECKED BY: L.A.K. 30
 DESIGNED BY: J.

Note:
 Any driveways const betw site 0+00 & site 1+65 (east side Seneca) shall be under cash agreement betw owner & paving contractor.

Ties to Iron at S. Seneca & 1/4 section corner
 49.74 N. to 1" on back of 4" walk.
 65.73 S.W. to 1" on S.E. cor. conc. manhole
 86.61 S.E. to 1" on N. side walk @ fence gate.



Drainage
 Excavate ditch east on 35th to permit drainage of Seneca pavement. Work to be completed by city.

EXCAVATION	COMP. FILL
6780.9	126
678.1	1.3
7459.0 cu yds	139 cu yds



STREET:	SENECA AVENUE
LIMITS:	S.L. RECTOR'S ACRES TO S.L. 31ST
PAVEMENT:	48' CONCRETE & CB.
DEPARTMENT:	CITY ENGINEERING DEPT. - WICHITA
	B.E. SMITH CITY ENGINEER
SCALE:	1" = 20'
SHEET:	2 OF 11
DRAWN BY:	J. JONES
PROJ. NO.:	C11-9
DATE:	

B.M. 9328 "4" on N curb of 34th & 11th W of NL Seneca.

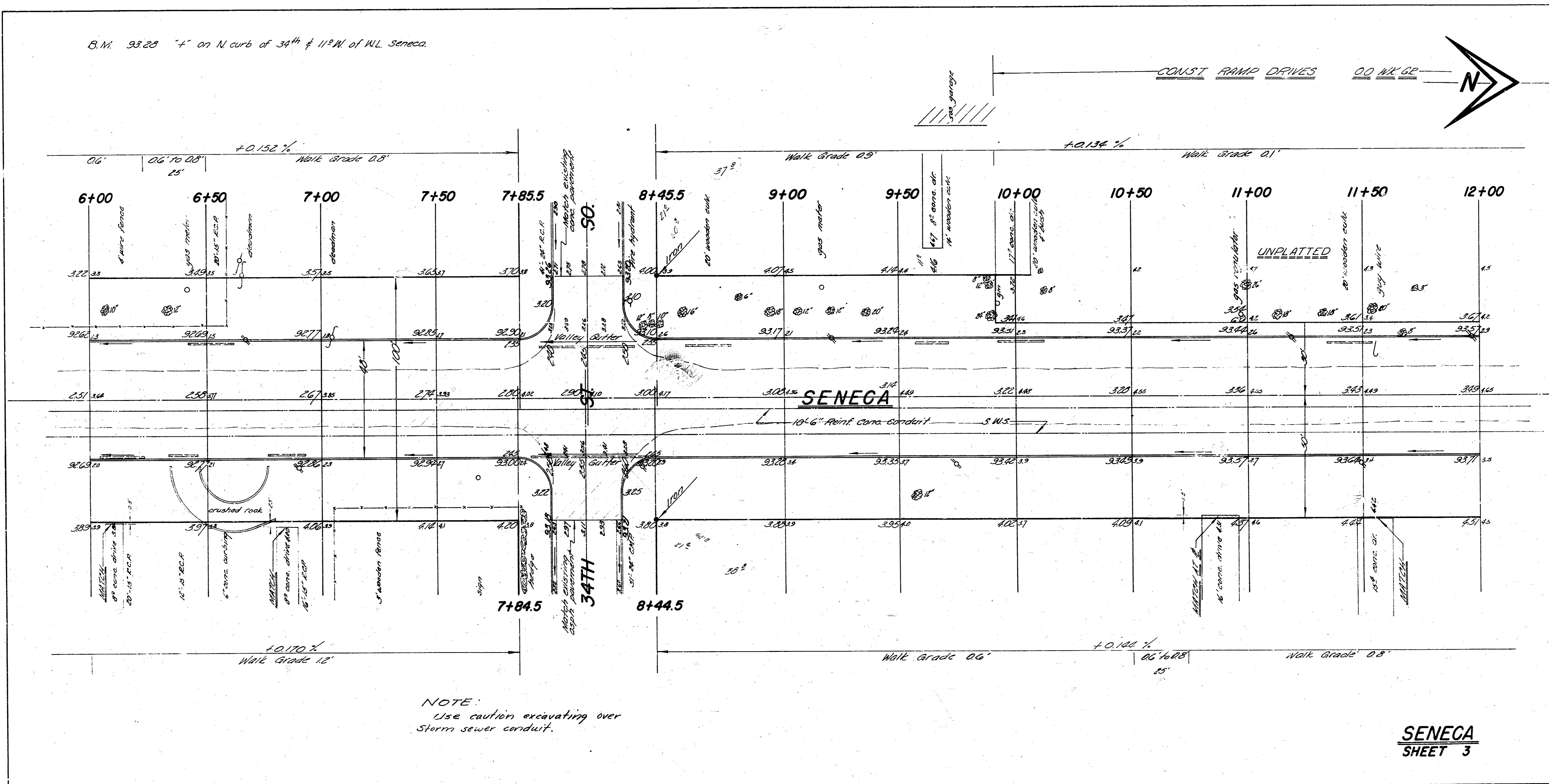

B.M. 34.02 1" in P&S, N. ca. of 33rd & 1st E. of E.L. Seneca

garage

CONST RAMP DRIVES 00 GRADE RT DRIVES

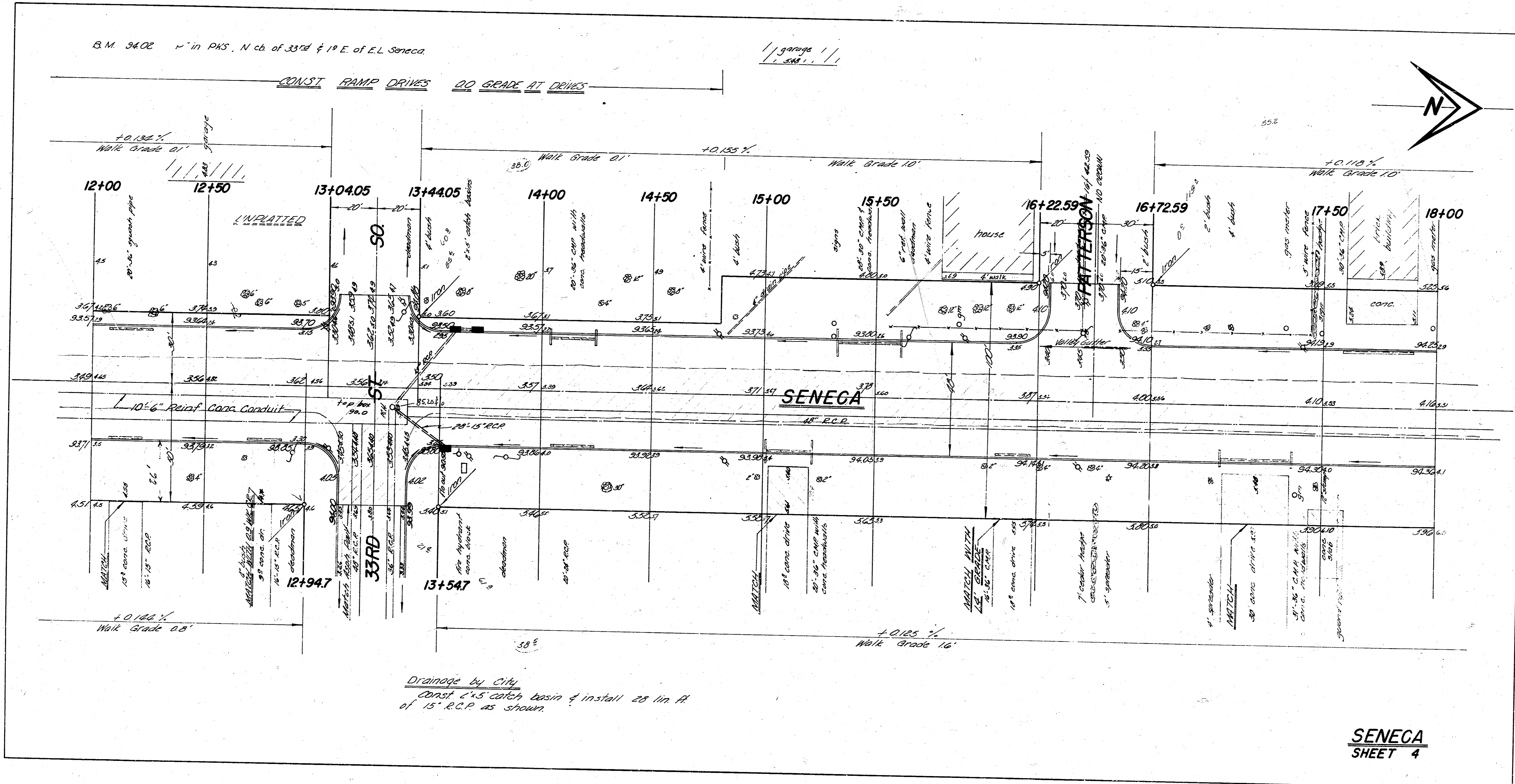
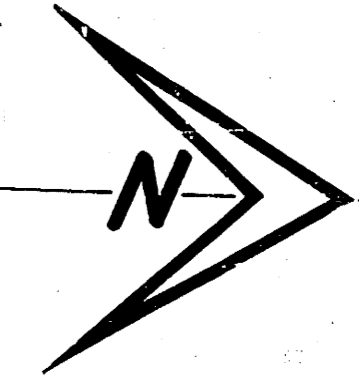

SENECA
SHEET 4

B.M. 9477 "4" on N. cb. 32nd St. 11² W. of M.L. Seneca

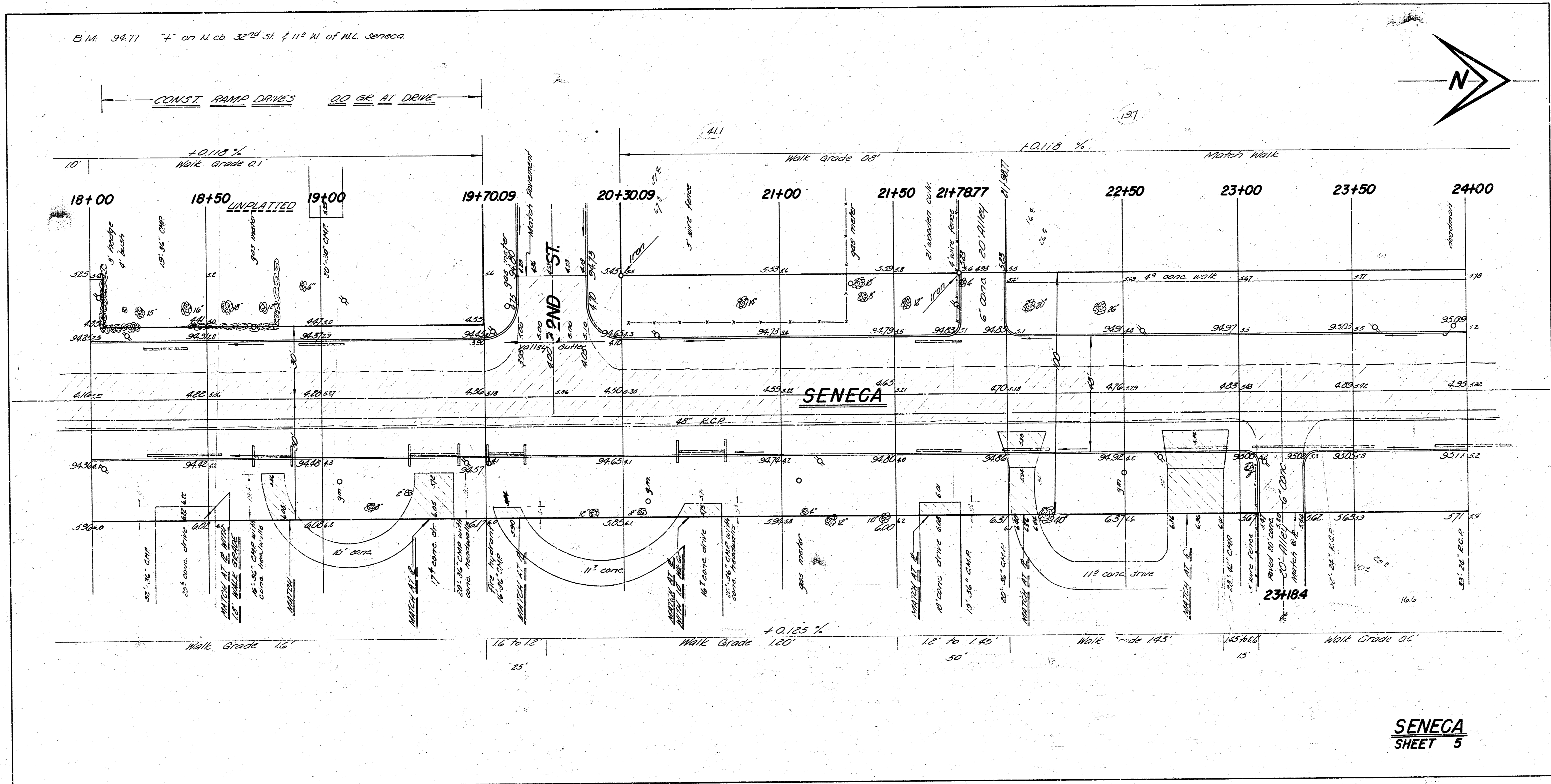
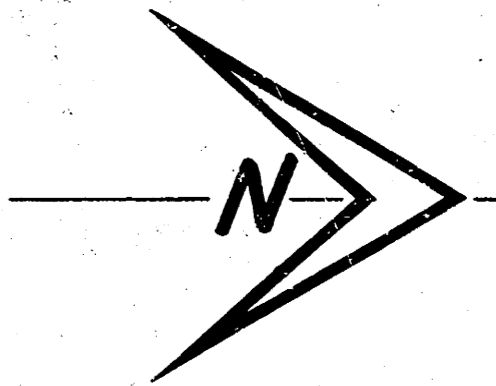

SENEGA
SHEET 5

B.M. 9644 "4" on S.E. cor. conc. lamp base @ int. of walks on NW cor. Seneca # 31st.

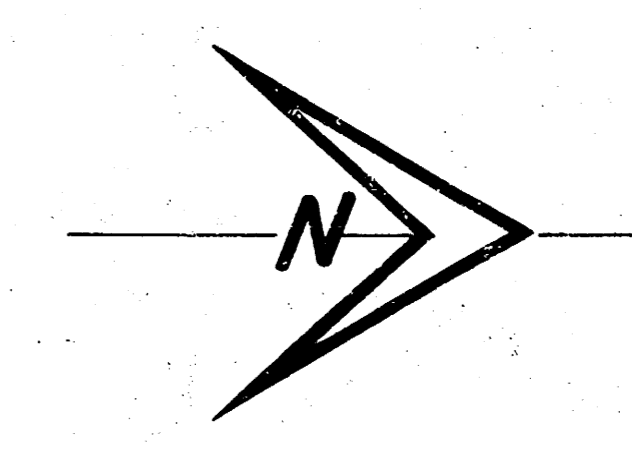

Note:
The existing asphalt surface shall be removed & paved as 3/4" asphalt that removal. The volume of asphalt (approx. 6" thickness) has been subtracted from the earthwork totals. Calculations at right hand side of sheet.

RAMP DRIVE NOTE
Const. ramp drives at all locations where the right-of-way is 30' & unless otherwise noted. Back of ramp to be level with top of curbs throughout drive section.

COMMERCIAL DRIVES
Location & width of all commercial drives shall be approved by the office of City Engineer before construction.

DRIVE HOOD-UPS BEHIND PROP. LINE
Hood-ups of 3' or more will be const. under private contract between paving contractor & property owner. Hood-ups less than 3' may be paved by contractor & assessed to the lot with property owners permission. Hood-ups of less than 3' will be 4" thick & the same width as existing drive behind property line.

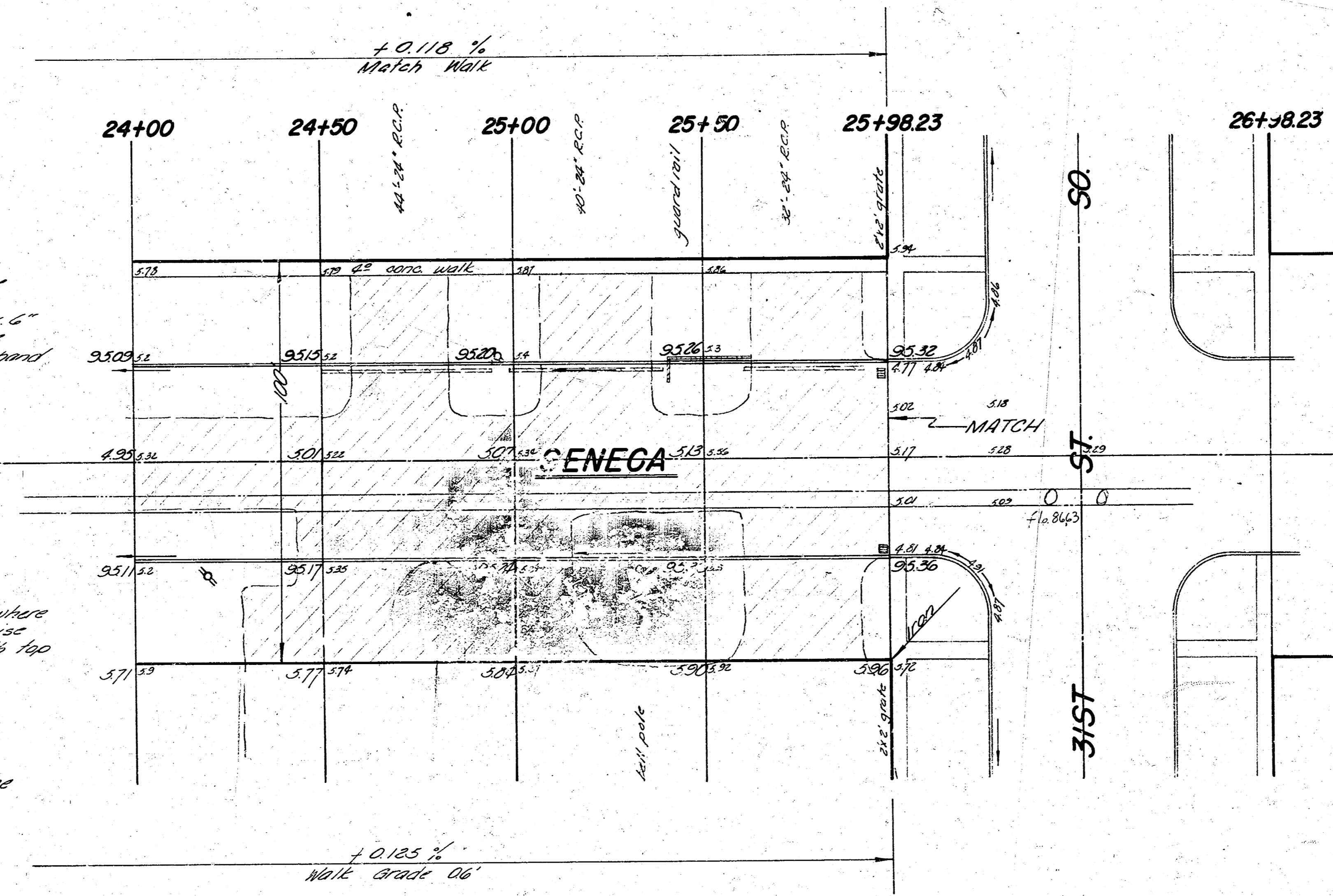

excavation from cross-sections	7755.3 cu yd
comp. fill from cross-sections	12.6 cu yd
excavation from paving plans	3023.9 cu yd
total	10791.8 cu yd

Area of each mat	Thickness	
Street #2	1508.9 sq yd	4"
"3	1903.9 sq yd	"
"4	1661.7 sq yd	"
"5	1750.8 sq yd	"
"6	1522.3 sq yd	"
total	7133.5 sq yd	15643 cu yd