

# SENECA - N.L. UNIVERSITY TO N.L. MAPLE

8" CONCRETE - 48' & CURB

PROJECT NO. C11-14

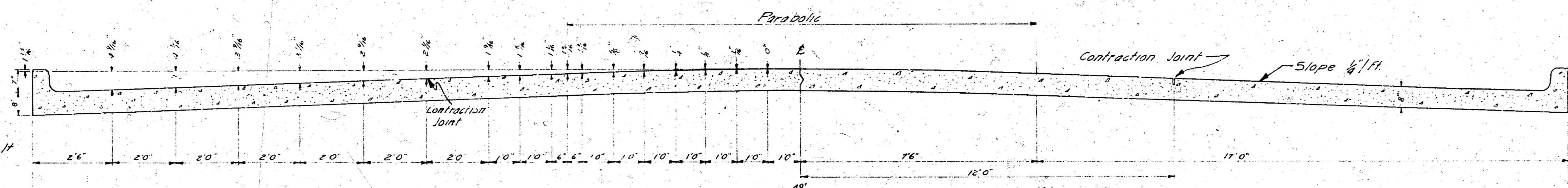

TYPICAL SECTION  
No Scale

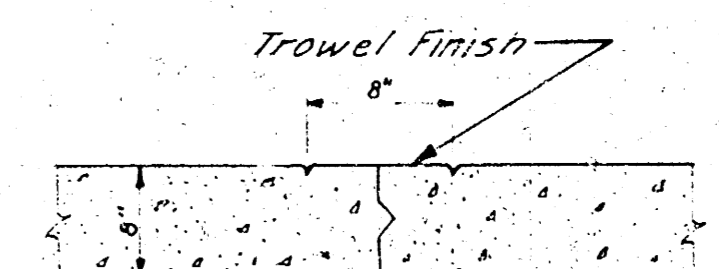

MARKER DETAIL  
No Scale  
Place full length of job

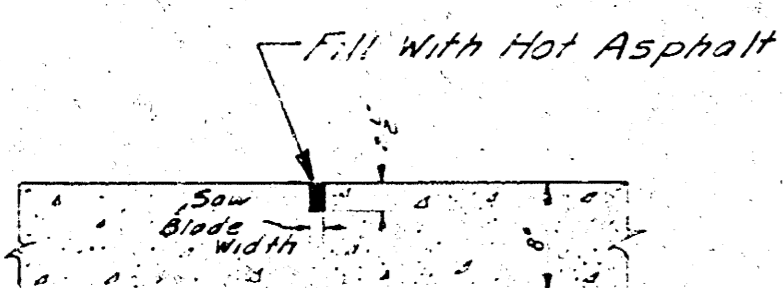

CONTRACTION JOINT  
No Scale

To Be Used At 30' Intervals  
Curb Height 4" - 6" - 8" - 10" - 12" - 14" - 16" - 18" - 20" - 22" - 24" - 26" - 28" - 30"

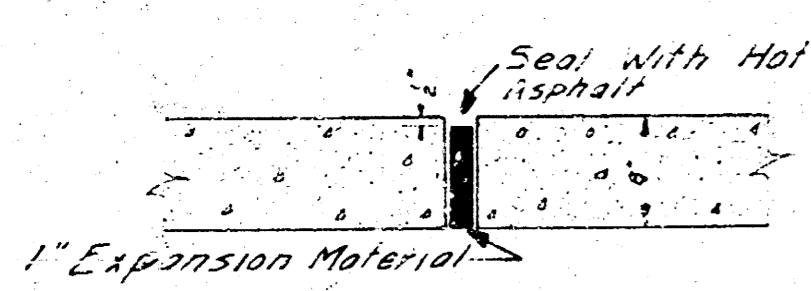

EXPANSION JOINT  
No Scale

To Be Used At 120' Intervals

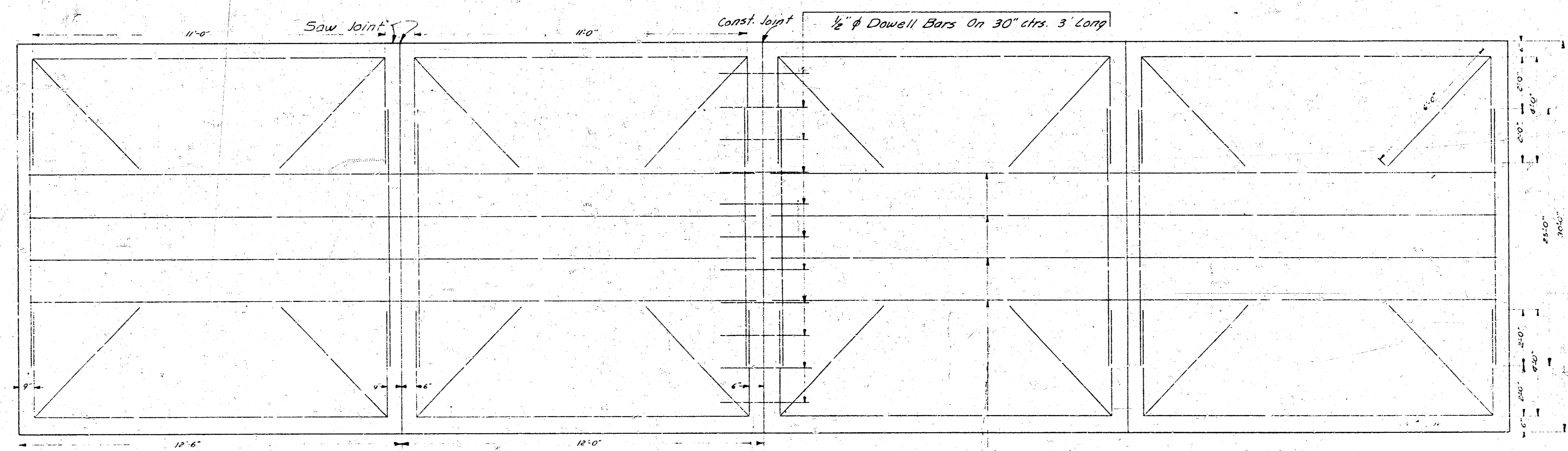

STEEL PATTERN  
No Scale

Use 3/8" Bars Unless Otherwise Specified

4 - 3/4" Bars, Equally Spaced, 24'-0" Long



Survey Y BK 203  
 Exc. J.L.A.  
 Checked

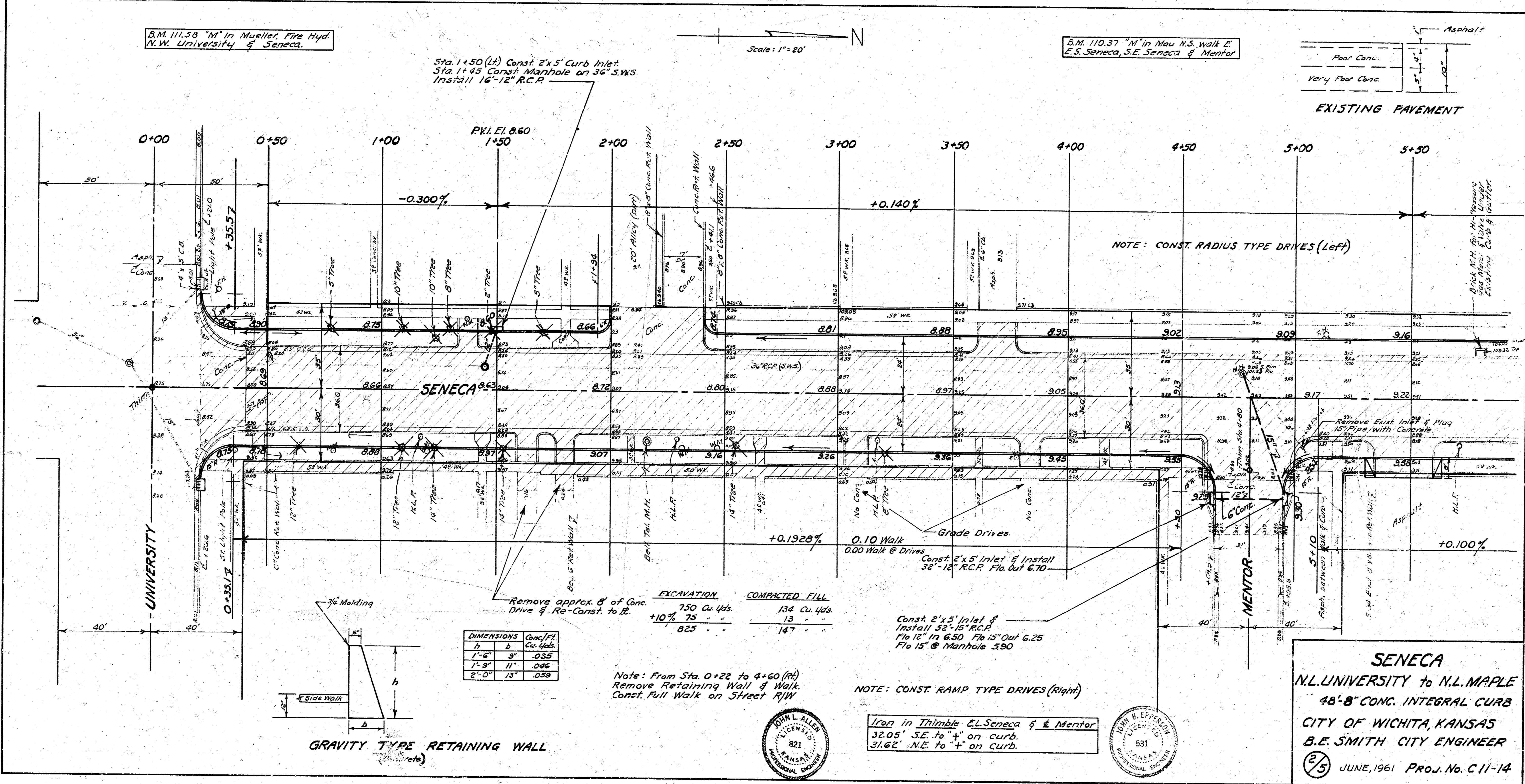

**SENECA**  
 N.L. UNIVERSITY to N.L. MAPLE  
 48'-8" CONC. INTEGRAL CURB  
 CITY OF WICHITA, KANSAS  
 B.E. SMITH CITY ENGINEER  
 (2/5) JUNE, 1961 PROJ. No. C-11-14

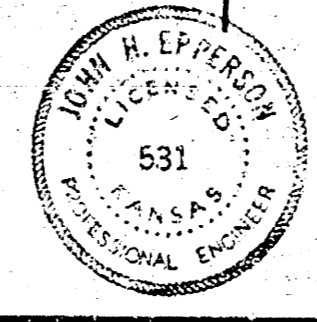
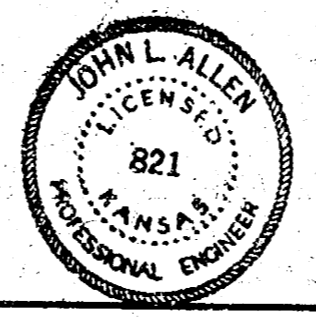

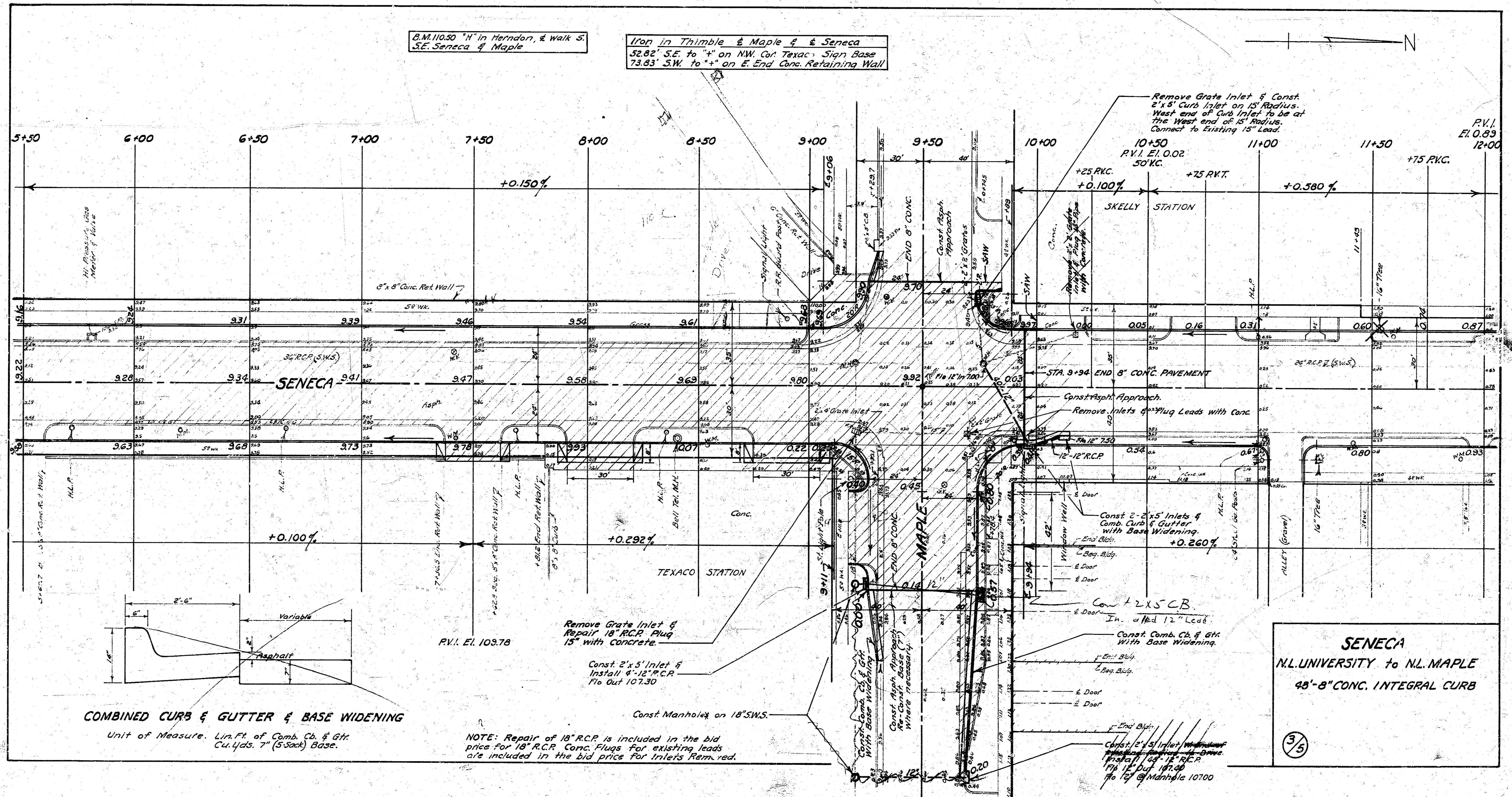

B.M. 110.50 "N" in Herndon, & walk S.  
S.E. Seneca & Maple

Iron in Thimble & Maple & Seneca  
32.82' S.E. to "x" on NW Cor Texaco Sign Base  
73.83' S.W. to "x" on E End Conc. Retaining Wall



**COMBINED CURB & GUTTER & BASE WIDENING**  
Unit of Measure. Lin. Ft. of Comb. Cb. & Gtr.  
Cul. Vals. 7" (5'30x3) Base.

NOTE: Repair of 18" R.C.P. is included in the bid price for 18" R.C.P. Conc. Plugs for existing leads are included in the bid price for Inlets Rem. red.

**SENECA**  
N.L. UNIVERSITY to N.L. MAPLE  
48'-8" CONC. INTEGRAL CURB

3/5