

**SHERIDAN AVENUE**  
 S.L. 33RD STREET So. To S.L. 31ST STREET So.

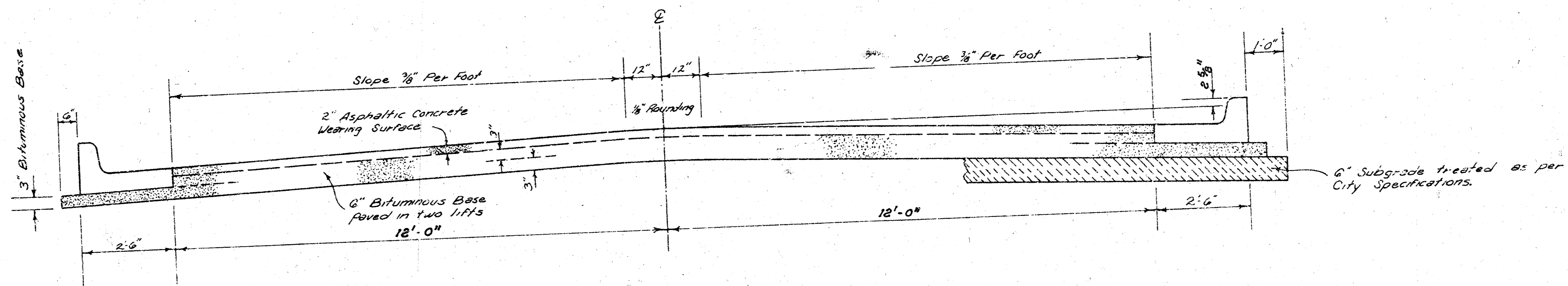

**TYPICAL SECTION**

**29' ASPHALTIC CONCRETE PAVEMENT WITH BITUMINOUS BASE**

*The A.C. pavement between the Comb. Curb & Gutter shall be paid as 5" A.C. Pavement (6" Bituminous Base). The Bituminous Base under the Comb. Curb & gutter shall be paid as 3" Bituminous Base.*

COMBINED CURB & GUTTER

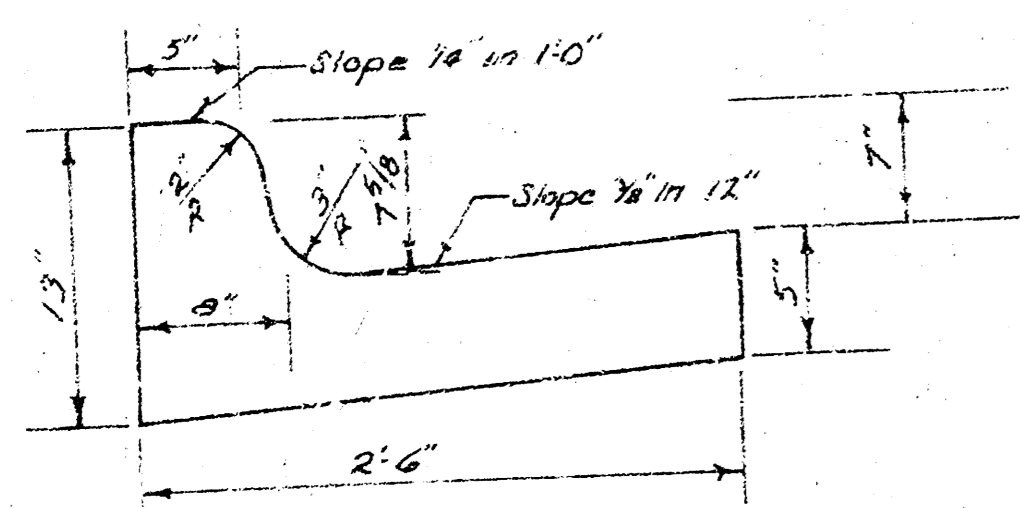

ROLL TYPE CURB & GUTTER

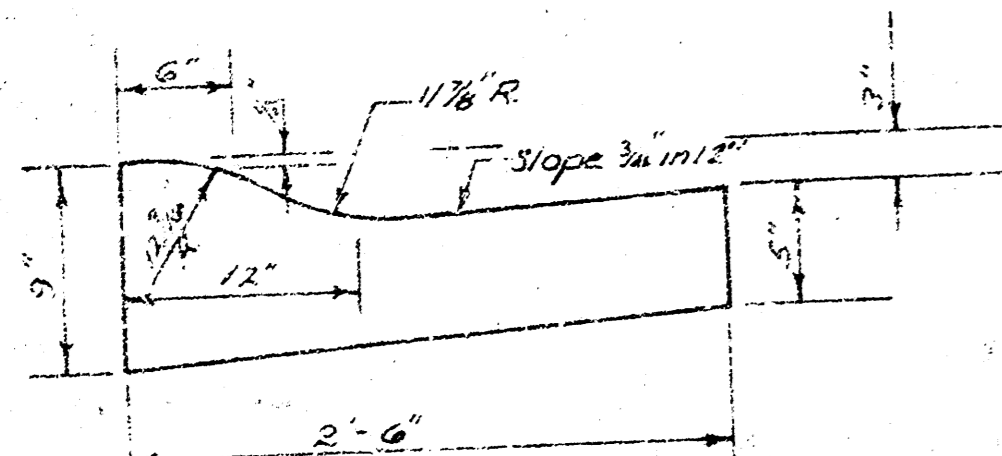

A TACK COAT OF EMULSIFIED ASPHALT (SS-1H) SHALL BE APPLIED AT AN APPROXIMATE RATE OF 0.05 GALLONS PER SQ. YD. BETWEEN LIFTS OF ASPHALTIC MATERIALS WHEN ORDERED BY THE ENGINEER. TACK COAT WILL NOT BE PAID FOR DIRECTLY AND SHALL BE CONSIDERED AS SUBSIDIARY TO PRICE BID FOR ASPHALTIC PAVEMENT. BITUMINOUS BASE AND ASPHALTIC CONCRETE WEARING SURFACE SHALL BE PLACED WITH A LAYDOWN MACHINE HAVING AUTOMATIC ELECTRONIC CONTROLS FOR CROWN AND GRADE. CONSTRUCTION JOINTS IN EACH LIFT SHALL BE STAGGERED A MINIMUM DISTANCE OF 1' WITH JOINTS IN PRECEDING LIFTS AND SUCH THAT A JOINT WILL BE CONSTRUCTED ON THE PAVEMENT CENTERLINE IN THE TOP LIFT.

**DETAIL OF TRANSVERSE CONSTRUCTION JOINTS**

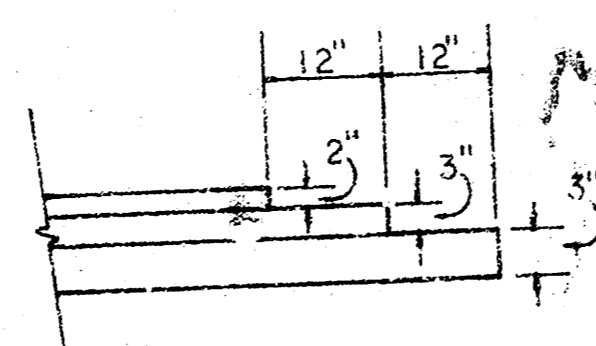

TRANSVERSE CONSTRUCTION JOINTS SHALL BE CONSTRUCTED IN FLEXIBLE BASE PAVEMENTS AT LOCATIONS WHERE PAVEMENT TEMPORARILY ENDS TO FACILITATE FUTURE PAVEMENT CONSTRUCTION AS SHOWN IN DETAIL. THE COST OF CONSTRUCTING THE TRANSVERSE CONSTRUCTION JOINTS SHALL NOT BE MEASURED OR PAID FOR DIRECTLY BUT SHALL BE INCLUDED IN THE BID PRICE FOR SQUARE YARDS OF ASPHALTIC CONCRETE PAVEMENT.

CITY OF WICHITA, KANSAS  
 DEPARTMENT OF PUBLIC WORKS — ENGINEERING  
 R. W. LINN — CITY ENGINEER  
 DATE: \_\_\_\_\_ PROJ. No. DAKS574130



B.M. 98.44 "I" cut N. end conc. M.H. on S.W. Cor. SHERIDAN & 33RD ST So.

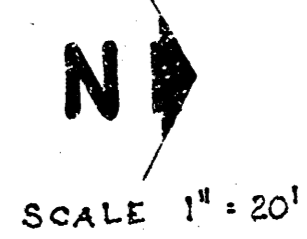

Base Line = East property line Sheridan Ave

CURVE DATA FOR CHANNEL  
 $\Delta = 15'$   
 $R = 200'$   
 $T = 26.33'$   
 $C = 32.21'$   
 $Arc = 52.36'$

PLAN -  
 SURVEY -  
 CHECKED

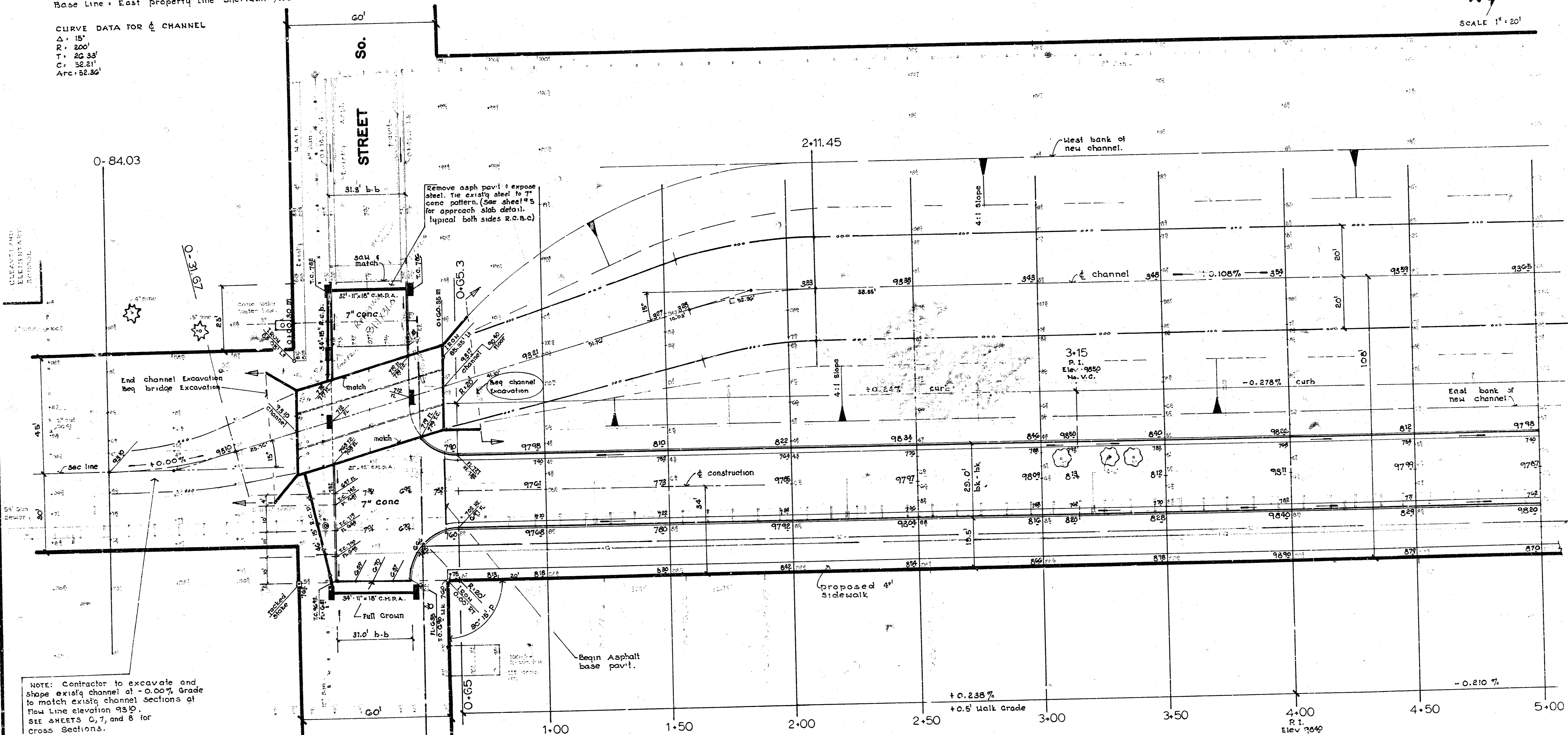

NOTE: Contractor to excavate and shape existing channel at -0.00% grade to match existing channel sections at flow line elevation 93.0. SEE SHEETS 6, 7, and 8 for cross sections.

NOTE: SAVING CONTRACTOR TO BE RESPONSIBLE FOR ALIGNMENT AND EXCAVATION OF NEW CHANNEL.

CITY		PROPERTY	
EXCAVATION	COMP. FILL	EXCAVATION	COMP. FILL
17,130.2 cu yds	738.0 cu yds	934.1 cu yds	114.5 cu yds
+10% 1,713.0	+10% 73.8	+10% 93.4	+10% 11.5
18,843.2 cu yds	811.8 cu yds	1,027.5 cu yds	126.0 cu yds

SHERIDAN AVENUE  
 Proj. No. DAKS 574130

2/27

P.M. 101.77 S.W. cor conc step Ho# 3246 Se. SHERIDAN.

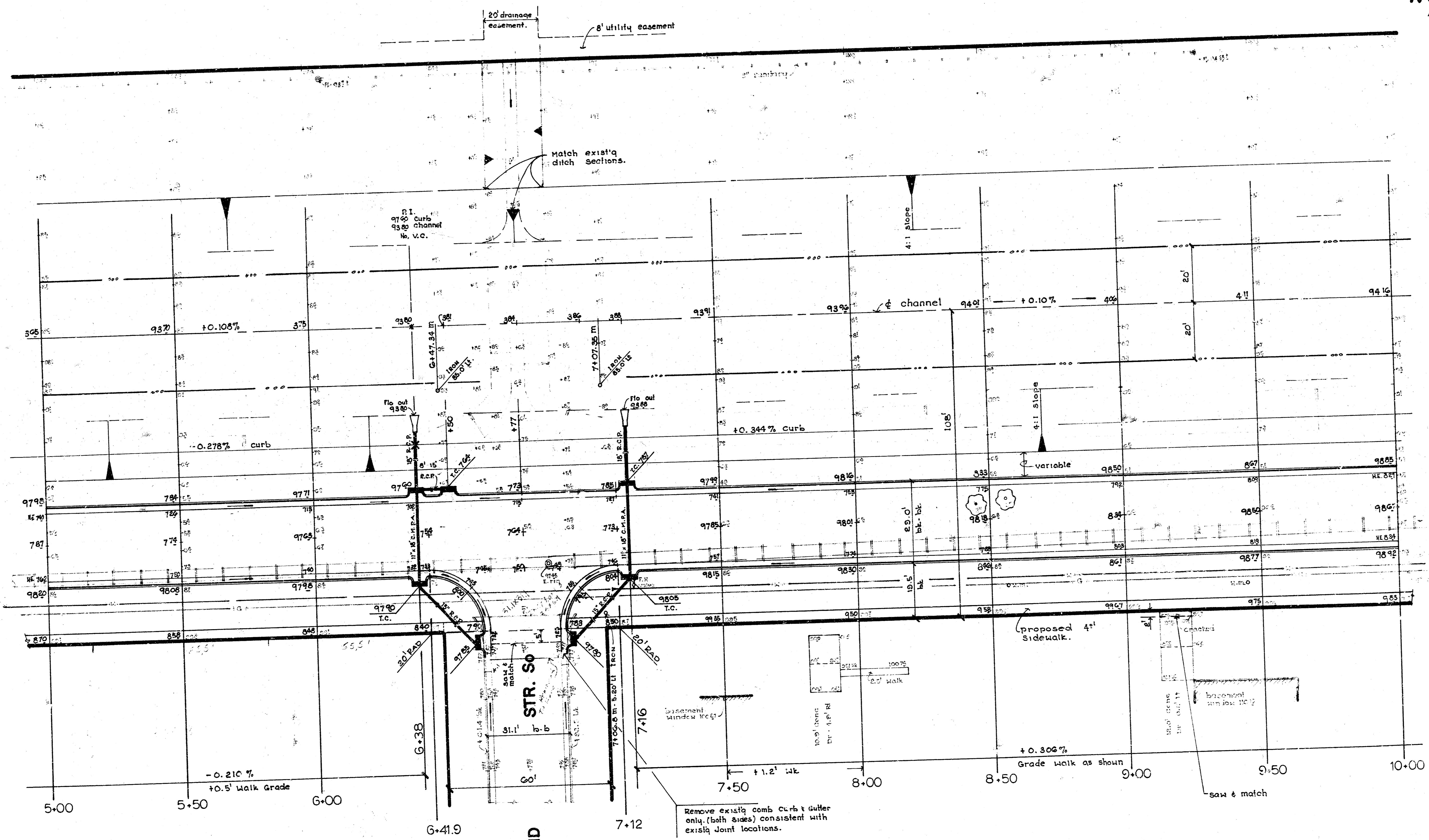

**\*\* SUBGRADE \*\***  
 Type of subgrade treatment shall be determined by the field Engineer. Subgrade treatment may consist of Lime treatment, cement treatment, subgrade modification, or any combination of these.

**\*\* SIDEWALK \*\***  
 Grade parking & clear R/W for proposed sidewalk. compact fill in walk area. walk to be constructed by "others".

SHERIDAN AVENUE  
 Proj No. DAKS 574130

3/5

B.M. 103.52 CITY STANDARD DISC TOP E. End South Handrail to R.C.B.

50' R/W

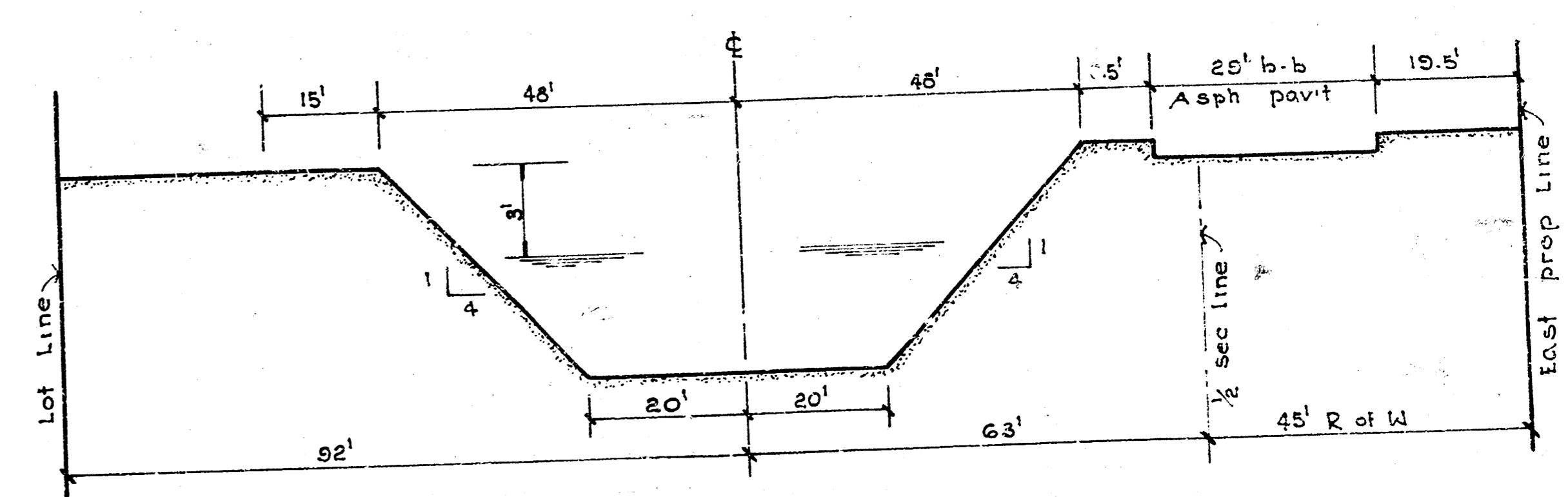
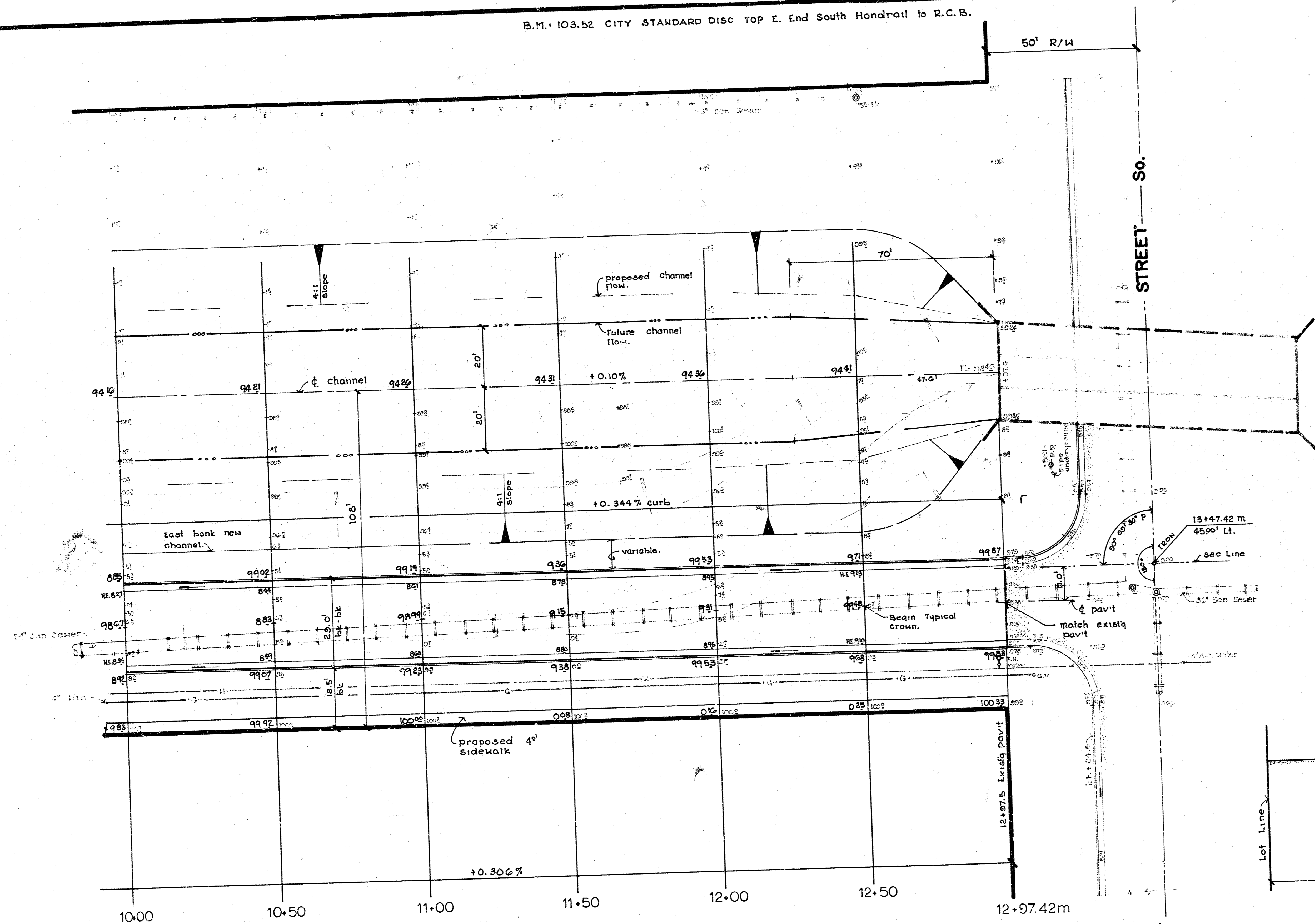

FUTURE TYPICAL SECTION--EARTH CHANNEL  
NOTE: See Sheet No. 5 for Construction Design.

SHERIDAN AVENUE  
Proj No. DAK5574130

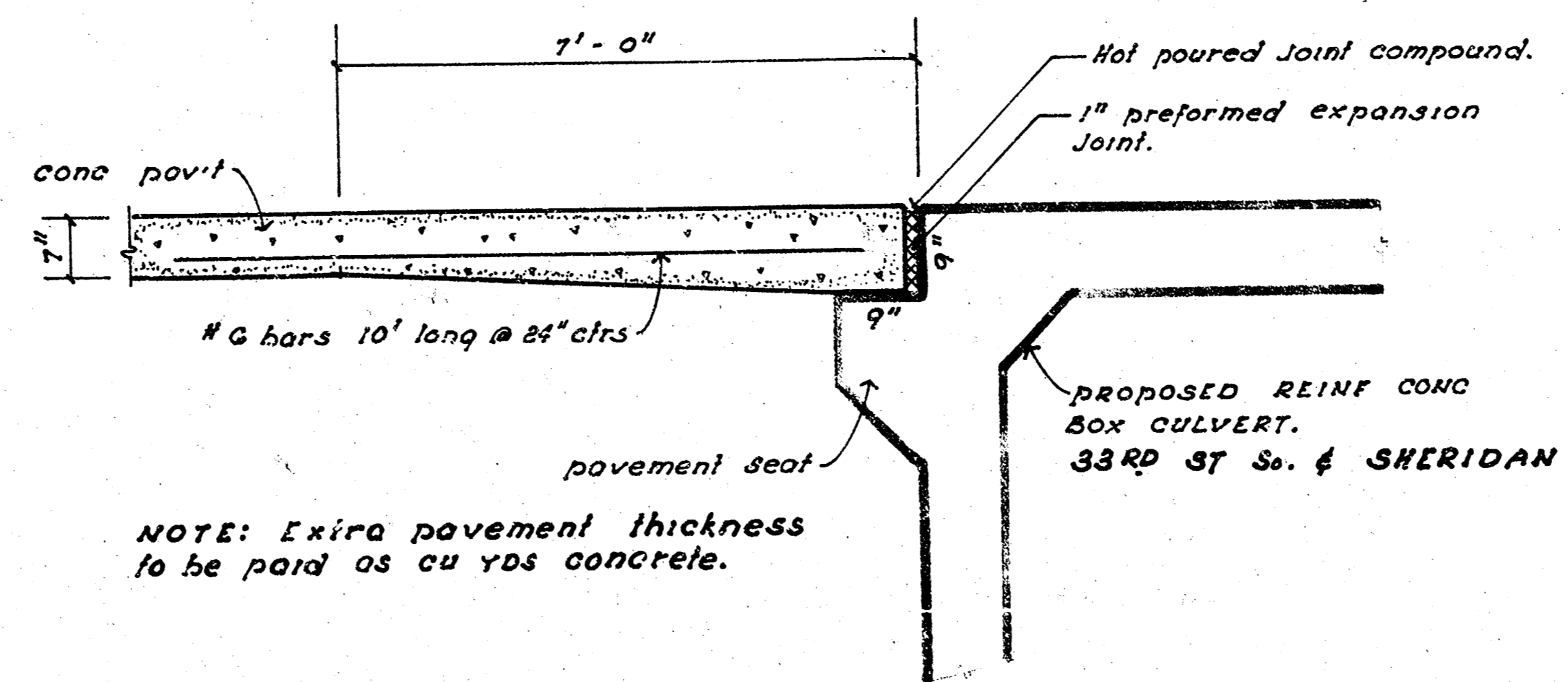

DETAIL SHOWING EXTRA PAVEMENT THICKNESS AND EXTRA REINF. STEEL. — No scale —

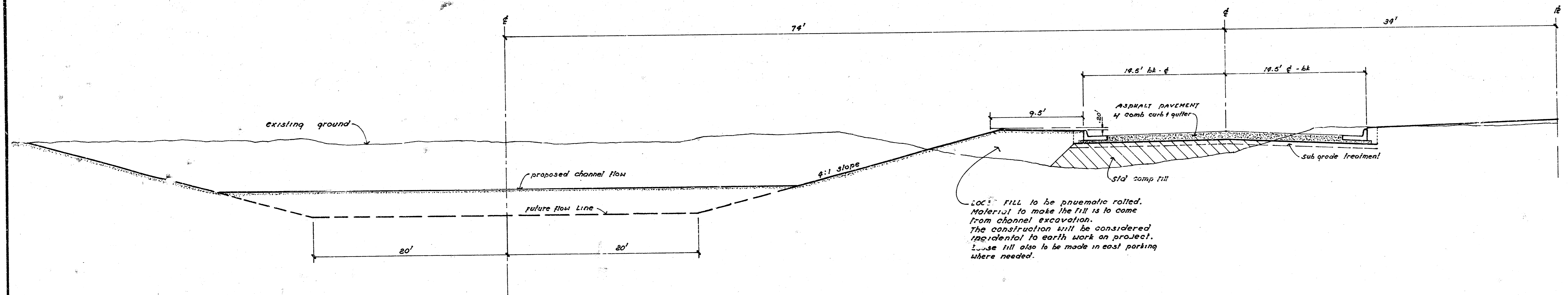

TYPICAL SECTION EARTH CHANNEL & PAVEMENT

SHERIDAN AVENUE  
Proj No. DAKS 574130