

B.M. 10177 S.W. Cor. Conc Step No. 3248 So. SHERIDAN AVE.

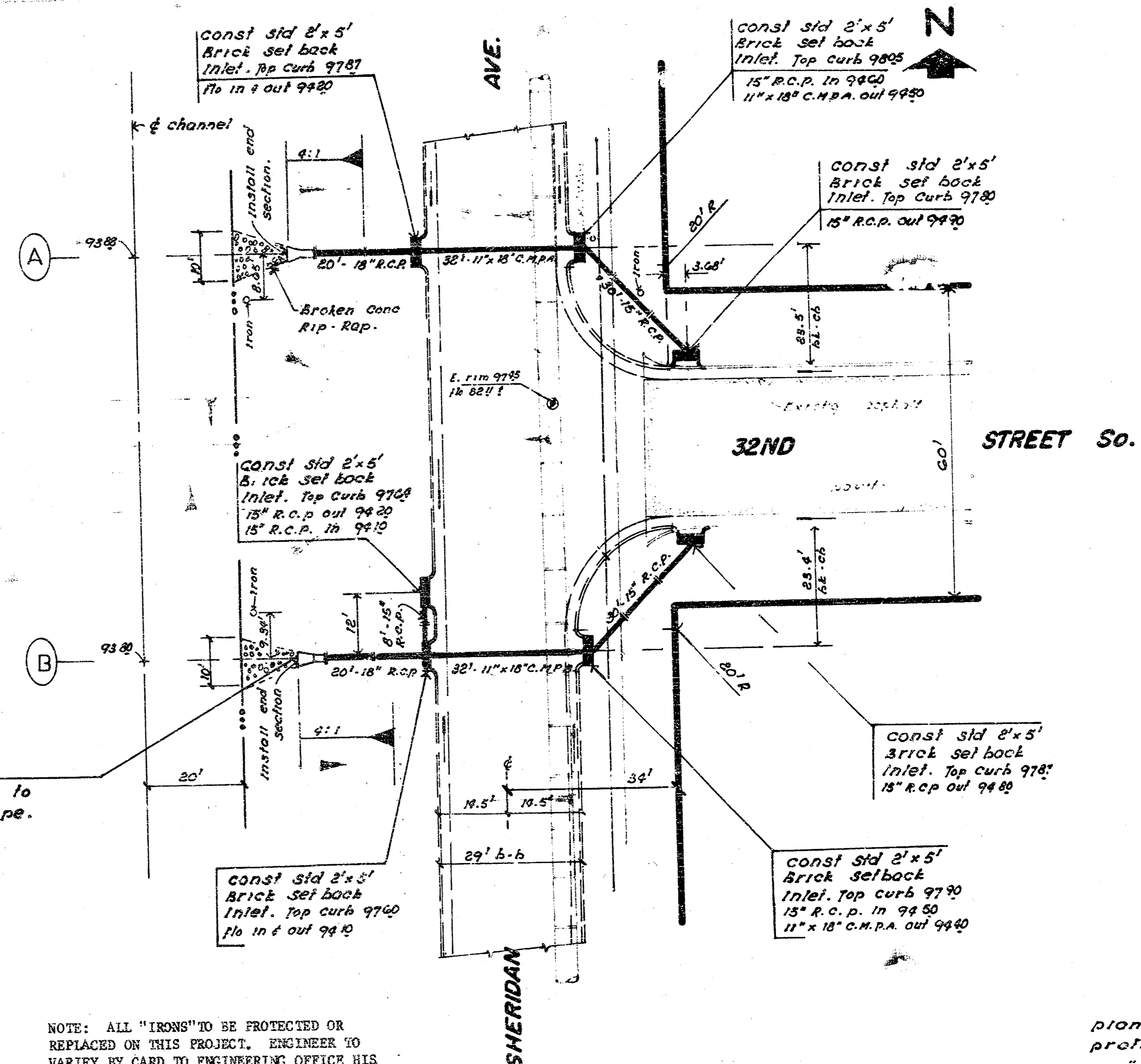

NOTE: Cost for 18" end sections to be included in the price for pipe.

NOTE: ALL "IRONS" TO BE PROTECTED OR REPLACED ON THIS PROJECT. ENGINEER TO VERIFY BY CARD TO ENGINEERING OFFICE HIS ACTION ON THE PROTECTION OR REPLACEMENT.

PLAN Scale 1" = 20'
Profile 1" = 10' Horiz
1" = 5' Vert

**** BROKEN CONCRETE RIP-RAP ****
All costs for furnishing and placing broken concrete rip-rap shall be incidental to other bid items on the project.

NOTE: Cost for mechanically tamped back fill is to be included in the bid price for pipe.

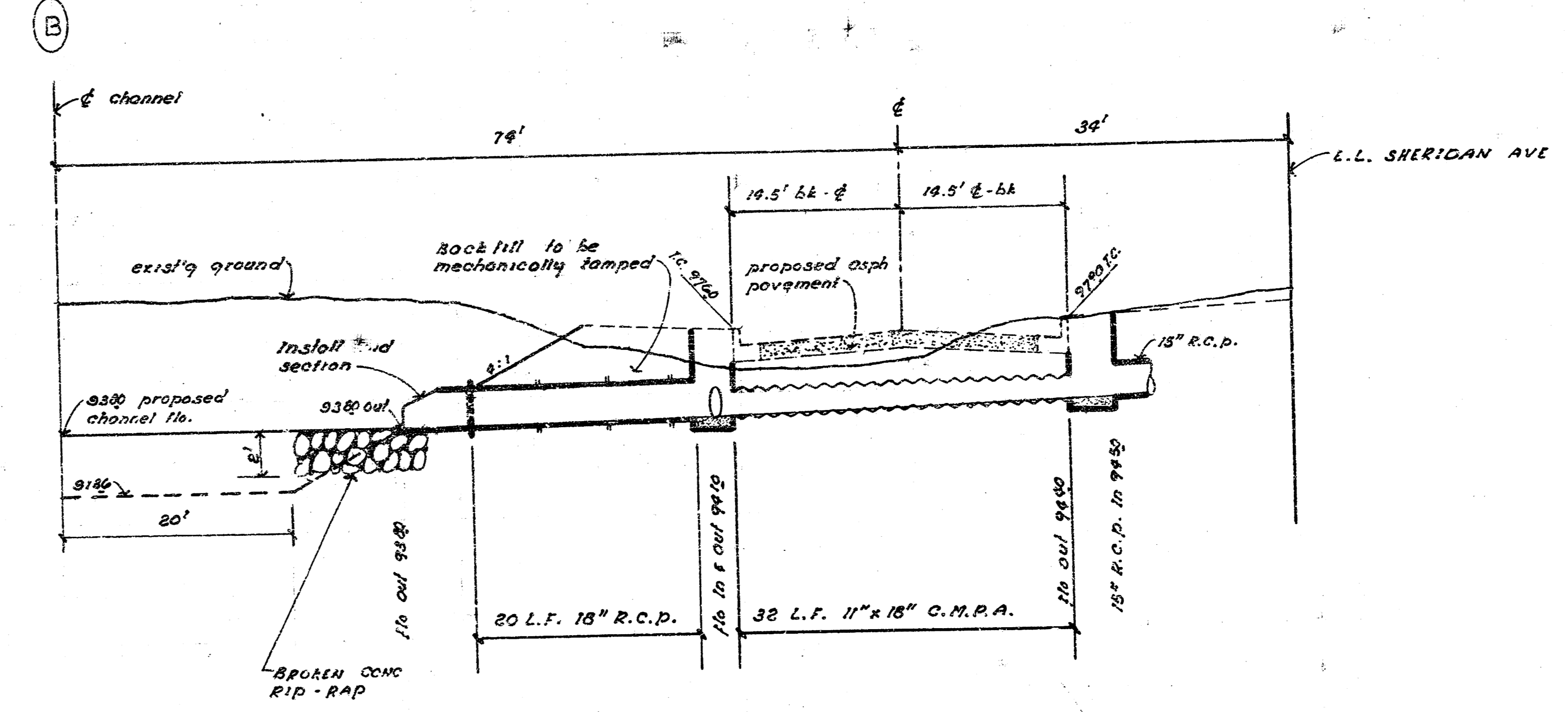
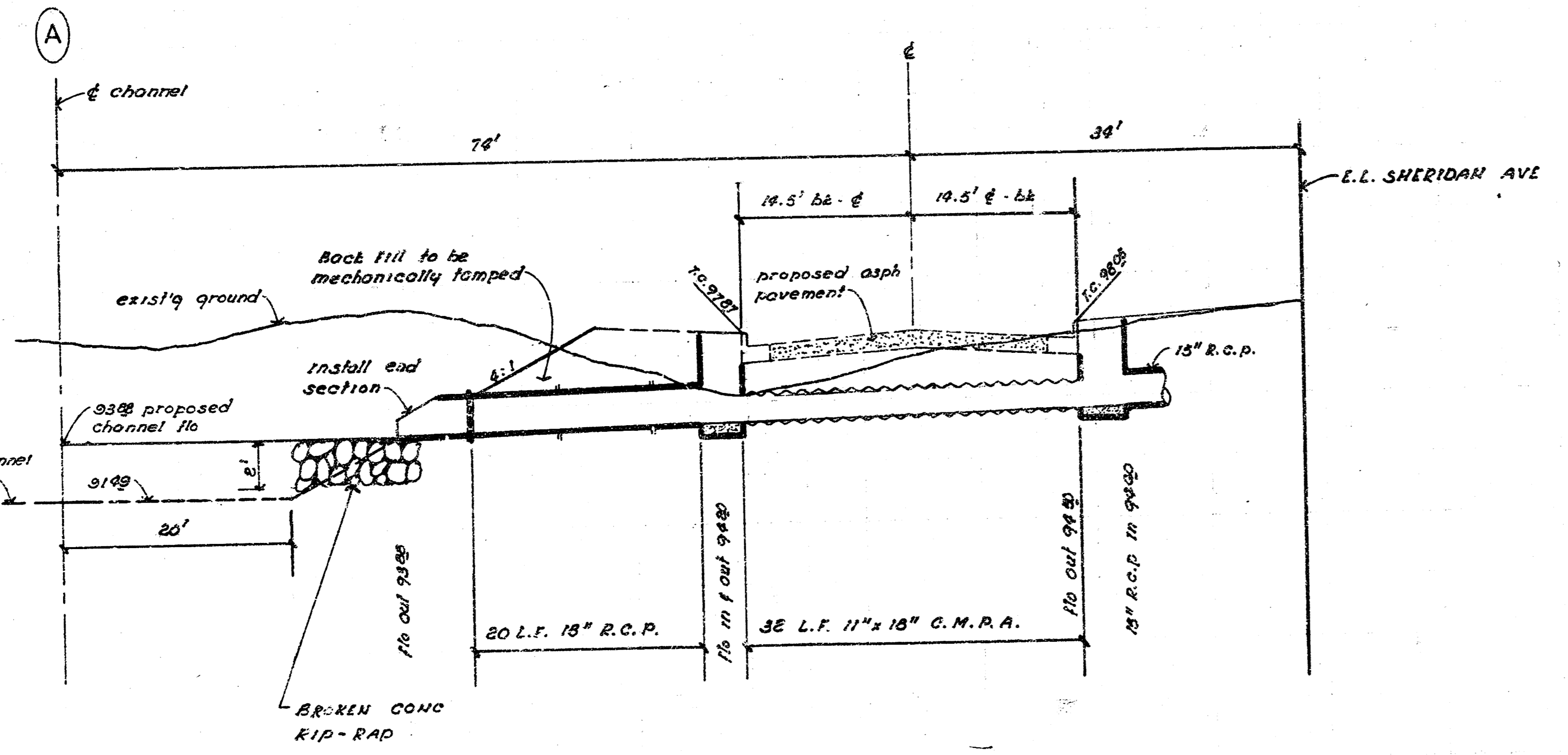

**** INCIDENTAL DRAINAGE ****
in connection with paving SHERIDAN AVE from S.L. 33rd to S.L. 31st STREET South.
CITY OF WICHITA, KANSAS
R. W. LINN CITY ENGINEER
DATE PROJ No. DARD 574130

S.M. 98' 11" D' cut N. end conc M.H. S.W. cor SHERIDAN & 33RD ST. S.

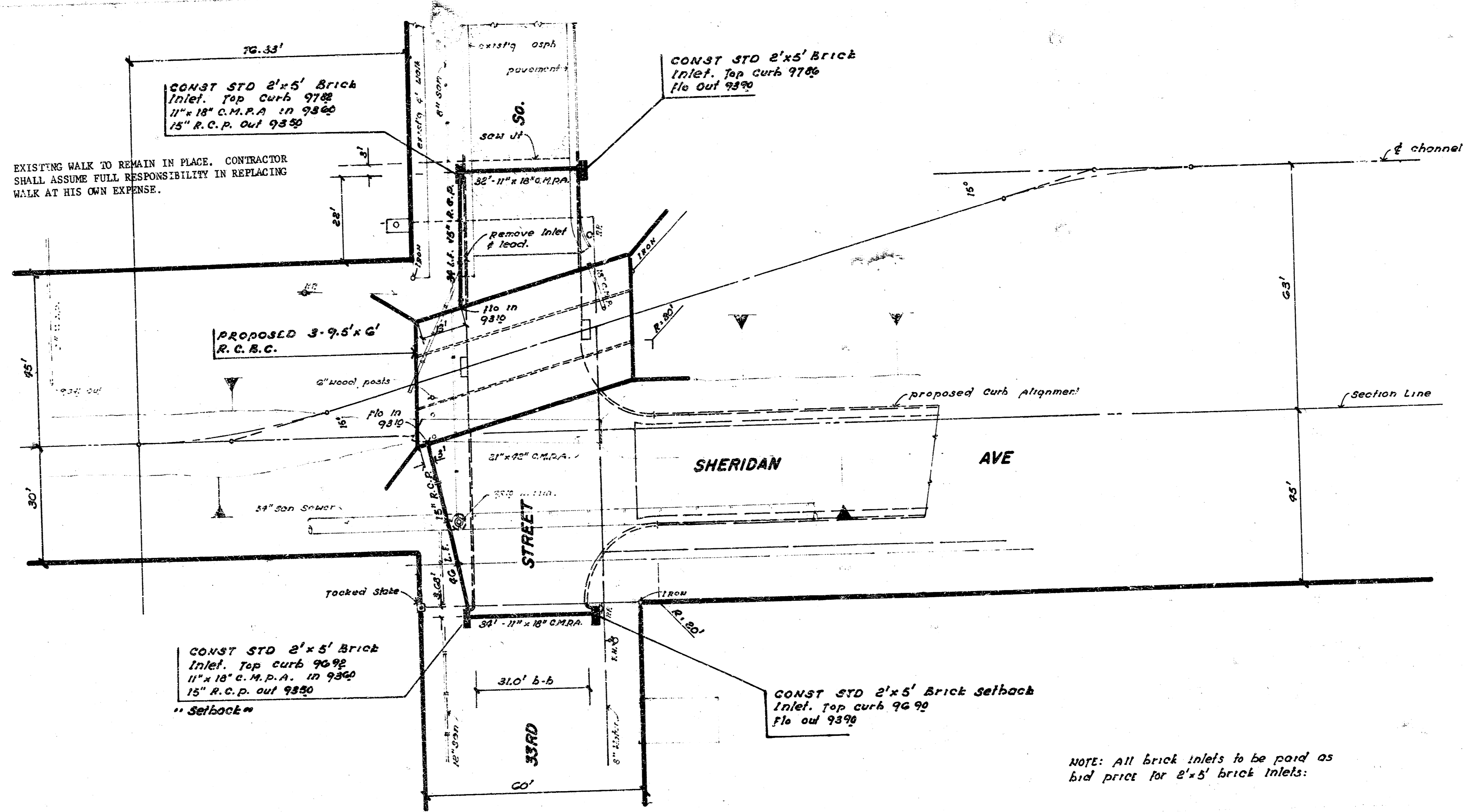

PLAN SCALE 1"=20'
PROFILE 1"=10' HORIZ
1"=5' VERT

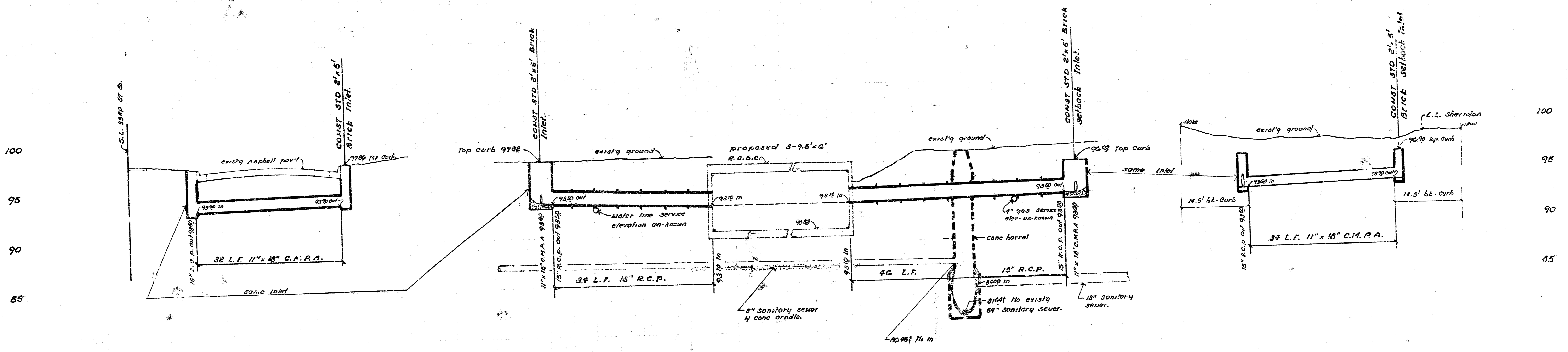

GLANTZ

845

504