

FENCHES

B.M. 115.99 'X' on Curb Highway 54 & Sheridan No.
 B.M. 115.43 N.W. Cor. Conc. Forch Ha #102
 B.M. 112.86 Spike E. Side H.L.P. S.W. Cor. Taft & Sheridan
 B.M. 113.82 'G' in Globe & W.K. E. At N.E. Cor. Sheridan & Maple
 B.M. 114.038 City B.M. Disc #12 No. & 26th W. of & Sheridan & Maple

Stationing & Base Line on 1/2 Section Line, Chaining North

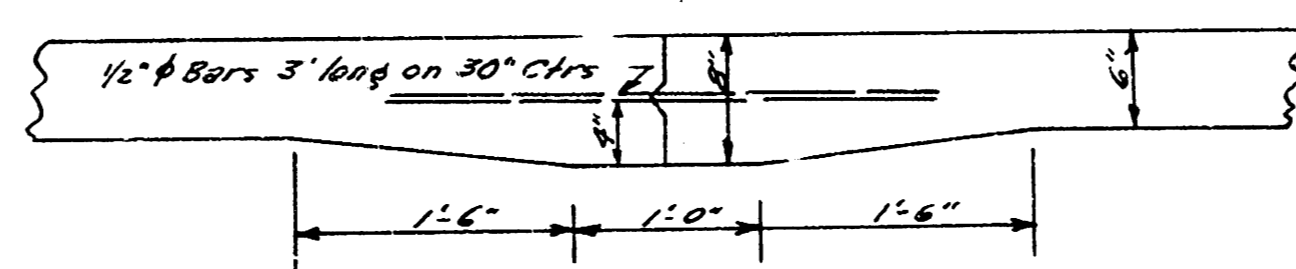

MASTIC JOINT DETAIL
NO SCALE

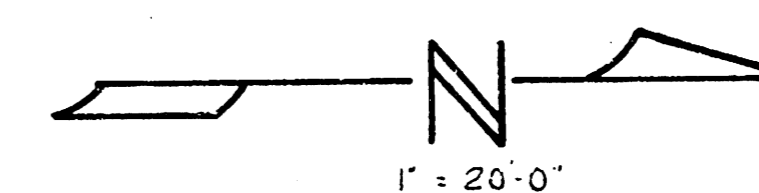

NOTE: ABANDON EXISTING DROP CATCH BASIN BY PLUGGING 15" R.C.R. AT THE POINT WHERE NEW 2x5 CATCH BASIN IS CONSTRUCTED. CONSTRUCT NEW 2x5 CATCH BASIN.

NOTE: RE-MODEL EXISTING DROP CATCH BASIN INTO A MAN HOLE & CONNECT NEW 2x5 CATCH BASIN TO IT WITH 15" R.C.R.

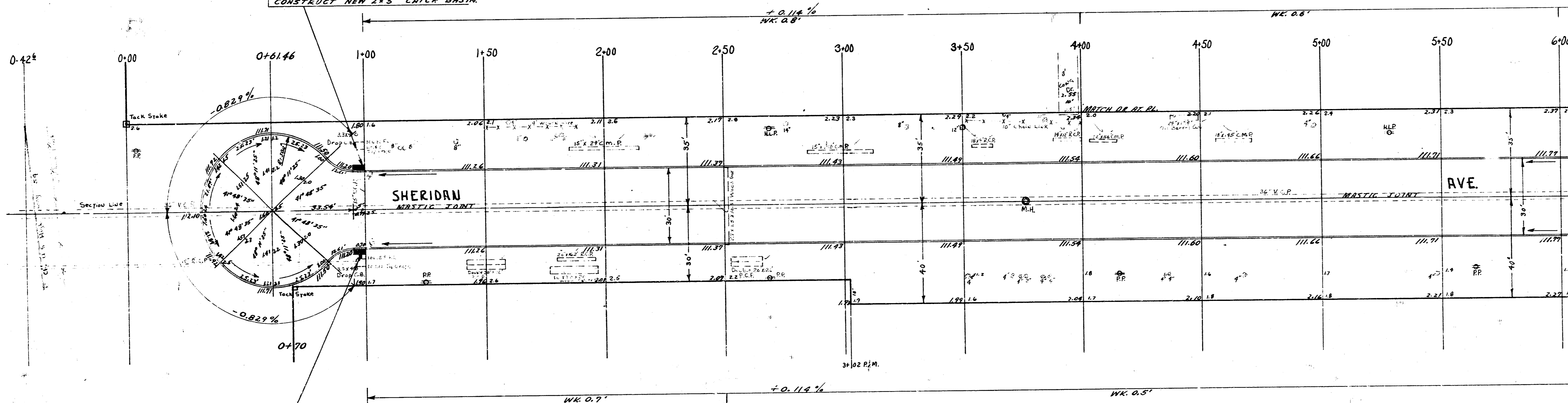

Excavation

111	120
122	120
123	120
124	120
125	120
126	120
127	120
128	120
129	120
130	120
131	120
132	120
133	120
134	120
135	120
136	120
137	120
138	120
139	120
140	120
141	120
142	120
143	120
144	120
145	120
146	120
147	120
148	120
149	120
150	120



SHERIDAN AVE.
 N.L.S. HIGHWAY 54 - S.L. UNIVERSITY EAST
 30 Conc. & Cb.
 CITY OF WICHITA, KANSAS
 B.E. SMITH CITY ENGINEER
 MAY 1958 PROJ. NO. C16-216

1/5

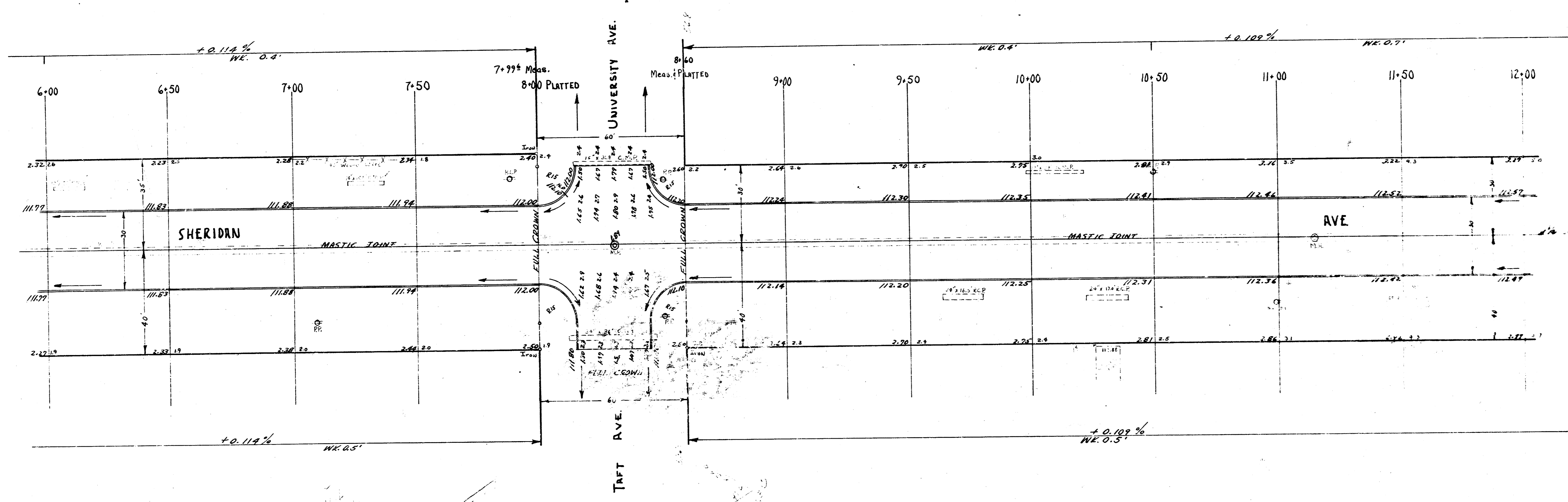
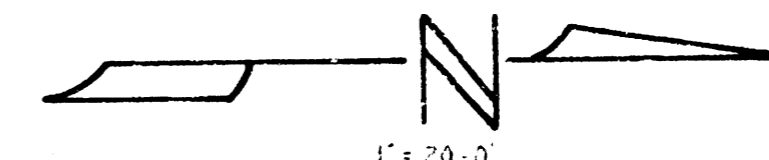

SHERIDAN AVE.
PROJ. NO. C16-216

25

