

B.M. 10342 S.E. Cor. Cone Porch, House on N.W. Cor. Laura & Skinner

P.I.
Sta 1400
Elev. 101.80
10016

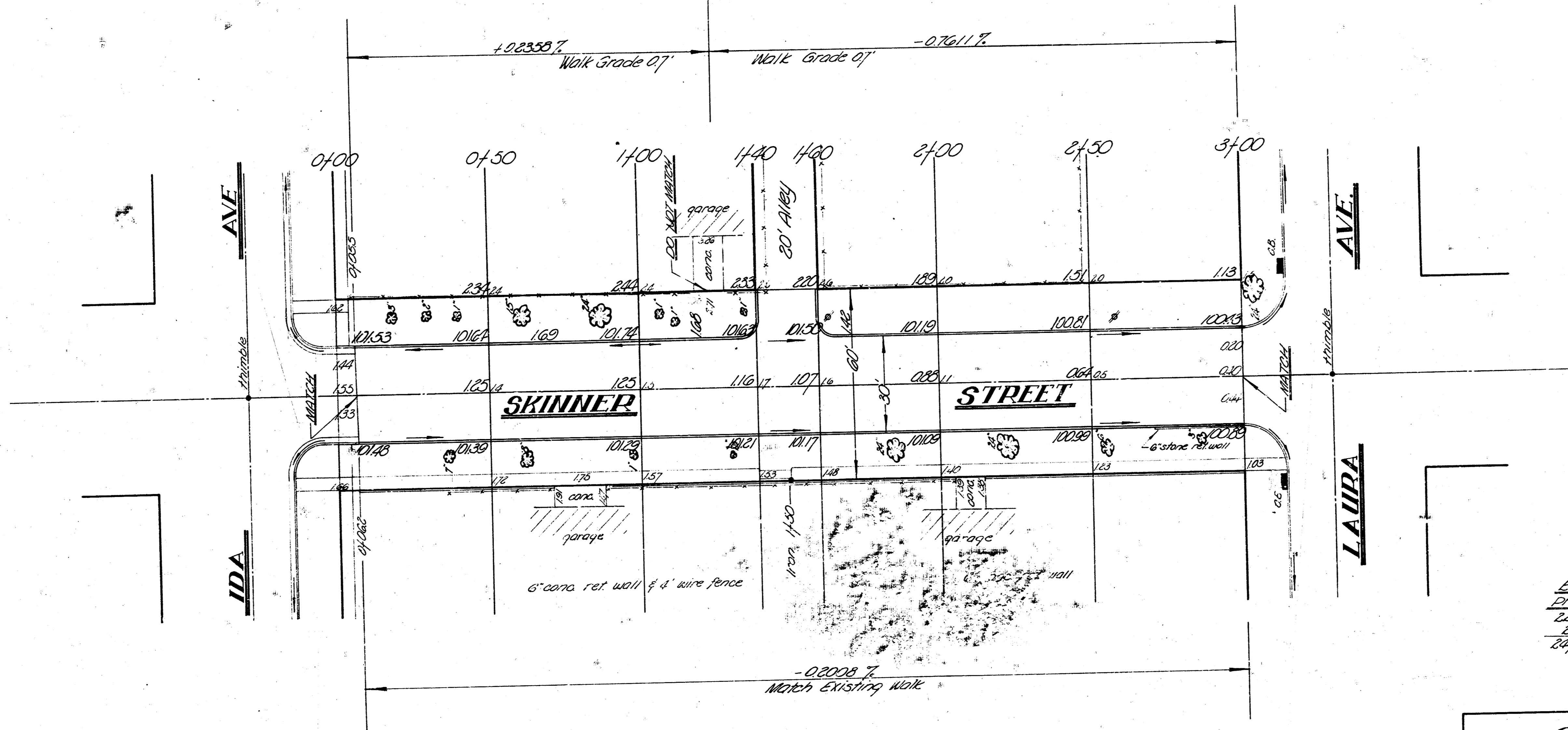

Sheet No. 5-29



EXCAVATION

PROP.	CITY
2245	174
2470	151

SKINNER
 EL. Ida to Laura
 30' Conc. & Curb
 City of Winston-Salem
 2002

