

Survey  
 Pricson  
 Pricson  
 Pricson

B.M. 98.645 Standard at Seneca & 27th St. So.

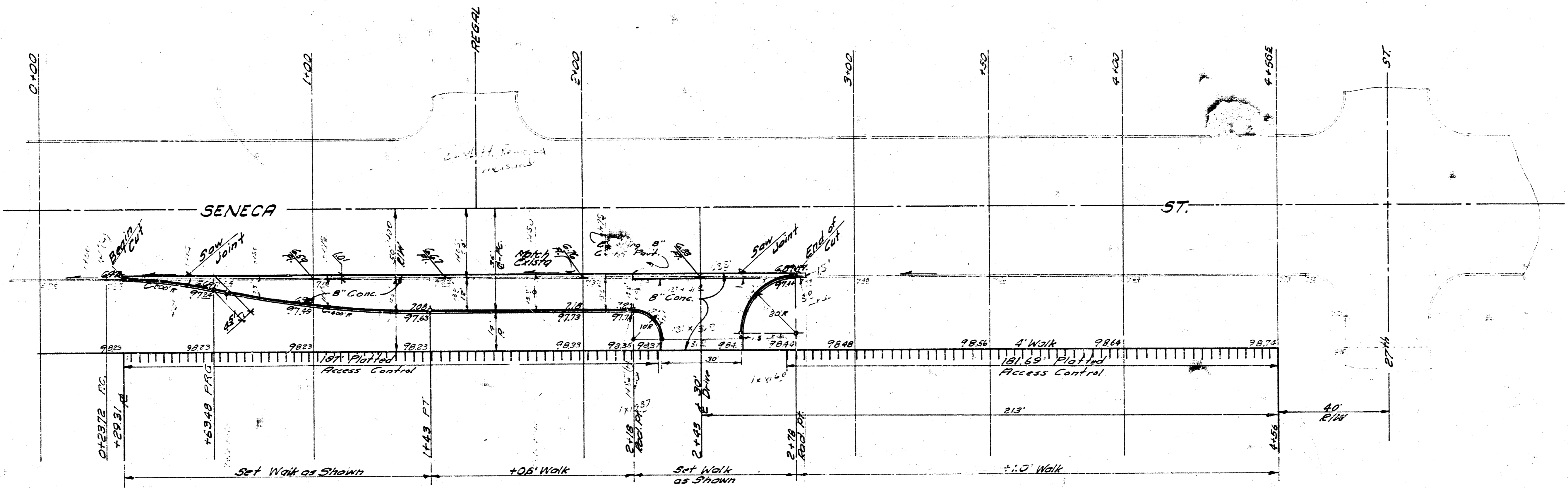

"Note to Field Engineer"  
 Check existing flow line at each  
 end of project and straight  
 grade between  
 cross-section points before other

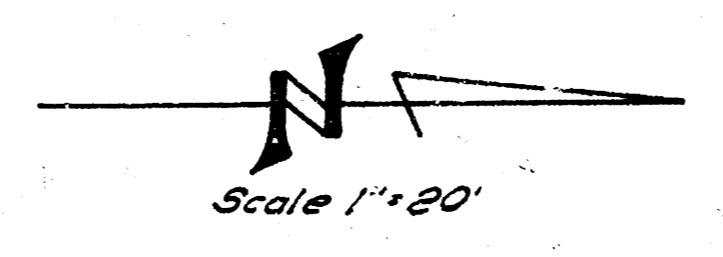
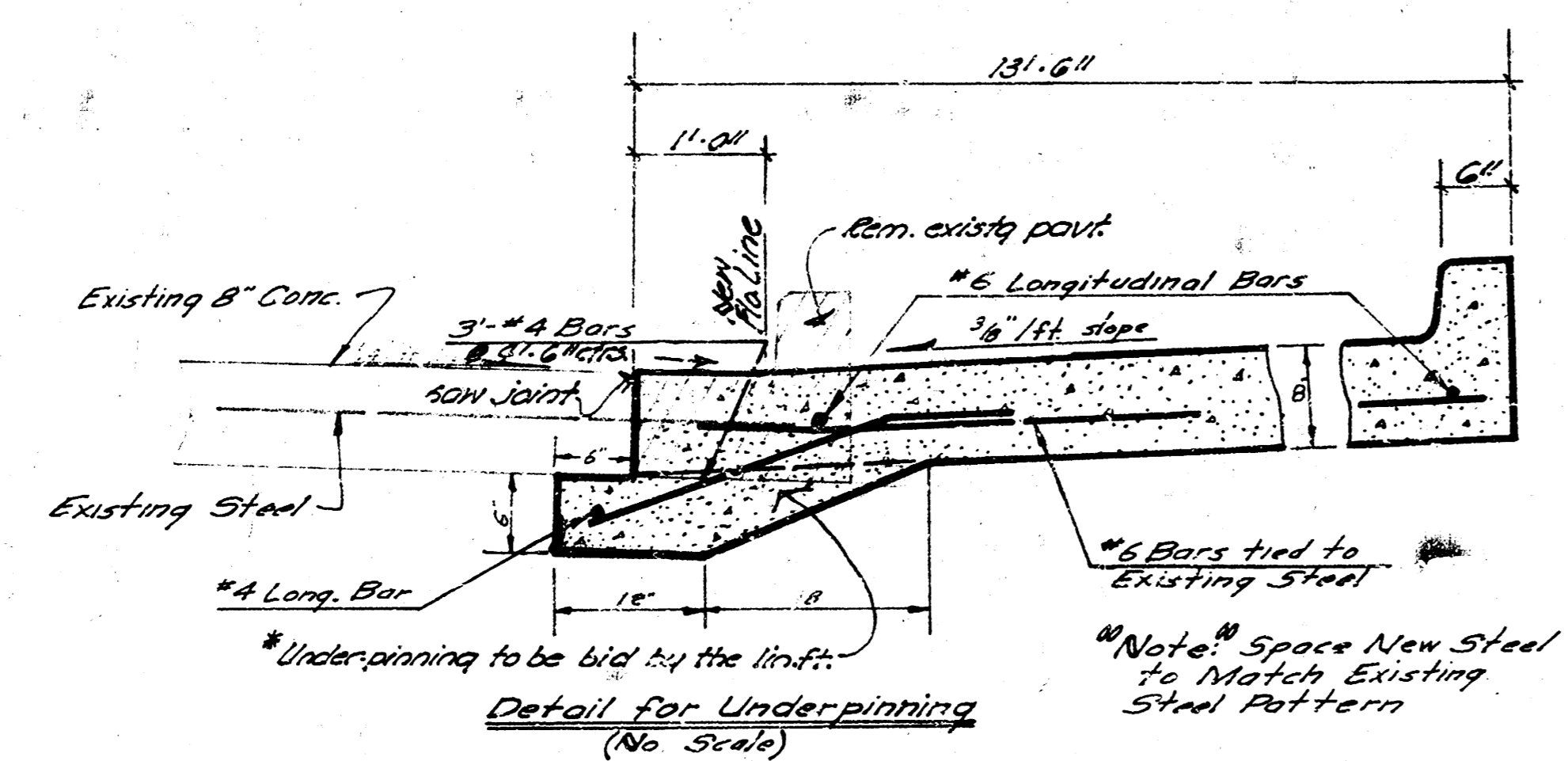

"Note"  
 Contractor to use Extreme  
 Care in Finishing Concrete to  
 Insure Drainage at Flo Line  
 of Street.

SENECA AVE.  
 DECELERATION LANE AND  
 DRIVE FOR HEERSCHE ADDN  
 8" Conc. & Int. Curb  
 B.E. Smith City Engineer  
 City of Wichita, Kansas  
 Date July  
 Jan. '68  
 GAS TAX 77-142

