

B.M. 101.99 NE cor. conc. P.C. 2nd Ho. N. of Savannah vs Everett
 B.M. 100.72 NW cor. conc. P.C. Ho # 2203 Savannah.
 Base line of sta on U. B. chain E.

NOTE: TO FIELD ENG. & CONTRACTOR:
 All entrance pipes are to be
 disposed of in accordance
 with instruction from the
 city dirt checker.

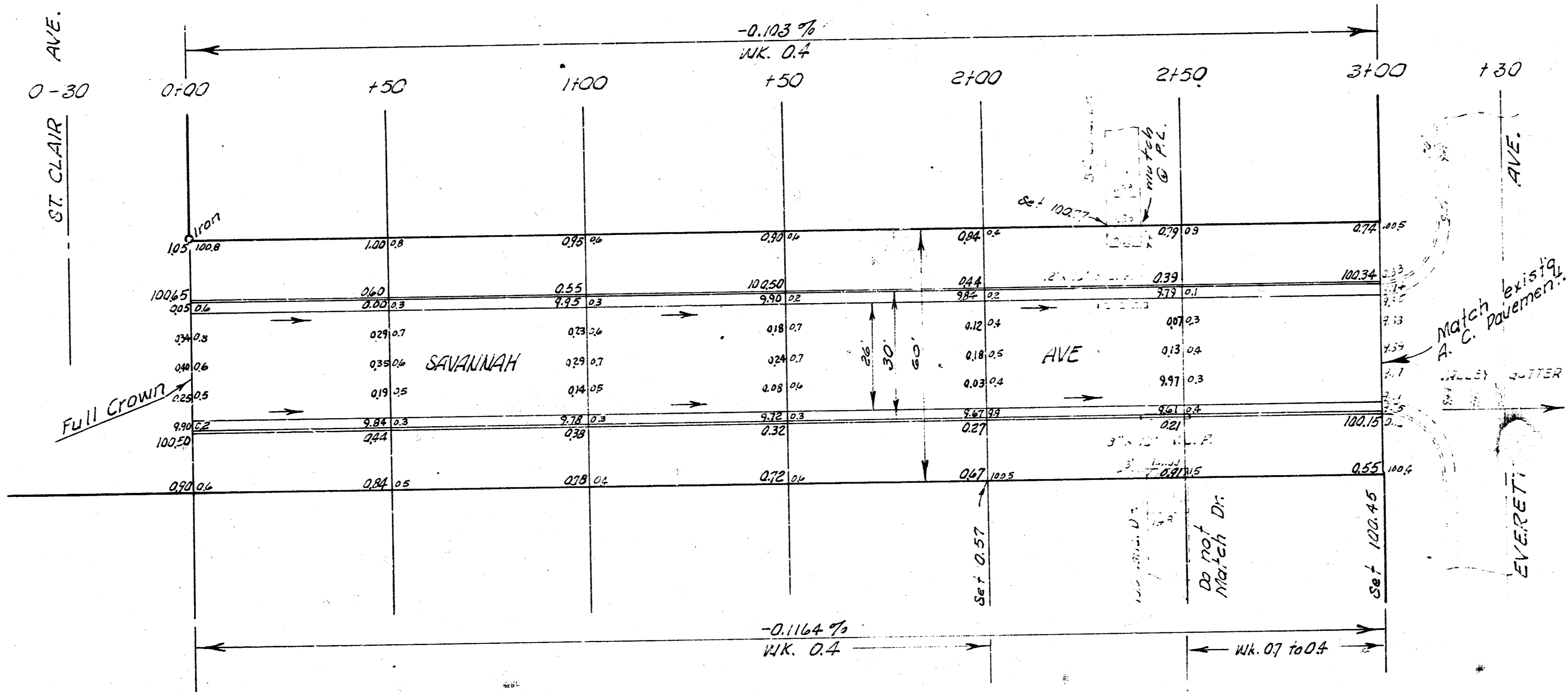

EARTH WORK
 EXCAVATION

CITY	PROP.
0.0	339.7
	+10%
0.0	34.0
	373.7

Co. Yds.



SAVANNAH AVE.
 EL ST. CLAIR TO W. EVERETT
 26'-2'-30" A.C.
 CITY OF WICHITA, KANSAS
 J. E. SMITH CITY ENGINEER
 220 W. 30th St.