

B.M. 9399 1/4" SPIKE IN FACE OF 18" ELM 5 FT. W/O-W. IN ON W. END 4 NR GREENWAY
 B.M. 9454 1" IN 1948 TOP CURB E SIDE SANTA FE 4 NR WASSAL ST.
 STA. ON 9 FT. OFFSET W/O E.P.

CURVE DATA				
Sta	Curve S. @ W.Ce	Curve S. @ E.Ce	Direction	Total Def.
0+00	PC			
0+25	19.30	24.98	3° 52' 29"	3° 52' 29"
0+50	19.30	24.98	3° 52' 29"	7° 44' 58"
0+75	19.30	24.98	3° 52' 29"	11° 37' 27"
1+00	19.30	24.98	3° 52' 29"	15° 29' 56"
1+3295	25.82	33.41	5° 11' 09"	20° 41' 00"

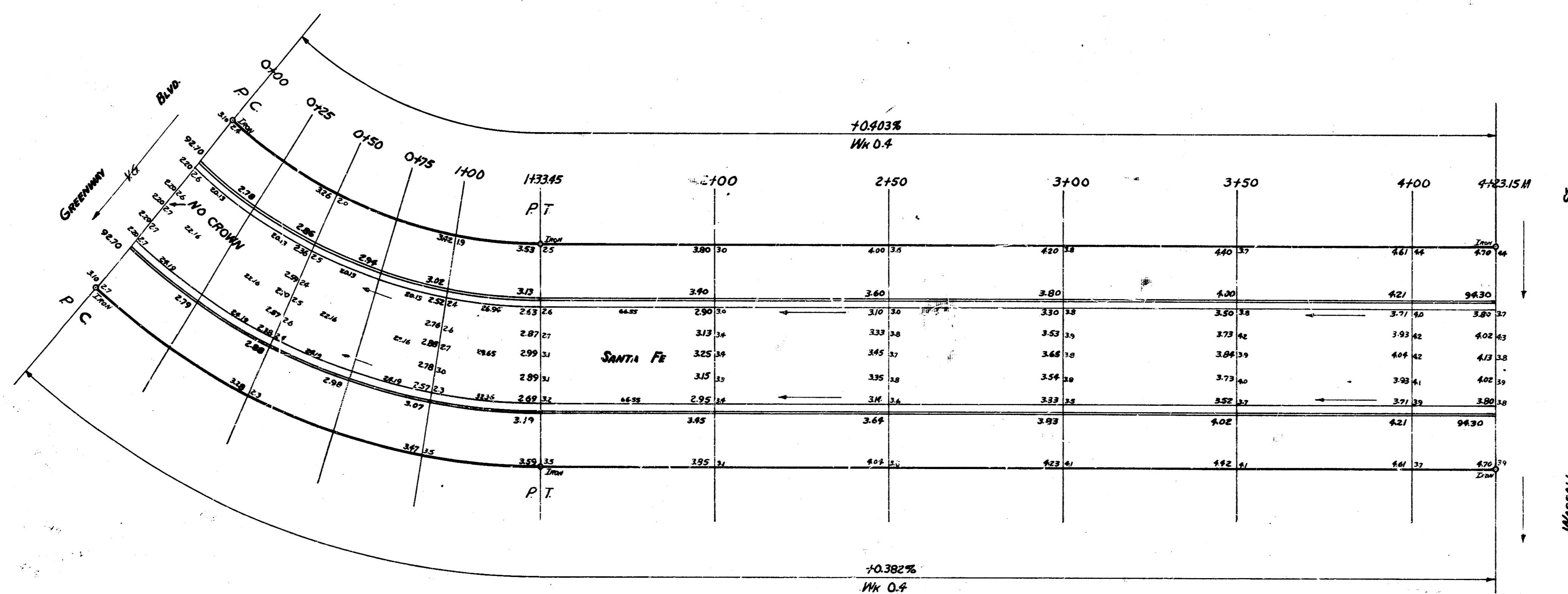

JANUARY 1955
W.P.
W.P.

SANTE FE
 EL GREENWAY TO S.L. WASSAL
 26-2-30 AC.
 CITY OF WICHITA, KANSAS
 B.E. SMITH CITY ENGINEER
 APRIL 1955 PROJ. NO. C.15-4

