

B.M. 157.08 Top bolt SW Cor. H.L.P. Base S-Side NGE Westlink Sub Station on 13th

$\Delta = 43.94' = 81.7'$ $34.07'$ $63.92'$ $64.15'$
 CURVE DATA BASED ON $R_{\text{Prop}} = \text{RAD}$ $D_s = 25.00'$

STA	ARC	CHORD LENGTH	DEFLECTION	TOTAL DEFLECTION
		$\frac{2R \sin(\frac{\theta}{2})}{2}$	θ	θ
0+34.08	0		0° 00' 00"	0° 00' 00"
0+50.0	15.92'	20.37'	11.82°	11° 49' 57"
0+75.0	31.84'	40.74'	23.64°	23° 39' 54"
1+00.0	47.76'	61.11'	35.46°	35° 15' 51"

$\text{Def}/\text{in Min} = 21.038860 \text{ Min}$

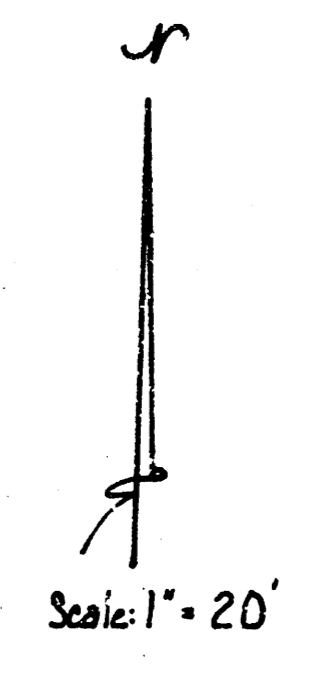
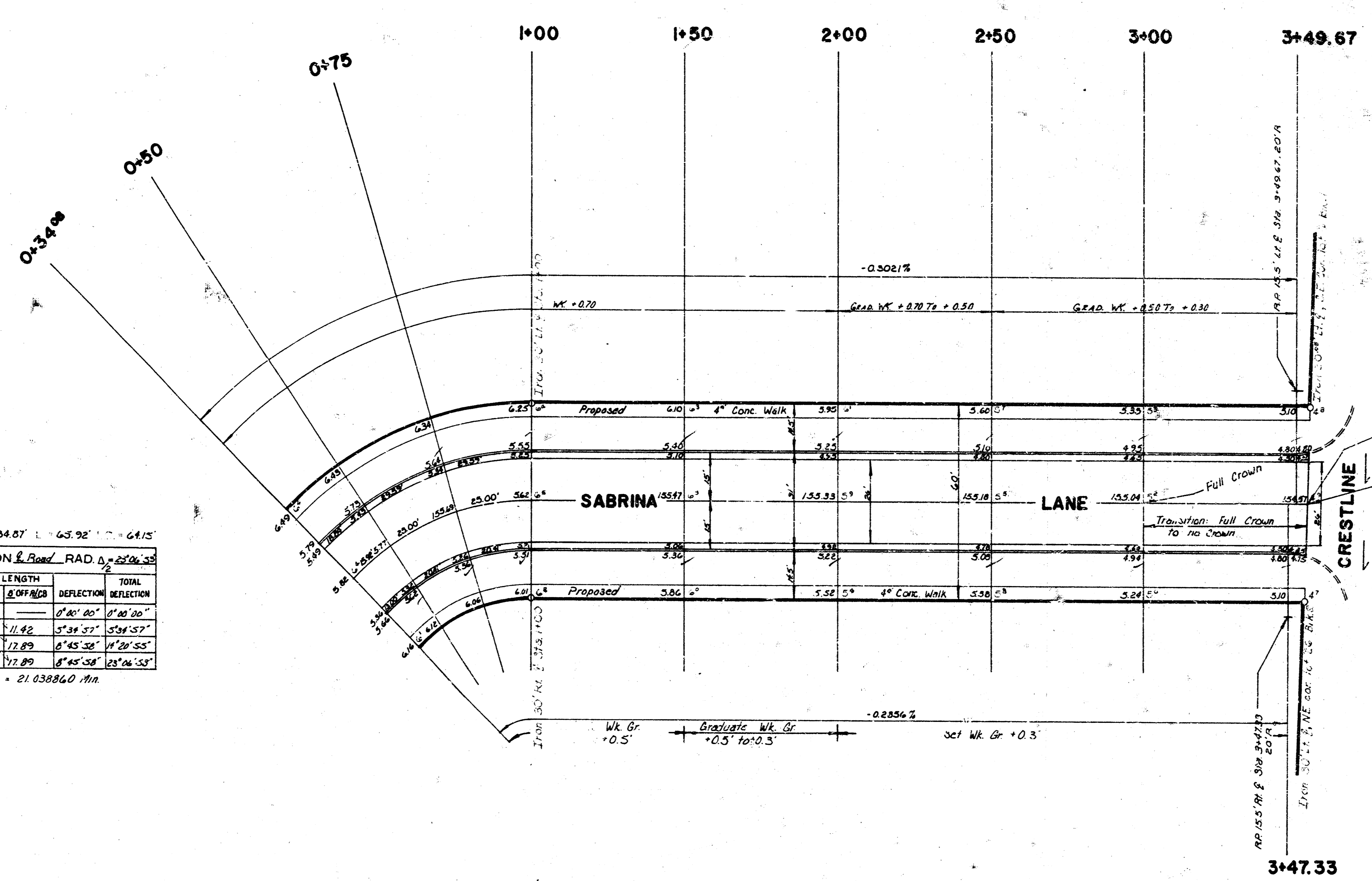

- Note: Contractor to clear Right-of-Way, Grade Parking, and compact fill in sidewalk areas. Sidewalk to be constructed by others.
- Note: Field Engineer to determine which portions are to have 4" treated sub-grade and which portions are to be sub-grade modified.
- Note: Baseline = Sabrina Lane.
- Note: All excess excavated material from this project is to be stockpiled at locations determined by the Engineer in Westlink Village 10th Addition.
- Note: 3-20' Drives is the Maximum Number of Drives that shall be constructed and cleared to this project.

- Note: Roll type comb. Cb. & Gutter to be used throughout project.
- Note: The cost of widened sections of Roll type comb. curb & gutter is to be included in the bid price for lin. ft. roll type comb. curb & gutter.



SABRINA LANE
N.L. LOT 10 BLK. I WESTLINK
VILLAGE 10TH ADDITION TO
W.L. CRESTLINE
ASPHALTIC CONCRETE PAVEMENT
3" B-B WITH COMB. CB. & GTR.
CITY OF WICHITA, KANSAS
R.W. LINN CITY ENGINEER
PROJECT NO. DAKS572038
DATE:

Item	Quantity	Unit
Earthwork	512.2	Cu Yds.
Comp. Fill	5	Cu Yds.
Total	517.2	Cu Yds.
Earthwork	543.4	Cu Yds.
Comp. Fill	0.5	Cu Yds.
Total	543.9	Cu Yds.

1/2