

B.M. 107.27 Large staple 1" between prongs on N. face P.P. S.W. cor. Rutan & Kinkaid  
 B.M. 104.34 40" Nail S.S. 18" Cedar Tree S.W. cor. Rutan & Bellaire  
 Stationing on W.R.

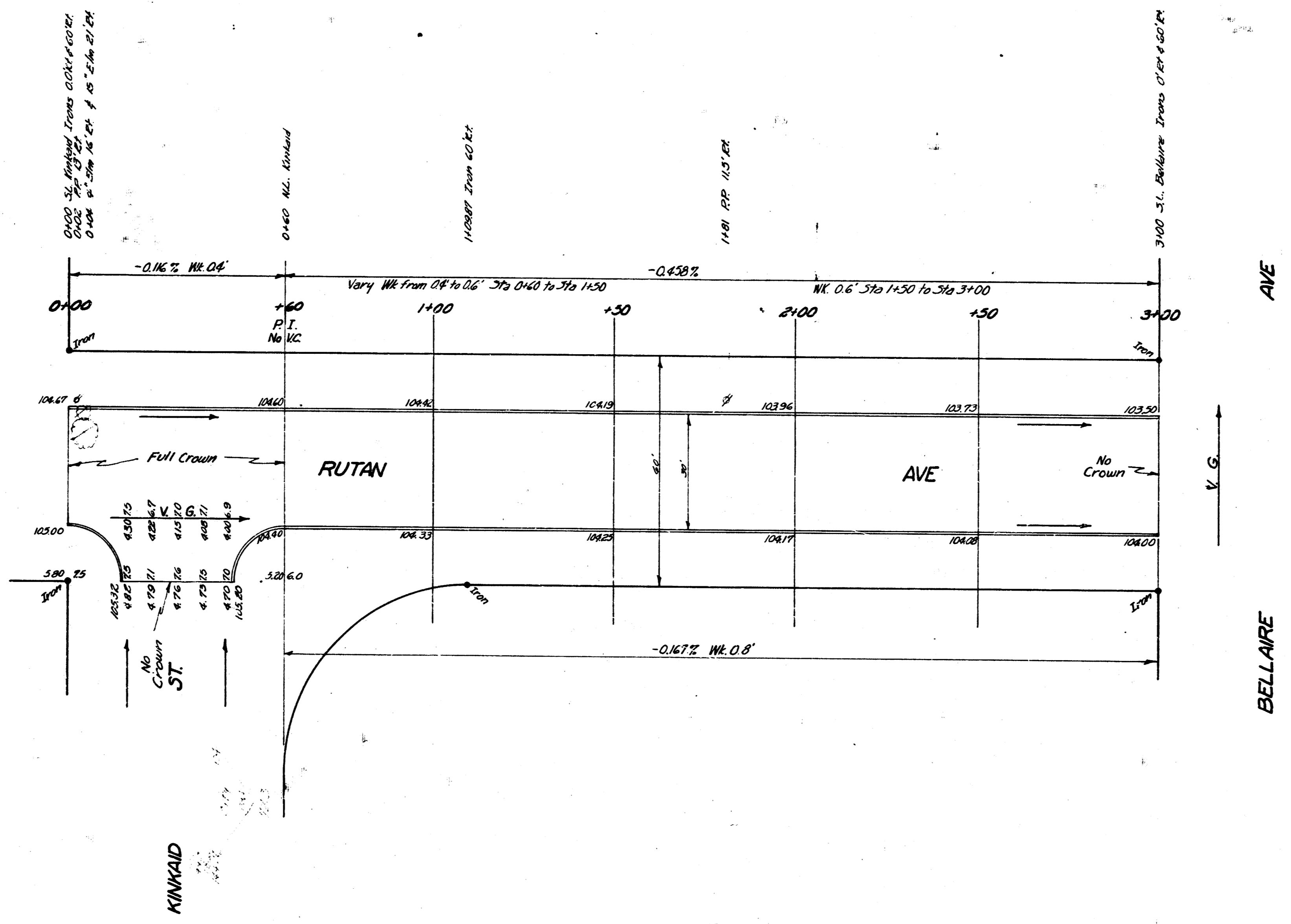
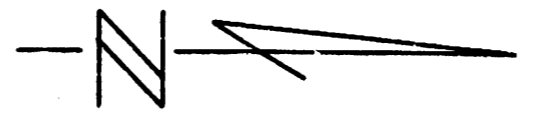

Survey made by J. J. JAKOBY  
 City Engineer  
 1954

Excavation

| Prop.  | Exc. | City |
|--------|------|------|
| 1326.8 | 0    | 15.2 |
| 1327.1 | 0    | 16.8 |
| 1427.2 | 0    | 18.1 |

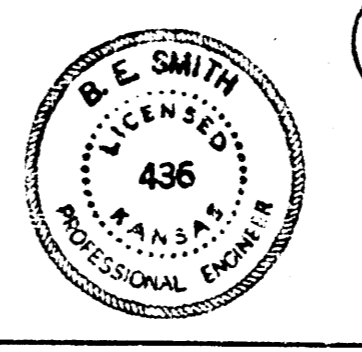

1/2

**RUTAN AVE**  
 C.L. KINKAID TO S.L. BELLAIRE  
 30' CONC. & CO.  
 CITY OF WICHITA KANSAS  
 B.E. SMITH CITY ENGINEER  
 APRIL 1954 PROJ. No. C13-212