

B.M. = 153.98 "G" in Globe-N end east return-Terrace Drive & Harry Str.
 " " = 139.93 City Standard S.E. corner Harry & Oliver
 base-line = $\frac{1}{4}$ Terrace Drive



NOTE - Prime & Seal Coat will be bid as 2" each, that remains includes rock base. If total depth of 4" is shown, 2" is shown subtracted from C.V. Excavation.

NOTE - Curb Elevations shown are top of full curb.

NOTE - Prime & Seal Coat = 2" approx. Rock Base = 2" "

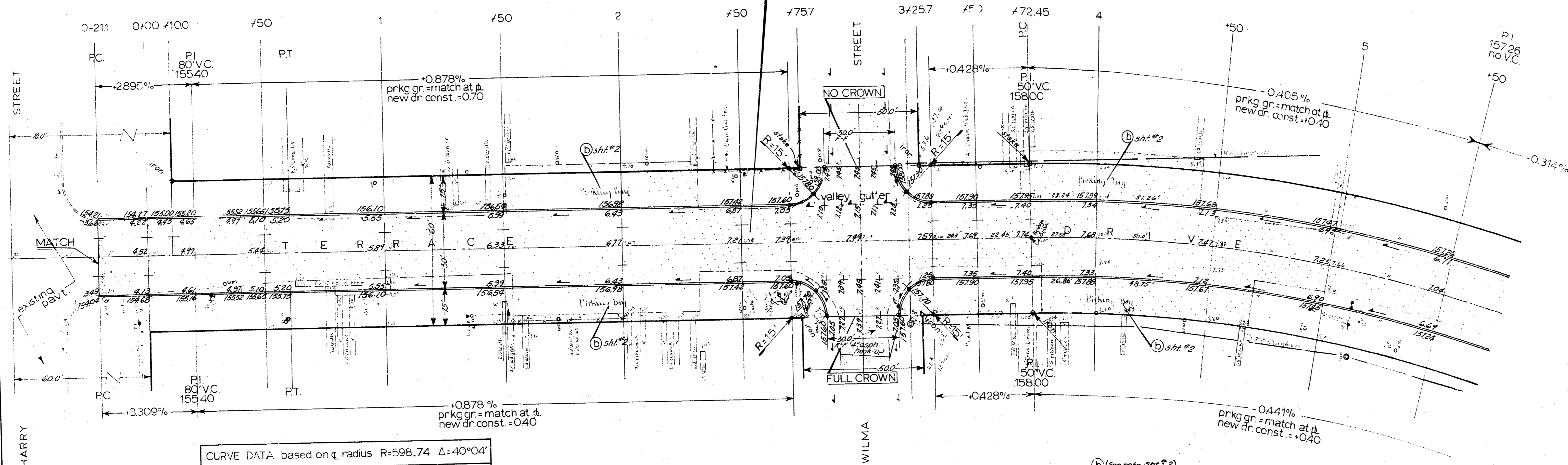

CURVE DATA based on ϵ radius R=598.74 $\Delta=40^{\circ}04'$

sta.	arc.	chord lgth	chord lgth	deflection	total
		6'@east cb	6'@west cb		deflection
3+724.51	PC			0' 00" 00"	0' 00" 00"
4	2755	26.46	28.58	1' 19" 06"	1' 19" 06"
150	50.0	48.06	51.90	2' 23" 32"	3' 42" 38"
5					5' 06" 10"
150					8' 29" 42"
6					10' 53" 14"
150	50.0	48.06	51.90	2' 23" 32"	12' 16" 46"
1025	1175	11.30	12.20	2' 33" 44"	13' 50" 30"
7+821.3	58.38	56.11	60.59	2' 47" 36"	16' 37" 04"
150	29.87	28.71	31.00	1' 38" 45"	18' 05" 51"
7+915	41.15	39.61	42.78	1' 38" 45"	20' 01" 52"

NOTE TO FIELD ENGINEER - All approach walks to remain in place except where they interfere with construction. In this event remove only what is necessary for street const.

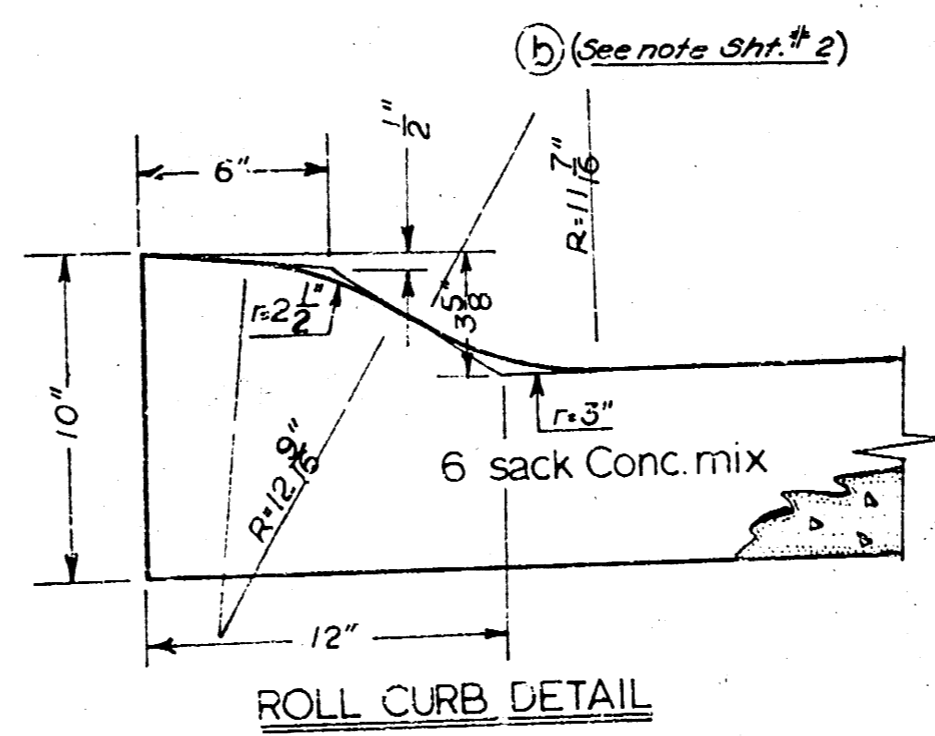
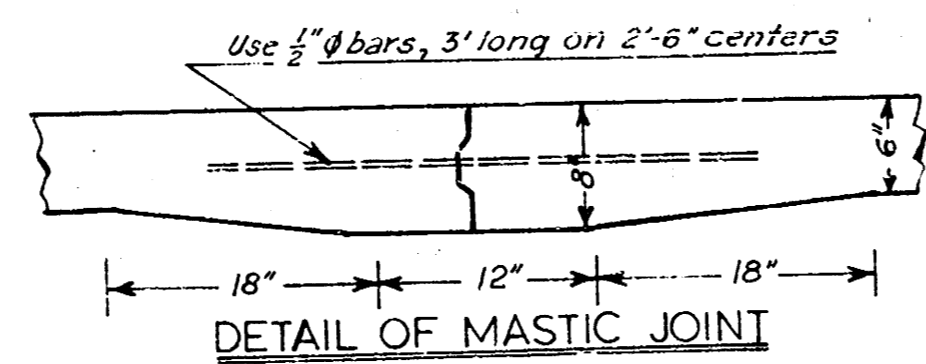

Original plan revised	5-15-62
TERRACE DRIVE	
N.L. Harry Str. to S.L. Boston Dr.	
30' Concrete Curb	
Department of Public Works - Engr. Div.	
CITY OF WICHITA, KANSAS	
B.E. Smith	City Engineer
Date: 5-17-62	Proj. No. C.11-36

Sht. 1 of 6

B.M. 15880 E Bolt on flange fire hydrant SW cor. Menlo & Terrace
 B.M. 15246 Spike in W. face p. pole S.E. Cor. Terrace & Boston

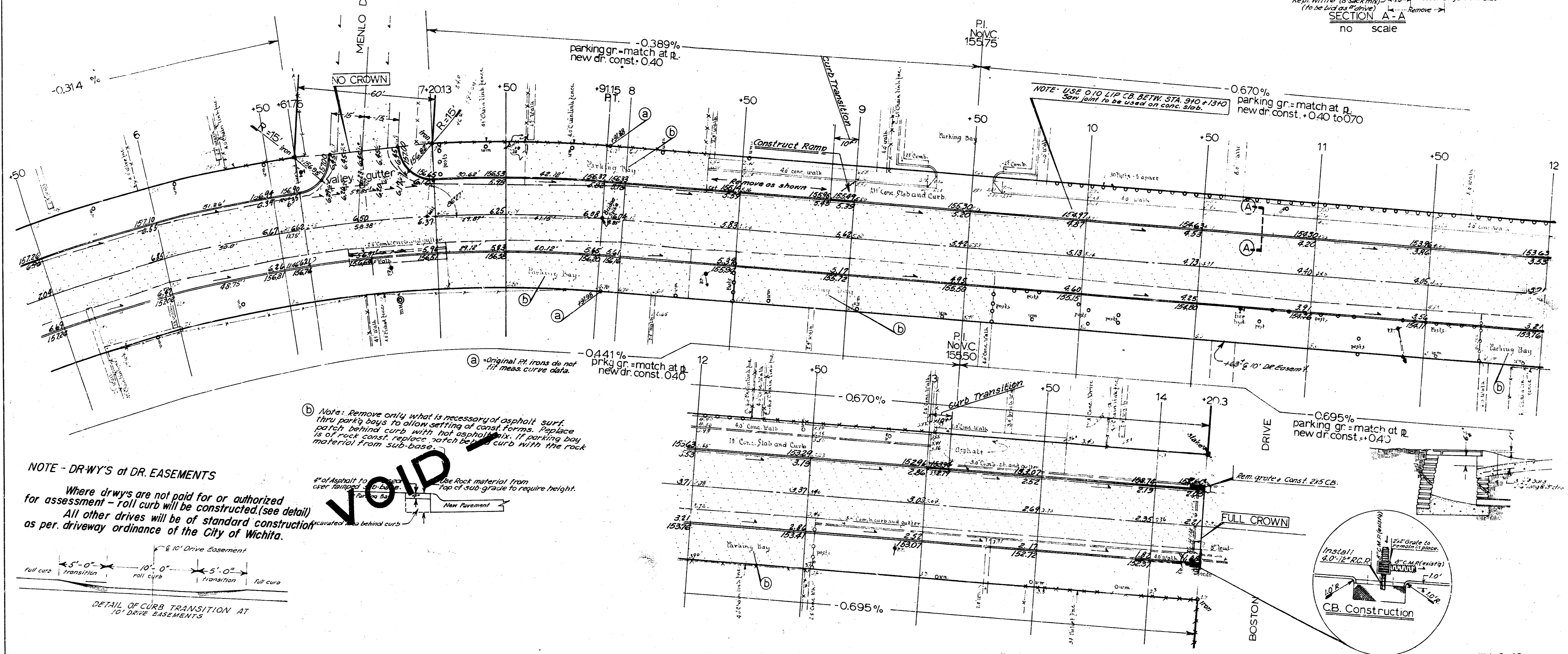
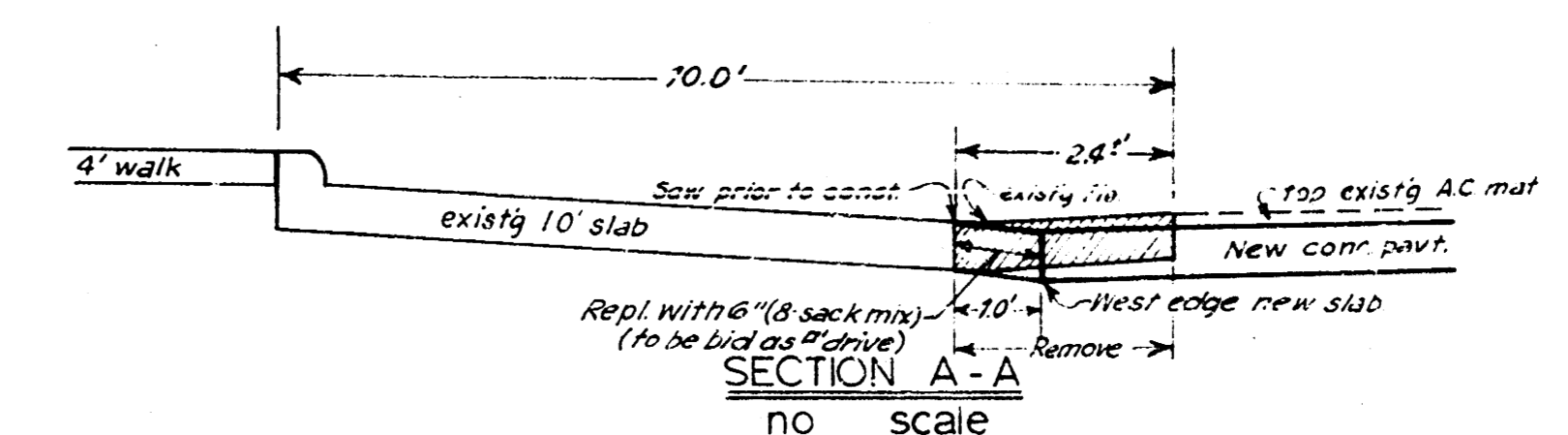
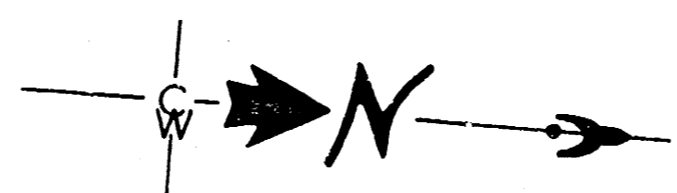

NOTE - DR-WY'S at DR. EASEMENTS
 Where drwys are not paid for or authorized for assessment - full curb will be constructed (see detail). All other drives will be of standard construction as per driveway ordinance of the City of Wichita.

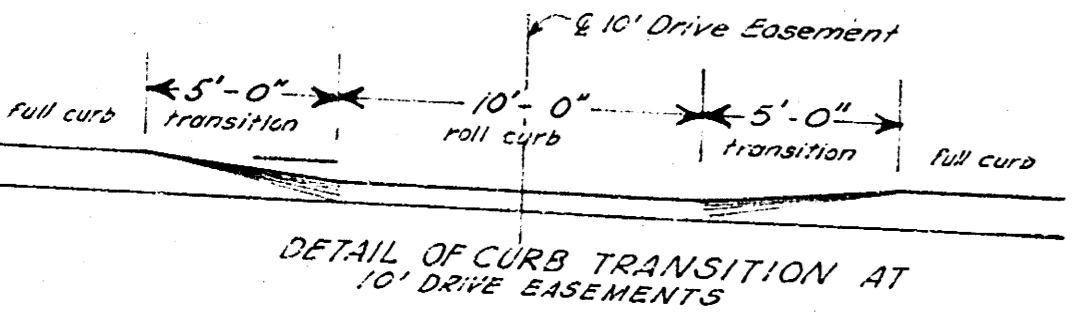

VOID
 Note: Remove only what is necessary of asphalt surf. drive parking bays to allow setting of const. forms. Place patch behind curb with hot asphalt mix. If parking bay material from sub-base, replace patch behind curb with the rock material from sub-base. Top of sub-grade to require height. New Easement

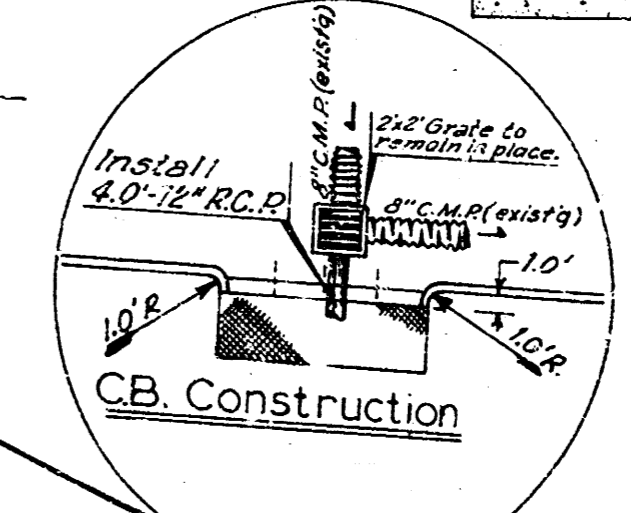

B.M. = 153.98 "C" in Globe-N end east return-Terrace Drive & Harry Str.
 " = 139.83 City Standard S.E. corner Harry & Oliver
 base-line = Terrace Drive

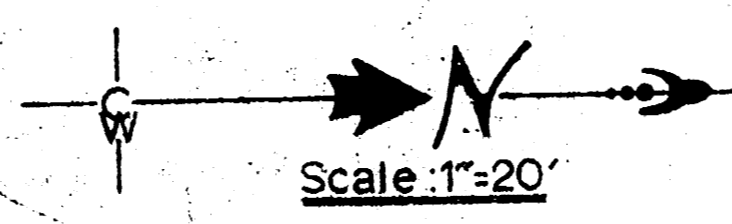

NOTE: Prime & Seal coat will be bid as Asphalt mat with 1 1/2" aggregate rock base. A total depth of 4 1/2" has been subtracted from C.V. excavation.

Curb elevations shown as top of roll curb.

NOTE - Prime (Seal Coat) = 2" approx. Rock Base

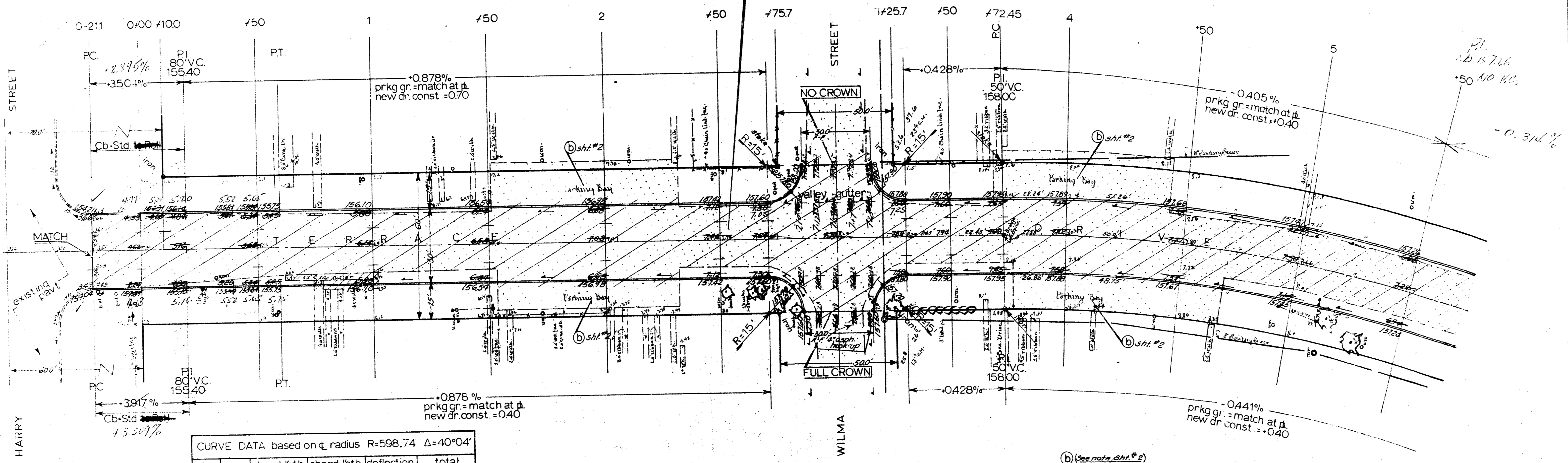

CURVE DATA based on Δ radius R=598.74 $\Delta=40^{\circ}04'$

sta.	arc	chord lgth	chord lgth	deflection	total deflection
		@east cb	@west cb		
372.45	RC			0' 00" 00"	0' 00" 00"
4	27.95	26.46	28.59	1' 19" 06"	1' 19" 06"
150	50.0	48.06	51.90	2' 23" 32"	3' 42" 38"
5	"	"	"	"	6' 06" 10"
150	"	"	"	"	8' 29" 42"
6	"	"	"	"	10' 53" 14"
150	50.0	48.06	51.90	2' 23" 32"	13' 16" 46"
141.15	11.75	11.30	12.20	0' 33" 44"	13' 50" 30"
720.13	58.38	56.11	60.59	2' 41" 36"	16' 32" 06"
150	29.87	28.71	31.00	1' 29" 45"	18' 01" 51"
749.15	41.15	39.61	42.78	1' 58" 08"	20' 01" 59"

NOTE TO FIELD ENGR. - All approach walks to remain in place except where they interfere with construction. In this event remove only what is necessary for street const.

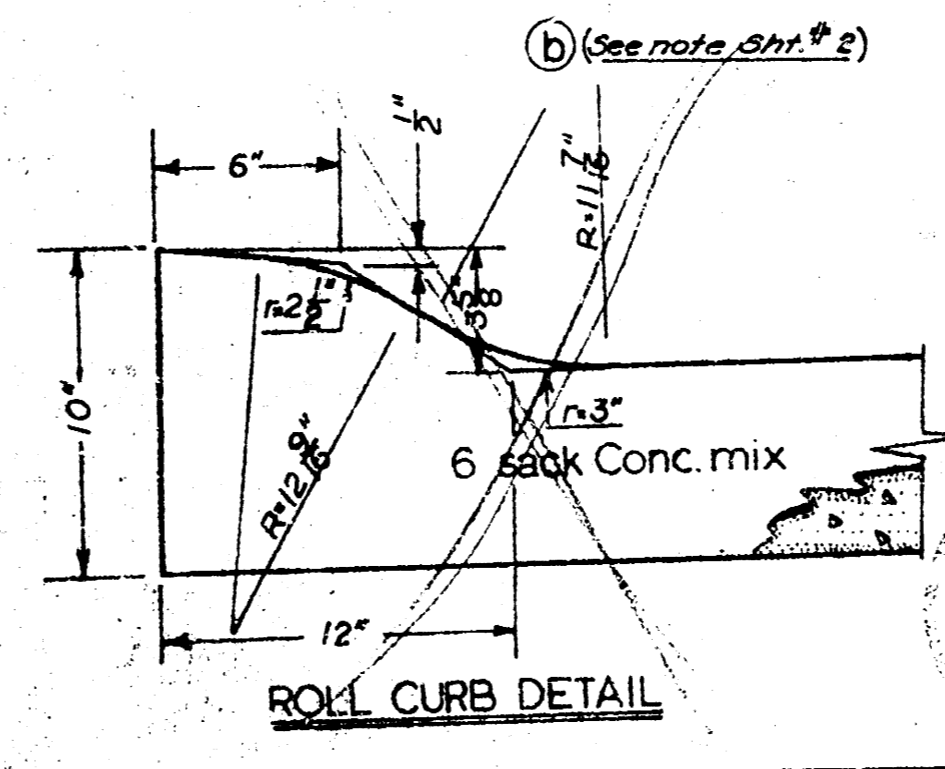
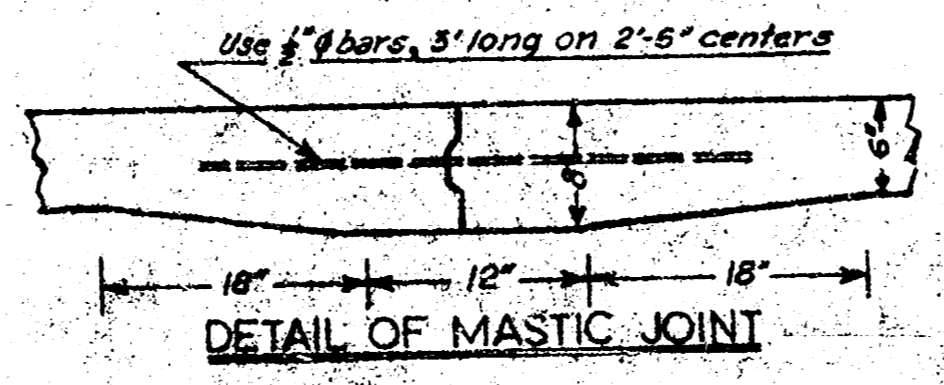

TERRACE DRIVE	
N.L. Harry Str. to S.L. Boston Dr	
30' Concrete Curb	
Department of Public Works-Engr. Div.	
CITY OF WICHITA, KANSAS	
B.E. Smith	City Engineer
Date: APRIL 1962	Proj. No. C11-36

Sht. 1016

1. Bolt on flange fire hydrant SW cor. Menlo & Terrace
 2. Spike in W. face p. pole S.E. Cor. Terrace & Boston

