

B.M. 117.90 "D" N.E. Cor. top Head Wall
30' N. & 34.5' W. E. Anna & Maple

B.M. 117.15 "G" in Globe W. curb
Young 1' S. of S.L. Douglas

T.P. 120.23 "M" in Mueller File
Hyd. S.E. Cor. Tracy & Douglas

Scale: 1" = 20'

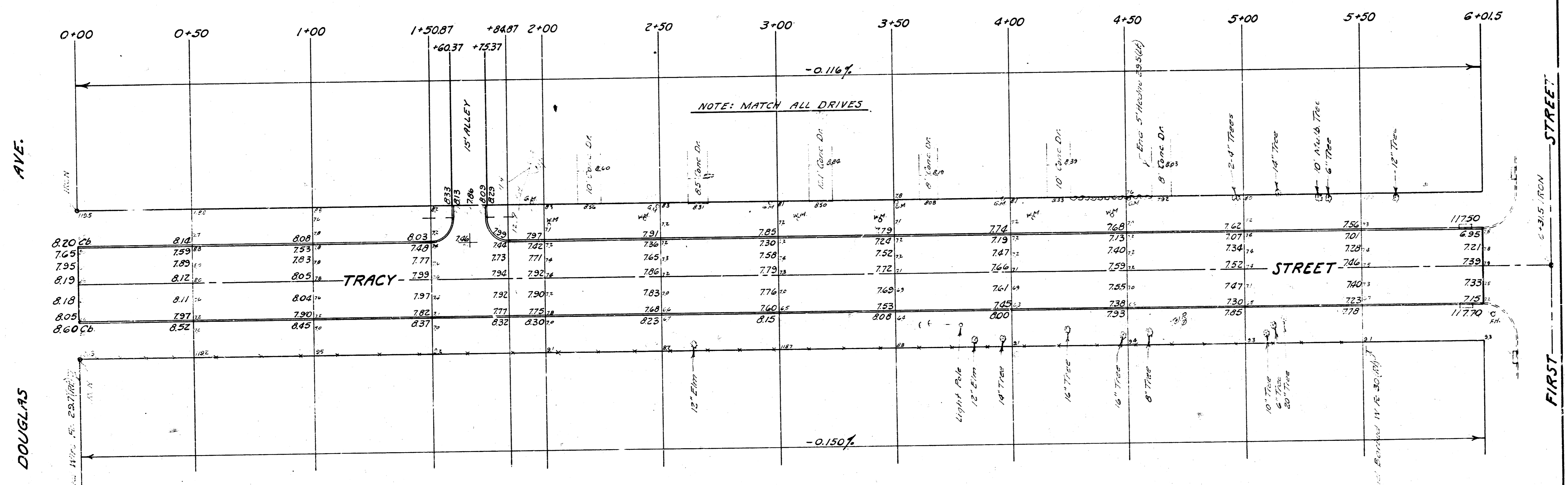

Cu. Yds.	PROPERTY	
	Exc.	Comp. Fill
-10%	187	62
	19	6
Total	206	68

CITY	Exc.	Cu. Yds.
3		3 Cu. Yds.

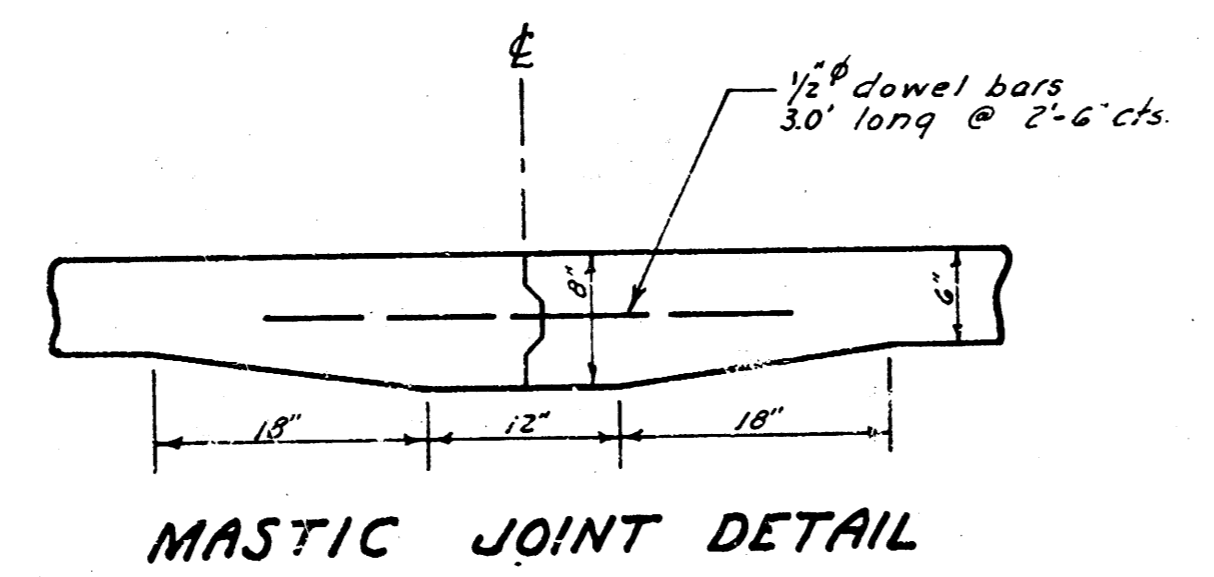

TRACY STREET
From N.L. DOUGLAS AVE.
To S.L. FIRST STREET
30'-6" Conc. & Int. Curb
B.E. SMITH CITY ENGINEER
CITY OF WICHITA, KANSAS
JULY 1962 Proj. No. C15-113

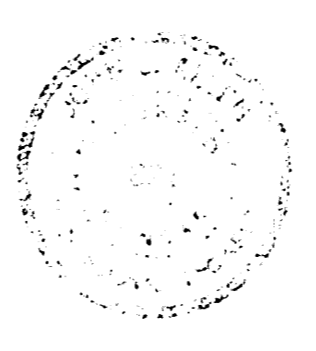

1/2