

BM BOLL WS OF HACKBERRY TREE NS OF TULSA 23'E OF E.L. WASHINGTON ELEV 95.01

NOTE:
STA ON N.P.L.

AVE

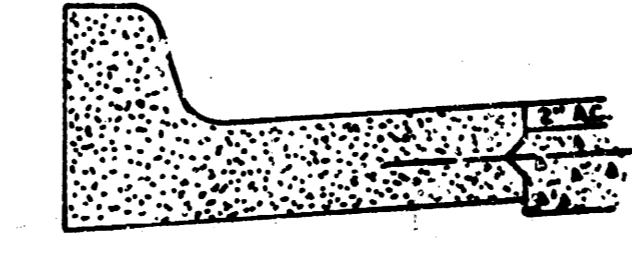
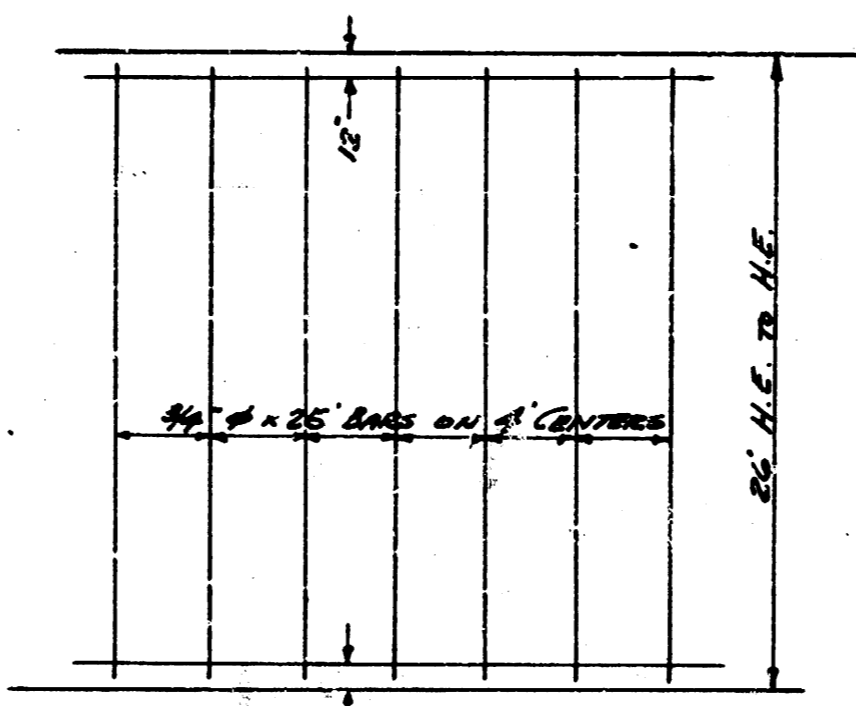
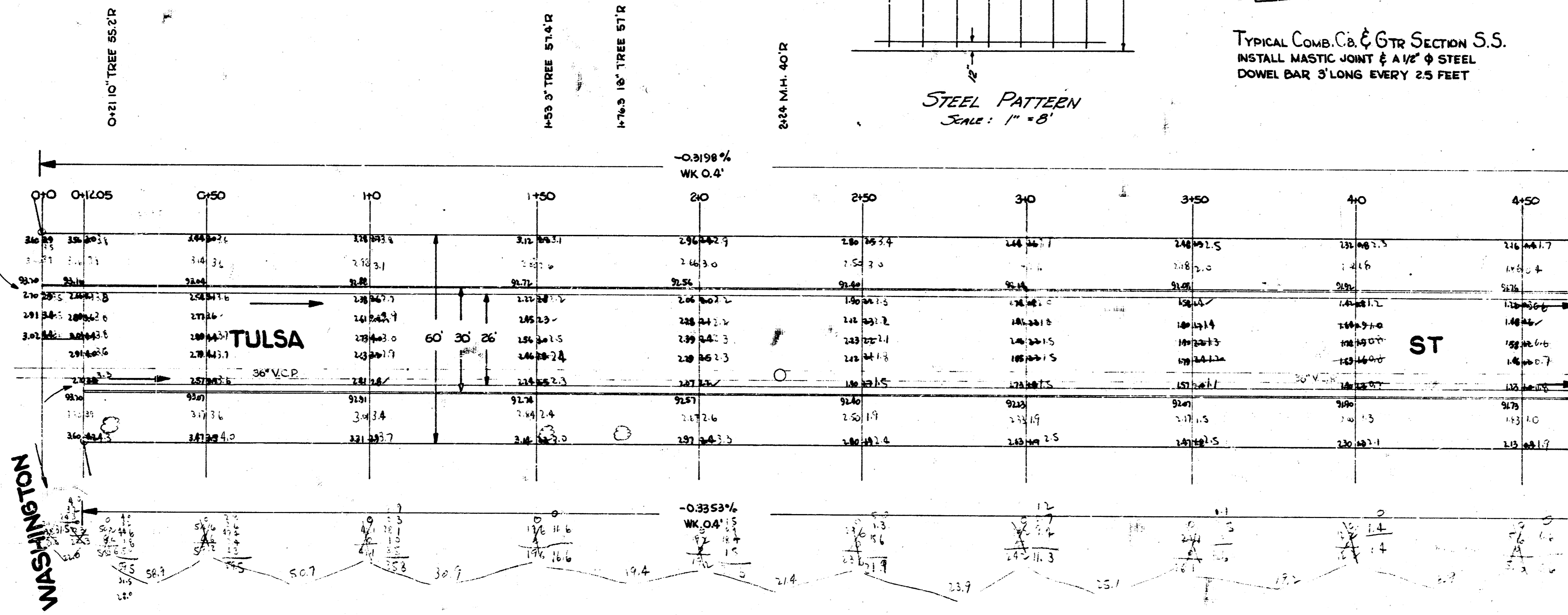

TYPICAL COMB. C>R SECTION S.S.
INSTALL MASTIC JOINT & 1/2" Ø STEEL
DOWEL BAR 3' LONG EVERY 25 FEET

Checked
Exc
N.P.L.
BR 3710

4335
4336
4337
4338
4339
4340
4341
4342
4343
4344
4345
4346
4347
4348
4349
4350
4351
4352
4353
4354
4355
4356
4357
4358
4359
4360
4361
4362
4363
4364
4365
4366
4367
4368
4369
4370
4371
4372
4373
4374
4375
4376
4377
4378
4379
4380
4381
4382
4383
4384
4385
4386
4387
4388
4389
4390
4391
4392
4393
4394
4395
4396
4397
4398
4399
4400



TULSA ST
E.L. WASHINGTON TO W.L. HYDRAULIC
26-2-30 ASPH. CONC.
CITY OF WICHITA, KANSAS
B.E. SMITH CITY ENGINEER
APR. 1954 PROJ. NO. C14-17

1/7

B.M. S.W. COR PORCH ON HOUSE N.W. COR TULSA & PATTIE ELEV 92.47

6+49 E.M.H. 40' R

9+46 E ATT GAR 24' L

9+51 E M.H. 40' R

AVE

NOTE:
C.B.S. & LEADS SHOWN AT
PATTIE, TO BE BUILT ON S.W.S

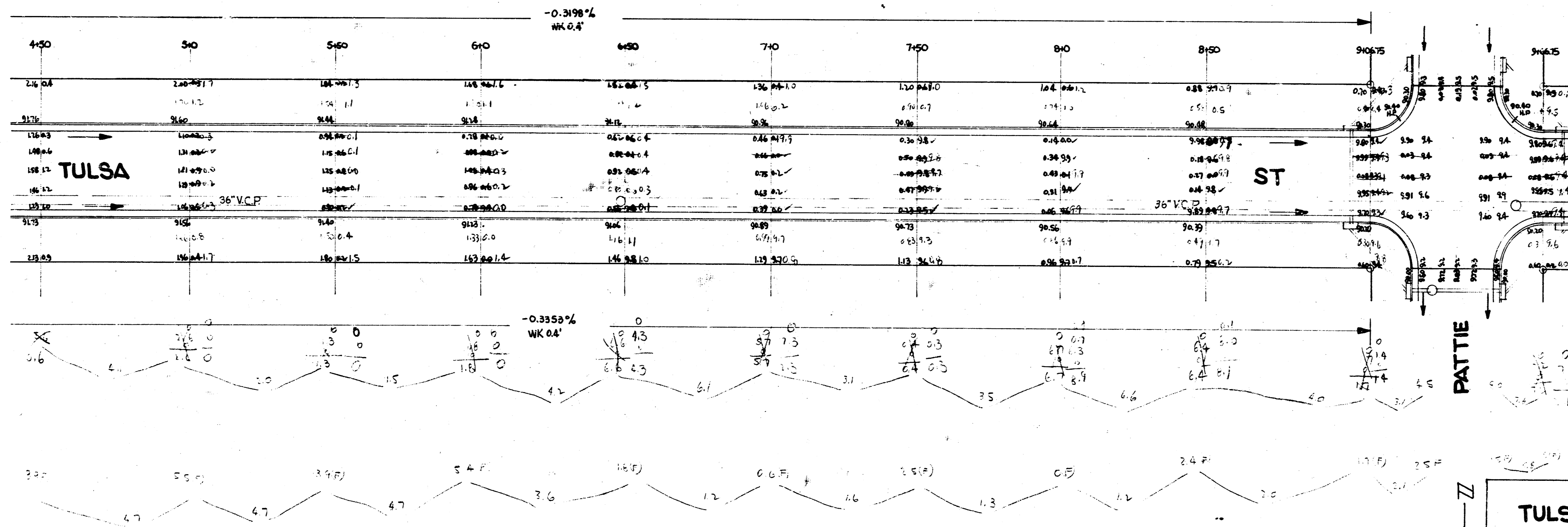

TULSA ST

PROJ. NO. C14-11

2/

NOTE TO FIELD ENGINEER

RE-X-SECTION NORTH PARKING BETWEEN STA 12+0 & STA 15+66.75 BEFORE CONSTRUCTION BEGINS. BUILDER WAS CUTTING BANK AT TIME OF ORIGINAL X-SECT.

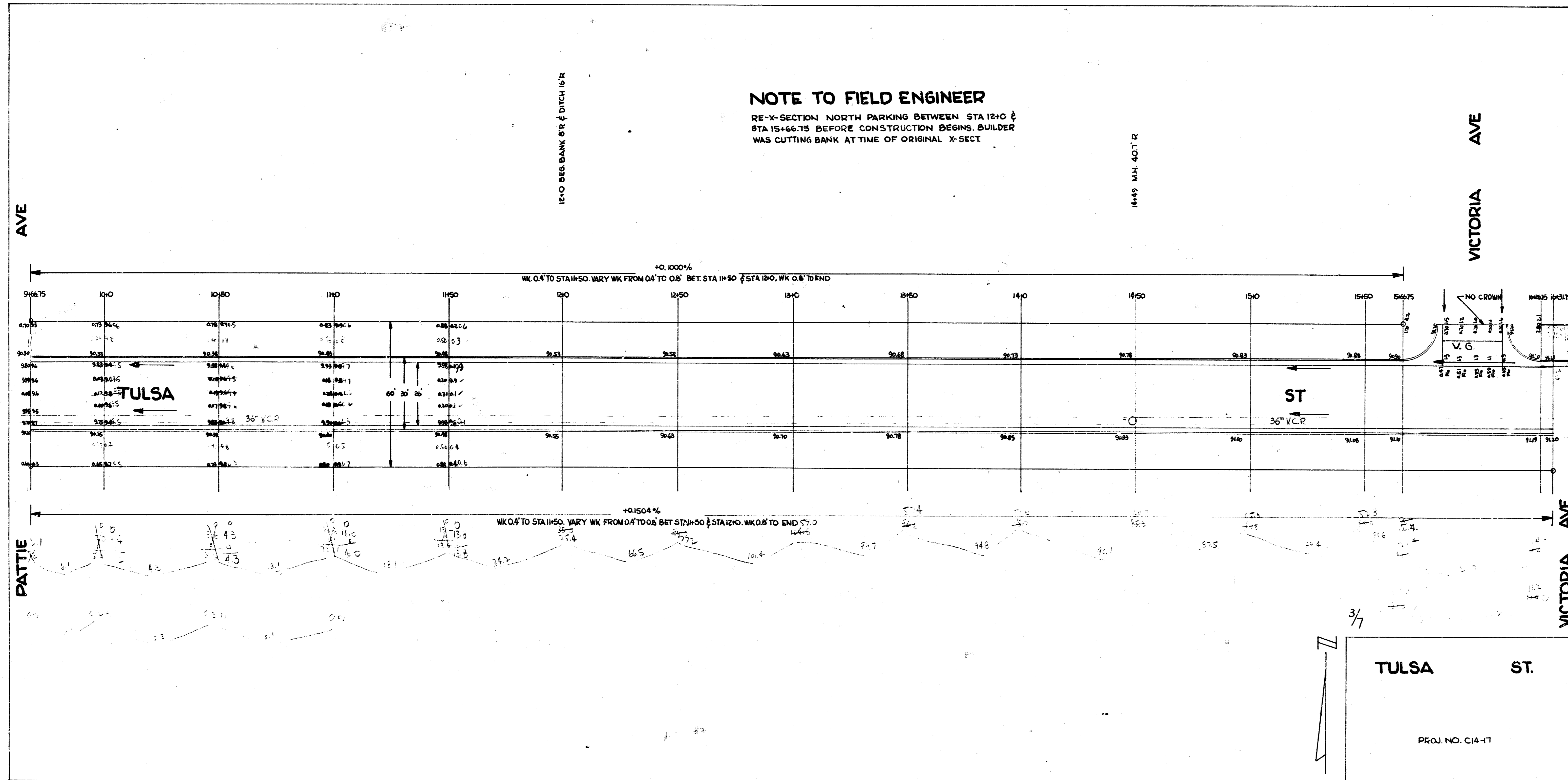

NOTE:
DO NOT MATCH DRIVES ON N.S. TULSA
BET. STA 16+40 & STA 21+0

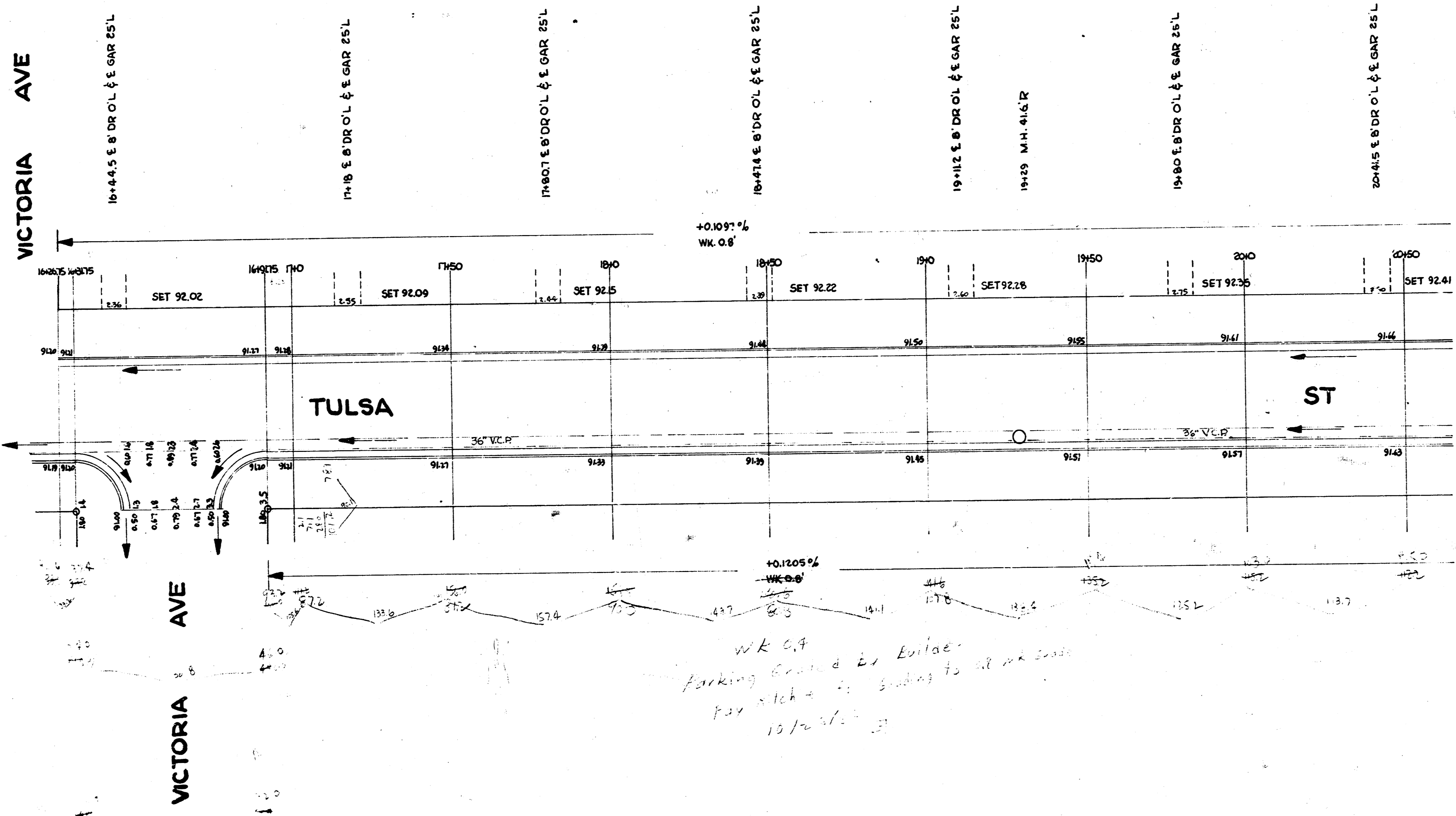

4/7

TULSA ST

PROJ. NO. C14-17

