

INDOLAWN BLVD.
S. BENEVOLENT EASTRIDGE
SA 4E-1038 ST

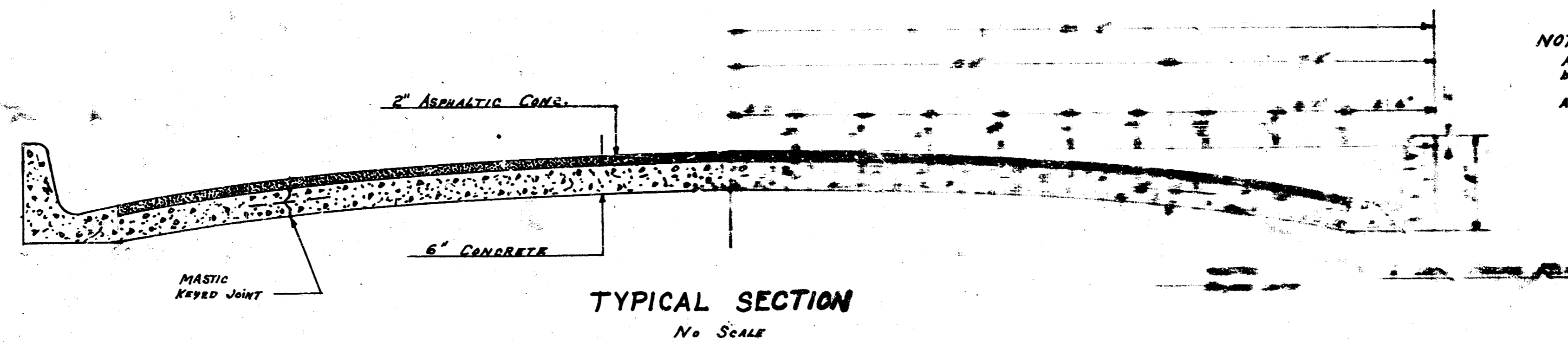

NOTE:-
 All top soil & organic material in ditches to be removed before filling. General to be decided in case of excavation.
 All existing asphalt to be removed from roadway before paving.

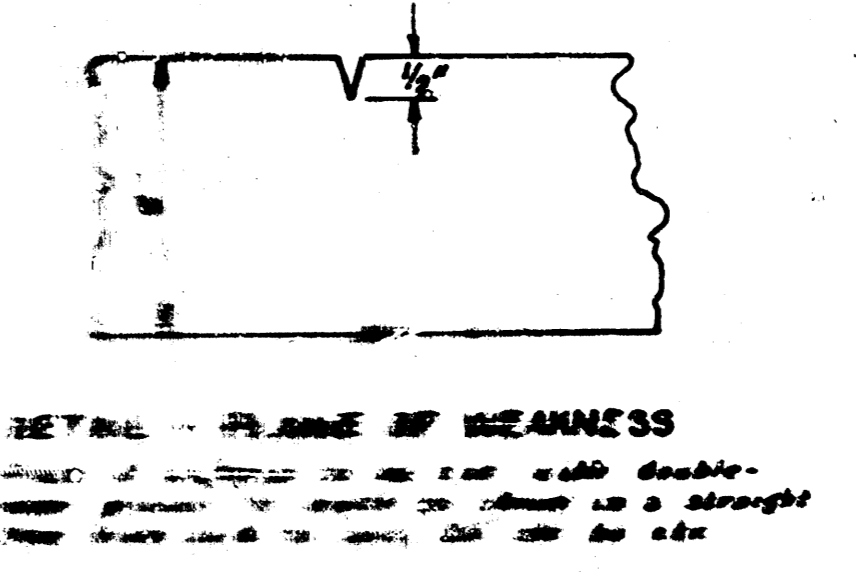
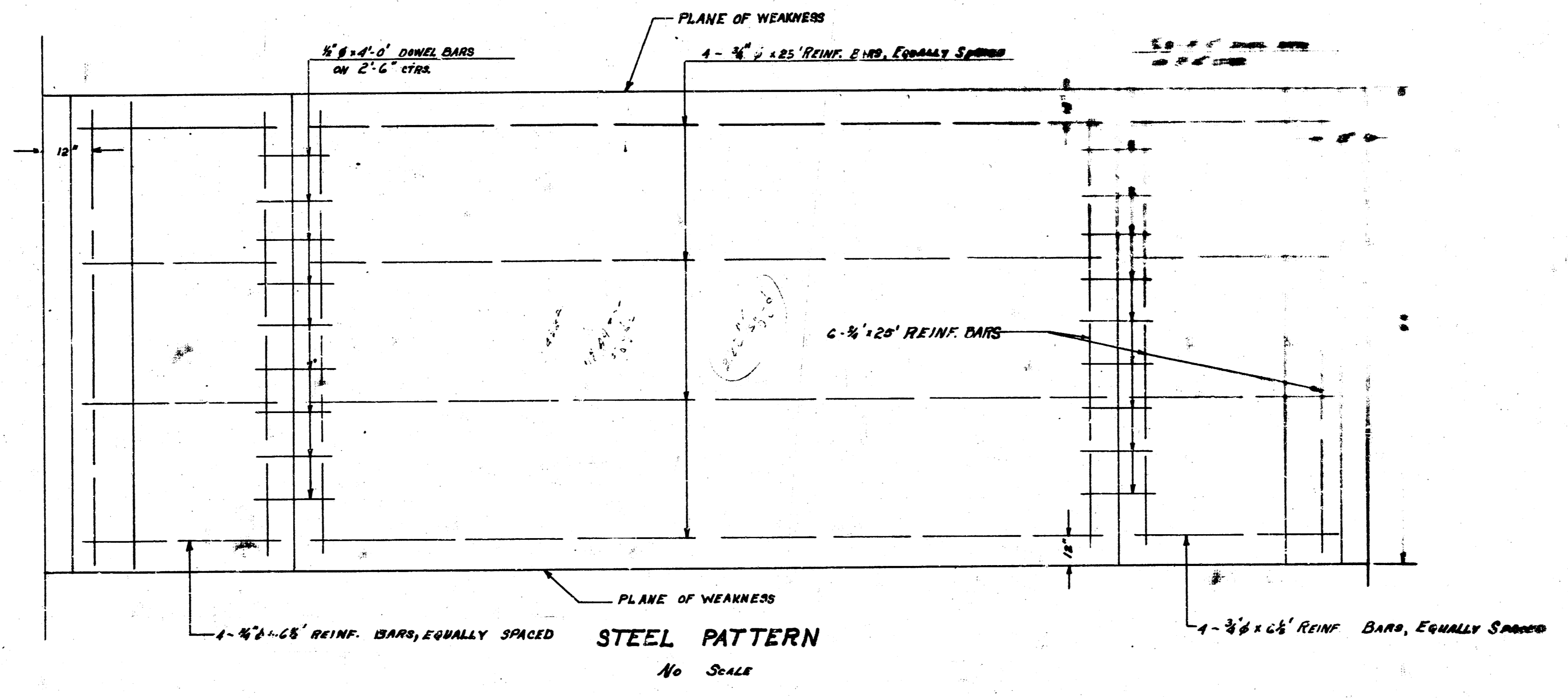

JF-32

235 73

B.M. 157.49 'X' on E. curb of Woodlawn. 20' S of N.L. Eastridge Adm.

N

2.41
 13.47
 11.7
 11.5

13.003
 100.74
 157.2
 157.2

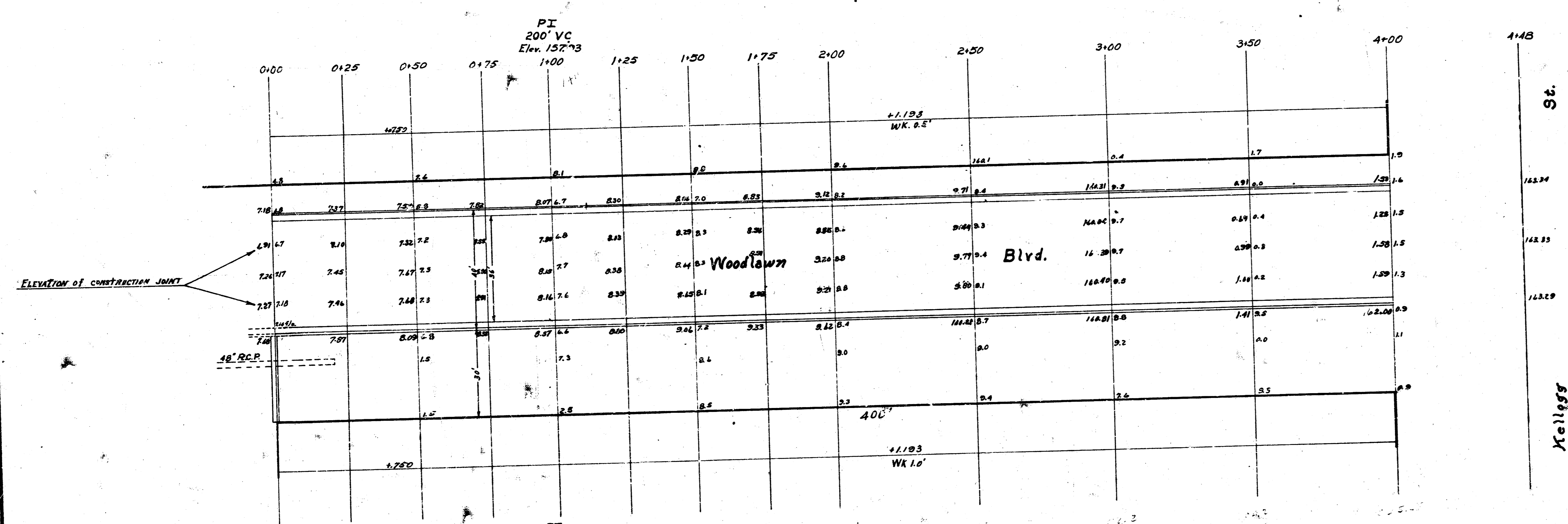

WOODLAWN BLVD.
 S. Res. H, Eastridge ~ ss Kellogg
 36-2-40 A.C.
 City of Wichita, Kansas
 L.K. White City Engineer
 Nov. 1950 Proj. No. C10-201

2/2

4 1 5 50