

B.M. 218.28 'X' cut in NW corner of concrete manhole
75' S. of Rockhill Lane E. & 56.5' E. of Woodlawn.

B.M. 221.43 S.E. corner conc base for light
tower at center of Girl Scout parking lot.

Sheet No. 117
Plan No. 117
Date: 11/17/72

Sta. 0+79 Begin 5" Asph.
width to match existing
gate & warp to 13'
width at Sta. 1+00

P. Pole to be moved
by Water Dept.

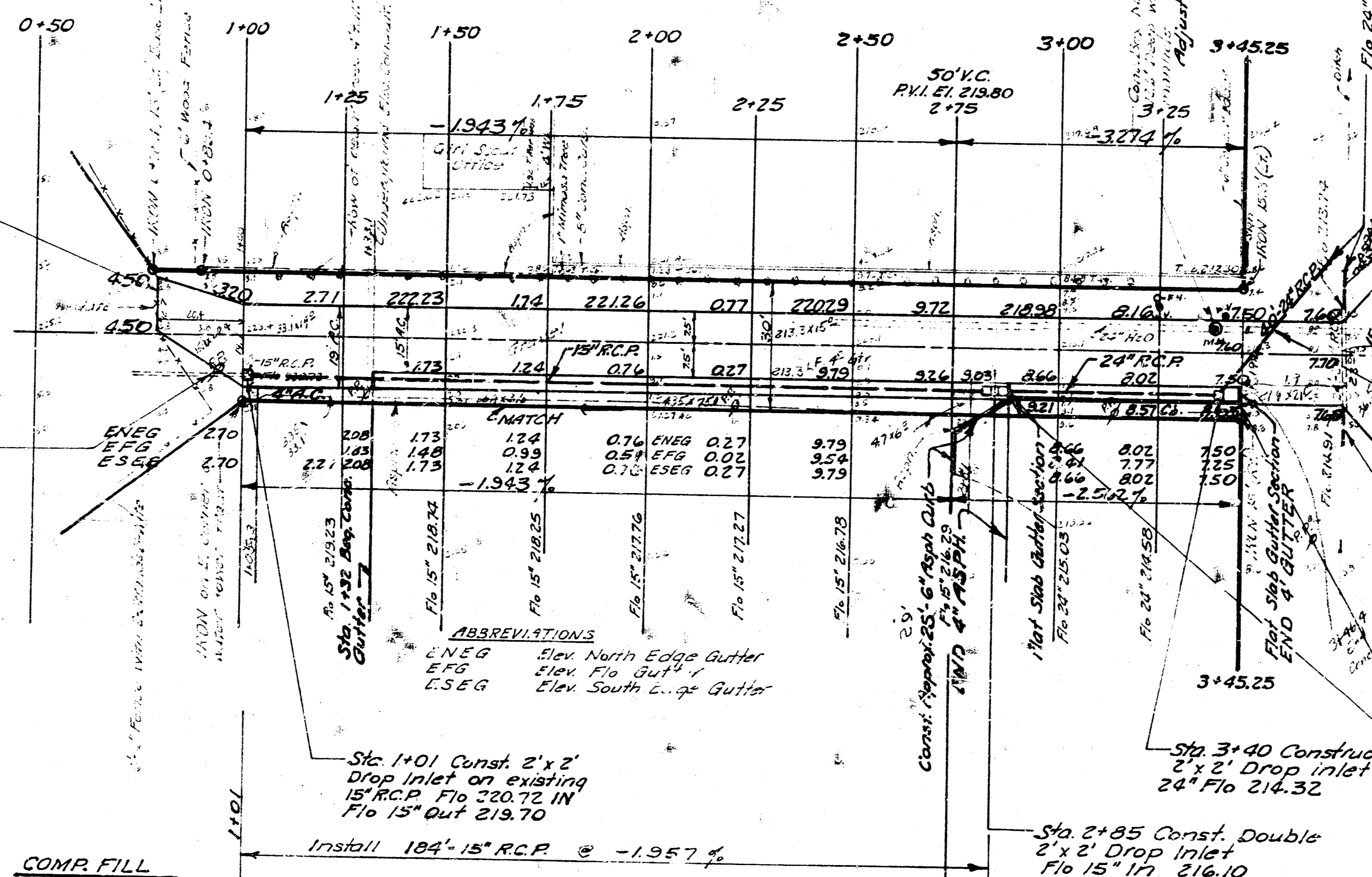

ABBREVIATIONS
 LNEG Elev. North Edge Gutter
 EFG Elev. Flat Gutter
 ESEG Elev. South Edge Gutter

EXCAVATION	COMP. FILL
123 Cu.Yds.	38 Cu.Yds.
12 "	4 "
Totals 135 Cu.Yds.	42 Cu.Yds.

825 Sp.Yds. Lime Treated Subgrade

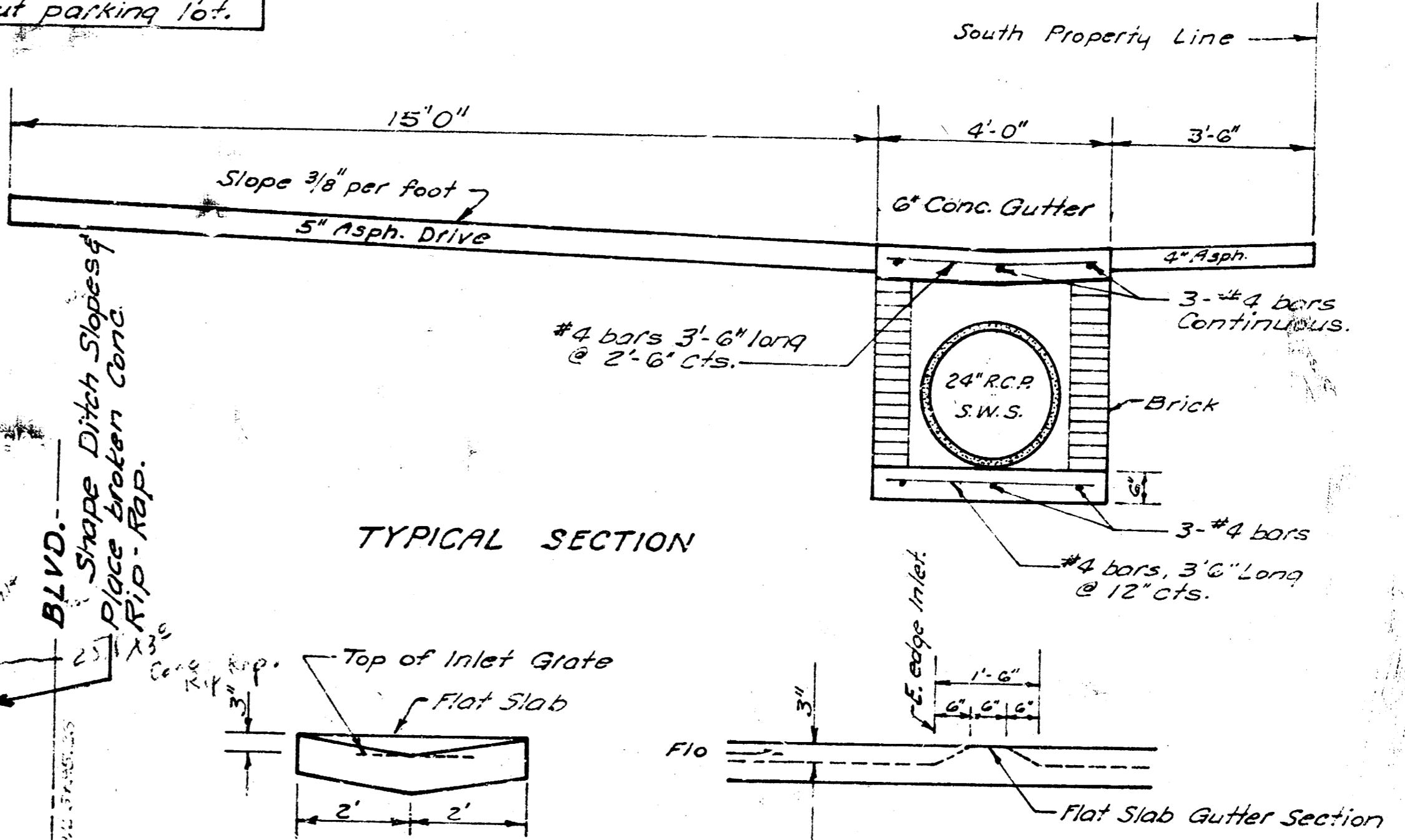

Const. Flat Slab Gutter Section
on East side of drop inlets to
force flow into inlet.

Install 8' Extension on the S. end
of existing 24\"/>

Const. Int. Curb on South edge of
gutter from Sta. 2+88 to 3+45

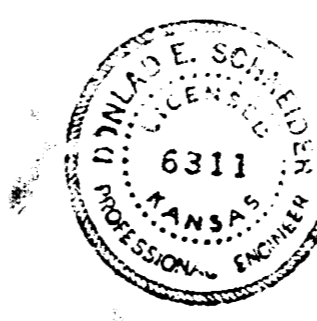

**DRIVEWAY IMPROVEMENTS
TO WOODLAWN TANK
WATER DEPT.
CITY OF WICHITA**

R.W. Linn City Engineer
City of Wichita Kansas

Date: NOV. 1972
 ARK 8502028
 PROJECT No. GETW 607701

1/2