

PAVING AND INCIDENTAL DRAINAGE IMPROVEMENTS

84441

TO SERVE

AVALON PARK 3RD AND 4TH ADDITION-PHASE 1

LAKE RIDGE-FROM THE S.L. OF AVALON PARK 3RD TO A POINT 30' W. OF THE W.L. OF LOT 36, BLOCK 1
 LAKE RIDGE CT.-FROM THE E.L. OF LAKE RIDGE TO AND INCLUDING THE CUL-DE-SAC
 LAKE RIDGE CT.-FROM THE W.L. OF LAKE RIDGE TO AND INCLUDING THE CUL-DE-SAC
 CANDLEWOOD CIR.-FROM THE W.L. OF LAKE RIDGE TO AND INCLUDING THE CUL-DE-SAC
 SIDEWALK-TO BE INSTALLED ALONG THE EAST LINE OF LAKE RIDGE

OCA NO. 766153

CITY OF WICHITA PROJECT NO. 472-84441

CITY OF WICHITA, KANSAS

JAMES L. ARMOUR, P.E. - CITY ENGINEER

INDEX OF SHEETS

1. TITLE SHEET
2. KEY MAP AND GENERAL NOTES
- 3-4. PLATS AND HORIZONTAL CONTROL
5. PROJECT COORDINATES
- 6-7. FOUR CORNER PLAN
8. SITE GRADING PLAN (INFO. ONLY)
9. TYPICAL 29' BK.-BK. PAVEMENT
10. TYPICAL 35' BK.-BK. PAVEMENT
- 11-13. PAVING PLAN-LAKE RIDGE
14. PAVING PLAN-LAKE RIDGE CT. (WEST)
- 15-16. PAVING PLAN-LAKE RIDGE CT. (EAST)
- 17-18. PAVING PLAN-CANDLEWOOD CIR.
19. VALLEY GUTTER PLAN
20. MISCELLANEOUS PAVING DETAILS
21. DRIVE ENTRANCES PLAN
22. STD. DRIVE ENTRANCE DETAILS
23. PLAN/PROFILE-SWS LINE NO. 1
- 24-25. PLAN/PROFILE-SWS LINE NO. 2
26. PLAN/PROFILE-SWS LINE NO. 3
- 27-28. PLAN/PROFILE-SWS LINE NO. 4
- 29-31. PLAN/PROFILE-SWS LINE NO. 5
32. PLAN/PROFILE-SWS LINE NO. 5A
33. STD. TYPE 1A CURB INLET (6" X 5'-0")
34. AREA INLET DETAILS
35. PRECAST MANHOLE DETAILS
36. MANHOLE FRAME AND COVER DETAILS
37. RIPRAP AND MISCELLANEOUS DETAILS
38. EROSION CONTROL PLAN
- 39-42. EROSION CONTROL DETAILS
43. SIGNING DETAILS
- 44-68. CROSS SECTIONS

EARTHWORK

EXCAVATION 3,258 CU. YDS.
 COMPACTED FILL 104 CU. YDS.
 LOOSE FILL 567 CU. YDS.

PROJECT LENGTH = 2817 LIN. FT.

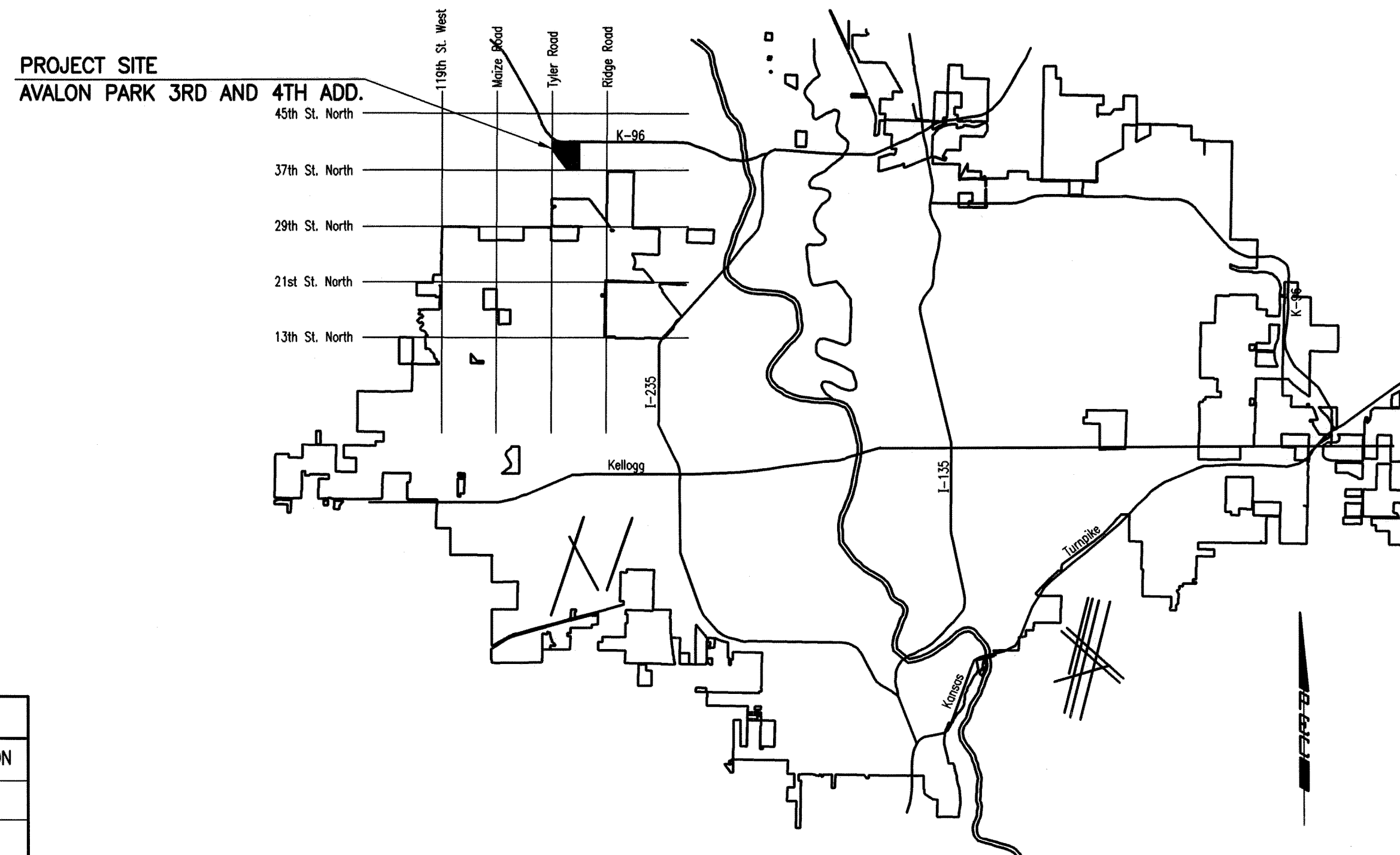

LOCATION MAP

SUBMISION BENCH MARKS (SBM)				
NO.	STREET AND STATION	FROM	DESCRIPTION	ELEVATION
1	LAKE RIDGE, STA. 32+37.40	17.50' LT.	S. END, SOUTHEAST CURB RETURN, LAKE RIDGE CT.	
2	LAKE RIDGE, STA. 34+66.22	17.50' RT.	S. END, SOUTHWEST CURB RETURN, LAKE RIDGE CT.	
3	LAKE RIDGE, STA. 38+01.42	17.50' RT.	S. END, SOUTHWEST CURB RETURN, CANDLEWOOD CIR.	

THE COST OF THE BENCH MARK DISC, INCLUDING INSTALLATION, SHALL BE INCIDENTAL TO THE CURB.

SEPTEMBER 2007

PLANS PREPARED BY

PROFESSIONAL ENGINEERING CONSULTANTS, P.A.
 ENGINEERS
 WICHITA, KANSAS

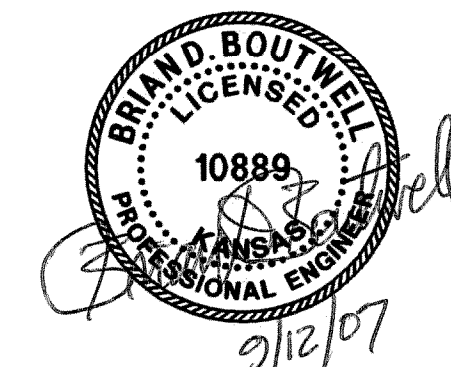

CONSTRUCTION SCHEDULE/SEQUENCE

CONTRACTORS FOR THE FOLLOWING AVALON PARK 3RD AND 4TH PROJECTS SHALL COORDINATE WITH OTHER CONTRACTORS ON SITE TO ALLOW CONCURRENT CONSTRUCTION WHENEVER POSSIBLE AND PREVENT DELAYS SO THAT EACH PROJECT CAN BE COMPLETED BY THE INDICATED DATE.

SANITARY SEWER (468-84216)

THE CONTRACTOR SHALL SEQUENCE HIS WORK TO COMPLETE, INCLUDING TESTING AND ACCEPTANCE, THE FOLLOWING WORK: LINE 1 IN ITS ENTIRETY, LINE 3 IN ITS ENTIRETY, LINE 4 IN ITS ENTIRETY, AND THEN COMPLETE ALL REMAINING WORK. ALL WORK ON THE AVALON PARK 3RD AND 4TH - PHASE 1 SANITARY SEWER PROJECT SHALL BE COMPLETED BY SEPTEMBER 11, 2007.

WATER DISTRIBUTION SYSTEM (448-90225)

THE CONTRACTOR SHALL COMPLETE THE AVALON PARK 3RD AND 4TH - PHASE 1 WATERLINE CONSTRUCTION BY OCTOBER 1, 2007.

MASS SITE GRADING (PRIVATE CONTRACT)

THE CONTRACTOR SHALL COMPLETE MASS SITE GRADING BY OCTOBER 31, 2007.

PAVING & INCIDENTAL DRAINAGE (472-84441)

THE CONTRACTOR SHALL COMPLETE AVALON PARK 3RD AND 4TH - PHASE 1 PAVING & DRAINAGE CONSTRUCTION BY DECEMBER 28, 2007.