

WATER VALVE BOX ELEVATIONS			
STREET	STATION	OFFSET	PROPOSED ELEVATION
LAKE RIDGE CT.	51+06.02	39.73' Lt.	153.8
LAKE RIDGE CT.	54+63.49	22.0' Rt.	151.2

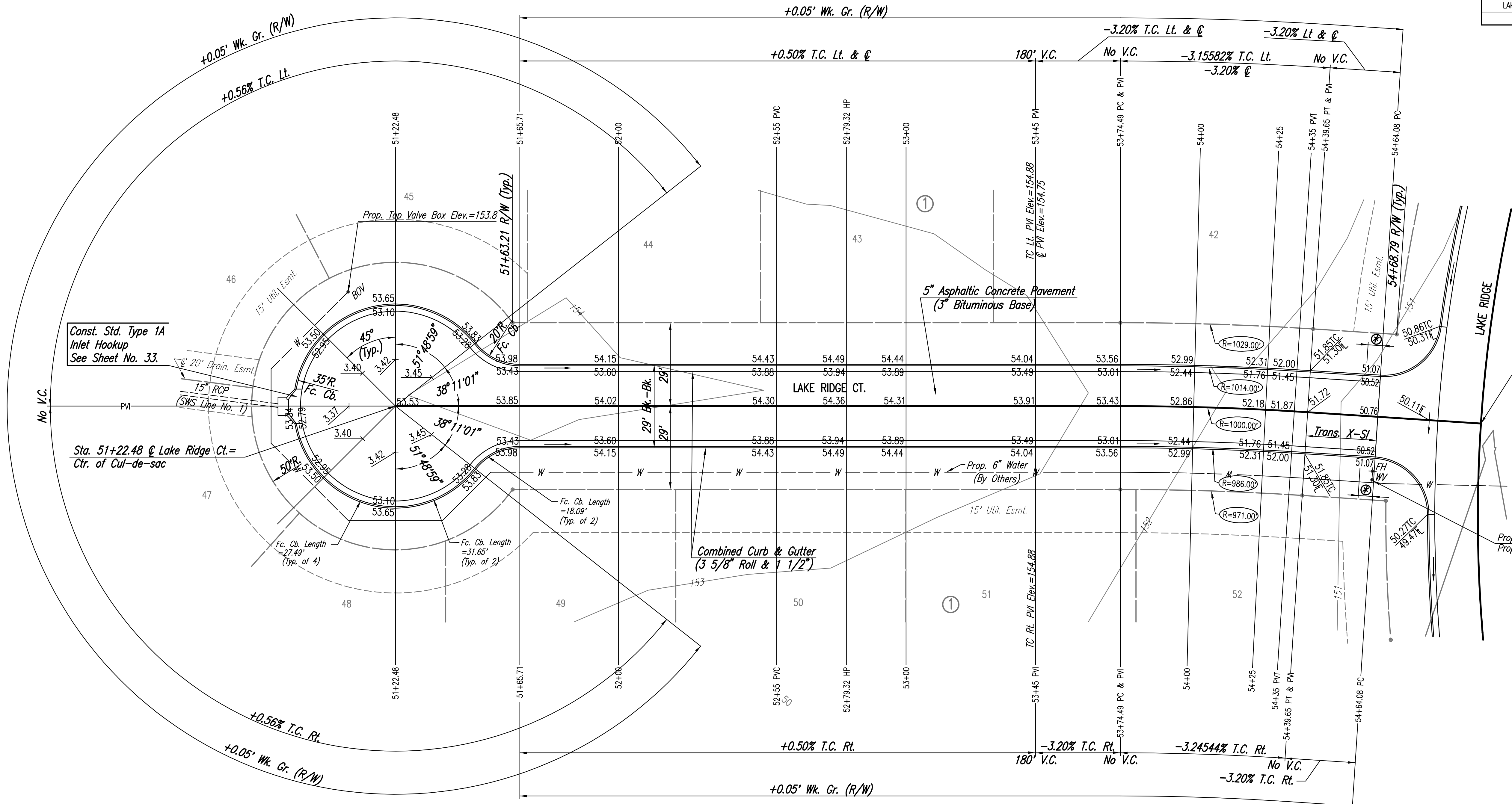
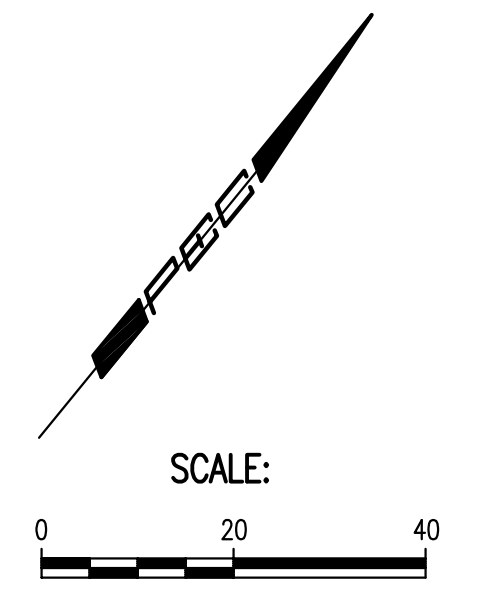

Sta. 55+00.0 @ Lake Ridge Ct. =
Sta. 32+69.08 @ Lake Ridge

Prop. Top Valve Box Elev.=151.2
Prop. FH Bury Line Elev.=151.1

@ CURVE DATA						
A=3°43'59\"/>						
@ STATION	@ ARC LENGTH	FACE CURB LENGTH LEFT CURB	FACE CURB LENGTH RIGHT CURB	CHORD LENGTH 8' OFF LEFT FACE CURB	CHORD LENGTH 8' OFF RIGHT FACE CURB	DEFLECTION ANGLE
53+74.49	0.51'	0.52'	0.50'	0.52'	0.50'	0°00'00.0"
54+00.00	25.00'	25.39'	24.65'	25.55'	24.45'	00°00'52.6"
54+25.00	25.00'	25.39'	24.65'	25.55'	24.45'	00°42'58.3"
54+39.64	14.64'	14.85'	14.44'	14.97'	14.32'	00°42'58.3"
TOTAL	65.15'	66.07'	64.24'			01°51'59.5"

Defl./ft. = 1.718873 min.

⊗ 5' Transition from Combined Curb and Gutter (3 5/8" Roll & 1 1/2") to Combined Curb and Gutter (6 5/8" & 1 1/2"). To be bid and paid for as "Combined Curb and Gutter (3 5/8" Roll & 1 1/2)".

NOTE: THIS STREET TO BE CONSTRUCTED WITH ROLL-TYPE CURB. TOP OF CURB ELEVATIONS GIVEN ARE FOR FULL HEIGHT CURB.

Scaled 09-12-2007 7:13:30 AM by BJS
 Plot Scale 1:20 09-12-2007 7:14:23 AM by BJS
 C:\2007\07150\000\07150-000-C-514512-5450

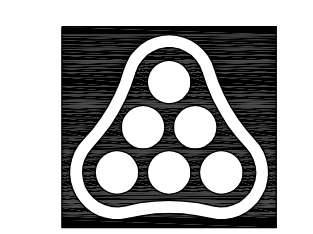

No.	Revision	By	Date
AVALON PARK 3RD AND 4TH ADDITION-PHASE 1 LAKE RIDGE CT. STA. 51+22 TO STA. 54+50 JAMES L. ARMOUR, P.E. - CITY ENGINEER CITY OF WICHITA PROJECT NO. 472-84441			
Professional Engineering Consultants, P.A. 303 S. TOPEKA • WICHITA, KANSAS 67202 316-262-2691 • FAX 316-262-3003			
Designed by	BMM	Job No.	35-07150-000
Drawn by	BJS, TAT	Date	April 2007
			Sheet 14 of 68