

Subdivision Bench Marks

No.	Street and Station	From CL	Description	Elevation
2	Kentucky Lane, Sta. 9+32.65	32.50' Lt.	Northwest end of Curb Return at the Int. of Kentucky, Kentucky & Hunters View.	

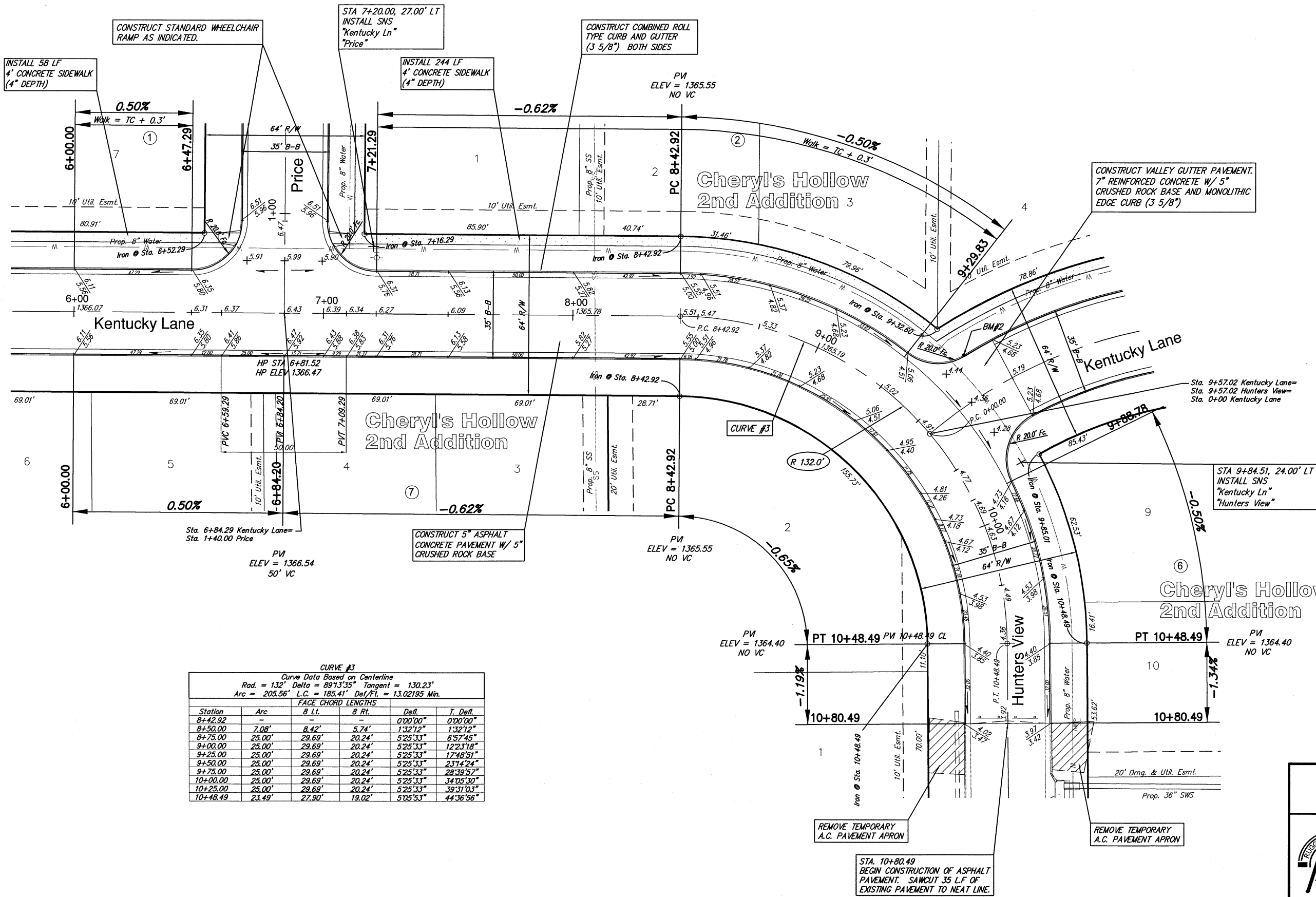

CURVE #3
 Curve Data Based on Centerline
 Rad. = 132' Delta = 89°13'35" Tangent = 130.23'
 Arc = 205.56' L.C. = 185.41' Def/ft. = 13.02195 Min.

Station	Arc	FACE CHORD LENGTHS		Defl.	T. Defl.
		8 Lt.	8 Rt.		
8+42.92	-	8.42'	5.74'	0°00'00"	0°00'00"
8+50.00	7.08'	20.24'	5.25'33"	1°32'12"	1°32'12"
8+75.00	25.00'	29.69'	20.24'	5°25'33"	6°57'45"
9+00.00	25.00'	29.69'	20.24'	5°25'33"	12°23'18"
9+25.00	25.00'	29.69'	20.24'	5°25'33"	17°48'51"
9+50.00	25.00'	29.69'	20.24'	5°25'33"	23°14'24"
9+75.00	25.00'	29.69'	20.24'	5°25'33"	28°39'57"
10+00.00	25.00'	29.69'	20.24'	5°25'33"	34°05'30"
10+25.00	25.00'	29.69'	20.24'	5°25'33"	39°31'03"
10+48.49	23.49'	27.90'	19.02'	5°05'53"	44°36'56"

NOTE: ROLL TYPE CURB AND GUTTER TO BE CONSTRUCTED ALONG PAVEMENT DEPICTED ON THIS SHEET

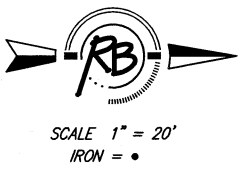

8-28-07

Cheryl's Hollow 2nd, Phase 1
Kentucky Lane/Hunters View
 WICHITA, KANSAS

Ruggles & Bohm, P.A.
 Engineering, Surveying, Land Planning

924 North Main
 Wichita, Kansas 67203
 www.rbkansas.com

(316) 264-8008
 (316) 264-4621 fax
 E-mail: info@rbkansas.com

DESIGN	KWL	RB JOB	304E
DRAWN	MLP	SHEET	6
REVIEW		OF	45
UTILITY		DATE	Aug. 7, 2007
DRAWING FILE	base {Kent2}	PROJECT NUMBER	472-84544