



SCALE: 1" = 80'

AREAS TO BE GRADED. FILL ONLY WITH DIRT FROM STOCKPILES. NOT ALL AREAS HAVE TO BE GRADED.

NOTE: EXISTING STOCKPILES ARE TO BE REMOVED AND SPREAD IN INDICATED AREAS ON SHEETS 24 & 25. LOTS CAN BE FILLED TO THE NEAREST FOOT BUT LOT CORNERS AND STREETS SHOULD BE CONSTRUCTED TO THE NEAREST TENTH.

SHADED AREAS ARE TO BE FILLED TO THE EXTENT POSSIBLE WITH THE DIRT AVAILABLE FROM STOCKPILES. AREAS THAT ARE NOT GRADED WITH THIS PROJECT WILL BE COMPLETED WITH A FUTURE STORMWATER DRAIN PROJECT. PROVIDE POSITIVE DRAINAGE IN ALL SITUATIONS.

ALL AREAS DISTURBED BY CONSTRUCTION SHALL BE SEEDED, FERTILIZED AND MULCHED. RIGHT-OF-WAY AND RESERVE AREAS SHALL BE SEEDED WITH FESCUE. LOTS AND EASEMENTS SHALL BE SEEDED WITH RYE.

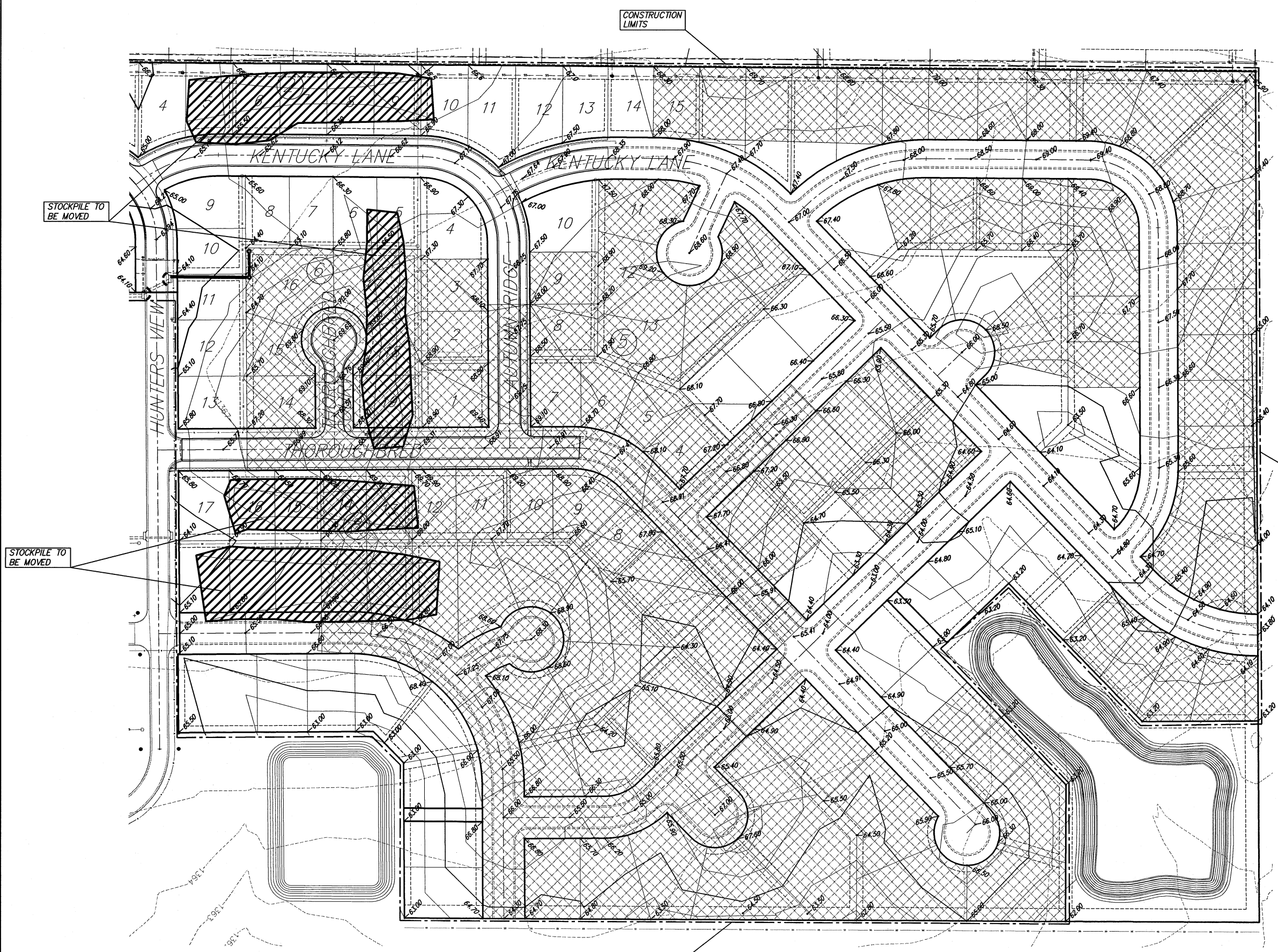

8-28-07

NOTE: ALL DISTURBED AREAS TO SEEDED, FERTILIZED AND MULCHED PER CITY OF WICHITA SPECIFICATIONS. CONTRACTOR TO MAINTAIN BMP'S PLACED BY PREVIOUS PROJECTS.

Cheryl's Hollow 2nd Addition
Stockpile Relocation Details
WICHITA, KANSAS



Ruggles & Bohm, P.A.
Engineering, Surveying, Land Planning
924 North Main
Wichita, Kansas 67203
www.rbkansas.com
(316) 264-8008
(316) 264-4621 fax
E-mail: info@rbkansas.com

DRAWING FILE: base {Grading Plan 1}
PROJECT NUMBER: 472-84544

DESIGN	KWL	RB JOB	304E
DRAWN	MLP	SHEET	24
REVIEW		OF	45
UTILITY		DATE	Aug. 7, 2007