

BENCHMARK:  
 BM #1: "C" CUT, TOP OF CURB, S. SIDE OF  
 SUNDANCE AS DEDICATED IN SAVANNA AT  
 CASTLE ROCK RANCH 7TH ADDITION, 25'± W  
 OF THE WEST LINE OF THE SE1/4 OF SEC.  
 12, TWP. 27-S, R-2-E  
 ELEV. = 1347.33 NGVD29

BM #2: 60d NAIL IN HIGH LINE POLE, 30'  
 SOUTH OF ST/4 COR., SEC. 12, TWP. 27-S,  
 R-2-E  
 ELEV. = 1348.58 NGVD29 (PER COUNTY  
 RECORD)

\*Existing stream is Army  
 Corps of Engineers jurisdiction  
 do not disturb beyond what  
 is necessary for construction.

CAUTION!  
 Ex. 18" SS  
 Near

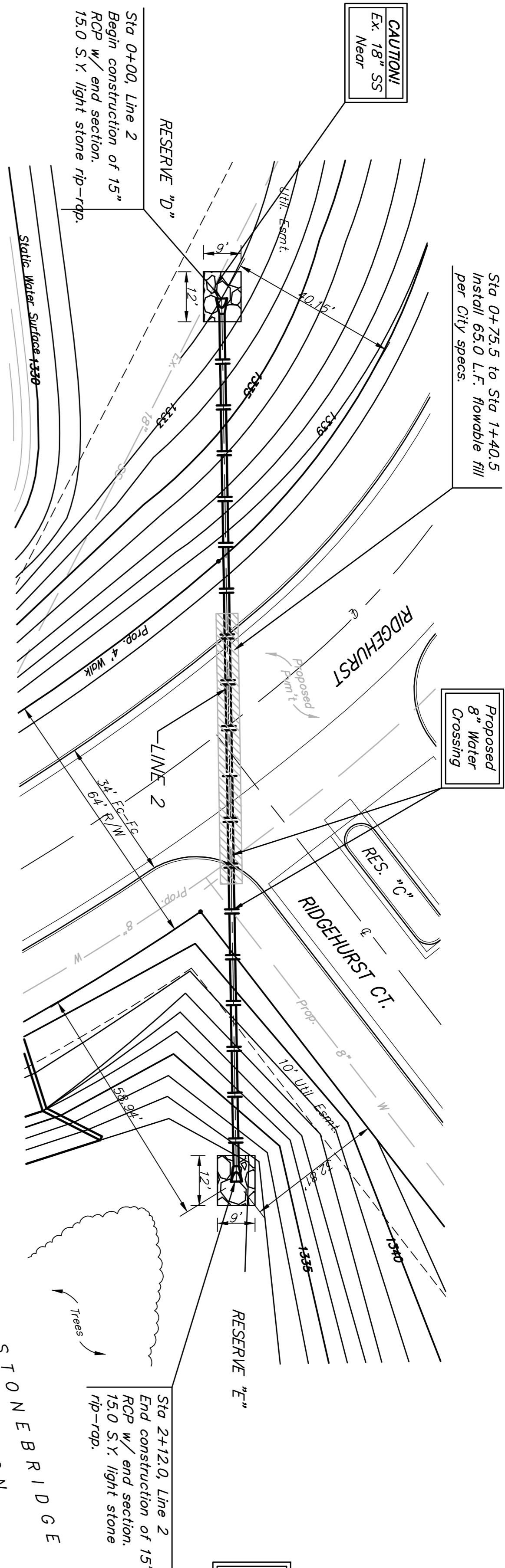

Sta 0+75.5 to Sta 1+40.5  
 Install 65.0 L.F. Flowable fill  
 per City specs.

Proposed  
 8" Water  
 Crossing

\*Existing stream is Army  
 Corps of Engineers jurisdiction  
 do not disturb beyond what  
 is necessary for construction.

Scale: 1" = 20' Horizontal  
 1" = 5' Vertical  
 • = Iron

Sta 0+00, Line 2  
 Begin construction of 15"  
 RCP w/ end section.  
 15.0 S.Y. light stone rip-rap.

65.0 L.F. Flowable fill  
 Elev. = 1338.0

Ridgehurst

Proposed  
 8" Water  
 Crossing  
 (This Project)

Sta 2+12.0, Line 2  
 End construction of 15"  
 RCP w/ end section.  
 15.0 S.Y. light stone  
 rip-rap.

CAUTION!  
 Ex. 18" SS  
 Near

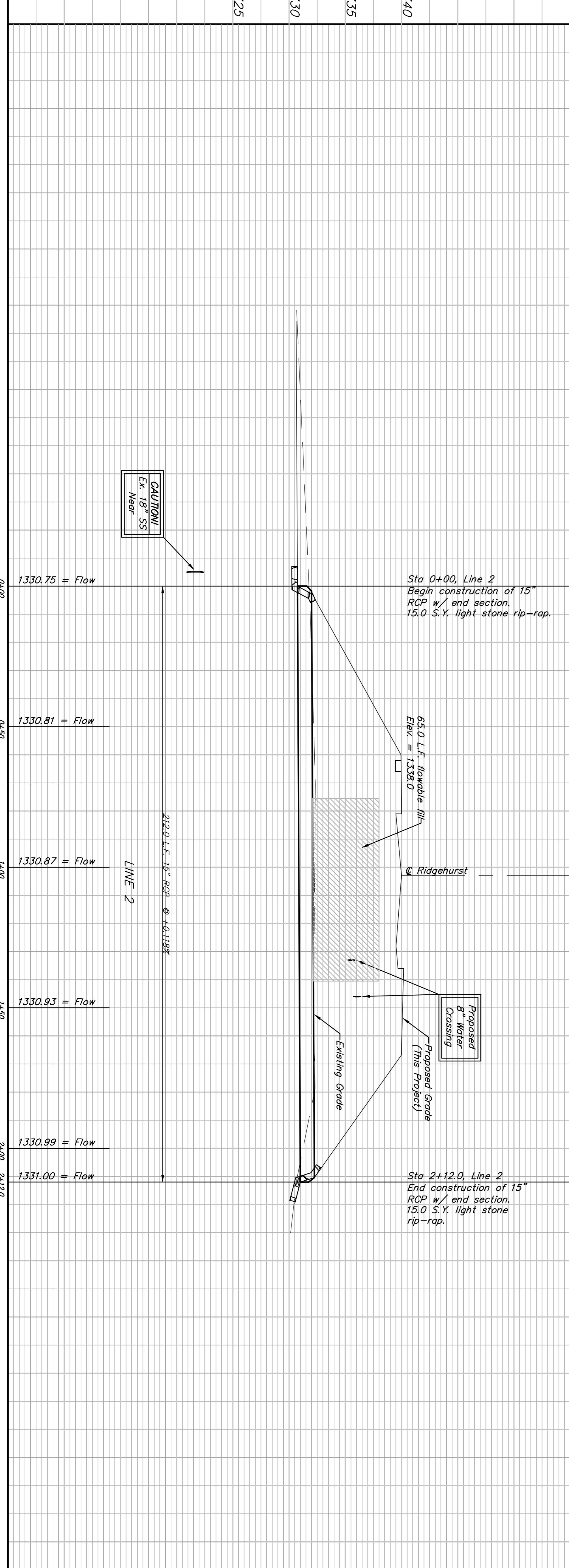

		<b>STONEBRIDGE ADDITION</b> <b>LINE 2</b>	
Storm Water Sewer Improvements			
Baughman Company, P.A. 315 Main St., Suite 201, P.O. Box 201, Stonebridge, PA 16822 ENGINEERING   SURVEYING   PLANNING   LANDSCAPE ARCHITECTURE		PROJECT NUMBER: 468-44395	
REVISIONS:		DESIGN: TMS	
APPROVED:		DATE: 09/07	
SCALE: Normal		SHEET: <b>4 OF 51</b>	
Stonebridge, SWMS			

1340	1340
1335	1335
1330	1330
1325	1325