

BENCHMARK:
 BM #1: "X" CUT, TOP OF CURB, S. SIDE OF
 SUNDANCE AS DEDICATED IN SAVANNA AT
 CASTLE ROCK RANCH 7TH ADDITION, 25'E, W
 OF THE WEST LINE OF THE SE1/4 OF SEC.
 12, TWP. 27-S, R-2-E
 ELEV. = 1347.33 NGVD29

BM #2: 60d NAIL IN HIGH LINE POLE, 30'
 SOUTH OF ST/4 COR., SEC. 12, TWP. 27-S,
 R-2-E
 ELEV. = 1348.58 NGVD29 (PER COUNTY
 RECORD)

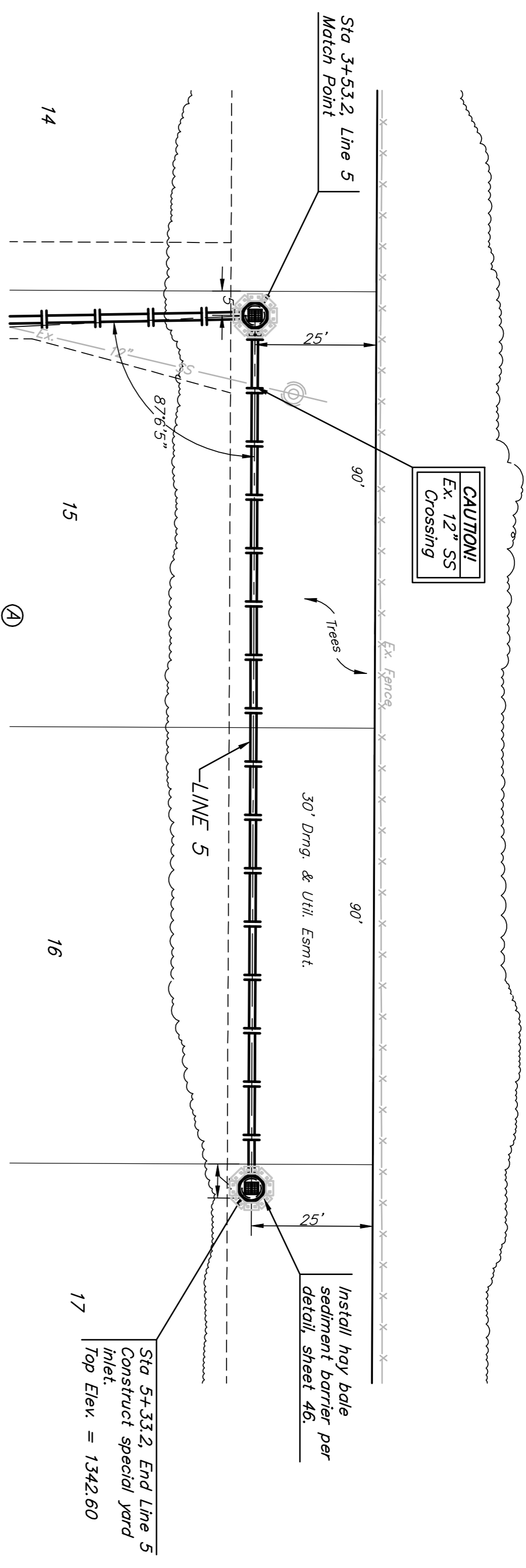

Remove trees ONLY with permission of Developer or Baughman Co. Cost of removal to be incidental to lump sum bid item "Site Clearing & Restoration"

Trees shall be protected from damage during storm sewer construction.

Scale: 1" = 20' Horizontal
 1" = 5' Vertical
 • = Iron

1345	1337.00 = Flow Out (E) 1337.25 = Flow In (N)	Sta 3+53.2, Line 5 Match Point	Existing Grade	Proposed Grade (This Project)	1345
1340	1337.68 = Flow				1340
1335	1338.14 = Flow				1335
1330	1338.60 = Flow				1330
	1338.90 = Flow	Sta 5+33.2, End Line 5 Construct special yard inlet. Top Elev. = 1342.60			1330

Baughman
LINE 5
 STORM WATER SEWER IMPROVEMENTS

1800 L.F. 15" RCP @ +0.017%

CAUTION!
 Ex. 12" SS Crossing

1337.00 = Flow Out (E)
 1337.25 = Flow In (N)

1337.68 = Flow

1338.14 = Flow

1338.60 = Flow

1338.90 = Flow

Sta 3+53.2, Line 5
Match Point

Existing Grade

Proposed Grade
(This Project)

Sta 5+33.2, End Line 5
Construct special yard
inlet.
Top Elev. = 1342.60

Remove trees ONLY with permission of Developer or Baughman Co. Cost of removal to be incidental to lump sum bid item "Site Clearing & Restoration"

Trees shall be protected from damage during storm sewer construction.

Scale: 1" = 20' Horizontal
 1" = 5' Vertical
 • = Iron

1345

1340

1335

1330

1337.00 = Flow Out (E)
1337.25 = Flow In (N)

1337.68 = Flow

1338.14 = Flow

1338.60 = Flow

1338.90 = Flow

Sta 3+53.2, Line 5
Match Point

Existing Grade

Proposed Grade
(This Project)

Sta 5+33.2, End Line 5
Construct special yard
inlet.
Top Elev. = 1342.60

Remove trees ONLY with permission of Developer or Baughman Co. Cost of removal to be incidental to lump sum bid item "Site Clearing & Restoration"

Trees shall be protected from damage during storm sewer construction.

Scale: 1" = 20' Horizontal
 1" = 5' Vertical
 • = Iron

1345

1340

1335

1330