

BENCHMARK:  
 BM #1: "X" CUT, TOP OF CURB, S. SIDE OF  
 SUNDANCE AS DEDICATED IN SAVANNA AT  
 CASTLE ROCK RANCH 7TH ADDITION, 25'± W  
 OF THE WEST LINE OF THE SET/4 OF SEC.  
 12, TWP. 27-S, R-2-E  
 ELEV. = 1347.33 NGVD29  
 BM #2: 60d NAIL IN HIGH LINE POLE, 30'  
 SOUTH OF ST/4 COR., SEC. 12, TWP. 27-S,  
 R-2-E  
 ELEV. = 1348.58 NGVD29 (PER COUNTY  
 RECORD)

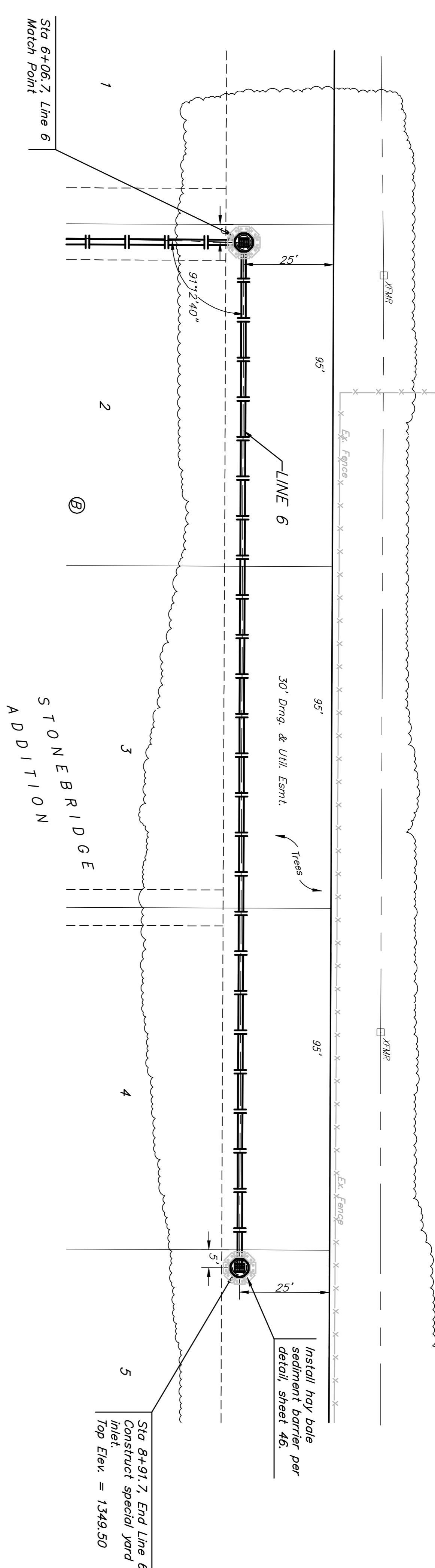

Remove trees ONLY with  
 permission of Developer or  
 Baughman Co. Cost of removal  
 to be incidental to lump sum bid  
 item "Site Clearing & Restoration"

Trees shall be protected from  
 damage during storm sewer  
 construction.

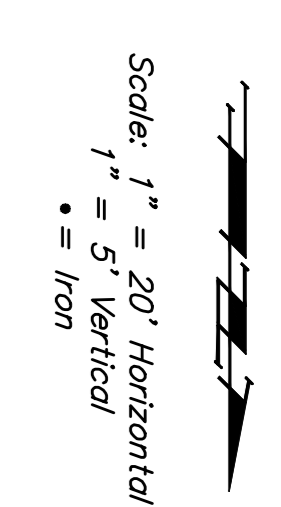

		<b>STONEBRIDGE ADDITION</b> <b>LINE 6</b>	
STORM WATER SEWER IMPROVEMENTS			
Baughman Company, P.A. 310 East 9th, Wichita, KS 67201, P:316.262.9271, F:316.262.9296 ENGINEERING   SURVEYING   PLANNING   LANDSCAPE ARCHITECTURE		DESIGN: TMS ATD DATE: 09/07	
PROJECT NUMBER: 468-44395		DRAWN: TMS	
REVISIONS:		APPROVED:	
SCALE: None		SHEET: <b>14 OF 51</b>	
Stonebridge_SWS13		06.07.E598	

1350  
1345  
1340  
1335

6+06.7  
6+50  
7+00  
7+50  
8+00  
8+50  
8+91.7

1344.30 = Flow Out (E)  
1344.55 = Flow In (N)

1344.77 = Flow

1345.02 = Flow

1345.28 = Flow

1345.53 = Flow

1345.79 = Flow

1346.00 = Flow

Sta 6+06.7, Line 6  
Match Point

Existing Grade

Proposed Grade  
(This Project)

Sta 8+91.7, End Line 6  
Construct special yard  
inlet.  
Top Elev. = 1349.50

285.0 L.F. 15" RCP @ +0.50%

LINE 6

1350  
1345  
1340  
1335