

BENCHMARK:
 BM #1: "C" CUT, TOP OF CURB, S. SIDE OF
 SUNDANCE AS DEDICATED IN SAVANNA AT
 CASTLE ROCK RANCH 7TH ADDITION, 25'E, W.
 OF THE WEST LINE OF THE SE1/4 OF SEC.
 12, TWP. 27-S, R-2-E
 ELEV. = 1347.33 NGVD29

BM #2: 60d NAIL IN HIGH LINE POLE, 30'
 SOUTH OF ST/4 COR., SEC. 12, TWP. 27-S,
 R-2-E.
 ELEV. = 1348.58 NGVD29 (PER COUNTY
 RECORD)

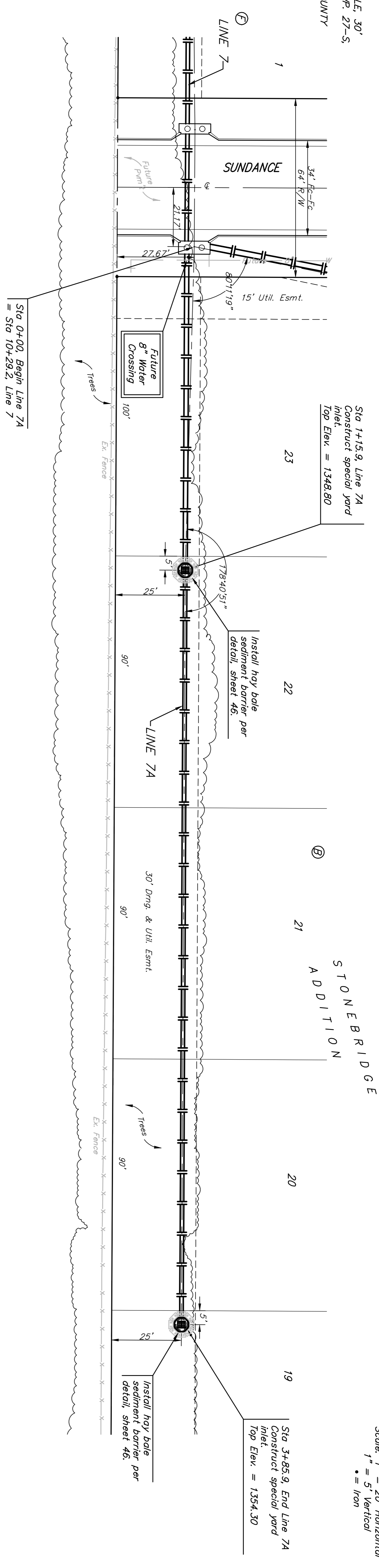

Scale: 1" = 20' Horizontal
 1" = 5' Vertical
 ● = Iron

Remove trees ONLY with
 permission of Developer or
 Baughman Co. Cost of removal
 to be incidental to lump sum bid
 item "Site Clearing & Restoration"

Trees shall be protected from
 damage during storm sewer
 construction.

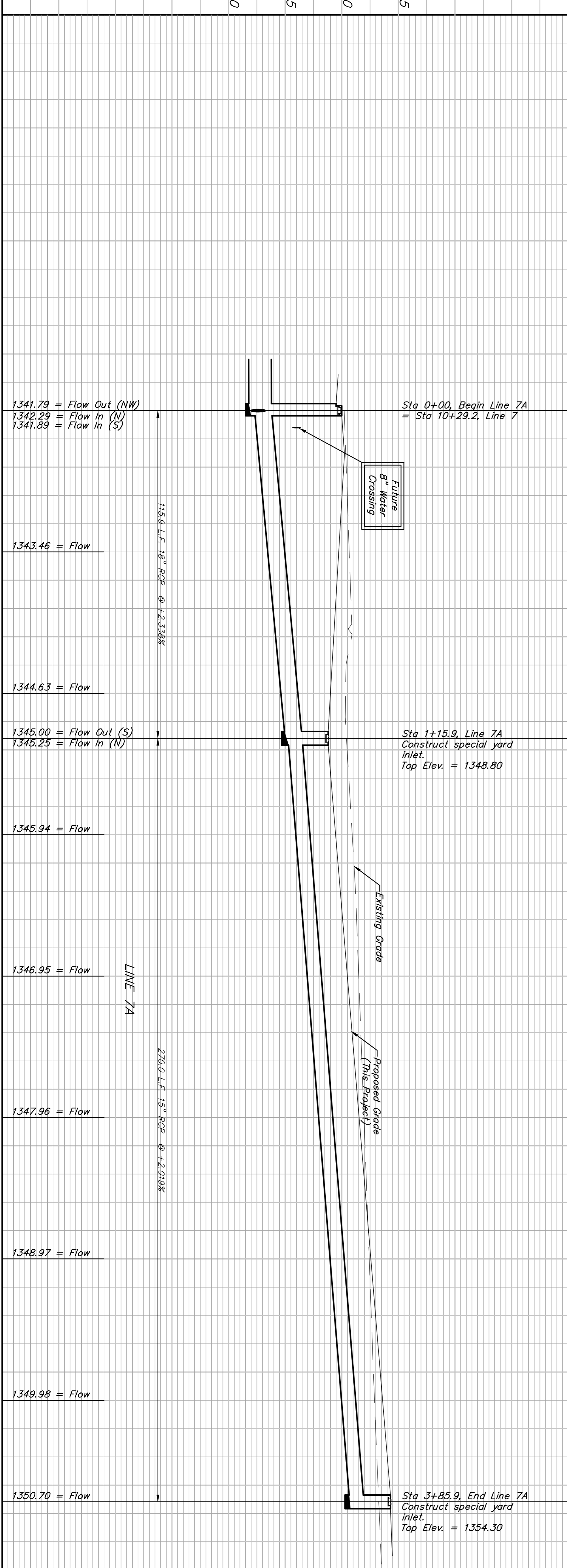

		STONEBRIDGE ADDITION LINE 7A STORM WATER SEWER IMPROVEMENTS	
Baughman Company, P.A. 310 E. 1st St., Suite 200, Williamsport, PA 17701 ENGINEERING SURVEYING PLANNING LANDSCAPE ARCHITECTURE		PROJECT NUMBER: 46844395 REVISIONS:	
DESIGN: ATD APPROVED: DATE 09/07		DRAWN: TMS DATE: 09/07	
SCALE: None		SHEET: 18 OF 51	
Stonebridge SWS17		1340 1345 1350 1355	